



US Army Corps
of Engineers®

Fact Sheet: Altadena Golf Course

Temporary Debris Staging & Reduction Site (TDSR)

As part of wildfire emergency response and recovery efforts, the U.S. Army Corps of Engineers (USACE) will conduct **recycling operations** at the Altadena Golf Course. This site will be used to process clean concrete, metals and plant material, such as burned trees, from fire-impacted properties to allow for **recycling of these materials** rather than taking them to local landfills. A 12-acre section of the golf course has been designated for this temporary operation through a lease agreement with Los Angeles County. Processing of common household hazardous materials, which began during Phase 1 by the EPA, will continue at a significantly smaller scale as limited quantities are collected until this work is 100% complete.

SITE SELECTION

- ✓ Speeds Up Cleanup & Recovery – Allows homeowners to **begin rebuilding sooner**.
- ✓ Proximity to Fire-Affected Areas – Reduces haul times, fuel consumption and emissions.
- ✓ Less Traffic & Road Impacts – Reduced traffic congestion and **less wear and tear on roads**.
- ✓ Environmental & Community Considerations – Site selection was based on logistical needs, reduction of environmental impact, and safety.

OPERATIONS & FACILITY DETAILS

- **Location:** Altadena Golf Course, 1456 East Mendocino St., Altadena
- **Operating Agency:** USACE | **Contractor:** Environmental Chemical Corporation (ECC)
- **Start Date:** March 31, 2025
- **Duration:** 10 months (subject to operational needs)
- **Facility Size:** 12 acres
- **Hours of Operation:** 7 AM–7 PM, 7 days/week

WHAT HAPPENS AT THIS SITE?

Debris is processed and **reduced in size** before being transported to **permitted** recycling facilities.

Accepted Materials:

- ✓ **Concrete** (foundations, walls)
- ✓ **Scrap Metal** (structural steel, appliances, cars [metal framing])
- ✓ **Vegetative Debris** (burned trees, branches)
- ✓ **Common Household Hazardous Materials (HHM)** (limited quantities)

Prohibited Materials:

- ✗ Ash and contaminated soil
- ✗ Asbestos-containing materials
- ✗ Municipal solid waste (household garbage)
- ✗ Tires and electronic waste

Note: Following completion of the U.S. EPA-led lithium-ion battery processing operation, USACE is managing the safe removal of remaining common HHM as part of ongoing recovery efforts.

ENVIRONMENTAL & SAFETY MEASURES

Air Quality & Dust Control

USACE and ECC will implement **strict dust control** measures and **air quality monitoring** to protect public health. Air quality data will be provided to local public health agencies.

- **Water trucks and misting systems** will suppress dust.
- **Air monitors** will track total dust including respirable particulates sized 2.5 and 10 microns.
- **Perimeter monitoring stations** will ensure compliance with air quality standards.

Noise Reduction

- Equipment will be fitted with **noise-reducing mufflers**.
- Crushing/grinding operations will be **positioned to reduce noise**.
- **Operating hours are limited to 7 AM – 7 PM**.
- Additional measures may include **temporary noise barriers, acoustic shielding**.

Security & Public Access

- **Fenced perimeter with controlled access** for authorized personnel only.
- **Security staff and traffic control personnel** will be on-site.

Traffic & Truck Routes

- Trucks will follow designated haul routes and be monitored by the Contractor and USACE.
- **Flaggers and traffic control personnel** will be stationed at key intersections.
- **Primary Routes: Mendocino, Lake, and Woodbury Streets** to minimize neighborhood impact.

Contact Information

For questions or concerns, please contact the dedicated call center at **(626) 657-6091**.

Maps & Figures:

Figure 1: TDSR Operational Layout

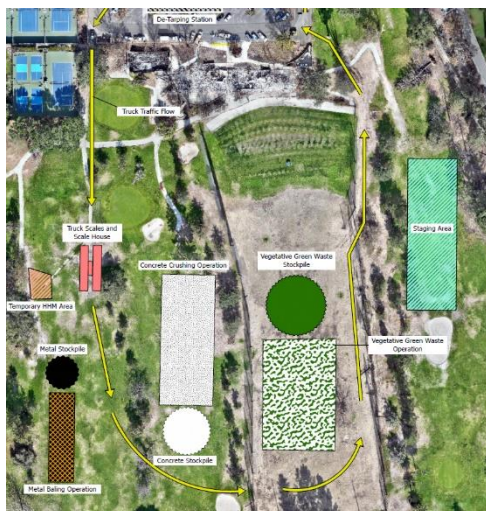

Figure 2: TDSR Primary Truck Route

