

LENNOX Community Parks & Recreation Plan

**GREENING
LENNOX**
THROUGH
PARTNERSHIPS

PURPOSE OF THE PLAN

The purpose of the Plan is to provide a vision and roadmap for a greener Lennox, including a more extensive network of publicly-accessible green spaces and recreational facilities, as well as environmental enhancement projects. More importantly, the Plan provides specific implementation actions to be taken by the County. These will require establishing and strengthening partnerships in order to help reach the vision of a greener, safer and healthier community. The Plan builds on previous planning efforts and is a response to community needs and call for future greening in Lennox.

ENVIRONMENTAL BENEFITS OF EXISTING PARK

154,806
gallons of
stormwater
intercepted
annually

158
pounds of
reduced air
pollutants
annually

11,589
tons of CO₂
sequestered
annually

PARKS AND GREENING PROFILE

Lennox has a severe deficit of parkland. The community only has one park, Lennox Park, which is approximately 5.6 acres in size. The Los Angeles County General Plan sets a standard of 4 acres of local parks per 1,000 residents. Lennox currently has a population of about 23,000 residents which means the community only has approximately **0.2 acres of local parks per 1,000 residents**, a figure significantly below the General Plan standard.

Access to Lennox Park is also not consistent throughout the community. **Thirty-six percent of the Lennox population is not within walking distance (1/2 mile) of Lennox Park or any other park in the area.** Other local environmental issues create a **high community need** for increased parks and green spaces. These include high levels of emissions and noise from nearby freeways and the Los Angeles International Airport (LAX), low urban tree canopy coverage, as well as a challenging pedestrian and bicycle environment. **Access Through Partnerships** provides a community-based **master plan and implementation strategy** for parks and urban greening for Lennox.

Where are parks most needed in Lennox?

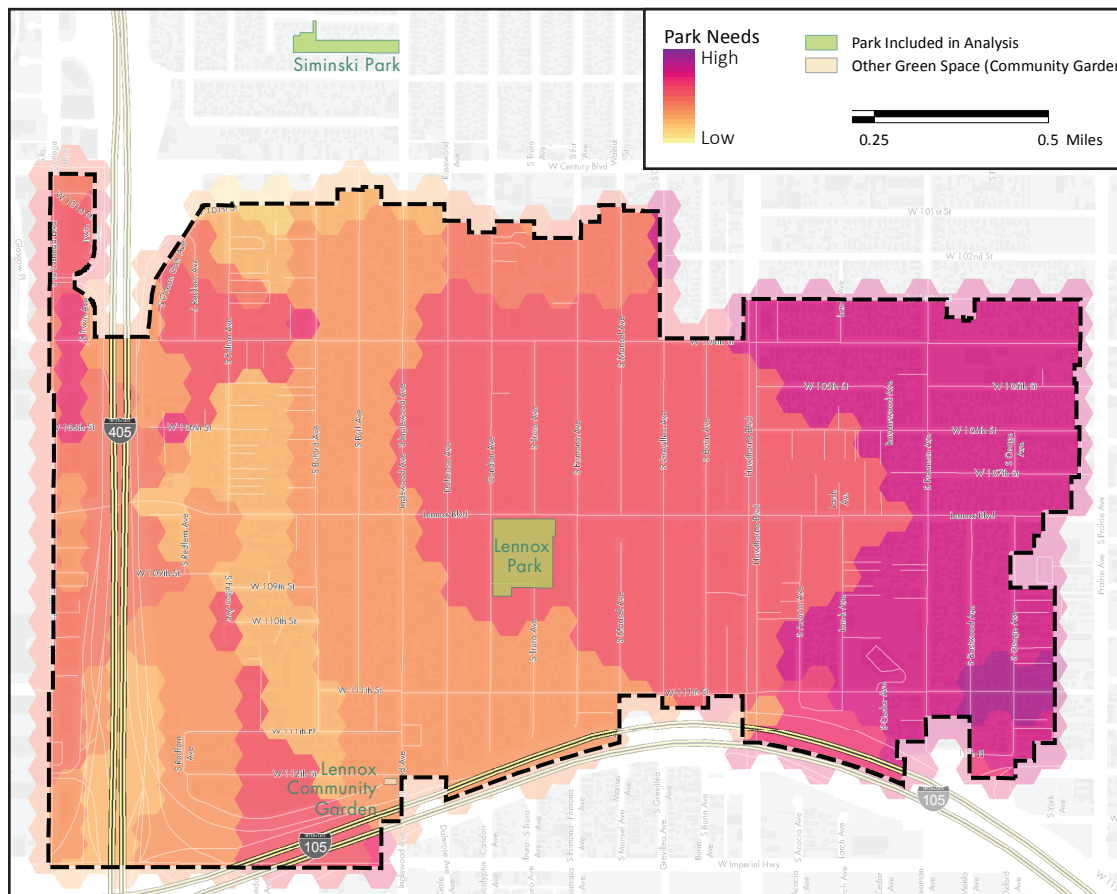

Community Members at Outreach Workshop.



Youth Activity at Outreach Workshop.

LENNOX GREEN VISION MAP

This map identifies potential park, trail, and greening projects that may be implemented in the short, medium, and/or long term to meet the needs of Lennox.

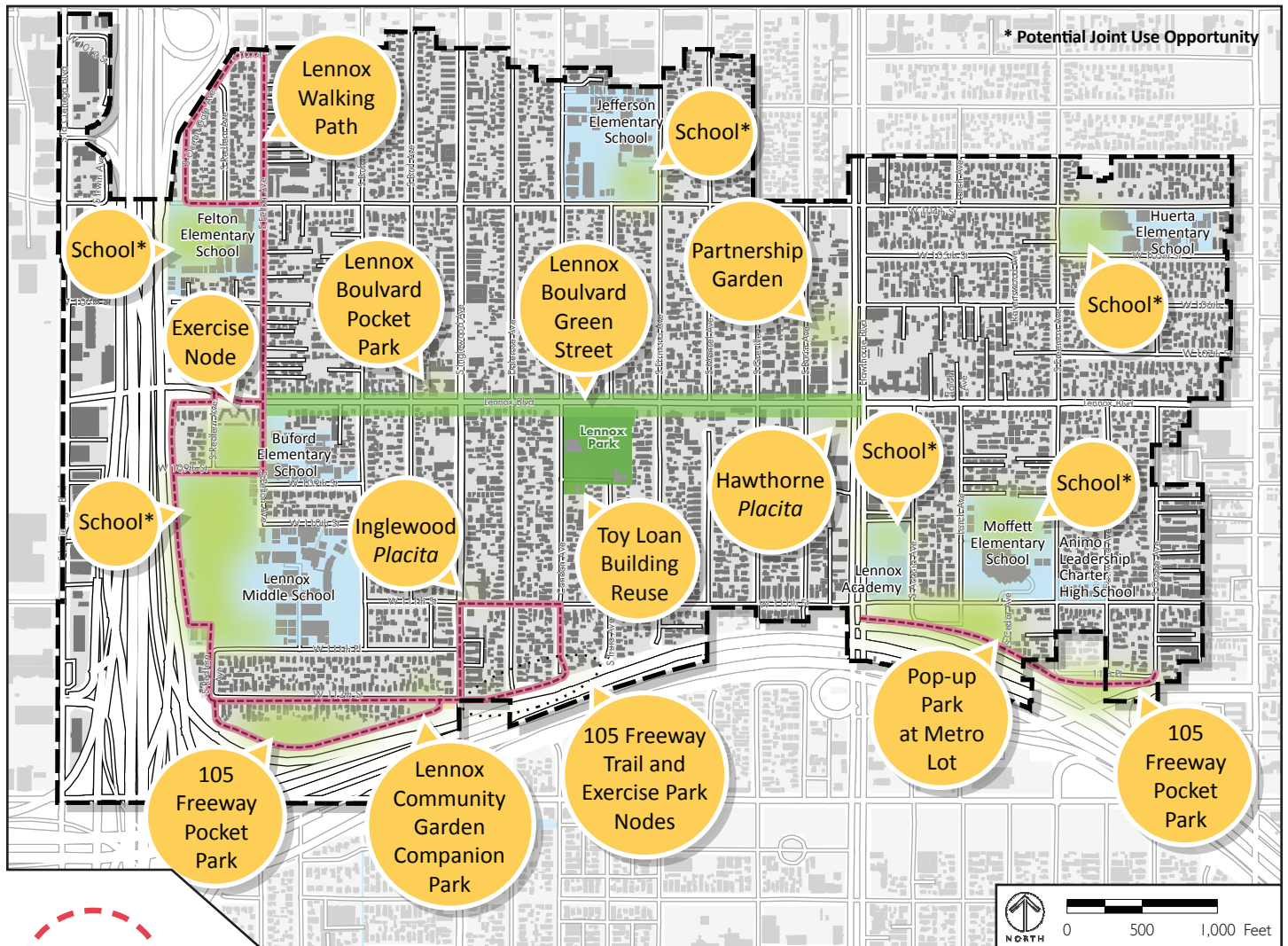

Site Identification Process

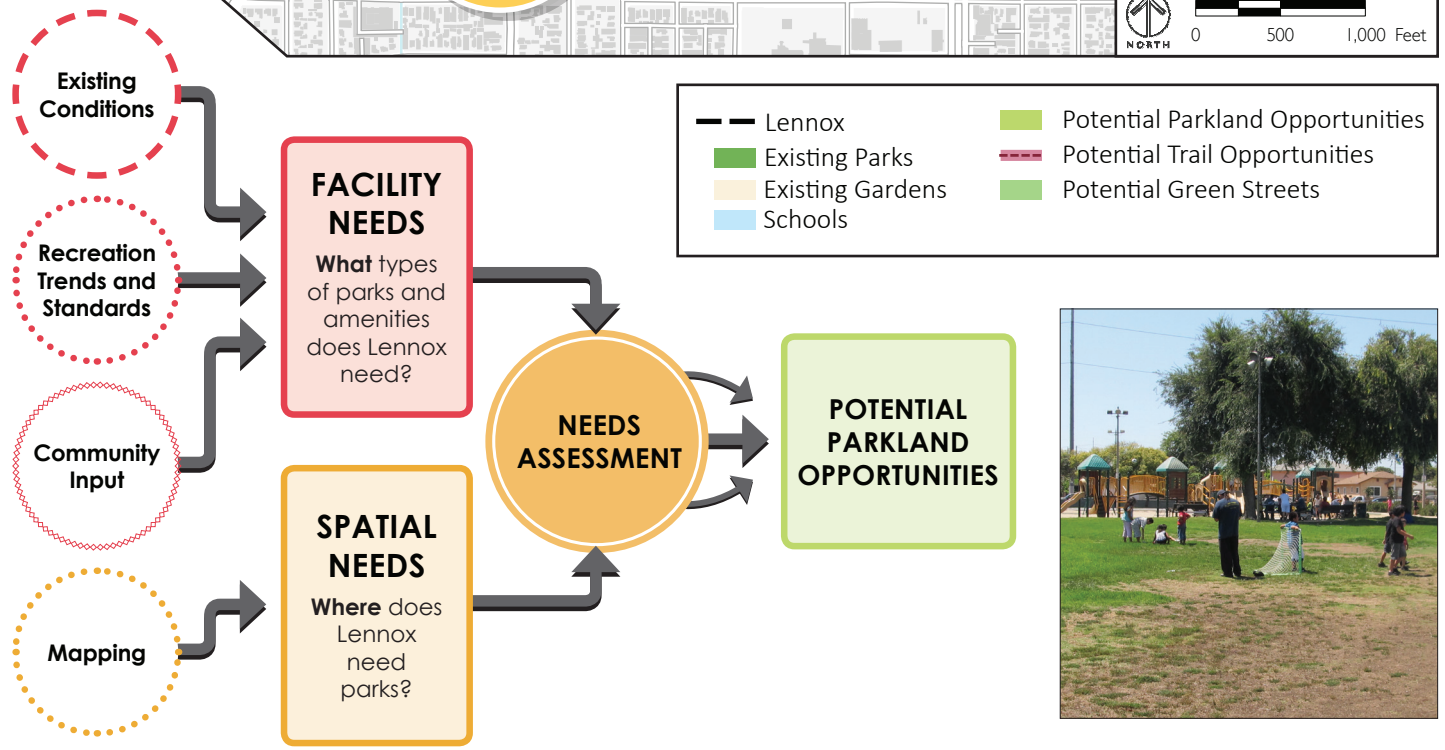

GOALS FOR LENNOX

1. Develop a working model with Lennox schools to formalize joint use.
2. Partner with community groups to develop small green spaces to fill the parkland gap.
3. Utilize “pop-up” interventions to create green space in the short term.
4. Ensure that facilities and programs meet community needs and that the community is included in decision-making processes.
5. Expand recreational opportunities within Lennox to include civic spaces that support community interaction, cultural identity, and commercial enterprise.
6. Increase the sense of nature within Lennox Park, future green spaces, and in the everyday lives of Lennox residents.
7. Maintain and enhance Lennox’s urban forest.
8. Focus on multi-benefit urban greening projects that optimize environmental services.
9. Create a community walking trail network along sidewalks, freeway buffers, and public land.

CONCEPTUAL PLACITA

Similar Projects



Leimert Park Village Plaza
Los Angeles, CA

Source: People Street; photo by LADOT/Jim Simmons



Bradley Avenue Plaza
Paicoma, Los Angeles, CA

Source: People Street; photo by LADOT/Jim Simmons

Conceptual Proposal for Lennox

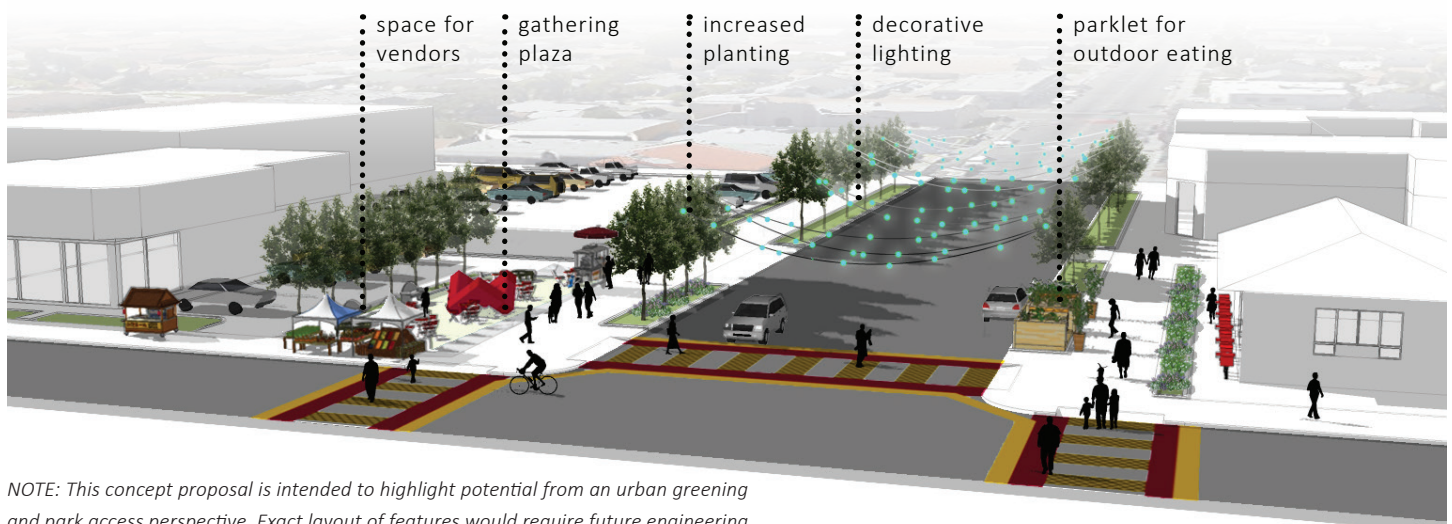

NOTE: This concept proposal is intended to highlight potential from an urban greening and park access perspective. Exact layout of features would require future engineering study and partnership with Los Angeles County Department of Public Works.

Service improvements

(with the addition of potential new parks)

Parkland Acres

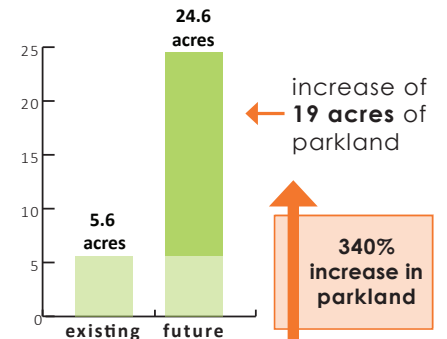

Total Population Served

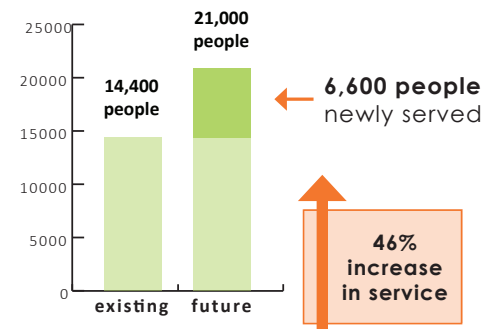

Youth Population (Under 18) Served

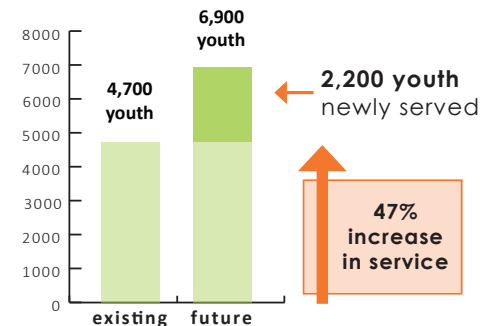

Graphs show improvements based on the addition of high priority park projects.

CONCEPTUAL FREEWAY POCKET PARK

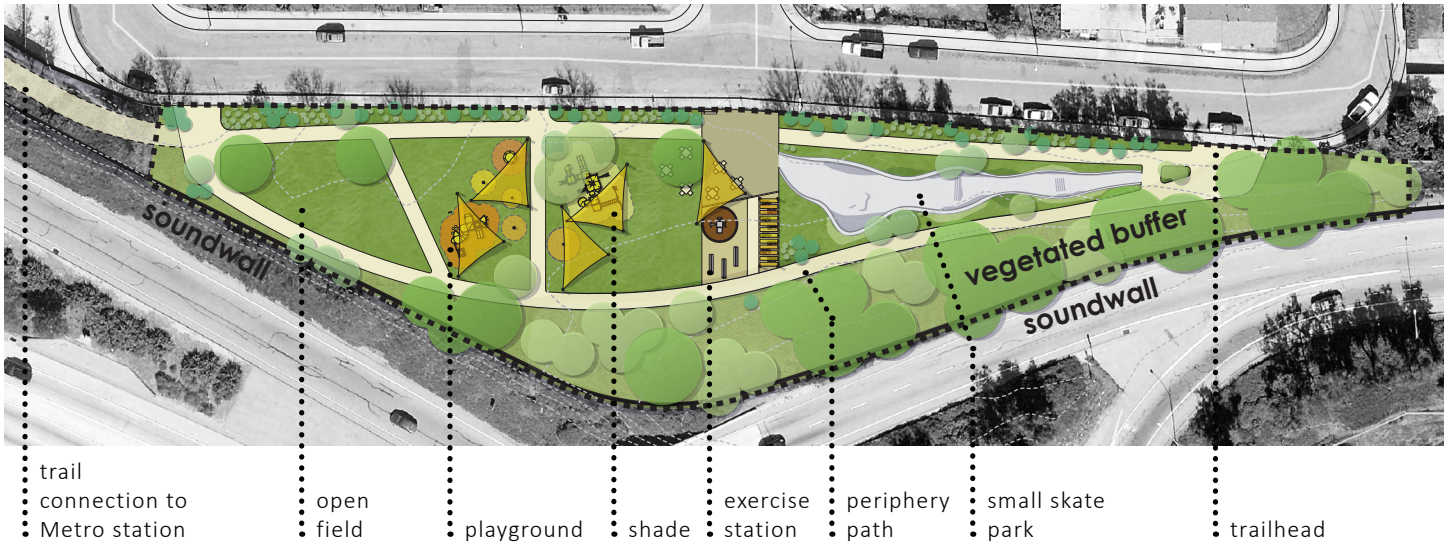

CONCEPTUAL POP-UP PARK AT LA METRO PARKING & RIDE LOT



Existing



Farmer's Market and Health Fair

Partner with healthy food activists to create a regular fresh produce market.



Night Market

Contract food trucks and performers for evening events.



Field Day

Bring in sports equipment, moveable equipment, and sod surfacing for active recreation.

LOS ANGELES
NEIGHBORHOOD
LAND TRUST

FROM LOT TO SPOT

PLACEWORKS



For more information, contact:

Clement Lau, AICP, Departmental Facilities Planner
County of Los Angeles Department of Parks and Recreation
Tel: (213) 351-5120; E-mail: clau@parks.lacounty.gov