

BOARD OF SUPERVISORS

Hilda L. Solis
First District

Holly J. Mitchell
Second District

Lindsey P. Horvath
Third District

Janice Hahn
Fourth District

Kathryn Barger
Fifth District



Chief Executive Office.

COUNTY OF LOS ANGELES

Kenneth Hahn Hall of Administration
500 West Temple Street, Room 713, Los Angeles, CA 90012
(213) 974-1101 ceo.lacounty.gov

Chief Executive Officer
Fesia A. Davenport

"To Enrich Lives Through Effective and Caring Service"

ADOPTED

BOARD OF SUPERVISORS
COUNTY OF LOS ANGELES

August 06, 2024

The Honorable Board of Supervisors
County of Los Angeles
383 Kenneth Hahn Hall of Administration
500 West Temple Street
Los Angeles, California 90012

111 August 6, 2024

Edward Yen
EDWARD YEN
EXECUTIVE OFFICER

Dear Supervisors:

**TEN-YEAR LEASE USING
COMMERCIAL PAPER NOTES TO FUND TENANT IMPROVEMENTS
DEPARTMENT OF MENTAL HEALTH
879 WEST 190TH STREET, SUITE 720, GARDENA
(SECOND DISTRICT) (3 VOTES)**

SUBJECT

Approval of a proposed new ten-year lease for 13,468 square feet of office space, and 56 on-site parking spaces for the Department of Mental Health's (DMH) Coastal Asian Pacific Islander Family Mental Health Center (API MHC) and authorization of the issuance of taxable commercial paper notes (Notes) through the Los Angeles County Capital Asset Leasing Corporation Lease Revenue Note Program (Note Program) to provide financing for the tenant improvement (TI) costs.

IT IS RECOMMENDED THAT THE BOARD:

1. Find that the proposed lease is exempt from the California Environmental Quality Act (CEQA) for the reasons stated in this Board letter and in the record of the project.
2. Find that the issuance of Notes through the Note Program to finance TI costs is not subject to CEQA because they are activities that are excluded from the definition of a project for the reasons stated in this Board letter and in the record of the project.
3. Authorize the Chief Executive Officer, or her designee, to execute the proposed lease with Omninet Pacific Pointe LP, a Delaware limited partnership (Landlord), for approximately 13,468 square feet of office space, and 56 on-site parking spaces located at 879 West 190th Street, Suite 720, Gardena (Premises) to be occupied by DMH. This proposes a lease for a term of ten years. The estimated maximum first year base rental cost is \$461,000, but with a two-month rent abatement

of about \$77,000, will be approximately \$384,000. The estimated total proposed lease cost is \$7,448,000 over the ten-year term. The rental costs will be funded 100 percent by State and Federal funds that is already included in DMH's existing budget. DMH will not be requesting additional net County cost for this action.

4. Authorize the Chief Executive Officer, or her designee, to reimburse the Landlord up to \$1,819,000 for the County's TI contribution, to be paid in lump sum.

5. To finance the County's TI contribution, establish TI Project No. 57255 for the lease at 879 West 190th Street, Gardena, CA, 90248.

6. Authorize the issuance of Notes through the Note Program in the amount not to exceed \$1,819,000 for the TI costs. Also, approve an amount not to exceed \$181,900 to be funded by the benefiting department, for interest due to the Landlord until County payment is received.

7. Authorize the Director of DMH, or her designee, to contract with and direct MCM Integrated, in coordination with the Chief Executive Officer, or her designee for the acquisition and installation of telephone, data, and low-voltage systems and vendor installation (Low-Voltage Items) at a total cost not to exceed \$425,000 paid in a lump sum. The cost for the Low-Voltage Items is in addition to the rental costs and the County's TI contribution payable to the Landlord.

8. Authorize and direct the Chief Executive Officer, or her designee, to execute any other ancillary documentation necessary to effectuate the terms of the proposed lease, and to take actions necessary and appropriate to implement the terms of the proposed lease, including, without limitation, exercising any early termination rights.

PURPOSE/JUSTIFICATION OF RECOMMENDED ACTION

DMH is currently co-located at 14112 South Kingsley Drive, Gardena with Aging & Disabilities' Senior Center and Adult Protective Services. All three programs have outgrown the current space. Once the programs have secured suitable alternate locations and are built out, the existing lease will be terminated because the existing location does not meet the needs of the programs.

DMH's Coastal API MHC is a directly operated outpatient mental health services program that provides direct, comprehensive, mental health services to the community, with a special focus on families and individuals with cultural and linguistic needs. Services provided include psychiatric evaluation and assessment, individual, group, and family therapy, medication management, case management, benefits establishment and crisis intervention. Other programs at this facility include the Full-Service Partnership Program and the Recovery, Resilience and Reintegration Services, both of which provide intensive, field based mental health services based on the acuity level of the clients' service need.

There are 60 DMH employees and clinicians plus four security guards assigned to the proposed Premises. This is a public-facing program and on-site coverage is needed to ensure the delivery of services. Approximately 100 clients visit the Premises each day for mental health services and medication appointments. Due to these in-person visits from patients who see clinicians, and the direct services provided at the facility, there are no immediate plans for teleworking or hoteling.

The proposed Premises was selected for its central location within DMH's service area, which has a high concentration of clients. The Premises easily accessible by public transportation routes such as

LA Metro, Gtrans (Gardena Transit), and Torrance Transit, and provides sufficient space and parking for DMH employees and clients.

Implementation of Strategic Plan Goals

The Countywide Strategic Plan North Star 1 – “Make Investments That Transform Lives” – provides that we will aggressively address society’s most complicated social, health, and public safety challenges. We want to be a highly responsive organization capable of responding to complex societal challenges – one person at a time.

The proposed lease is also consistent with Strategic Asset Management Goal – Strengthen connection between service priorities and asset decisions and Key Objective No. 4 – Guide Strategic Decision-Making.

The proposed lease supports the above goals and objective by providing DMH with the necessary office and clinic space to continue providing services within their service area.

The proposed lease conforms with the Asset Management Principles outlined in Enclosure A.

FISCAL IMPACT/FINANCING

The estimated maximum first year base rental cost is \$461,000 which includes 56 on-site parking spaces at no additional cost. The aggregate cost associated with the proposed lease over the entire term, including two months of rent abatement, TI costs, and Low-Voltage Items is \$7,448,000 as shown in Enclosure B. The proposed lease costs will be fully funded by State and Federal funds that is already included in DMH’s existing budget. DMH will not be requesting additional net County cost for this action.

Traditionally, the County borrows the TI dollars from the landlord at interest rates in the range of 9 to 10 percent. The Note Program serves as an alternative funding mechanism to finance the TI costs in place of the TI funding provided by the landlord. For budgetary and planning purposes, the County assumes an interest of 9 percent for the Note Program. However, the interest rate of the Notes will be based on the market conditions at the time of issuance. It is anticipated that the department can borrow the TI dollars at a lower rate than that offered by the landlord, and thereby achieve a cost savings.

The Note Program is a short-term financing program used by the County to provide the initial funding mechanism for construction and capital improvement projects. The Notes issued through the Note Program are short-term variable rate debt instruments and the interest rate is reflective of the market conditions at the time of issuance. Upon project completion and after occupancy of the leased spaces and reconciliation of project expenditures, Notes will be issued to remit for the TI costs.

The Notes will be issued to fund TI costs after completion of the TI project, tenant department takes occupancy of the leased space, and reconciliation of project expenditures. After the Landlord is reimbursed for the TI, DMH would begin to repay the Note costs, which include principal, interest, administrative fees, and insurance. The Notes will have a final repayment date not to exceed five years from the date of issuance and a minimum of 20 percent principal borrowing repayment is required annually. The redemption must be incorporated in DMH's annual budget. The Chief Executive Office (CEO) will coordinate with the tenant department to determine the amount of available cash to repay all or a portion of the outstanding Notes, and incorporate the planned

redemptions in the budget no later than May 15th of each year for redemption of the outstanding Notes to be completed by June 30th of each year.

The Note Program process involves the County making a lump sum payment to the landlord upon reconciliation of the final TI costs by use of a special fund, designated as J50. The J50 fund has been established to capture the TI expenditures exclusively related to the TIs funded by the Notes.

Should the Note Program be used to pay TIs, sufficient funds would be appropriated through the budget process in the TI project number under J50 to allow for the lump sum payment to the Landlord. Sufficient funds for the proposed lease and County TI reimbursement costs, including repayment amounts for the Note Program or repayment to the Landlord, as applicable, would be appropriated in the Rent Expense budget and will be billed back to DMH.

Subject to the proposed lease terms, there may be interest due to the Landlord until the County payment is received. Since this interest cost is not eligible to be financed under the Note Program, this interest cost will be paid by the Rent Expense budget and the costs will be disbursed to DMH.

The TIs for the proposed lease are expected to be completed in Fiscal Year 2025-26. Future funding for the rental costs and other costs associated with the proposed lease will be addressed through the annual budget process for DMH.

FACTS AND PROVISIONS/LEGAL REQUIREMENTS

In addition to the terms previously stated, the proposed lease also includes the following provisions:

- The annual rental rate will be \$34.20 per square foot, per year and is subject to annual increases based on the Consumer Price Index capped at 3 percent per annum.
- The Landlord has agreed to two months of rent abatement. DMH has the option to convert all or any portion of its rental abatement towards an increase in the base TI allowance.
- Total TI costs are expected to be \$2,492,000. The Landlord will provide \$673,400 (\$50 per square foot) base TI allowance.
- The County will reimburse the Landlord up to \$1,819,000 (\$135 per square foot) as the County's lump sum TI contribution.
- The County will pay up to \$425,000 for the lump sum cost of the Low-Voltage Items.
- The Landlord is responsible for all operating and maintenance costs of the building and all utilities and janitorial costs. The County has no responsibility for any operating and maintenance costs.
- There are 56 on-site parking spaces included in the base rent at no additional cost.
- A ten-year initial term with an option to extend the lease for an additional five years with nine months' prior written notice, at fair market rent. If all options are exercised, the total term of the proposed lease would be 15 years.
- The County has the right to terminate the proposed lease any time after 96 months, with 180 days' written notice subject to payment of a termination fee equal not to exceed \$178,000.

- Holdover at the proposed lease expiration is permitted on the same terms and conditions except the monthly base rent during the holdover period will be at the base rent at the time of the proposed lease expiration subject to the regular annual increases.
- The proposed lease was submitted for review to the Board's appointed Real Estate Management Commission on June 27, 2024, and was unanimously approved.
- The proposed lease will be effective upon approval by the Board and full execution of the proposed lease, but the term and rent will commence on the first day of the month, 30-days after substantial completion of the TIs by the Landlord and acceptance of the Premises by the County.

The CEO issued a flyer soliciting proposals for available space from landlords, brokers, and other owner representatives, for this space need, through the Board's Executive Office website and Real Estate's County website. None of the responses received were suitable for Department's needs due to insufficient parking and located outside the service area. The CEO conducted a market search of available office space for lease but was unable to identify any sites that could accommodate this requirement more economically. Based upon a review of available industry data, it has been established that the annual rental range for a comparable lease in the area is between \$36 and \$40.20 per square foot, per year. The base annual rental rate of \$34.20 per square foot, per year for the proposed lease represents a rate that is below the market range for the area. We were unable to identify any sites that could accommodate this requirement more economically. We recommend the proposed Premises as the most suitable to meet the County's space requirements.

Co-working office space is not suitable for this requirement due to the nature of services provided by DMH at this location.

Enclosure C shows all County-owned and leased facilities within the surveyed areas and there are no County-owned or leased facilities available for this space requirement.

The Department of Public Works has inspected the facility and found it suitable for County occupancy. Construction of the TIs will be completed in compliance with relevant building and construction laws and regulations, including the Americans with Disabilities Act. The required notification letter to the City of Gardena has been sent in accordance with Government Code Section 25351.

County Counsel has reviewed the enclosed proposed lease and has approved it as to form. The lease is authorized by Government Code Section 25351, which allows the County to enter into leases and agreements for the leasing of buildings, as necessary, to carry out the work of the county government.

The proposed lease will provide for a suitable office location for DMH's program(s), which is consistent with the County's Facility Location Policy, adopted by the Board on July 24, 2012, as outlined in Enclosure D.

ENVIRONMENTAL DOCUMENTATION

This project is exempt from CEQA, as specified in Class 1 of the Environmental Document Reporting Procedures and Guidelines adopted by the Board, and section 15301 of the State CEQA Guidelines (Existing Facilities). The proposed lease, which involves the leasing of existing office space with minor TIs within an existing building, with no expansion of the existing building, is within a class of

projects that have been determined not to have a significant effect on the environment and meets the criteria set forth in section 15301 of the State CEQA Guidelines (Guidelines), and Class 1 of the County's Environmental Document Reporting Procedures and Guidelines, Appendix G. In addition, based on the proposed project records, it will comply with all applicable regulations, and there are no cumulative impacts, unusual circumstances, damage to scenic highways, listing on hazardous waste site lists compiled, pursuant to Government Code Section 65962.5, or indications that it may cause a substantial adverse change in the significance of a historical resource that would make the exemption inapplicable.

Using the Note Program to finance the TIs is not subject to CEQA because they are activities that are excluded from the definition of a project by section 21065 of the Public Resources Code and section 15378 of the State CEQA Guidelines. The proposed action to establish TI project numbers and authorize the issuance of short-term Notes is organizational and an administrative activity of government that will not result in indirect or direct physical changes to the environment pursuant to section 15378(b)(5).

Upon the Board's approval of the recommended actions, a Notice of Exemption will be filed with the Registrar-Recorder/County Clerk in accordance with section 21152 of the California Public Resources Code.

IMPACT ON CURRENT SERVICES (OR PROJECTS)

The proposed lease will adequately provide the necessary office space, and parking spaces for this County requirement. DMH concurs with the proposed lease and recommendations.

Respectfully submitted,



FESIA A. DAVENPORT

Chief Executive Officer

FAD:JMN:JTC:JLC

HD:ANR:EG:gb

Enclosures

- c: Executive Office, Board of Supervisors
- County Counsel
- Auditor-Controller
- Internal Services
- Mental Health

**DEPARTMENT OF MENTAL HEALTH
879 WEST 190TH STREET, GARDENA**

Asset Management Principles Compliance Form¹

1.	<u>Occupancy</u>	Yes	No	N/A
A	Does lease consolidate administrative functions? ² This is a mental health center		X	
B	Does lease co-locate with other functions to better serve clients? ²	X		
C	Does this lease centralize business support functions? ²	X		
D	Does this lease meet the guideline of 200 sq. ft of space per person? ² 224 sq. ft per person (based on 60 staff); the premises provides for private interview rooms, conference rooms and a public lobby		X	
E	Does lease meet the 4/1000 sq. ft. parking ratio guideline? ² 56 space is a 4.16 parking ratio		X	
F	Does public parking and mass-transit exist to facilitate employee, client and visitor access to the proposed lease location? ²	X		
2.	<u>Capital</u>			
A	Is it a substantial net County cost (NCC) program)		X	
B	Is this a long-term County program?	X		
C	If yes to 2 A or B; is it a capital lease or an operating lease with an option to buy?		X	
D	If no, are there any suitable County-owned facilities available?		X	
E	If yes, why is lease being recommended over occupancy in County-owned space?			X
F	Is Building Description Report enclosed as Enclosure C?			X
G	Was build-to-suit or capital project considered? ²			X
3.	<u>Portfolio Management</u>			
A	Did department use CEO Space Request Evaluation (SRE)?	X		
B	Was the space need justified?	X		
C	If a renewal lease, was co-location with other County departments considered?			X
D	Why was this program not co-located?			
	1. ____ The program clientele requires a "stand alone" facility.			
	2. <u> X </u> No suitable County occupied properties in project area.			
	3. <u> X </u> No County-owned facilities available for the project.			
	4. ____ Could not get City clearance or approval.			
	5. ____ The Program is being co-located.			
E	Is lease a full-service lease? ²	X		
F	Has growth projection been considered in space request?	X		
G	¹ Has the Dept. of Public Works completed seismic review/approval?	X		
¹ As adopted by the Board of Supervisors 11/17/98				
² If not, why not?				

OVERVIEW OF THE PROPOSED BUDGETED LEASE COSTS

879 W. 190th St., Gardena
Department of Mental Health

Basic Lease Assumptions

Leased Area (sq. ft.)	13,468
	Per RSF
	Per Month (\$)
Base Rent	\$2.85
	Per RSF
	Per Year (\$)
Term	120 months/10 years
Annual Rent Adjustments	3.00%
	Lump Sum
Tenant Improvement Costs- Reimbursable	\$1,818,180
	Lump Sum
Low Voltage Costs	\$425,000

	1 st Year	2 nd Year	3 rd Year	4 th Year	5 th Year	6 th Year	7 th Year	8 th Year	9 th Year	10 th Year	Total 10 Year Rental Costs
Annual Base Rent Costs ¹	\$460,606	\$474,424	\$488,656	\$503,316	\$518,416	\$533,968	\$549,987	\$566,487	\$583,481	\$600,986	\$5,280,000
Rent Abatement ²	(\$76,768)										(\$77,000)
Tenant Improvement Costs- Reimbursable	\$1,819,000										\$1,819,000
Total Costs Paid to Landlord	\$2,202,838	\$474,424	\$488,656	\$503,316	\$518,416	\$533,968	\$549,987	\$566,487	\$583,481	\$600,986	\$7,023,000
Low Voltage Costs	\$425,000										\$425,000
Total Annual Lease Costs	\$2,627,838	\$474,424	\$488,656	\$503,316	\$518,416	\$533,968	\$549,987	\$566,487	\$583,481	\$600,986	\$7,448,000

¹ Base Rent subject to Consumer Price Index (CPI) increases with a cap of 3 percent per annum.

² Tenant shall have 2 months of Rent Abatement.

***Calculation note: All numbers are rounded up to ensure sufficient funds available to pay the specified expense.**

**DEPARTMENT OF MENTAL HEALTH
SPACE SEARCH – 5 MILE RADIUS
879 WEST 190TH STREET, GARDENA**

Name	Address	OwnershipType
Harbor-F-9 Trailer (Annex)	1000 W Carson St. Torrance 90502	Owned
Harbor-N-16	1000 W Carson St. Torrance 90502	Owned
Harbor-D-5 Annex	1000 W Carson St. Torrance 90502	Owned
Harbor-N-33 Annex	1000 W Carson St. Torrance 90502	Owned
Harbor-D-4.5	1000 W Carson St. Torrance 90502	Owned
Animal Control #3 - Administration Building	216 W Victoria St. Carson 90248	Owned
Harbor-F-4.5	1000 W Carson St. Torrance 90502	Owned
Harbor-D-2.5	1000 W Carson St. Torrance 90502	Owned
Harbor-N-21	1000 W Carson St. Torrance 90502	Owned
Harbor - Public Health Programs Building N - 22	1000 W Carson St. Torrance 90502	Owned
Harbor - Medical Records Office F - 8	1000 W Carson St. Torrance 90502	Owned
Harbor-J-4	1000 W Carson St. Torrance 90502	Owned
Harbor-N-33	1000 W Carson St. Torrance 90502	Owned
Harbor-D-5.5	1000 W Carson St. Torrance 90502	Owned
DMH - Wellness Center	21732 S Vermont Ave, Torrance 90502	Leased
Harbor-D-3.5	1000 W Carson St. Torrance 90502	Owned
Harbor - REI Administration Building N - 14	1124 W Carson St. Torrance 90502	Owned

FACILITY LOCATION POLICY ANALYSIS

Proposed lease: Lease for the Department of Mental Health – 879 West 190th Street, Suite 720, Gardena – Second District.

A. Establish Service Function Category – DMH provides direct, comprehensive mental health services to families and individuals.

B. Determination of the Service Area – Need for services within the South Bay region of the County.

C. Apply Location Selection Criteria to Service Area Data

- Need for proximity to service area and population: Continued need for operation in the South Bay region of the County for DMH programs.
- Need for proximity to existing County facilities: N/A
- Need for proximity to Los Angeles Civic Center: N/A
- Economic Development Potential: N/A
- Proximity to public transportation: The location is adequately served by local transit services, i.e., LA Metro local bus routes, Gtrans (Gardena Transit), and the Torrance Transit line. The site is located within 0.5 miles of the 110 freeway and the 405 freeway.
- Availability of affordable housing for County employees: The surrounding area provides for affordable housing and rental opportunities.
- Use of historic buildings: N/A
- Availability and compatibility of existing buildings: There are no alternative existing County buildings available to meet DMH's needs.
- Compatibility with local land use plans: The City of Gardena has been notified of the proposed County use which is consistent with its use and zoning for office space at this location.
- Estimated acquisition/construction and ongoing operational costs: The aggregate cost associated with the proposed lease over the entire term is \$7,448,000.

D. Analyze results and identify location alternatives

Based upon a review of available industry data, it has been established that the annual rental range for a comparable lease in the area is between \$36 and \$40.20 per square foot, per year. The base annual rental rate of \$34.20 per square foot, per year for the proposed lease represents a rate that is below the market range for the area. We were unable to identify any sites that could accommodate this requirement more economically. We recommend the proposed Premises as the most suitable to meet the County's space requirements.

E. Determine benefits and drawbacks of each alternative based upon functional needs, service area, cost, and other Location Selection Criteria

The proposed lease will provide adequate and efficient office space for 60 employees and clients consistent with the County's Facility Location Policy, adopted by the Board on July 24, 2012.

**COUNTY OF LOS ANGELES
CHIEF EXECUTIVE OFFICE**

LEASE AGREEMENT

**COUNTY OF LOS ANGELES - Tenant
OMNINET PACIFIC POINTE LP – Landlord**

**879 WEST 190TH STREET, SUITE 720
GARDENA, CALIFORNIA 90248**

TABLE OF CONTENTS

	Page
1. BASIC LEASE INFORMATION	1
1.1 Terms	1
1.2 Defined Terms Relating to Landlord's Work Letter	3
1.3 Exhibits to Lease.....	4
2. PREMISES.....	4
2.1 Lease of Premises	4
2.2 Measurement of Premises	4
3. COMMON AREAS.....	5
4. COMMENCEMENT AND EXPIRATION DATES	5
4.1 Term	5
4.2 Termination Right for Delay of Commencement Date	6
4.3 Early Entry	6
4.4 Early Termination as of the Early Termination Date	6
5. RENT	6
5.1 Base Rent.....	6
5.2 Method of Payment and Required Information	7
5.3 Rental Abatement	7
5.4 Base Rent Adjustments.....	7
6. USES	8
7. HOLDOVER	8
8. COMPLIANCE WITH LAW	8
9. DAMAGE OR DESTRUCTION	9
9.1 Damage	9
9.2 Tenant Termination Right.....	9
9.3 Damage In Last Year	9
9.4 Default By Landlord	10
10. REPAIRS AND MAINTENANCE	10
10.1 Landlord Representations	10
10.2 Landlord Obligations	12
10.3 Tenant Obligations.....	13
10.4 Tenant's Right to Repair	13
11. SERVICES AND UTILITIES	14
11.1 Services.....	14
12. TAXES	16
13. LANDLORD ACCESS	16
14. TENANT DEFAULT	16
14.1 Default	16
14.2 Termination.....	17
14.3 No Effect on Indemnity.....	17
15. LANDLORD DEFAULT	17
15.1 Remedies	17
15.2 Waiver	17
15.3 Emergency.....	18
15.4 Limitation of Liability.....	18
16. ASSIGNMENT AND SUBLETTING	18
16.1 Assignment and Subletting	18
16.2 Sale	18

17.	ALTERATIONS AND ADDITIONS.....	19
	17.1 Landlord Consent.....	19
	17.2 End of Term.....	19
18.	CONDEMNATION.....	20
	18.1 Controlling Terms.....	20
	18.2 Total Taking.....	20
	18.3 Partial Taking.....	20
	18.4 Restoration.....	21
	18.5 Award.....	21
	18.6 Waiver of Statute.....	21
19.	INDEMNIFICATION.....	21
	19.1 Landlord's Indemnity.....	21
	19.2 Tenant's Indemnity.....	21
20.	INSURANCE.....	21
	20.1 Waiver.....	21
	20.2 General Insurance Provisions – Landlord Requirements.....	21
	20.3 Insurance Coverage Types And Limits.....	24
	20.4 Landlord Requirements.....	25
21.	PARKING.....	25
	21.1 Tenant's Rights.....	25
	21.2 Remedies.....	26
22.	ENVIRONMENTAL MATTERS.....	26
	22.1 Hazardous Materials.....	26
	22.2 Landlord Indemnity.....	27
23.	ESTOPPEL CERTIFICATES.....	27
24.	TENANT IMPROVEMENTS.....	27
25.	LIENS.....	28
26.	SUBORDINATION AND MORTGAGES.....	28
	26.1 Subordination and Non-Disturbance.....	28
	26.2 Existing Deeds of Trust.....	28
	26.3 Notice of Default.....	28
27.	SURRENDER OF POSSESSION.....	28
28.	SIGNAGE.....	28
29.	QUIET ENJOYMENT.....	29
30.	GENERAL.....	29
	30.1 Headings.....	29
	30.2 Successors and Assigns.....	29
	30.3 Brokers.....	29
	30.4 Entire Agreement.....	29
	30.5 Severability.....	29
	30.6 Notices.....	30
	30.7 Governing Law and Venue.....	30
	30.8 Waivers.....	30
	30.9 Time of Essence.....	30
	30.10 Consent.....	30
	30.11 Community Business Enterprises.....	30
	30.12 Memorandum of Lease.....	30
	30.13 Counterparts; Electronic Signatures.....	31
31.	AUTHORITY.....	31
32.	ACKNOWLEDGEMENT BY LANDLORD.....	32
	32.1 Consideration of GAIN Program Participants.....	32

32.2	Solicitation of Consideration.....	32
32.3	Landlord Assignment	32
32.4	Smoking in County Facilities.	34
33.	IRREVOCABLE OFFER.....	34
34.	OPTION TO EXTEND	35

EXHIBITS

- Exhibit A – Floor Plan of the Premises
- Exhibit B – Commencement Date Memorandum and Confirmation of Lease Terms
- Exhibit C – Heating, Ventilation, and Air Conditioning Standards
- Exhibit D – Cleaning and Maintenance Schedule
- Exhibit E – Subordination, Non-disturbance and Attornment Agreement
- Exhibit F – Tenant Estoppel Certificate
- Exhibit G – Community Business Enterprises Form
- Exhibit H – Memorandum of Lease Terms
- Exhibit I – Landlord's Work Letter

COUNTY OF LOS ANGELES
CHIEF EXECUTIVE OFFICE

LEASE AGREEMENT

This LEASE AGREEMENT ("Lease") is entered into as of the _____ day of _____, 20__ between Omninet Pacific Pointe LP, a Delaware Limited Partnership ("Landlord"), and COUNTY OF LOS ANGELES, a body corporate and politic ("Tenant" or "County").

Landlord and Tenant agree:

1. BASIC LEASE INFORMATION

1.1 Terms

The following terms as used herein shall have the meanings provided in this Section 1, unless otherwise specifically modified by provisions of this Lease:

<p>(a) Landlord's Address for Notices:</p>	<p>OMNINET PACIFIC POINTE, LP 9420 Wilshire Blvd, Fourth Floor Beverly Hills, CA 90212 Attention: Michael Danielpour Email: Michael@omninet.com</p> <p>With a copy to:</p> <p>Omninet Property Management, Inc. 9420 Wilshire Blvd, Fourth Floor Beverly Hills, CA 90212 Attention: Commercial Operations Email: maryr@omninet.com</p>
<p>(b) Tenant's Address for Notices:</p>	<p>County of Los Angeles Chief Executive Office - Real Estate Division 320 West Temple Street, 7th Floor Los Angeles, CA 90012 Attention: Director of Real Estate</p> <p>With a copy to:</p> <p>County of Los Angeles Office of the County Counsel 648 Kenneth Hahn Hall of Administration 500 West Temple Street, Suite 648 Los Angeles, CA 90012-2713 Attention: Property Division</p>
<p>(c) Premises:</p>	<p>Approximately 13,468 rentable square feet, designated as Suite 720, in the Building</p>

	(defined below) ("Premises"), as shown on <u>Exhibit A</u> attached hereto.
(d) Building:	The Building located at 879 West 190 th Street, Gardena, California 90248, which is currently assessed by the County Assessor as APN 6121-021-007, 6121-021-008, and 6121-021-021 (collectively, the "Property");
(e) Term:	Ten (10) years, commencing on the first day of the month following thirty (30) days after the date of Tenant's Acceptance of the Premises, as defined in Section 4.1 (the "Commencement Date"), and terminating at midnight on the day before the 10 th annual anniversary of the Commencement Date (the "Termination Date"), subject to earlier termination by Tenant as provided herein. The phrase "Term of this Lease" or "the Term hereof" as used in this Lease, or words of similar import, shall refer to the initial Term of this Lease together with any additional Extension Term for which an option has been validly exercised.
(f) Estimated Commencement Date:	June 1, 2025
(g) Irrevocable Offer Expiration Date: (see Section 33)	September 1, 2024
(h) Base Rent:	\$2.85 per rentable square foot per month (i.e., \$38,383.80 per month or \$460,605.60 per year) and subject to annual adjustments as described in Section 5.3 below
(i) Early Termination Date (see Section 4.4)	Provided that Tenant is not then in default under this Lease, Tenant will have the one-time right to terminate this Lease upon delivering at least One Hundred and Eighty (180) days' prior written notice to Landlord at any time after the 8 th annual anniversary of the Commencement Date of this Lease, subject to Tenant paying the unamortized portion of the Landlord's TI Allowance on an interest rate of seven and one-half percent (7.5%) per annum. Such right may be exercised by Tenant on one hundred and eighty (180) days' prior written

	notice to Landlord and Tenant's compliance with the terms of Section 4.4 herein.
(j) Rentable Square Feet	13,468 Rentable Square Feet
(k) Initial Departmental Use:	Department of Mental Health with public intake, subject to Section 6.
(l) Parking Spaces:	56 unreserved parking spaces (i.e., 4.1 parking spaces/1,000 RSF) located in the Building's parking lot at no additional cost to the Tenant.
(m) Tenant's Hours of Operation:	6 a.m. to 8 p.m. Monday through Friday, and 9 a.m. to 1 p.m. on Saturdays
(n) Asbestos Report:	A report dated January 17, 2022 prepared by Hart Laboratory, Inc. a licensed California Asbestos contractor.
(o) Seismic Report	A report dated April 29, 2022 prepared by IDS Group.
(p) Disabled Access Survey	Those two (2) reports dated December 4, 2023 and prepared by CASp Experts LLC.

1.2 Defined Terms Relating to Landlord's Work Letter

(a) Landlord's TI Allowance:	\$673,400.00 (i.e., \$50.00 per rentable square foot of the Premises)
(b) Tenant's TI Contribution:	\$1,818,180.00 (i.e., \$135.00 per rentable square foot of the Premises)
(c) Tenant's TI Contribution Amortization Rate and Change Authorization Amortization Rate:	Not applicable
(d) Estimated Monthly Payments Attributable to Total TI Costs in Excess of Landlord's TI Allowance	Not applicable

(e) Tenant's Work Letter Representative:	An assigned staff person of the Chief Executive Office - Real Estate Division
(f) Landlord's Work Letter Representative:	William Molina or an assigned person of the Landlord
(g) Landlord's Address for Work Letter Notices:	Omninet Pacific Pointe, LP 9420 Wilshire Blvd, Fourth Floor Beverly Hills, CA 90212 Attention: Michael Danielpour With a copy to: Omninet Property Management, Inc. 9420 Wilshire Blvd, Fourth Floor Beverly Hills, CA 90212 Attention: Commercial Operations
(h) Tenant's Address for Work Letter Notices:	County of Los Angeles Chief Executive Office - Real Estate Division 320 West Temple Street, 7th Floor Los Angeles, CA 90012 Attention: Director of Real Estate
1.3 <u>Exhibits to Lease</u>	Exhibit A - Floor Plan of Premises Exhibit B - Commencement Date Memorandum and Confirmation of Lease Terms Exhibit C - HVAC Standards Exhibit D - Cleaning and Maintenance Schedule Exhibit E - Subordination, Non-Disturbance and Attornment Agreement Exhibit F - Tenant Estoppel Certificate Exhibit G - Community Business Enterprises Form Exhibit H - Memorandum of Lease Exhibit I - Landlord's Work Letter

2. PREMISES

2.1 Lease of Premises

Landlord does hereby lease to Tenant, and Tenant does hereby lease from Landlord, upon the terms and conditions herein set forth, the Premises described in Section 1.1 and depicted on Exhibit A attached hereto.

2.2 Measurement of Premises

Tenant shall have the right at any time prior to the Commencement Date of the Term of this Lease to field-measure and verify the exact footage of the Premises

and/or the Building. All measurements shall be taken in accordance with the methods of measuring rentable area as described in the Standard Method for Measuring Floor Area in Office Buildings, ANSI/BOMA Z65.1-2017, Method A, as promulgated by the Building Owners and Management Association ("BOMA") International, except that no penthouse mechanical room space shall be included in the measurement. A copy of such measurement report shall be delivered to Landlord. Landlord and Tenant hereby agree there will be no modification made to the Base Rent if the remeasured square footage exceeds or is less than the amount set forth in Section 1.1(c) above.

3. COMMON AREAS

Tenant may use the following areas ("Common Areas") in common with Landlord and any other tenants of the Building: the entrances, lobbies, corridors and other public areas of the Building, walkways, landscaped areas, driveways necessary for access to the Premises, parking areas and other common facilities designated by Landlord from time to time for common use of all tenants of the Building. Tenant shall comply with all reasonable, non-discriminatory rules and regulations regarding the use of the Common Area established by Landlord.

4. COMMENCEMENT AND EXPIRATION DATES

4.1 Term

The Term of this Lease shall commence upon the Commencement Date and terminate on the Termination Date. Within thirty (30) days of determining the Commencement Date, Landlord and Tenant shall acknowledge in writing the Commencement Date by executing a Commencement Date Memorandum and Confirmation of Lease Terms in the form attached hereto as Exhibit B. The term "Tenant's Acceptance of the Premises" as used in this Lease shall mean the date upon which the Tenant Improvements and the Premises are Substantially Complete, Tenant has inspected the Premises, and Tenant has accepted the Tenant Improvements and the Premises in writing. The terms "Substantial Completion" or "Substantially Complete" as used in this Lease shall mean compliance with all of the following:

- (a) The shell and core of the Building are complete and in compliance with all applicable laws and codes, and all of the building systems are operational to the extent necessary to service the Premises;
- (b) Landlord has sufficiently completed all the work required to be performed by Landlord in accordance with this Lease and Landlord's Work Letter (if any), including the installation of modular furniture systems, if so required (except minor punch list items which Landlord shall thereafter promptly complete), such that Tenant can conduct normal business operations from the Premises. Notwithstanding any contrary provision contained herein, the completion of the installation of Tenant's data (e.g., computer), telecom, telephone equipment and low voltage wiring and any other work which is Tenant's responsibility under this Lease (as opposed to Landlord's obligation) shall not be a condition precedent to the occurrence of Substantial Completion.

- (c) Landlord has obtained a certificate of occupancy for the Building, or a temporary certificate of occupancy for that portion of the Building that includes all of the Premises, or its equivalent;
- (d) Tenant has been provided with the number of parking privileges and spaces to which it is entitled under this Lease; and

4.2 Termination Right For Delay of Commencement Date

If the Commencement Date has not occurred within two hundred seventy (270) days following the date of Landlord's receipt of the final governmental building permits granting Landlord the right to perform the Tenant Improvements in the Premises, subject to extension for Tenant Delay(s) and/or Force Majeure Delays, and/or Change Authorizations, as provided in Landlord's Work Letter executed concurrently herewith, then Tenant may thereafter, at any time before the Commencement Date occurs, terminate this Lease effective upon the giving of at least ninety (90) days prior written notice to Landlord, and the parties shall have no further rights or obligations to one another hereunder.

4.3 Early Entry

Tenant shall be entitled to enter the Premises not less than thirty (30) days prior to the Commencement Date for the purpose of installing Tenant's furniture, fixtures, and equipment in the Premises. Such early entry shall be subject to all provisions hereof, but shall not advance the Termination Date, and Tenant shall not pay Base Rent nor any other charges for such early entry period until the occurrence of the Commencement Date. Further, Tenant's early entry right is subject to Tenant not interfering with the completion of the Tenant Improvements in the Premises.

4.4 Early Termination as of the Early Termination Date

Tenant shall have the right to terminate this Lease at any time after the Early Termination Date specified in Section 1.1, by giving Landlord not less than one hundred and eighty days (180) days prior written notice, executed by Tenant's Chief Executive Officer or his/her designee. In the event Tenant terminates this Lease pursuant to this Section 4.4, Tenant shall pay Landlord the unamortized portion of the Landlord's TI Allowance with interest calculated at seven and one-half percent (7.5%) per annum. Such payment shall be made within thirty (30) days following the Early Termination Date and shall not exceed an amount equal to \$177,631.83.

4.5 Intentionally Omitted

5. RENT

5.1 Base Rent

Tenant shall pay Landlord the Base Rent stated in Section 1.1 during the Term hereof within fifteen (15) days after (a) the Commencement Date, and (b) the first day of each calendar month thereafter, provided that at least 15 business days prior to the Commencement Date, Landlord must provide the Auditor-Controller (A-C) of the County of Los Angeles with the following information: (i) name and address of Landlord or other party to whom Base Rent should be paid, (ii)

Landlord's federal tax ID number; (iii) name of contact person and contact information (including phone number) for Landlord; (iv) a completed IRS form W-9, and (v) evidence of insurance in compliance with Section 20.2. If Landlord fails to timely provide the information required pursuant to this Section 5.1, or to provide updates for any changed information, then Tenant shall not be required to pay Base Rent to Landlord until fifteen (15) business days after Landlord provides such information. Base Rent for any partial calendar month during the Term shall be prorated in proportion to the number of days during the Term within such calendar month.

5.2 Method of Payment and Required Information

The Tenant may, at its sole discretion, determine the most appropriate, efficient, secure, and timely form of payment for any amounts due under this Lease. Landlord further agrees that the default form of payment shall be Electronic Funds Transfer (EFT) or direct deposit, unless an alternative method of payment is deemed appropriate by the Auditor-Controller (A-C).

Subject to Section 5.1, the Landlord shall provide the A-C with electronic banking and related information for the Landlord and/or any other payee that the Landlord designates to receive payment pursuant to this Lease. Such electronic banking and related information includes, but is not limited to: bank account number and routing number, legal business name, valid taxpayer identification number or TIN, a working e-mail address capable of receiving remittance advices and other payment related correspondence, and any other information that the A-C determines is reasonably necessary to process the payment and comply with all accounting, record keeping, and tax reporting requirements.

Any provision of law, grant, or funding agreement requiring a specific form or method of payment other than EFT or direct deposit shall supersede this requirement with respect to those payments. Upon the Commencement Date or at any time during the duration of the Lease, a Landlord may submit a written request for an exemption to this requirement. Such request must be based on specific legal, business or operational needs and explain why the payment method designated by the A-C is not feasible and an alternative is necessary. The A-C, in consultation with the contracting department(s), shall decide whether to approve exemption requests.

5.3 Rent Abatement

The first (1st) and second (2nd) months Base Rent due for the Premises shall be abated following the Commencement Date as provided herein. Tenant shall have the option to convert all or any portion of its Rent Abatement toward an increase in the Landlord's TI Allowance by delivering written notice to Landlord prior to the Commencement Date.

5.3. Base Rent Adjustments

(a) CPI. From and after the 1st anniversary of the Commencement Date, on the first day of the first full calendar month thereafter (the "Adjustment Date") and on every anniversary of the Adjustment Date thereafter, Base Rent shall be adjusted by applying the CPI Formula set forth below. The "Base Index" shall be the Index published for the month the Lease commences.

(b) CPI Formula. The Index means the Consumer Price Index for all Urban Consumers for the Los Angeles-Long Beach-Anaheim area, all items, published by the United States Department of Labor, Bureau of Labor Statistics (1982-84=100). The "CPI Formula" means Base Rent for the first full month after the Commencement Date multiplied by a fraction, the numerator being the Index published for the month immediately preceding the month in which the adjustment is to be effective (the "New Index"), and the denominator being the Base Index. If the Index is changed so that the Index differs from that used as of the Commencement Date of the Lease, the Index shall be converted in accordance with the conversion factor published by the United States Department of Labor, Bureau of Labor Statistics. If the Index is discontinued or revised during the Term of this Lease, such other governmental Index or computation with which it is replaced shall be used in order to obtain substantially the same results as would be obtained if the Index had not been discontinued or revised.

(c) Illustration of Formula. The formula for determining the Adjusted Base Rent shall be as follows:

$$\frac{\text{New Index}}{\text{Base Index}} \times \text{Base Rent at the Commencement Date} = \text{Adjusted Base Rent}$$

(d) Limitations on CPI Adjustment. In no event shall the monthly Base Rent adjustment based upon the CPI Formula result in an increase greater than three percent (3%) per year of the Base Rent payable in the month preceding the applicable adjustment. In no event shall the Base Rent be adjusted by the CPI Formula to result in a lower monthly Base Rent than was payable during the previous year of the Lease.

6. USES

Landlord agrees that the demised Premises, together with all appurtenances thereto, shall be used by the Tenant for the government department set forth in Section 1.1, any other County Department the County designates, for any other governmental purposes, or other lawful purposes that do not materially adversely interfere with other uses in the Building, during Tenant's Hours of Operation, after Tenant's Hours of Operation, and on weekends and holidays.

7. HOLDOVER

If Tenant remains in possession of the Premises or any part thereof after the expiration of the term of this Lease, such occupancy shall be a tenancy which is terminable only upon ninety (90) days written notice from Landlord or thirty (30) days written notice from Tenant's Chief Executive Officer or his/her designee at the last monthly Base Rent payable under this Lease, plus any other charges payable under this Lease, and subject to all of the terms, covenants, and conditions of this Lease. If Landlord delivers a termination notice to Tenant as provided herein and Tenant fails to surrender the Premises to Landlord by the expiration of such ninety (90) day period, then no additional notice is required from Landlord prior to initiating legal proceedings.

8. COMPLIANCE WITH LAW

Tenant shall, at Tenant's expense, comply promptly with all applicable statutes, ordinances, rules, regulations, orders and requirements in effect during the term hereof regulating the use, occupancy or improvement of the Premises by Tenant. Landlord, not Tenant, shall, at its sole cost, at all times cause the Premises and the Building to comply with all applicable statutes, ordinances, rules, regulations, orders and requirements in

effect and binding upon Tenant or Landlord during the term hereof, including but not limited to the Americans with Disabilities Act ("ADA"), except if such compliance is made necessary as a result of Tenant's particular use of or alterations or improvements to the Premises.

9. DAMAGE OR DESTRUCTION

9.1 Damage

If any portion of the Premises is damaged by fire or any other cause rendering the Premises totally or partially inaccessible or unusable, and the Premises may be restored to a complete architectural unit of equivalent value, condition and character that existed immediately prior to such casualty in less than one hundred eighty (180) days, then Landlord shall promptly, at Landlord's expense, repair such damage, and this Lease shall continue in full force and effect. If all or any portion of the Premises shall be made unusable by fire or other casualty, Landlord shall immediately secure the area to prevent injury to persons and/or vandalism to the improvements. Landlord shall promptly, but in any event within fifteen (15) days, cause an architect or general contractor selected by Landlord to provide Landlord and Tenant with a written estimate of the amount of time required to substantially complete the repair and restoration of the Premises and make the Premises leasable again using standard working methods. The failure to do so shall be a material default hereunder. Base Rent shall abate to the extent that the Premises are unusable by Tenant.

9.2 Tenant Termination Right

If any portion of the Premises is damaged by fire or any other cause rendering the Premises totally or partially inaccessible or unusable, and the Premises will not be restored to a complete architectural unit of equivalent value, condition and character that existed immediately prior to such casualty in less than one hundred eighty (180) days for any reason, then Tenant may terminate this Lease by giving Landlord written notice within ten (10) days after Tenant's receipt of written notice from Landlord or its agents specifying such time period of repair; and this Lease shall terminate and the Base Rent shall be abated from the date the Premises became unusable. If Tenant does not elect to terminate this Lease, then Landlord shall promptly commence and diligently prosecute to completion the repairs to the Building or Premises, provided that insurance proceeds are available to repair the damages.

9.3 Damage In Last Year

Notwithstanding the foregoing provisions, if any material destruction to the Premises occurs during the last year of the Term, then either Landlord or Tenant may terminate this Lease by giving written notice to the other not more than thirty (30) days after such destruction, in which case:

- (a) Landlord shall have no obligation to restore the Premises;
- (b) Landlord may retain all insurance proceeds relating to such destruction, and

- (c) This Lease shall terminate as of the date which is thirty (30) days after such written notice of termination.

9.4 Default By Landlord

If Landlord is required to repair and restore the Premises as provided for in this Section 9, and Landlord thereafter fails to diligently prosecute said repair and restoration work to completion, as determined by Tenant in its reasonable discretion, then Tenant may, at its sole election:

- (a) Declare a default hereunder, or
- (b) Perform or cause to be performed the restoration work and deduct the cost thereof, plus interest thereon at ten percent (10%) per annum, from the next installment(s) of Base Rent due as a charge against the Landlord.

10. REPAIRS AND MAINTENANCE

10.1 Landlord Representations

- (a) Landlord represents to Tenant that, to Landlord's actual knowledge as of the date hereof and on the Commencement Date:
 - i. Subject to the reports provided to Tenant as described in Section 1.1 above, the Premises, the Building, and all Common Areas (including electrical, heating, ventilating, and air conditioning ("HVAC"), mechanical, plumbing, gas and fire/life safety systems in the Building and similar building service systems) comply with all current laws, codes, and ordinances, including but not limited to the Americans With Disabilities Act, and are in reasonably good working order and condition;
 - ii. The Building and the Premises comply with all covenants, conditions, restrictions and insurance underwriter's requirements;
 - iii. The Premises, the Building and the Common Areas are free of the presence of Hazardous Materials (as hereinafter defined); and
 - iv. Landlord has not received any notice from any governmental agency that the Building or the Premises are in violation of any law or regulation.
- (b) Landlord represents, based upon a professional inspection of the Premises and the Building and the Asbestos Report (as defined in Section 1.1) that the Premises and the Building contain no asbestos containing materials (other than as may be reflected in the Asbestos Report). Landlord shall, prior to Tenant's occupancy, abate, at Landlord's sole cost and expense, all asbestos-containing materials to the extent required by law and provide Tenant with an updated report from a licensed California Asbestos contractor to that effect.

(c) CASp Inspection:

In accordance with California Civil Code Section 1938, Landlord hereby states that the Premises and the Common Areas: *[Check the appropriate box]*

Have undergone inspection by a Certified Access Specialist (a "CASp") and have been determined to meet all applicable construction related accessibility standards pursuant to California Civil Code Section 55.53. Landlord shall provide Tenant with a copy of the CASp inspection report and a current disability access inspection certificate for the Premises within seven (7) days after the execution of this Lease.

Have undergone inspection by a Certified Access Specialist and have not been determined to meet all applicable construction related accessibility standards pursuant to California Civil Code Section 55.53. Landlord has provided Tenant with a copy of the CASp inspection report at least 48 hours prior to the execution of this Lease. A Certified Access Specialist (CASp) can inspect the subject premises and determine whether the subject premises comply with all of the applicable construction-related accessibility standards under state law. Although state law does not require a CASp inspection of the subject premises, the commercial property owner or lessor may not prohibit the lessee or tenant from obtaining a CASp inspection of the subject premises for the occupancy or potential occupancy of the lessee or tenant, if requested by the lessee or tenant. The parties shall mutually agree on the arrangements for the time and manner of the CASp inspection, the payment of the fee for the CASp inspection, and the cost of making any repairs necessary to correct violations of construction-related accessibility standards within the premises.

Have not undergone inspection by a Certified Access Specialist. A Certified Access Specialist (CASp) can inspect the subject premises and determine whether the subject premises comply with all of the applicable construction-related accessibility standards under state law. Although state law does not require a CASp inspection of the subject premises, the commercial property owner or lessor may not prohibit the lessee or tenant from obtaining a CASp inspection of the subject premises for the occupancy or potential occupancy of the lessee or tenant, if requested by the lessee or tenant. The parties shall mutually agree on the arrangements for the time and manner of the CASp inspection, the payment of the fee for the CASp inspection, and the cost of making any repairs necessary to correct violations of construction-related accessibility standards within the premises.

The foregoing statement is provided solely for the purpose of complying with California Civil Code Section 1938 and shall not affect the Landlord's and Tenant's respective responsibilities for compliance with any design and construction related accessibility obligations as provided under this Lease or the Landlord's Work Letter.

(d) Landlord agrees to indemnify and hold harmless Tenant from all damages, reasonable costs, and expenses, which result from a material breach of

Landlord's representations contained in this Section 10.1, subject to the limitations set forth in this Lease.

10.2 Landlord Obligations

- (a) Landlord shall keep and maintain the Property in good condition and repair and promptly make repairs to and perform maintenance upon and replace as needed:
- i. the structural elements of the Building, including without limitation, all permanent exterior and interior walls, floors and ceilings, foundations, roof, concealed plumbing, stairways, concealed electrical systems and intra-building telephone network cables;
 - ii. mechanical (including HVAC), electrical, plumbing and fire/life systems serving the Building;
 - iii. the Common Areas;
 - iv. exterior windows of the Building;
 - v. elevators serving the Building; and,
 - vi. landscaping throughout the Building, the Building perimeter, and parking areas
- (b) Landlord, at its sole cost and expense, shall also perform all maintenance and repairs to the Premises, and shall keep the Premises in good condition and repair, reasonable wear and tear excepted. Landlord's repair obligations include, without limitation, repairs to, or replacements of:
- i. the floor covering (if such floor covering is carpeting it shall be replaced as needed, but not less often than after five (5) years of use);
 - ii. interior partitions;
 - iii. doors, door frames and hardware;
 - iv. the interior side of demising walls (which shall be repainted as needed but not less often than every five (5) years);
 - v. signage;
 - vi. emergency exit signage and battery replacement;
 - vii. HVAC equipment dedicated to the mechanical rooms housing Tenant's computer servers and related equipment; and
 - viii. Light fixtures, bulbs, tubes and ballasts.

- (c) Landlord shall, to the best of its ability, provide all reports, maintenance records, or other documentation as may be requested from time to time.

10.3 Tenant Obligations

Without limiting Landlord's repair and maintenance obligations, Tenant shall be responsible for (i) the cost of repairing any area of the Property damaged by Tenant or by Tenant's agents, employees, invitees or visitors, and (ii) the repair of low voltage electronic, phone and data cabling and related equipment that is installed by or for the exclusive benefit of Tenant. All repairs and replacements shall:

- (a) be made and performed by contractors or mechanics approved by Landlord, which consent shall not be unreasonably withheld, conditioned or delayed;
- (b) be at least equal in quality, value and utility to the original work or installation; and
- (c) be in accordance with all applicable laws.

10.4 Tenant's Right to Repair

- (a) If Tenant provides written notice (or oral notice in the event of an emergency, such as damage or destruction to or of any portion of the Building structure and/or the Building systems, and/or anything that could cause material disruption to Tenant's business) to Landlord of an event or circumstance which requires the action of Landlord with respect to repair and/or maintenance, and if Landlord fails to provide such action within a reasonable period of time given the circumstances after the giving of such notice, but in any event not later than seven (7) days after the giving of such notice, then Tenant may proceed to take the required action (provided, however, that no such notice shall be required in the event of an emergency which threatens life or where there is imminent danger to property or a possibility that a failure to take immediate action could cause a material disruption in Tenant's normal and customary business activities). Tenant shall have access to the Building to the extent necessary to perform the work contemplated by this provision. If such action was required under the terms of this Lease to have been taken by Landlord and was not taken by Landlord within such period (unless such notice was not required as provided above), and Tenant took such required action, then Tenant shall be entitled to prompt reimbursement by Landlord of Tenant's reasonable costs and expenses in having taken such action plus interest thereon at ten percent (10%) per annum. If not reimbursed by Landlord within ten (10) business days after written notice, then Tenant shall be entitled to deduct from Base Rent payable by Tenant under this Lease the amount set forth in its invoice for such work. The remedies provided in this Section are in addition to the remedies provided in Section 15.
- (b) Notwithstanding any provisions of this Lease to the contrary, Tenant, acting through the County's Chief Executive Office, may request that the Landlord perform, supply and administer any repairs, maintenance, building services and/or alterations that are the responsibility of the Tenant, not to exceed \$5,000, as part of a separate purchase order issued by the County on

Tenant's behalf. In such case, Tenant shall promptly reimburse Landlord for such costs within thirty (30) days after completion and Tenant's receipt of an applicable invoice, prior written approval from tenant and Landlord and all supporting documentation. Any improvements by Landlord shall be subject to (i) the Work Letter provisions regarding selection and bidding of contractors, Landlord-Tenant coordination and audit rights, and Tenant's remedies found in said Work Letter; and (ii) compliance with County Internal Services Department Purchasing Policy and Procedure No. A-0300, effective November 22, 2016, delivered to Landlord and incorporated by reference herein. This Section shall not apply to any Tenant Improvements as defined in Section 24.

11. **SERVICES AND UTILITIES**

11.1 Services

(a) Heating, Ventilation and Air Conditioning (HVAC)

Landlord shall furnish heating, ventilation and air conditioning ("HVAC"), during Tenant's Hours of Operations in amounts required for the use and occupancy of the Premises for normal office purposes to a standard comparable to other first-class buildings and not less than the standard set forth in Exhibit C attached hereto. If Tenant desires HVAC after or before Tenant's Hours of Operation, then Tenant shall pay to Landlord for such usage the rate of \$50.00 per hour, per zone. Such charges shall be paid to Landlord within thirty (30) days after Landlord's delivery of an applicable invoice. In addition, Landlord shall furnish HVAC, at Tenant's expense, at all times (i.e., twenty-four (24) hours per day, seven (7) days per week, three hundred sixty-five (365) days per year) to the mechanical rooms housing Tenant's computer servers and related equipment. Landlord shall, as part of the work described in Landlord's Work Letter, install submeters in any and all mechanical rooms of the Premises which shall measure the amount of electricity consumed therein during hours other than Tenant's Hours of Operation. Landlord shall cause such sub-meters to be read on a monthly basis and Tenant shall pay to Landlord for the electricity consumed by the mechanical room(s) during hours other than Tenant's Hours of Operation within thirty (30) days after Landlord's delivery of an applicable invoice.

(b) Electricity

Landlord shall furnish to the floor on which the Premises is located the amount of electric current provided for in the Landlord's Work Letter (if applicable) but in any event not less than seven (7) watts of electric current (connected load) per square foot of rentable square feet in the Premises, for power and lighting and electric current for HVAC and Landlord shall provide the existing or new transformers or sub-panels on each floor for the Premises necessary for Tenant to utilize such capacity in the Premises; provided, however, any transformers or panels which may be required in order to accommodate Tenant's usage in the Premises of such seven (7) watts of electric current (connected load) shall be Tenant's sole cost and paid by Tenant as part of Tenant's TI Contribution,

(c) Elevators

Landlord shall furnish freight and passenger elevator services to the Premises during Tenant's Hours of Operations. During all other hours, Landlord shall furnish passenger elevator cab service in the elevator bank serving the Premises on an as needed basis, and, by prior arrangement with Landlord's building manager, freight elevator service.

(d) Water

Landlord shall make available in the Premises warm and cold water for normal lavatory and kitchen purposes and potable water for drinking purposes, all of which shall meet applicable government standards.

(e) Janitorial

Landlord, at its sole cost and expense, shall provide janitorial service five (5) nights per week, generally consistent with that furnished in comparable office buildings in the County of Los Angeles, but not less than the services set forth in the specifications set forth in Exhibit D attached hereto.

(f) Access

Landlord shall furnish to Tenant's employees and agents access to the Building, Premises and Common Areas on a seven day per week, 24 hour per day basis, subject to compliance with such reasonable security measures as shall from time to time be in effect for the Building. If required, Landlord shall provide access cards or fobs to all Tenant employees for Building entry, elevators, and/or floor access, at Landlord's sole cost and expense.

(g) Pest Control

Landlord at its sole cost and expense shall provide any and all pest control services to the Premises per the specifications set forth in Exhibit D attached hereto.

(h) Utilities

Landlord agrees to pay, at its sole cost, when due, all charges for the use of the sewer, effluent treatment (when and if imposed by any governmental authority), all water, sprinkler standby charges, electricity, gas, heating and common area power and lighting, trash removal service, fire/life safety systems, charges associated with the HVAC, and other utility rents and charges accruing or payable in connection with the Premises and the Common Areas during the Term of this Lease or any renewal, extension, or holdover thereof, whether the same are pro-rated or measured by separate meters. In the event Landlord fails or refuses to pay any or all of such charges when due, Tenant may give Landlord ten (10) business days prior written notice and thereafter pay directly such charges and deduct the payments from the next installments of rent due as a charge against the Landlord.

(i) Landscaping

Landlord, at its sole cost and expense, shall maintain all landscaping.

(j) Security.

Landlord, at its sole cost and expense, shall be responsible for providing Building security. Tenant, at its sole cost and expense, shall be responsible for providing security within the Premises (as needed).

12. TAXES

Landlord, at its sole cost and expense, shall pay, prior to delinquency, all real property taxes, assessments and special assessments which may be levied or assessed against the Premises or the Building during the term of this Lease or any renewal or holdover period thereof.

In the event Landlord fails or refuses to pay any or all taxes or assessments when due, Tenant may, at its sole discretion, give Landlord thirty (30) calendar days prior written notice and thereafter pay such taxes and assessments and deduct the payments from the next installments of rent due as a charge against the Landlord.

13. LANDLORD ACCESS

Tenant shall permit Landlord and its agents to enter the Premises during Tenant's Hours of Operations upon prior written notice only for the purpose of inspecting the Premises for any reasonable purpose. If Landlord temporarily closes any portion of the Building or the Premises, Base Rent shall be prorated based upon the percentage of the Premises or the Building rendered unusable and not used by Tenant. Landlord shall have the right at any and all times to enter the Premises in the event of an emergency and notify Tenant immediately thereafter.

14. TENANT DEFAULT

14.1 Default

The occurrence of any one or more of the following events shall constitute a material default and breach of this Lease by Tenant ("Default"):

- (a) the failure by Tenant to make any payment of Base Rent or any other payment required to be made by Tenant hereunder (except to the extent an offset is expressly permitted hereunder) as and when due, and the failure continues for a period of ten (10) days after written notice to Tenant;
- (b) the failure by Tenant to observe or perform any of the other covenants, conditions or provisions of this Lease, where such failure shall continue for a period of thirty (30) days after written notice from Landlord specifying in detail the nature of the default; provided, however, if more than thirty (30) days are reasonably required for its cure then Tenant shall not be deemed to be in default if Tenant commences such cure, within said thirty (30)-day period and thereafter diligently prosecutes such cure to completion.

14.2 Termination

Tenant agrees that if a Default should occur and should not be cured within the time periods set forth above, it shall be lawful for Landlord to terminate this Lease upon the giving of written notice to Tenant. In addition thereto, Landlord shall have such other rights or remedies as may be provided by law.

14.3 No Effect on Indemnity

Nothing in this Article shall be deemed to affect either Landlord or Tenant's right to indemnification under any indemnification clause or clauses set forth in this Lease.

15. LANDLORD DEFAULT

15.1 Remedies

In addition to the provisions for Landlord's default provided by Sections 9.4, 10.4, 19, 21.2 and 32.3, Landlord shall be in default ("Landlord Default") in the performance of any obligation required to be performed by Landlord under this Lease if Landlord has failed to commence to perform such obligation within five (5) days after the giving of written notice with respect thereto by Tenant (which notice shall be, if appropriate, the same notice given under Section 10.4); provided, however, that if the nature of the Landlord Default is such that the same cannot reasonably be cured within such five (5) day period, Landlord shall not be deemed to be in Landlord Default if Landlord shall within such period commence such cure and thereafter diligently prosecute the same to completion. If the Landlord Default is of such a nature that it materially and substantially interferes with Tenant's occupancy and use of the Premises and if such Landlord Default is not cured within the foregoing cure period, then Tenant shall have the right, at its option, with or without further notice or demand of any kind to Landlord or any other person, to any one or more of the following described remedies in addition to all other rights and remedies provided at law or in equity or elsewhere herein:

- (a) to remedy such default or breach and deduct the costs thereof (including but not limited to attorney' fees) from the installments of Base Rent next falling due;
- (b) to pursue the remedy of specific performance;
- (c) to seek money damages for loss arising from Landlord's failure to discharge its obligations under this Lease or offset such damages against Base Rent next coming due; and/or
- (d) to terminate this Lease.

15.2 Waiver

Nothing herein contained shall relieve Landlord from its duty to effect the repair, replacement, correction or maintenance required to restore any affected services, or to perform any other obligations to the standard prescribed in this Lease, nor shall this Section be construed to obligate Tenant to undertake any such work.

15.3 Emergency

Notwithstanding the foregoing notice and cure period, Tenant may cure any default after delivering written notice of such default to Landlord and where the failure promptly to cure such default would, in the reasonable opinion of Tenant, create or allow to persist an emergency condition, or materially and adversely affect the operation of Tenant's business in the Premises. In such cases, Tenant may perform the necessary work through its Internal Services Department and deduct the cost of said work from the Base Rent next due.

15.4 Limitation of Liability

Notwithstanding anything to the contrary set forth in this Lease, Landlord, its managers, members, shareholders, partners, limited partners, general partners, officers, directors, contractors, agents and employees (collectively, "Landlord Parties") shall not be liable for any injury to Tenant's business or any consequential, punitive, special or exemplary damages, however occurring. Without limiting the foregoing, Landlord and the Landlord Parties shall not be liable for any claims, losses, liabilities or damages (collectively, "Losses") to the personal property of Tenant or its employees, invitees, customers, agents or contractors for any cause unless caused by gross negligence or intentional misconduct of Landlord Parties.

16. **ASSIGNMENT AND SUBLETTING**

16.1 Assignment and Subletting

Tenant may assign, mortgage, encumber or otherwise transfer this Lease or sublet the whole or any part of the Premises without first obtaining Landlord's prior consent; provided, however, no such assignment, subletting or other transfer shall relieve Tenant of any liability under this Lease unless Landlord has given its written consent thereto, which Landlord shall not unreasonably withhold if the assignee has a financial condition which is reasonably sufficient for it to be responsible for all future obligations under this Lease. Notwithstanding the foregoing to the contrary, this Lease shall not be assigned to the Department of Corrections or Department of Probation to the extent such departments use the Premises for public facing purposes as opposed to administrative office use.

16.2 Sale

If Landlord sells or conveys the Property, then all liabilities and obligations of Landlord accruing under this Lease after the sale or conveyance shall be binding upon the new owner, and the transferor shall be released from all liability under this Lease accruing subsequent to such sale or conveyance, provided that the transferee assumes Landlord's remaining obligations hereunder in writing. Nothing in this Section 16.2 shall be deemed to release Landlord's successor in interest from responsibility for any condition (including but not limited to deferred maintenance) existing on the date of transfer.

Upon any sale or transfer of the Property by Landlord, Landlord shall provide prior written notice of said sale or transfer to Tenant. In addition, Landlord shall provide the following information to Tenant, at Tenant's Address for Notice (set forth in

Section 1.1 hereof), as a condition of Tenant's obligation to pay Base Rent to the new owner:

- (a) A letter from the Landlord confirming that the Property was transferred to the new owner, along with written evidence of the transfer of the Property (e.g., a recorded deed).
- (b) A signed letter from the new owner including the following information:
 - i. Name and address of new owner or other party to whom Base Rent should be paid
 - ii. Federal tax ID number for new owner
 - iii. Name of contact person and contact information (including phone number) for new owner
 - iv. Proof of insurance
- (c) A W-9 form for new owner.

Tenant shall not be obligated to pay any rental amounts to any party other than the Landlord named herein until such time as all the requirements of this Section 16.2 are satisfied.

17. ALTERATIONS AND ADDITIONS

17.1 Landlord Consent

Tenant shall not make any structural alterations, improvements, additions, or utility installations in or about the Premises (collectively, "Alterations") without first obtaining the written consent of Landlord, which consent shall not be unreasonably withheld, conditioned or delayed. If Landlord fails to respond in writing within thirty (30) days after Tenant's request, then Landlord shall be deemed to have approved the requested Alterations. However, Landlord's consent shall not be required for any Alteration that satisfies all of the following criteria:

- (a) complies with all laws;
- (b) is not visible from the exterior of the Premises or Building;
- (c) will not materially affect the systems or structure of the Building; and
- (d) does not unreasonably interfere with the normal and customary business office operations of other tenants in the Building.

17.2 End of Term

Any Alterations not removed by Tenant shall become the property of Landlord and remain upon and be surrendered with the Premises at the expiration of the Term.

18. CONDEMNATION

18.1 Controlling Terms

If during the Term, or during the period of time between the execution of this Lease and the Commencement Date, there is any taking of all or any part of the Premises or any interest in this Lease by Condemnation (as defined below), this Section shall determine the rights and obligations of Tenant and Landlord. "Condemnation" shall mean the exercise of any governmental power to take title to any portion of the Premises, whether by legal proceedings or otherwise, by a Condemnor (as defined below) or a voluntary sale or transfer by Landlord to any Condemnor either under threat of a Condemnor's exercise of such power or while legal proceedings are pending for the exercise of such power. "Condemnor" shall mean any public or quasi-public authority, or private corporation or individual, having the power of Condemnation.

18.2 Total Taking

If the Premises are totally taken by Condemnation, this Lease shall terminate on the date the Condemnor has a right to possession of the Premises (the "Date of Taking").

18.3 Partial Taking

If any portion, but not all, of the Premises or the Common Areas is taken by Condemnation, this Lease shall remain in effect, except that Tenant may elect to terminate this Lease if, in Tenant's reasonable judgment, the remaining portion of the Premises (including the space available for parking) is rendered unsuitable for Tenant's continued use of the Premises. If Tenant elects to so terminate this Lease, Tenant must exercise its right to terminate by giving notice to Landlord within thirty (30) days after the date that the nature and the extent of the Condemnation have been determined (the "Determination Date"), which notice shall set forth the date of termination. Such termination date shall not be earlier than thirty (30) days nor later than ninety (90) days after Tenant has notified Landlord of its election to terminate; except that this Lease shall terminate on the Date of Taking if the Date of Taking falls on a date before the termination date designated by Tenant. If Tenant does not so notify Landlord within thirty (30) days after the Determination Date, all obligations of Tenant under this Lease shall remain in effect, except that Base Rent shall be equitably abated in proportion to the degree to which Tenant's use of the Premises and the Common Areas is impaired by such Condemnation.

18.4 Restoration

Notwithstanding the preceding paragraph, if, within thirty (30) days after the Determination Date, Landlord notifies Tenant that Landlord, at its sole cost, will add to the remaining Premises and/or the Common Areas so that the Premises and the space available for parking, will be substantially the same (as reasonably determined by Tenant) after the Date of Taking as they were before the Date of Taking, and Landlord commences the restoration promptly and, subject to reasonable allowance for delays that are not caused by Landlord, completes it within ninety (90) days after Landlord so notifies Tenant, then this Lease shall continue in effect. In such event, all obligations of Tenant under this Lease shall

remain in effect, except that Base Rent shall be equitably abated or reduced during the period from the Date of Taking until the completion of such restoration.

18.5 Award

The Award (as defined below) shall be divided between Landlord and Tenant as their respective interests may appear. "Award" shall mean all compensation, sums or anything of value awarded, paid or received on a total or partial Condemnation of the Premises. Tenant shall be entitled to any awards for relocation benefits or goodwill belonging to Tenant.

18.6 Waiver of Statute

Landlord and Tenant hereby waive the provision of California Code of Civil Procedure Section 1265.130 allowing Landlord or Tenant to petition the Superior Court to terminate this Lease in the event of a partial taking of the Premises.

19. INDEMNIFICATION

19.1 Landlord's Indemnity

The Landlord shall indemnify, defend and hold harmless the Tenant from and against any and all liability, loss, injury or damage including (but not limited to) demands, claims, actions, fees, costs and expenses (including reasonable attorney and expert witness fees), arising from or connected with the Landlord's repair, maintenance and other acts and omissions arising from and/or relating to the Landlord's ownership of the Premises.

19.2 Tenant's Indemnity

The Tenant shall indemnify, defend and hold harmless the Landlord, from and against any and all liability, loss, injury or damage, including (but not limited to) demands, claims, actions, fees, costs and expenses (including reasonable attorney and expert witness fees) arising from or connected with the Tenant's repair, maintenance and other acts and omissions arising from and/or relating to the Tenant's use of the Premises.

20. INSURANCE

During the term of this Lease, the following insurance requirements will be in effect:

20.1 Waiver

Both the Tenant and Landlord each agree to release the other and waive their rights of recovery against the other for damage to their respective property arising from perils insured in the Causes-of-Loss Special Form (ISO form CP 10 30).

20.2 General Insurance Provisions – Landlord Requirements

Without limiting the Landlord's indemnification of Tenant and during the term of this Lease, and until all of its obligations pursuant to this Lease have been met, Landlord shall provide and maintain at its own expense insurance coverage satisfying the requirements specified in this Lease. These minimum insurance

coverage terms, types and limits (the "Required Insurance") also are in addition to and separate from any other contractual obligation imposed upon Landlord pursuant to this Lease. The Tenant in no way warrants that the Required Insurance is sufficient to protect the Landlord for liabilities which may arise from or relate to this Lease.

(a) Evidence of Coverage and Notice to Tenant

- i. Certificate(s) of insurance coverage ("Certificate") satisfactory to Tenant, and a copy of an Additional Insured endorsement confirming that Tenant and its Agents (defined below) has been given insured status under the Landlord's General Liability policy, shall be delivered to Tenant at the address shown below and provided prior to the start day of this Lease.
- ii. Renewal Certificates shall be provided to Tenant not less than 10 days prior to Landlord's policy expiration dates. The Tenant reserves the right to obtain complete, certified copies of any required Landlord insurance policies at any time.
- iii. Certificates shall identify all Required Insurance coverage types and limits specified herein, reference this Lease by name or number, and be signed by an authorized representative of the insurer(s). The Insured party named on the Certificate shall match the name of the Landlord identified in this Lease. Certificates shall provide the full name of each insurer providing coverage, its NAIC (National Association of Insurance Commissioners) identification number, its financial rating, the amounts of any policy deductibles or self-insured retentions exceeding twenty-five thousand (\$25,000.00) dollars, and list any Tenant-required endorsement forms.
- iv. Neither the Tenant's failure to obtain, nor the Tenant's receipt of, or failure to object to a non-complying insurance certificate or endorsement, or any other insurance documentation or information provided by the Landlord, its insurance broker(s) and/or insurer(s), shall be construed as a waiver of any of the Required Insurance provisions.
- v. Certificates and copies of any required endorsements, and/or notices of cancellation shall be delivered to:

County of Los Angeles
Chief Executive Office - Real Estate Division
320 West Temple Street, 7th Floor
Los Angeles, CA 90012
Attention: Director of Real Estate

Landlord also shall promptly notify Tenant of any third party claim or suit filed against Landlord which arises from or relates to this Lease, and could result in the filing of a claim or lawsuit against Landlord and/or Tenant.

(b) Additional Insured Status and Scope of Coverage

The Tenant, which is the County of Los Angeles, its Special Districts, Elected Officials, Officers, Agents, Employees and Volunteers (collectively, "Tenant and its Agents"), shall be provided additional insured status under Landlord's General Liability policy with respect to liability arising from or connected with the Landlord's acts, errors, and omissions arising from and/or relating to the Landlord's operations on and/or its ownership of the premises. Tenant's additional insured status shall apply with respect to liability and defense of suits arising out of the Landlord's acts or omissions, whether such liability is attributable to the Landlord or to the Tenant. The full policy limits and scope of protection also shall apply to the Tenant as an additional insured, even if they exceed the Tenant's minimum Required Insurance specifications herein. Use of an automatic additional insured endorsement form is acceptable providing it satisfies the Required Insurance provisions herein.

(c) Cancellation of or Changes in Insurance

Landlord shall provide the Tenant with, or Landlord's insurance policies shall contain a provision that the Tenant shall receive, written notice of cancellation or any change in Required Insurance, including insurer, limits of coverage, term of coverage or policy period. The written notice shall be provided to the Tenant at least ten (10) days in advance of cancellation for non-payment of premium and thirty (30) days in advance for any other cancellation or policy change. Failure to provide written notice of cancellation or any change in Required Insurance may constitute a material breach of the Lease, in the sole discretion of the Tenant, upon which the Tenant may suspend or terminate this Lease.

(d) Failure to Maintain Insurance

Landlord's failure to maintain or to provide acceptable evidence that it maintains the Required Insurance shall constitute a material breach of the Lease, upon which County immediately may withhold payments due to Landlord, and/or suspend or terminate this Lease. County, at its sole discretion, may obtain damages from Landlord resulting from said breach. Alternatively, the County may purchase the Required Insurance, and without further notice to Landlord, deduct the premium cost from sums due to Landlord or pursue Landlord reimbursement.

(e) Insurer Financial Ratings

Insurance is to be provided by an insurance company authorized to do business in California and reasonably acceptable to the Tenant, with an A.M. Best rating of not less than A:VII, unless otherwise approved by the Tenant.

(f) Landlord's Insurance Shall Be Primary

Landlord's insurance policies, with respect to any claims related to the Common Areas and Premises, shall be primary with respect to all other sources of coverage available to Tenant. Any Landlord maintained

insurance or self-insurance coverage shall be in excess of and not contribute to any Tenant coverage. Tenant's insurance policies shall be primary with respect to all of Tenant's personal property, furniture, fixtures and equipment located within the Premises.

(g) Waiver of Subrogation

To the fullest extent permitted by law, the Landlord hereby waives its and its insurer(s) rights of recovery against Tenant under all required insurance policies for any loss arising from or related to this Lease. The Landlord shall require its insurers to execute any waiver of subrogation endorsements which may be necessary to affect such waiver.

(h) Deductibles and Self-Insured Retentions ("SIRs")

Landlord's policies shall not obligate the Tenant to pay any portion of any Landlord deductible or SIR.

(i) Per Occurrence Coverage

If any part of the Required Insurance is written on a per occurrence basis, any policy retroactive date shall precede the start date of this Lease. Landlord understands and agrees it shall maintain such coverage until the date of the closing of any sale of the Building by Landlord to a third party.

(j) Application of Excess Liability Coverage

Landlord may use a combination of primary and excess insurance policies which provide coverage as broad as ("follow form" over) the underlying primary policies, to satisfy the Required Insurance provisions.

(k) Separation of Insureds

All liability policies shall provide cross-liability coverage as would be afforded by the standard ISO (Insurance Services Office, Inc.) separation of insureds provision with no insured versus insured exclusions or limitations.

(l) Intentionally Omitted

20.3 Insurance Coverage Types And Limits

(a) Tenant Requirements: During the term of this Lease, Tenant shall maintain a program of insurance coverage as described below:

i. Commercial General Liability Insurance, providing scope of coverage equivalent to ISO policy form CG 00 01, naming Landlord and its Agents as an additional insured, with limits of not less than:

General Aggregate:	\$ 2 million
Products/Completed Operations Aggregate:	\$ 1 million
Personal and Advertising Injury:	\$ 1 million
Each Occurrence:	\$ 1 million

Tenant, at its sole option, may satisfy all or any part of this insurance requirement through use of a program of self-insurance (self-funding of its liabilities). Certificate evidencing coverage or letter evidencing self-funding will be provided to Landlord after execution of this Lease at Landlord's request.

20.4 Landlord Requirements

During the term of this Lease, Landlord shall provide and maintain the following programs of insurance coverage:

- (a) Commercial General Liability Insurance, providing scope of coverage equivalent to ISO policy form CG 00 01, naming Tenant and Tenant's Agents as an additional insured, with limits of not less than:

General Aggregate:	\$ 5 million
Products/Completed Operations Aggregate:	\$ 5 million
Personal and Advertising Injury:	\$ 3 million
Each Occurrence:	\$ 3 million

Landlord shall be permitted to maintain such coverage pursuant to an umbrella or excess polic(ies) of insurance.

- (b) Commercial Property Insurance. Such insurance shall:
- i. Provide coverage for Tenant's property and any tenant improvements and betterments to the Premises; this coverage shall be at least as broad as that provided by the Causes-of-Loss Special Form (ISO form CP 10 30), excluding earthquake and including flood and ordinance or law coverage.
 - ii. Be written for the full replacement cost of the Property, with a deductible no greater than \$250,000 or 5% of the Property value, whichever is less. Insurance proceeds shall be payable to the Landlord and Tenant, as their interests may appear.

21. PARKING

21.1 Tenant's Rights

Tenant shall have the right to the number of unreserved parking spaces set forth in Section 1.1, without charge, for the Term of this Lease. Up to ten percent (10%) of such unreserved parking spaces may be tandem parking spaces. Tenant shall be entitled to full in/out privileges at all times. Tenant's parking rights shall be subject to reasonable parking rules and regulations adopted by Landlord from time to time, provided that such procedures shall be uniformly applied to all tenants. Tenant acknowledges that all unreserved parking spaces are not for the exclusive use of Tenant, rather, all such parking spaces are to be used on a non-exclusive, first-come, first-served basis by Tenant and other tenants, occupants, licensees, invitees and permittees of the Building. Landlord, at its sole expense, shall provide Tenant sixty (60) access cards or key fobs for Building and parking, if applicable.

21.2 Remedies

Landlord acknowledges that it is a material term of this Lease that Tenant receives all of the parking spaces to which it is entitled under this Lease for the entire Term of this Lease and that it would be impracticable and extremely difficult to fix the actual damages for a breach of such provisions. It is therefore agreed that if, for any reason whatsoever other than an emergency or Landlord's performance of its repair and maintenance obligations, ten percent (10%) or more of the parking spaces required above are not available to Tenant (in addition to the rights given to Tenant under Section 14 and Sections 9 and 17 in the event of casualty or condemnation), and, if such parking spaces are not restored to Tenant within five (5) business days after Landlord's receipt of written notice from Tenant then Tenant may:

- (a) terminate this Lease by giving written notice of such termination to Landlord, which notice shall be effective thirty (30) days thereafter, or
- (b) deduct from the Base Rent thereafter accruing hereunder an amount each month equal to the Base Rent times the percentage of parking spaces not so provided, but such deduction from Base Rent shall be not less than ten percent (10%) nor more than one hundred percent (100%) of the Base Rent.

22. ENVIRONMENTAL MATTERS

22.1 Hazardous Materials

Tenant shall not cause nor permit, nor allow any of Tenant's employees agents, customers, visitors, invitees, licensee, contractor, assignees or subtenants to cause or permit, any Hazardous Materials to be brought upon, stored, manufactured, generated, blended, handled, recycled, treated, disposed or used on, under or about the Premises, the Building or the Common Areas, except for routine office and janitorial supplies in usual and customary quantities stored, used and disposed of in accordance with all applicable Environmental Laws. As used herein, "Hazardous Materials" means any chemical, substance, material, controlled substance, object, condition, waste, living organism or combination thereof, whether solid, semi solid, liquid or gaseous, which is or may be hazardous to human health or safety or to the environment due to its radioactivity, ignitability, corrosivity, reactivity, explosivity, toxicity, carcinogenicity, mutagenicity, phytotoxicity, infectiousness or other harmful or potentially harmful properties or effects, including, without limitation, molds, toxic levels of bacteria, tobacco smoke within the Premises, petroleum and petroleum products, asbestos, radon, polychlorinated biphenyls (PCBs), refrigerants (including those substances defined in the Environmental Protection Agency's "Refrigerant Recycling Rule," as amended from time to time) and all of those chemicals, substances, materials, controlled substances, objects, conditions, wastes, living organisms or combinations thereof which are now or become in the future listed, defined or regulated in any manner by any Environmental Law based upon, directly or indirectly, such properties or effects. As used herein, "Environmental Laws" means any and all federal, state or local environmental, health and/or safety-related laws, regulations, standards, decisions of courts, ordinances, rules, codes, orders, decrees, directives, guidelines, permits or permit conditions, currently

existing and as amended, enacted, issued or adopted in the future which are or become applicable to Tenant, the Premises, the Building or the Common Areas.

22.2 Landlord Indemnity

Landlord shall indemnify, protect, defend (by counsel acceptable to Tenant) and hold harmless Tenant from and against any and all claims, judgments, causes of action, damage, penalties, fines, taxes, costs, liabilities, losses and reasonable expenses arising at any time during or after the Term as a result of, or in connection with, the presence of Hazardous Materials on, under or about the Premises, Building or Common Areas caused by Landlord or Landlord's other violation of laws relating to Hazardous Materials other than those caused by Tenant. This indemnity shall include, without limitation, the cost of any required or necessary repair, cleanup or detoxification, and the preparation and implementation of any closure, monitoring or other required plans, as such action is required by local or state laws or any governmental agency. Landlord shall promptly deliver to Tenant a copy of any notice received from any governmental agency during the Term of this Lease concerning the presence of Hazardous Materials in the Building or the Premises in violation of applicable laws. Landlord's obligations pursuant to the foregoing indemnity shall survive the expiration or termination of this Lease. A default by Landlord under this Section shall constitute a material default under this Lease.

22.3 Tenant Indemnity

Tenant agrees to indemnify, defend and hold harmless Landlord and the Landlord Parties from and against all liability, expense (including defense costs, legal fees and response costs imposed by law) and claims for damages which arise out of the presence of Hazardous Materials on the Premises caused by Tenant or Tenant's contractors, agents or employees.

The indemnification provisions of this Section 22 shall survive the expiration or earlier termination of this Lease.

23. **ESTOPPEL CERTIFICATES**

Tenant shall, within thirty (30) business days after written request of Landlord, execute, acknowledge and deliver to Landlord or its designee a written statement in the form of Exhibit F attached hereto (properly completed) but shall have no other obligation to deliver any other form of estoppel certificate. It is intended that any such statement delivered pursuant to this Section may be relied upon by a prospective purchaser of Landlord's interest in the Premises or a holder of any mortgage upon Landlord's interest in the Premises.

24. **TENANT IMPROVEMENTS**

Prior to the Commencement Date, Landlord shall construct the Tenant Improvements in the manner set forth in Landlord's Work Letter executed by Landlord and Tenant concurrently herewith.

25. LIENS

Tenant shall keep its interest in this Lease and the Premises free from any liens arising out of any work performed or materials ordered or obligations incurred by Tenant. Landlord shall keep its interest in this Lease and the Premises free from any liens which would impair the interest of Tenant hereunder and hereby indemnifies and holds Tenant harmless from any liability or loss from any such lien.

26. SUBORDINATION AND MORTGAGES

26.1 Subordination and Non-Disturbance

Tenant agrees, at Landlord's option, to subordinate this Lease to the lien of any mortgages or deeds of trust now or hereafter in force against the Building; provided, however, Tenant's obligation to subordinate this Lease is expressly conditioned upon Tenant receiving a written agreement in the form of Exhibit E attached hereto and provided further that no such subordination shall affect any option to extend the Term of this Lease, right of first offer to lease additional premises, option to purchase, or right of first offer to purchase the Property included herein.

26.2 Existing Deeds of Trust

The beneficiary under any existing deed of trust affecting the Building shall provide a written agreement to Tenant in the form of Exhibit E attached hereto, within thirty (30) days after the Commencement Date, subject to any delay by Landlord's lender.

26.3 Notice of Default

If any mortgagee or beneficiary under a deed of trust affecting the Property gives written notice of its name and address to Tenant by registered mail and requests copies of any notice of default that Tenant serves upon Landlord, Tenant agrees to use its best efforts (but without liability for failure to do so) to give such mortgagee or beneficiary a copy of any notice of default that Tenant serves upon Landlord which could permit Tenant to terminate this Lease, along with an additional ten days within which to cure such default.

27. SURRENDER OF POSSESSION

Subject to casualty, at the expiration of the Term of this Lease, whether by lapse of time or otherwise, Tenant shall promptly and peacefully surrender the Premises to Landlord in a "broom-clean" condition. Tenant may (but shall not be required to) remove, at its own expense, all fixtures, equipment and all other personal property placed or installed in or upon the Premises by Tenant, or under its authority (including any modular furniture).

28. SIGNAGE

Tenant shall be allowed building standard signage on the directory located in the ground floor lobby of the Building and elevator lobbies of the floors of the Premises and suite signage, all of which shall be at a cost to be deducted from the Tenant's TI Costs. Tenant shall have the right to install, at a cost to be deducted from the Tenant's TI Costs, up to two (2) lines per 1,000 rentable square feet of the Premises on the Building's directory

board in the main lobby of the Building. Tenant shall be permitted to install signs within the Premises that conform with any and all applicable laws and ordinances.

29. QUIET ENJOYMENT

So long as Tenant is not in default hereunder, Tenant shall have the right to the peaceful and quiet enjoyment and possession of the Premises and the Common Areas during the Term of this Lease, subject to the terms and conditions of this Lease.

30. GENERAL

30.1 Headings

Titles to Sections of this Lease are not a part of this Lease and shall have no effect upon the construction or interpretation of any part hereof.

30.2 Successors and Assigns

All of the covenants, agreements, terms and conditions contained in this Lease shall inure to and be binding upon the Landlord and Tenant and their respective successors and assigns.

30.3 Brokers

Landlord and Tenant each represent and warrant to each other that it has not engaged any broker, finder or other person who would be entitled to any commission or fees in respect of the negotiation, execution or delivery of this Lease other than Cushman & Wakefield of California, Inc. (the "Tenant's Agent") and CBRE (Landlord's Agent") and shall indemnify and hold harmless each other against any loss, cost, liability or expense incurred by the other party as a result of any claim asserted by any such broker, finder or other person on the basis of any arrangements or agreements made or alleged to have been made in variance with this representation. The terms of any commissions due shall be pursuant to a separate commission agreement between Landlord and Tenant's Agent.

30.4 Entire Agreement

This Lease (including all exhibits hereto and the Landlord's Work Letter) is the final and complete expression of Landlord and Tenant relating in any manner to the leasing, use and occupancy of the Premises, to Tenant's use of the Building and other matters set forth in this Lease. No prior agreements or understanding pertaining to the same shall be valid or of any force or effect, and the covenants and agreements of this Lease shall not be altered, modified or added to except in writing signed by both Landlord and Tenant.

30.5 Severability

Any provision of this Lease which shall prove to be invalid, void or illegal shall in no way affect, impair or invalidate any other provision hereof, and the remaining provisions hereof shall nevertheless remain in full force and effect.

30.6 Notices

The parties shall give all notices in writing by (i) personal delivery, (ii) national-recognized, next-day courier service, or (iii) first-class registered or certified mail, postage prepaid, to the Landlord's Address for Notice and Tenant's Address for Notice as set forth in Section 1.1. Without limiting the generality of the foregoing, Landlord's notices to Tenant shall not be effective if they are delivered to the Premises or to another address that is not set forth in Section 1.1(b) hereof. Any notice given under this Lease shall be deemed effective upon the date of delivery (whether accepted or refused), which, for certified mail and courier service, shall be established by U.S. Post Office return receipt or the courier's proof of delivery, respectively.

30.7 Governing Law and Venue

This Lease shall be governed by and construed in accordance with the internal laws of the State of California. Any litigation with respect to this Lease shall be conducted in the County of Los Angeles, State of California.

30.8 Waivers

No waiver by Landlord or Tenant of any provision hereof shall be deemed a waiver of any other provision hereof or of any subsequent breach by Landlord or Tenant of the same or any other provision. Landlord's or Tenant's consent to or approval of any act shall not be deemed to render unnecessary the obtaining of Landlord's or Tenant's consent to or approval of any subsequent act by Landlord or Tenant.

30.9 Time of Essence

Time is of the essence for the performance of all of the obligations specified hereunder.

30.10 Consent

Whenever any consent is required by Landlord or Tenant hereunder, such consent shall not be unreasonably withheld, conditioned or delayed and, unless otherwise specifically provided herein, shall be deemed granted if not refused within ten (10) business days after written request is made therefore, together with all necessary information.

30.11 Community Business Enterprises

Landlord shall complete and deliver to Tenant concurrently with the execution hereof a Community Business Enterprises form set forth as Exhibit G attached hereto.

30.12 Memorandum of Lease

If requested by Tenant, Landlord and Tenant shall execute and acknowledge a Memorandum of Lease in the form of Exhibit H attached hereto, which Memorandum may be recorded by Tenant in the Official Records of Los Angeles County.

30.13 Counterparts: Electronic Signatures

This Lease and any other documents necessary for the consummation of the transaction contemplated by this Lease may be executed in counterparts, including both counterparts that are executed on paper and counterparts that are in the form of electronic records and are executed electronically. An electronic signature means any electronic sound, symbol or process attached to or logically associated with a record and executed and adopted by a party with the intent to sign such record, including facsimile or e-mail electronic signatures. All executed counterparts shall constitute one agreement, and each counterpart shall be deemed an original. The parties hereby acknowledge and agree that electronic records and electronic signatures, as well as facsimile signatures, may be used in connection with the execution of this Lease and electronic signatures, facsimile signatures or signatures transmitted by electronic mail in so-called pdf format shall be legal and binding and shall have the same full force and effect as if a paper original of this Lease had been delivered had been signed using a handwritten signature. Landlord and Tenant (i) agree that an electronic signature, whether digital or encrypted, of a party to this Lease is intended to authenticate this writing and to have the same force and effect as a manual signature, (ii) intended to be bound by the signatures (whether original, faxed or electronic) on any document sent or delivered by facsimile or, electronic mail, or other electronic means, (iii) are aware that the other party will reply on such signatures, and (iv) hereby waive any defenses to the enforcement of the terms of this Lease based on the foregoing forms of signature. If this Lease has been executed by electronic signature, all parties executing this document are expressly consenting under the United States Federal Electronic Signatures in Global and National Commerce Act of 2000 ("E-SIGN") and California Uniform Electronic Transactions Act ("UETA")(Cal. Civ. Code § 1633.1, et seq.), that a signature by fax, email or other electronic means shall constitute an Electronic Signature to an Electronic Record under both E-SIGN and UETA with respect to this specific transaction.

31. AUTHORITY

Only the County's Board of Supervisors ("Board of Supervisors") has the authority, by formally approving and/or executing this Lease, to bind Tenant to the terms included herein. Landlord understands that no material terms of this Lease may be altered or deleted, nor may any new material terms be added to this Lease, without the express written approval of the Board of Supervisors, either through an amendment to the Lease or by other formal board action. No County officer, employee, agent or independent contractor has any authority to alter, add or delete the material terms of this Lease, and Landlord may not rely upon any representations to the contrary. This limitation of authority applies to all material terms of the Lease including, without limitation, any monetary ceiling established for Tenant Improvements or other project costs of Landlord which are subject to reimbursement by Tenant. Tenant shall not reimburse Landlord for any expenses which exceed this ceiling. Notwithstanding the foregoing, the Chief Executive Office of the County (the "Chief Executive Office") may take any administrative act on behalf of Tenant hereunder which does not have the effect of increasing Base Rent or other financial obligations of Tenant under this Lease, including without limitation, granting any approvals, terminating this Lease in the manner provided herein by an early termination notice or otherwise, signing estoppel certificates, signing the Commencement Date Memorandum and Confirmation of Lease Terms or subordinating this Lease. Each individual executing this Lease on behalf of Landlord represents and warrants that he or

she is duly authorized to execute and deliver this Lease on behalf of Landlord, and that this Lease is binding upon Landlord in accordance with its terms.

32. ACKNOWLEDGEMENT BY LANDLORD

Landlord acknowledges that it is aware of the following provisions:

32.1 Consideration of GAIN Program Participants

Should Landlord require additional or replacement personnel after the effective date of this Lease, Landlord shall give consideration for any such employment openings to participants in the County Department of Public Social Services' Greater Avenues for Independence ("GAIN") Program who meet Landlord's minimum qualifications for the open position. The County will refer GAIN participants by job category to Landlord.

32.2 Solicitation of Consideration

It is improper for any County officer, employee or agent to solicit consideration in any form from a landlord. A landlord shall not offer or give, either directly or through an intermediary, consideration in any form to a County officer, employee or agent who has had any involvement in the procurement, negotiation, consummation, administration or management of a lease.

Landlord shall immediately report any attempt by a County officer, employee or agent to solicit such improper consideration. The report shall be made to the County Auditor-Controller's Employee Fraud Hotline at (800) 544-6861.

Landlord hereby represents and warrants that it has not provided, and will not provide, any financial benefits to any County official, employee or agent who has had any involvement in the procurement, negotiation, consummation, administration or management of this Lease. Landlord hereby agrees that if it violates any of the terms of this Section 32.2, then the County may declare this Lease null and void, and the County reserves the right to exercise any and all other remedies available under applicable law.

32.3 Landlord Assignment

(a) Landlord may assign, transfer, mortgage, hypothecate or encumber Landlord's right, title and interest in and to this Lease or any portion thereof (including the right to receive rental payments but excluding its duties and obligations hereunder), and Landlord may execute any and all instruments providing for the payment of Base Rent directly to an assignee or transferee, but only if the conditions set forth in this Section are met.

(b) Any document or agreement purporting to assign, transfer, mortgage, hypothecate or encumber Landlord's right, title and interest in and to this Lease, or any portion thereof, as security for the Landlord's obligation to repay any monetary obligation, is hereinafter referred to as a "Security Agreement." Any Security Agreement which is executed without full compliance with the requirements of this Section shall be void. It is hereby expressly agreed that a sale agreement which sets forth sale of the Building or an assignment agreement pursuant to which Landlord assigns its interest

in this Lease in connection with a sale of the Building do not constitute a Security Agreement under this Lease.

- (c) Each assignee or transferee under the Security Agreement shall certify and agree in writing that such assignee or transferee has read and is familiar with the requirements of Sections 5950-5955 of California Government Code, which prohibits the offer or sale of any security constituting a fractional interest in this Lease or any portion thereof, without the prior written consent of the Tenant. Notwithstanding the foregoing, the Tenant hereby acknowledges and agrees that Landlord shall have the right to encumber the Property with CMBS (commercial mortgage backed securities) financing or other traditional real estate financing. However, Landlord may not encumber the Property through any type of bond financing vehicle, including but not limited to certificate of participation financing.
- (d) If Landlord shall be convicted by applicable Court of law of violating the provisions of Section 5951 of the California Government Code, such conviction, which is a requirement for Tenant to exercise its remedies pursuant to Section 5954 of the California Government Code, will constitute a material breach of this Lease, upon which Tenant shall have the right to exercise the remedy set forth in such Section 5954 of the California Government Code. In addition, in the event Landlord is convicted of violating Section 5951 of the California Government Code, Tenant may exercise or pursue any other right or remedy it may have under this Lease or applicable law.
- (e) Landlord shall give Tenant written notice and a copy of each and every assignment, transfer, hypothecation or encumbrance of Landlord's interest in this Lease and any instrument relating thereto (including, but not limited to, instruments providing for the payment of Base Rent directly to an assignee or transferee) at least thirty (30) days prior to the effective date thereof.
- (f) Landlord shall not furnish any information concerning Tenant or the subject matter of this Lease (including, but not limited to, offering memoranda, financial statements, economic and demographic information, and legal opinions rendered by the office of counsel for the Tenant) to any person or entity, other than purchasers, lenders and prospective purchasers and lenders and all of their legal representatives and brokers on a need to know basis, except with Tenant's prior written consent. Landlord shall indemnify, defend and hold Tenant and its officers, agents and employees harmless from and against all claims and liability alleged to arise from the inaccuracy or incompleteness of any information furnished by Landlord in violation of this Section 32.3.
- (g) The provisions of this Section 32.3 shall be binding upon and applicable to the parties hereto and their respective successors and assigns. Whenever in this Section Landlord is referred to, such reference shall be deemed to include Landlord's successors or assigns, and all covenants and agreements by or on behalf of Landlord herein shall bind and apply to Landlord's successors and assigns, whether so expressed or not.

- (h) Notwithstanding any contrary provision contained in this Lease, Landlord shall have the right at any time and from time to time, to refinance the Building or transfer Landlord's right, title and interest in and to the Building or Property without Tenant's consent.

32.4 Smoking in County Facilities.

The Surgeon General of the United States has concluded that passive smoke exposure is the third leading cause of preventable death in the United States. The United States Environmental Protection Agency has found second-hand smoke to be a known carcinogen. It is recognized that the County has a responsibility to establish, maintain and promote a healthful and safe working environment and to reduce health and safety risks of its employees and the public at large. Tobacco smoke is a hazard to the health of County employees and the general public and represents an annoyance which should be regulated and banned in all county facilities to the end that air quality in all such facilities be improved for the preservation and improvement of the health of all County employees and the public. Therefore, to the greatest extent possible, the rights and comfort of all employees shall be respected. Reasonable effort shall be made to provide smokers a place to smoke in areas open to the sky or otherwise located outside County facilities and, except as provided under Los Angeles County, California - Code of Ordinances Chapter 2.126 ("LAMC 2.126"), all portions of County-owned facilities and all portions of facilities leased by or from the County, which areas are not open to the sky, shall be designated as "no smoking" areas. Smoking, including the use of electronic smoking devices, shall be prohibited in the following areas of County facilities: (1) Within 50 feet of any operable entry or exit door or operable window of any County building and within 25 feet of any access ramp or handicap path; (2) Within any County parking lot, parking structure, or parking garage, whether enclosed or open to the sky; or (3) Within any driving range and eating area, including outdoor eating areas, of any County golf course. International no-smoking signs and other appropriate signs which designate no-smoking areas shall be clearly, sufficiently and conspicuously posted in every room, building or other place so covered by LAMC 2.126. The manner of such posting, including the wording, size, color and place of posting, whether on the walls, doors, tables, counters, stands or elsewhere, shall be at the discretion of the building proprietor so long as clarity, sufficiency and conspicuousness are apparent in communicating the intent. (Los Angeles County, California - Code of Ordinances Chapter 2.126.)

33. **IRREVOCABLE OFFER**

In consideration for the time and expense that Tenant will invest in this Lease, including but not limited to preliminary space planning, legal review, and preparation and noticing for presentation to the Tenant Real Estate Management Commission of Los Angeles County, as necessary, in reliance on Landlord's agreement to lease the Premises to Tenant under the terms of this Lease, Landlord irrevocably offers to enter into this Lease and not to revoke this offer until the Irrevocable Offer Expiration Date, as defined in Section 1.1.

34. OPTION TO EXTEND.

(a) Option Term. Provided that no material Default has occurred and is continuing under the Lease at the time the option is exercised, Tenant shall have one (1) option to renew this Lease for an additional period of five (5) years (the "Extension Term").

(b) Exercise of Option. Tenant must exercise its option to extend this Lease by:

(i) giving Landlord written notice of its intention to do so (its "Notice of Intent") no later than nine (9) months, nor earlier than twelve (12) months, prior to the end of the initial Term, and

(ii) after Market Rental Value has been determined as provided below, and after the Board of Supervisors has approved the exercise of the option to renew, by giving written notice of its election to exercise such option. It is understood that Tenant will not exercise its option until after the Board of Supervisors has approved doing so, which will not be prior to the determination of the Market Rental Value, as provided below. If the Board of Supervisors has not approved the exercise of such option prior to ninety (90) days after the expiration of the Term of this Lease as then in effect, Tenant shall be entitled to holdover at the holdover rental rate as provided in this Lease. If Tenant fails to give written notice of its election to exercise the option to Landlord, Landlord will promptly provide written notice to Tenant that the Term shall not be extended unless Tenant responds within ten (10) business days in writing electing to exercise its renewal option, and Tenant shall respond by the expiration of such ten (10) business day period by delivering written notice of its election to exercise such renewal option or election not to exercise such renewal option. Tenant's failure to notify Landlord of its election to exercise such renewal option, within ten (10) business day after receipt of such written notice shall terminate this Lease as of the Expiration Date, and neither Landlord nor Tenant will have any further obligation or liability under this Lease arising or continuing from and after such Expiration Date, subject, however, to the provisions that expressly survive expiration or termination of this Lease.

(c) Terms and Conditions of the Extension Term. The Extension Terms shall be on all the terms and conditions of this Lease, except that the Base Rent during Extension Terms shall be equal to one hundred percent (100%) of Market Rental Value for the Premises as of the commencement of the Extension Term ("Adjusted Market Rental Value") to be determined as set forth below, including, but not limited to, the comparable rental rate, escalation, abatement, tenant improvement allowances (after first reasonably deducting the value of the existing improvements) then being offered to renewing tenants leasing space in the Gardena and 190th Street Corridor sub-market(s) ("Market").

Notwithstanding any contrary provision contained herein, during the Extension Term, Landlord shall have the right, but only in connection with Landlord's redevelopment of the Building or Property, to terminate this Lease, without cause and without payment of any penalty to Tenant, upon delivering at least twenty-four (24) months prior written notice to Tenant (and, accordingly, the Lease shall terminate as of the last day of such twenty-four (24) month period).

(d) Agreement on Base Rent. Landlord and Tenant shall have ninety (90) days after Landlord receives the Notice of Intent in which to agree on the Base Rent during the applicable Extension Term. Base Rent during the Extension Term(s) shall be the Adjusted

Market Rental Value of the Premises calculated as of the date Tenant gives its Notice of Intent with respect to its option to extend.

(e) Market Rental Value. The term "Market Rental Value" shall be the rental rate that comparable Premises in the Market in which the Premises is located would command for the same term as the Extension Term on the open market at the time Tenant provides its Notice of Intent. For purposes hereof, the term "comparable Premises" shall mean premises in a building similar in size and location to the Building in the Market, taking into account any improvements installed by or on behalf of Tenant in the Building, the fact that Tenant is not required to pay operating expenses, insurance or taxes for the Premises and the fact that Tenant is not required to pay for electricity, water, sewer, trash and janitorial utilities and services for the Premises. In determining the Market Rental Value, additional appropriate consideration shall be given to Tenant's creditworthiness, the annual amount per rentable square foot that Landlord has accepted in current transactions between non-affiliated parties from non-sublease, non-expansion, space for renewal and non-equity tenants of comparable creditworthiness for comparable premises for a comparable use for a comparable period of time, the annual rental rates per square foot, the standard of measurement by which the rentable square footage is measured, the ratio of rentable square feet to usable square feet, and the fact that Tenant is not required to pay operating expenses, insurance or taxes pursuant to this Lease, parking rights and obligations, signage rights, abatement provisions reflecting free rent, tenant improvements and any other tenant inducements then being offered to renewing tenants leasing space in the Market, however, the fact that brokerage commissions are or are not payable for such comparable transactions shall be excluded from such calculation.

(f) Opinion. Landlord shall submit its opinion of Market Rental Value to Tenant within fifteen (15) days after Landlord's receipt of the Notice of Intent, and Tenant shall respond thereto within ten (10) days thereafter by either (a) accepting Landlord's opinion of Market Rental Value (in which case, such Market Rental Value shall be used to determine Base Rent during the Extension Term) or (b) submitting Tenant's opinion of Market Rental Value. If Landlord and Tenant cannot agree upon the Market Rental Value of the Premises within fifteen (15) days thereafter, then Landlord and Tenant within five (5) days shall each submit to each other their final written statement of Market Rental Value ("Final Statement"). Within ten (10) days thereafter Landlord and Tenant shall together appoint one real estate appraiser (who shall be a Member of the American Institute of Real Estate Appraisers) (or, if both Landlord and Tenant agree, a certified property manager with ten (10) years' experience) who will determine whether Landlord's or Tenant's Final Statement of Market Rental Value is the closest to the actual (in such appraiser's opinion) Market Rental Value of the Premises. If Landlord and Tenant cannot mutually agree upon an appraiser within said ten (10) day period, Tenant may apply to the Presiding Judge of the Superior Court for Los Angeles County, requesting said Judge to appoint the M.A.I. qualified appraiser. The appraiser so appointed shall promptly determine whether Landlord's or Tenant's Final Statement of Market Rental Value is the closest to the actual (in such appraisers' opinion) Market Rental Value of the Premises, and such Final Statement of Market Rental Value shall be the Market Rental Value used in determining Base Rent during the Extension Term. The fees and expenses of the appraiser shall be borne equally by Landlord and Tenant. The appraiser appointed or selected pursuant to this Section shall have at least ten (10) years' experience appraising commercial properties in Los Angeles County.

(g) Amendment of Lease. Immediately after the Board of Supervisors approves the exercise of any option granted pursuant to this Section 34, and such option is exercised,

Landlord and Tenant shall execute an amendment to this Lease setting forth the new Base Rent in effect.

IN WITNESS WHEREOF this Lease has been executed the day and year first set forth above.

LANDLORD:

OMNINET PACIFIC POINTE, LP,
A Delaware limited partnership

By: Omninet Five GP, LLC,
A California limited liability company
Its: General Partner

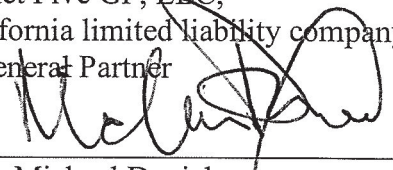
By: 
Name: Michael Danielpour
Title: Manager of General Partner

TENANT:

COUNTY OF LOS ANGELES,
a body corporate and politic

FESIA A. DAVENPORT
Chief Executive Officer

By: _____
John T. Cooke
Assistant Chief Executive Officer

ATTEST:

DEAN C. LOGAN
Registrar-Recorder/County Clerk
of the County of Los Angeles

By: _____
Deputy

APPROVED AS TO FORM:

DAWYN R. HARRISON
County Counsel

By: 
Senior Deputy

EXHIBIT A
FLOOR PLAN OF PREMISES



KINETSU INTL EXPRESS 871 W 190TH ST SUITE 178 GARDENA CA 90248	DWG TITLE: EXISTING FLOOR PLAN	DRAWN BY: NJ	KEY INTERNATIONAL INC <small>1882 E. South Street, Suite 200, Gardena, CA 90248 TEL: (310) 321-1000 FAX: (310) 321-1001</small>
	SCALE: 1/16"=1'-0"	CHECKED BY: CAJW DP20/0013-KINETSU	DATE: 5-13-2019

EXHIBIT B

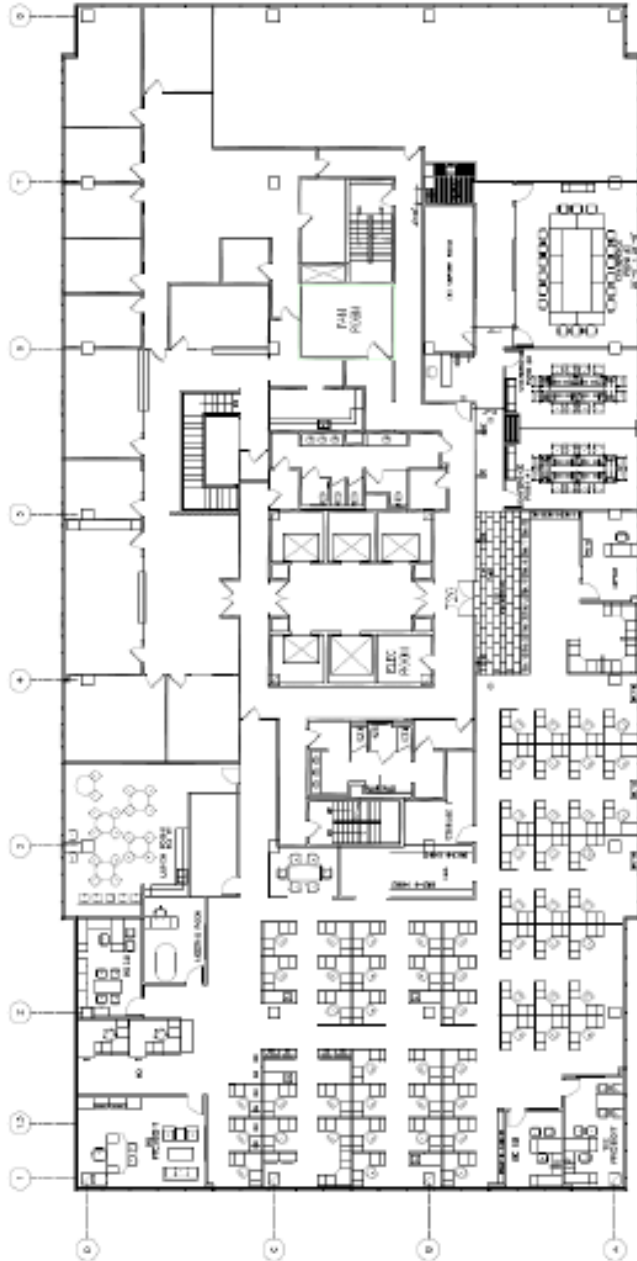
**COMMENCEMENT DATE MEMORANDUM
AND CONFIRMATION OF LEASE TERMS**

Reference is made to that certain Lease Agreement ("Lease") dated _____, 20__, between County of Los Angeles, a body corporate and politic ("Tenant"), and Omninet Pacific Pointe LP, a Delaware Limited Partnership ("Landlord"), whereby Landlord leased to Tenant and Tenant leased from Landlord certain premises in the building located at 879 West 190th Street, Gardena, California ("Premises"),

Landlord and Tenant hereby acknowledge as follow:

- 1) Landlord delivered possession of the Premises to Tenant in a Substantially Complete condition on _____ ("Possession Date");
- 2) Tenant has accepted possession of the Premises and now occupies the same;
- 3) The Lease commenced on _____ ("Commencement Date");
and
- 4) The Premises contains 13,468 rentable square feet of space.

For clarification and the purpose of calculating future rental rate adjustments:

- 1) Base Rent per month is _____.
- 2) The Base Index month is _____.
- 3) The Base Index is _____.
- 4) The first New Index month is _____.

IN WITNESS WHEREOF, this memorandum is executed this _____ day of _____,
20____.

Tenant:

Landlord:

COUNTY OF LOS ANGELES,
a body corporate and politic

OMNINET PACIFIC POINTE, LP,
A Delaware limited partnership

By: _____
Name _____
Its _____

By: Omninet Five GP, LLC,
A California limited liability company
Its: General Partner

By: _____
Name: Michael Danielpour
Title: Manager of General Partner

EXHIBIT C

HEATING, VENTILATION AND AIR CONDITIONING

Landlord shall supply cooling, ventilating and heating with capacity to produce the following results effective during Tenant's Hours of Operation established by the Lease and within tolerances normal in comparable office buildings; maintenance of inside space conditions of not greater than 78 degrees Fahrenheit when the outside air temperature is not more than 93 degrees Fahrenheit dry bulb and 70 degrees Fahrenheit wet bulb, and not less than 70 degrees Fahrenheit when the outside air temperature is not lower than 42 degrees Fahrenheit dry bulb. Interior space is designated at a rate of one zone for approximately each 1,000 square feet and one diffuser for each 200 square feet of usable/net square footage within the Premises. If energy requirements prohibit Landlord from complying with these requirements, Tenant shall not unreasonably withhold its consent to temporary waivers or modifications.

EXHIBIT D

CLEANING AND MAINTENANCE SCHEDULE

A. DAILY (Monday through Friday)

1. Carpets vacuumed.
2. Composition floors dust-mopped.
3. Desks, desk accessories and office furniture dusted. Papers and folders left on desk not to be moved.
4. Waste baskets, other trash receptacles emptied.
5. Chairs and waste baskets returned to proper position.
6. Fingerprints removed from glass doors and partitions.
7. Drinking fountains cleaned, sanitized and polished.
8. Lavatories, toilets and toilet rooms cleaned and mopped. Toilet supplies replenished.
9. Bulb and tube replacements, as required.
10. Emergency exit signage and egress battery replacement (if applicable)
11. Graffiti expunged as needed within two working days after notice by Tenant
12. Floors washed as needed.
13. Standard kitchen/lunchroom/restroom supplies replenished, including, but, not limited to, paper supplies and soap.
14. Non-exclusive day porter service from 7:00 a.m. to 5:00 p.m., Monday through Friday

B. WEEKLY

15. Low-reach areas, chair rungs, baseboards and insides of door jambs dusted.
16. Window sills, ledges and wood paneling and molding dusted.

C. MONTHLY

17. Floors washed and waxed in uncarpeted office area.
18. High-reach areas, door frames and tops of partitions dusted.
19. Upholstered furniture vacuumed, plastic and leather furniture wiped

20. Picture moldings and frames dusted.
21. Wall vents and ceiling vents vacuumed.
22. Carpet professionally spot cleaned as required to remove stains.
23. Intentionally Omitted.

D. QUARTERLY

24. Light fixtures cleaned and dusted, but not less frequently than quarterly.
25. Intentionally Omitted.
26. Draperies or mini-blinds cleaned as required, but not less frequently than quarterly.
27. HVAC units serviced for preventative maintenance purposes, all filters changed.

E. SEMI-ANNUALLY

28. Windows washed as required inside and outside but not less frequently than semi-annually.
29. All painted wall and door surfaces washed and stains removed.
30. All walls treated with vinyl covering washed and stains removed.

F. ANNUALLY

31. Furniture Systems and any other fabric or upholstered surfaces including chairs, couches, walls, etc., spot cleaned, or if determined to be necessary in Tenant's sole discretion, professionally cleaned in their entirety using a water extraction system.
32. Bathroom and any other ceramic tile surfaces professionally cleaned using a hand scrub process. All grout and porous surfaces resealed with a professional grade sealant.
33. Touch-up paint all interior painted surfaces in a color and finish to match existing.

G. AS NEEDED

34. Premises and the sidewalks, driveways, parking areas and all means of access and egress for the Premises should be maintained in good repair, and in clean and safe condition at all times.
35. All lawns, shrubbery and foliage on the grounds of the Premises should be maintained in good condition and neat in appearance. Grass and shrubbery must be replanted as needed to maintain the grounds in good appearance and condition.

36. Interior and exterior pest control inspections and remediation frequency is to be determined by a licensed exterminator.
37. Carpets to be cleaned using a non-detergent, low moisture, soil encapsulation system as recommended by the carpet manufacturer. The following schedule will be maintained for carpet cleaning:
 - i. heavy traffic areas cleaned as needed, with a minimum frequency of bi-monthly [six (6) times per year];
 - ii. moderate traffic areas cleaned as needed, with a minimum of once every six (6) months [two (2) times per year]; and
 - iii. clean light traffic areas a minimum of once per year.

Landlord agrees that bonnet cleaning is not an acceptable method of cleaning carpets.

38. All walls repainted and wall coverings replaced throughout the Premises. The paint finish should be eggshell or semi-gloss as directed by Tenant and in a color acceptable to Tenant. In no event will Landlord be required to repaint or replace wall coverings more than one (1) time in a five (5) year period (the "Occurrence") except for touch-up paint as provided in Paragraph 6.C. of this Exhibit E. The initial tenant improvements completed prior to Tenant's occupancy or as a condition to the renewal of the Lease shall not constitute an Occurrence for the purpose of determining the frequency of this work.
39. All HVAC ducts cleaned as needed, but no less than every five (5) years.

H. GENERAL

Landlord shall, upon request of Tenant, produce written service contracts as evidence of compliance with the terms of this Cleaning and Maintenance Schedule.

1. Subordination. The lien of the Deed of Trust and all amendments, modifications and extensions thereto shall be and remain at all times a lien on the Property prior and superior to the Lease, except that if Tenant is granted any option to extend the Term of the Lease, right of first offer to lease additional premises or option to purchase the Property or right of first offer to purchase the Property in the Lease, such provisions shall not be affected or diminished by any such subordination.

2. Definitions of "Transfer of the Property" and "Purchaser". As used herein, the term "Transfer of the Property" means any transfer of Borrower's interest in the Property by foreclosure, trustee's sale or other action or proceeding for the enforcement of the Deed of Trust or by deed in lieu thereof. The term "Purchaser", as used herein, means any transferee, including Lender, of the interest of Borrower as a result of any such Transfer of the Property and also includes any and all successors and assigns, including Lender, of such transferee.

3. Non-disturbance. The enforcement of the Deed of Trust shall not terminate the Lease or disturb Tenant in the possession and use of the leasehold estate created thereby.

4. Attornment. Subject to Section 3 above, if any Transfer of the Property should occur, Tenant shall and hereby does attorn to Purchaser, including Lender if it should be the Purchaser, as the landlord under the Lease, and Tenant shall be bound to Purchaser under all of the terms, covenants and conditions of the Lease for the balance of the Lease term and any extensions or renewals of it which may then or later be in effect under any validly exercised extension or renewal option contained in the Lease, all with the same force and effect as if Purchaser had been the original landlord under the Lease. This attornment shall be effective and self-operative without the execution of any further instruments upon Purchaser's succeeding to the interest of the landlord under the Lease.

5. Lender Not Obligated. Lender, if it becomes the Purchaser or if it takes possession under the Deed of Trust, and any other Purchaser shall not:

(a) be liable for any damages or other relief attributable to any act or omission of any prior Landlord under the Lease, including Borrower, unless such act or omission continues after the date that Lender or Purchaser succeeds to the interest of such prior landlord; or

(b) be subject to any offset or defense not specifically provided for in the Lease which Tenant may have against any prior landlord under the Lease, unless resulting from a default or breach by such prior landlord which continues after Lender or Purchaser succeeds to the interest of such prior landlord; and provided that any offsets deducted by Tenant prior to the date that Lender or Purchaser succeeds to the interest of such prior landlord shall not be subject to challenge; or

(c) be bound by any prepayment by Tenant of more than one (1) month's installment of rent, unless the Lease expressly requires such prepayment; or

(d) be obligated for any security deposit not actually delivered to Purchaser; or

(e) be bound by any modification or amendment of or to the Lease which materially increases Landlord's obligations under the Lease or materially decreases Tenant's obligation under the Lease, unless Lender has approved such modification or amendment in writing, which approval shall not be unreasonably withheld, conditioned or delayed.

6. Notices. All notices given under this Agreement shall be in writing and shall be given by personal delivery, overnight receipted courier or by registered or certified United States mail, postage prepaid, sent to the party at its address appearing below. Notices shall be effective upon receipt (or on the date when proper delivery is refused). Addresses for notices may be changed by any party by notice to all other parties in accordance with this Section.

To Lender: _____

To Borrower: Omninet Pacific Pointe, LP
9420 Wilshire Blvd., 4th Floor
Beverly Hills, CA 90212
Attention: Michael Danielpour

With a copy to:

Omninet Property Management, Inc.
9420 Wilshire Blvd., 4th Floor
Beverly Hills, CA 90212
Attention: Commercial Operations

To Tenant: County of Los Angeles
Chief Executive Office
Real Estate Division
320 W. Temple Street, 7th Floor
Los Angeles, California 90012
Attention: Director of Real Estate

7. Miscellaneous Provisions. This Agreement shall inure to the benefit of and be binding upon the parties and their respective successors and assigns. This Agreement is governed by the laws of the State of California without regard to the choice of law rules of that State.

TENANT: COUNTY OF LOS ANGELES,
a body corporate and politic

By: _____
Name: _____
Title: _____

BORROWER: OMNINET PACIFIC POINTE, LP,
A Delaware limited partnership

By: Omninet Five GP, LLC,
A California limited liability company
Its: General Partner

By: _____
Name: Michael Danielpour
Title: Manager of General Partner

LENDER: [*Insert name of Lender*],

By: _____
Name: _____
Title: _____

A notary public or other officer completing this certificate verifies only the identity of the individual who signed the document to which this certificate is attached, and not the truthfulness, accuracy, or validity of that document.

STATE OF CALIFORNIA)
) SS.
COUNTY OF _____)

On _____, before me, _____
Date Name And Title Of Officer (e.g. "Jane Doe, Notary Public")
personally appeared _____,
Name of Signer(s)

who proved to me on the basis of satisfactory evidence to be the person(s) whose name(s) is/are subscribed to the within instrument and acknowledged to me that he/she/they executed the same in his/her/their authorized capacity(ies), and that by his/her/their signature(s) on the instrument the person(s), or the entity upon behalf of which the person(s) acted, executed the instrument.

I certify under PENALTY OF PERJURY under the laws of the State of California that the foregoing paragraph is true and correct.

WITNESS my hand and official seal.

Signature (Seal)

EXHIBIT F

TENANT ESTOPPEL CERTIFICATE

To: [Insert name of party to rely on document]

Attn: _____

Re: Date of Certificate: _____

 Lease Dated: _____

 Current Landlord: _____

 Located at: _____

 Premises: _____

 Commencement Date of Term: _____

 Expiration Date: _____

 Current Rent: _____

County of Los Angeles ("Tenant") hereby certifies that, to its actual knowledge, as of the date hereof:

1. Tenant is the present holder of the tenant's interest under the lease described above, as it may be amended to date (the "Lease"). The Lease covers the premises described above (the "Premises") in the building (the "Building") at the address set forth above.

2. (a) A true, correct and complete copy of the Lease (including all modifications, amendments, supplements, side letters, addenda and riders of and to it) is attached to this Certificate as Exhibit A.

 (b) The current Rent is set forth above.

 (c) The term of the Lease commenced on the Commencement Date set forth above and will expire on the Expiration Date set forth above, including any presently exercised option or renewal term. Tenant has no option or right to renew, extend or cancel the Lease, or to lease additional space in the Premises or Building, or to use any parking other than that specified in the Lease.

 (d) Except as specified in the Lease, Tenant has no option or preferential right to purchase all or any part of the Premises (or the land of which the Premises are a part).

 (e) Tenant has made no agreement with Landlord or any agent, representative or employee of Landlord concerning free rent, partial rent, rebate of rental payments or any other similar rent concession except as expressly set forth in the Lease.

3. (a) The Lease constitutes the entire agreement between Tenant and Landlord with respect to the Premises, has not been modified changed, altered or amended, except as set forth in Exhibit A, and is in full force and effect. There are no other agreements, written or oral, which affect Tenant's occupancy of the Premises.

[(b) To the knowledge of Tenant, Tenant has not given Landlord written notice of a material default under the Lease which has not been cured.]

(c) Tenant's interest in the Lease has not been assigned or encumbered.

(d) Tenant is not entitled to any credit against any rent or other charge or rent concession under the Lease, except as set forth in the Lease.

(e) No rental payments have been made more than one (1) month in advance.

4. All contributions required to be paid by Landlord to date for improvements to the Premises have been paid in full, and all of Landlord's obligations with respect to tenant improvements have been fully performed, except: _____.

IN WITNESS WHEREOF, the Tenant has executed this Tenant Estoppel Certificate as of the day set forth above.

COUNTY OF LOS ANGELES,
a body corporate and politic

By: _____
Name: _____
Title: _____

EXHIBIT G

COMMUNITY BUSINESS ENTERPRISE FORM

INSTRUCTIONS: All Landlords shall submit this form on an annual basis on or before December 30th of each year of the term of this agreement as evidence of MBE/WBE participation. The information requested below is for statistical purposes only. The final analysis and consideration of the lease will be determined without regard to race, creed, color or gender. *(Categories listed below are based on those described in 49 CFR Section 23.5)*

I. Minority/Women Participation in Firm (Partners, Associate Partners, Managers, Staff, etc.)

1. Firm Name: _____ 2. Address: _____ _____ _____	3. Contact Person/Telephone Number: _____ _____ _____ 4. Total number of employees in the firm: _____
--	--

5. Provide the number of all minority employees and women in each category.	Owners, Partners and Associate Partners		Managers		Staff	
	All O,P & AP	Women	All Managers	Women	All Staff	Women
Black/African American						
Hispanic/Latin American						
Asian American						
Portuguese American						
American Indian/Alaskan Native						
All Others						

II. PERCENTAGE OF MINORITY/WOMEN OWNERSHIP IN FIRM

1. Type of Business Structure: (Corporation, Partnership, Sole Proprietorship, Etc.) _____

2. Total Number of Ownership/Partners, Etc.: _____	III. MINORITY/WOMEN-OWNED FIRM CERTIFICATION		
3. Provide the percentage of ownership in each category.	All Employees	Women	Is your firm currently certified as a minority owned business firm by the:
Black/African American			State of California? <input type="checkbox"/> Yes <input type="checkbox"/> No
Hispanic/Latin American			City of Los Angeles? <input type="checkbox"/> Yes <input type="checkbox"/> No
Asian American			Federal Government? <input type="checkbox"/> Yes <input type="checkbox"/> No
Portuguese American			

Section D. OPTION TO PROVIDE REQUESTED INFORMATION

American Indian/Alaskan Native			<input type="checkbox"/> We do not wish to provide the information required in this form. Firm Name: _____ Signature/Title: _____ Date: _____
All Others			
			

EXHIBIT H

MEMORANDUM OF LEASE

**RECORDING REQUESTED BY AND
WHEN RECORDED MAIL TO:**

County of Los Angeles
Chief Executive Office
Real Estate Division
320 W. Temple Street, 7th Floor
Los Angeles, California 90012
Attention: Director of Real Estate

This document is recorded for the benefit of the County of Los Angeles and recording is exempt from recording fees pursuant to California Government Code Section 27383. This transaction is exempt from documentary transfer tax pursuant to California Revenue and Taxation Code Section 11922.

MEMORANDUM OF LEASE

This Memorandum of Lease ("Memorandum") is made and entered into by and between OMNINET PACIFIC POINTE, LP, a Delaware limited partnership (the "Landlord"), and the COUNTY OF LOS ANGELES, a public body corporate and politic, duly organized and existing under the laws of the State of California (the "Tenant"), who agree as follows:

Landlord and Tenant have entered into an unrecorded lease dated _____, 20__ (the "Lease") of certain real property located in the County of Los Angeles, State of California, described in Exhibit A attached hereto and incorporated herein by reference, for a term commencing on _____, 20__, and ending on a date _____ years after the commencement date, unless such term is extended or sooner terminated pursuant to the terms and conditions set forth in the Lease.

This Memorandum has been prepared for the purpose of giving notice of the Lease and of its terms, covenants, and conditions, and for no other purposes. The provisions of this Memorandum shall not in any way change or affect the provisions of the Lease, the terms of which remain in full force and effect.

Dated: _____, 20__.

LANDLORD:

OMNINET PACIFIC POINTE, LP,
A Delaware limited partnership

By: Omninet Five GP, LLC,
A California limited liability company
Its: General Partner

By:

Name: Michael Danielpour
Title: Manager of General Partner

TENANT:

COUNTY OF LOS ANGELES,
a body corporate and politic

FESIA A. DAVENPORT
Chief Executive Officer

By: _____
John T. Cooke
Assistant Chief Executive Officer

ATTEST:

DEAN C. LOGAN
Registrar-Recorder/County Clerk
of the County of Los Angeles

By: _____
Deputy

APPROVED AS TO FORM:

DAWYN R. HARRISON
Interim County Counsel

By: _____
Senior Deputy

A notary public or other officer completing this certificate verifies only the identity of the individual who signed the document to which this certificate is attached, and not the truthfulness, accuracy, or validity of that document.

STATE OF CALIFORNIA)
) SS.
COUNTY OF _____)

On _____, before me, _____
Date Name And Title Of Officer (e.g. "Jane Doe, Notary Public")
personally appeared _____,

Name of Signer(s)

who proved to me on the basis of satisfactory evidence to be the person(s) whose name(s) is/are subscribed to the within instrument and acknowledged to me that he/she/they executed the same in his/her/their authorized capacity(ies), and that by his/her/their signature(s) on the instrument the person(s), or the entity upon behalf of which the person(s) acted, executed the instrument.

I certify under PENALTY OF PERJURY under the laws of the State of California that the foregoing paragraph is true and correct.

WITNESS my hand and official seal.

Signature (Seal)

EXHIBIT I

LANDLORD'S WORK LETTER

LANDLORD'S WORK LETTER

For

**COUNTY OF LOS ANGELES
CHIEF EXECUTIVE OFFICE
LEASE AGREEMENT**

**COUNTY OF LOS ANGELES, as Tenant
OMNINET PACIFIC POINTE LP, as Landlord**

**879 WEST 190TH STREET, SUITE 720
GARDENA, CALIFORNIA 90248**

LANDLORD'S WORK LETTER

This Work Letter supplements the Lease Agreement (the "Lease") dated _____, 2024, executed concurrently herewith, by and between Omninet Pacific Pointe LP, a Delaware Limited Partnership, as Landlord, and COUNTY OF LOS ANGELES, a body corporate and politic, as Tenant, covering certain Premises described in the Lease. Terms capitalized but not otherwise defined herein shall have the meanings ascribed to them in the Lease.

The parties hereby agree as follows:

1. **Basic Work Letter Information.** The following terms as used herein shall have the meanings provided in this Section unless otherwise specifically modified by provisions of this Work Letter.

- | | |
|---|--|
| (a) <u>Total TI Costs</u> | \$2,491,580.00 (i.e., \$185.00 per rentable square foot of the Premises) |
| (i) <u>Landlord's TI Allowance</u> | \$673,400.00 (i.e., \$50.00 per rentable square foot of the Premises) |
| (ii) <u>Tenant's TI Contribution</u> | \$1,818,180.00 (i.e., \$135.00 per rentable square foot of the Premises) |
| (b) <u>TI Amortization Rate and Change Authorization Amortization Rate:</u> | Not applicable |
| (c) <u>Tenant's Work Letter Representative</u> | An assigned staff person of the Chief Executive Office-Real Estate Division |
| (d) <u>Landlord's Work Letter Representative</u> | William Molina or an assigned staff person of the Landlord |
| (e) <u>Landlord's Address for Work Letter Notices</u> | OMNINET PACIFIC POINTE, LP
9420 Wilshire Blvd, Fourth Floor
Beverly Hills, CA 90212
Email: williamm@omninet.com |

With a copy to:

OMNINET PACIFIC POINTE, LP
9420 Wilshire Boulevard, Suite 400
Beverly Hills, California 90212
Attention: Michael Danielpour

And to:

Omninet Property Management, Inc.
9420 Wilshire Boulevard, Suite 400
Beverly Hills, California 90212
Attention: Commercial Operations

(f) Tenant's Address for Work Letter Notices

County of Los Angeles
Chief Executive Office - Real Estate
Division
320 West Temple Street, 7th Floor
Los Angeles, CA 90012
Attention: Director of Real Estate

(g) Addenda

Addendum A: Base Building
Improvements
Addendum B: Tenant Improvements
Addendum C: Form of Preliminary and
Final TI Cost Summary

2. Construction of the Building.

2.1 Base Building Improvements. Landlord has constructed or shall construct the base building improvements described on Addendum A hereto (the "Base Building Improvements") as a part of the Building. If the Base Building Improvements must be changed or added to in order to accommodate the special needs of Tenant in the Premises, such changes or additions shall not be considered Tenant Improvements (as defined below) unless such changes or additions are specifically described in Addendum B hereto.

2.2 Additional Costs Not Total TI Costs.

(a) If the Building as initially constructed does not comply with current life-fire safety codes, disabled access codes (including, without limitation, the Americans with Disabilities Act of 1990 (ADA), and/or earthquake safety codes, and Landlord incurs increased design or construction costs that it would not have incurred if the Building had been in compliance with such codes, then such costs shall not be included in the calculation of Total TI Costs (as defined below), and Tenant shall have no financial responsibility for such costs.

(b) Landlord must identify all noncompliant code related items utilizing an independent third-party expert at Landlord's sole cost and expense. Any work that Landlord must undertake to cause the Premises to comply with the access requirements of the ADA or to make existing building systems, including but not limited to electrical service and HVAC equipment, fully operational shall be at Landlord's sole cost and expense. Total TI Costs shall not include any costs associated with (i) asbestos abatement or compliance with the Hazardous Materials provision of the Lease, including all expenses associated with curing any "Sick Building Syndromes", (ii) code compliance work required for the existing fire sprinkler system including pump house, main lines or other portion of the existing fire sprinkler system located outside of the Premises, however, any modification or upgrade of the fire sprinkler system located within the Premises (as opposed to outside of the Premises) required to accommodate the Tenant Improvements shall be included as part of the Tenant Improvement Costs, (iii) conversion of air conditioning systems to eliminate use of CFC refrigerants that are harmful to the atmosphere, (iv) utility costs incurred during construction, (v) costs incurred in order to cause the Premises to comply with any mechanical or electrical requirements set forth in the Lease, nor (v) supervision or overhead costs of Landlord.

(c) Landlord shall be solely responsible for all costs and expenses necessary to increase and / or maintain existing structural floor loading in order to accommodate Tenant's libraries, file rooms, unusual live loads and other such uses. If Tenant's floor loading requirements exceeds the structural floor loading capacity of the Building, then all costs of increasing the floor loading shall be included as part of Tenant's TI Contribution.

(d) Tenant shall have the right at any time prior to the Commencement Date to field-measure and verify the exact footage of the Premises and/or the Building. All measurements shall be taken in accordance with the methods of measuring rentable area as described in the Standard Method for Measuring Floor Area in Office Buildings, ANSI/BOMA Z65.1-2017, Method A, as promulgated by the Building Owners and Management Association ("BOMA") International, except that no penthouse mechanical room space shall be included in the measurement. A copy of such measurement report shall be delivered to Landlord. Landlord and Tenant hereby agree there will be no modification made to the Base Rent if the remeasured square footage exceeds or is less than the amount set forth in Section 1.1(c) of the Lease. The cost of such measurement shall be a Total TI Cost.

2.3 **Base Building Plans.** Landlord has delivered to Tenant complete and accurate "as built" plans and specifications for the Building in an AutoCAD 2015 (or later version) and Adobe PDF electronic format. If Tenant incurs additional costs because such plans and specifications are incomplete or inaccurate, then any delay caused thereby shall not be a Tenant Delay (as defined below), but shall be deemed to be a delay caused by Landlord, and Landlord shall pay for any increased costs caused by such delay.

2.4 **Survey.** Where 'as-built' plans are missing, Landlord must perform a survey of existing space, which shall include existing floor plans and mechanical, electrical, and plumbing systems. The survey shall be at Landlord's sole cost and expense. Landlord shall submit such survey to the Tenant such that the initial Space Plan (as defined in Section 5.1) can be modified to conform to the existing conditions.

3. **Selection of Architect and Engineer.** Landlord shall not proceed with any bid solicitation for architectural services until final space plan is furnished to the Landlord. Once Landlord receives the final space plan, Landlord shall promptly solicit at least three (3) proposals from qualified licensed architects and engineers familiar with all applicable laws and building requirements detailing a scope of work sufficient to complete the Working Drawings (as defined below). Landlord and Tenant shall receive the bids conterminously from each of the (3) bidders and shall meet within five (5) business days of receiving the bids to jointly review the bids. Landlord shall select an architect and an engineer, subject to Tenant's acceptance, which shall not be unreasonably withheld, and which acceptance (or rejection for reasonable reasons) shall be granted within five (5) business days after Landlord has submitted the name of the selected architect and the selected engineer to Tenant, together with detailed proposals outlining the cost for design/engineering services. This procedure shall be repeated until Tenant accepts an architect (the "Architect") and an engineer (the "Engineer"), and Tenant's written acceptance has been delivered to and received by Landlord.

4. **Selection of Contractor.** The Final Plans (as defined below) and a proposed construction contract accepted by Tenant shall be submitted to a sufficient number of qualified contractors, selected by Landlord, so that a minimum of three (3) bids are received. Each contractor shall be requested to submit a sealed fixed price contract bid price (on an American Institute of Architects (AIA) form) to construct the Tenant Improvements depicted on the Final Plans. Landlord and Tenant shall receive the bids conterminously from each of the (3) bidders

and shall meet within five (5) business days of receiving the bids to jointly review the bids. Landlord shall select the most qualified bidder offering the lowest price after adjustments for inconsistent assumptions, and Landlord shall submit all bids, along with Landlord's recommendation, to Tenant for Tenant's review and acceptance. Following Tenant's acceptance, Landlord shall enter into a construction contract (the "Construction Contract") with the lowest qualified bidder (the "Contractor") to construct the Tenant Improvements, consistent with the terms of the accepted bid.

5. Preparation of Plans and Specifications and Construction Schedule.

5.1 **Preparation of Space Plan.** Concurrently with the execution of this Lease, Tenant shall submit to Landlord specifications for the Premises, which shall include a space plan, and when available, low voltage and furniture plans and shall depict, without limitation, all demising walls, corridors, entrances, exits, doors, and interior partitions, and the locations of all offices, conference rooms, computer rooms, mini-service kitchens, and the reception area, library, and file room (collectively, the "Space Plan").

5.2 **Preparation and Review of Working Drawings.** Within thirty (30) days after the date the Space Plan is submitted to Landlord (the "Plan Submission Date"), Landlord shall instruct the Architect to commence preparation of working drawings (the "Working Drawings"), which shall (a) be consistent with the Space Plan and the Preliminary TI Cost Summary (as defined below), (b) be compatible with the design, construction and equipment of the Building, (c) comply with all applicable laws, (d) be capable of physical measurement and construction, (e) contain all information required for the construction of the Tenant Improvements and the preparation of the Engineering Drawings (as defined below), and (f) include all partition locations, plumbing locations, air conditioning system and duct work, special air conditioning requirements, reflected ceiling plans, office equipment locations, and special security systems. The Working Drawings may be submitted in one or more stages and at one or more times provided that a schedule to submit the Working Drawings is provided to, and approved by, the Tenant. Landlord shall provide Tenant the Working Drawings, or such portion thereof as has been submitted, for Tenant's review and acceptance. Landlord shall be solely responsible for ensuring that the Working Drawings fully comply with all applicable building codes and cover any expenses that result from the errors, omissions or inconsistencies in the Architect's Instruments of Service.

5.3 **Preparation and Review of Engineering Drawings.** As part of the Total TI Costs, Landlord shall cause the Architect to coordinate with the Engineer and to integrate all engineering drawings prepared by the Engineer, including but not limited to complete mechanical, electrical, HVAC, and plumbing plans ("Engineering Drawings"), into the Working Drawings. The Engineering Drawings may be submitted in one or more stages and at one or more times for Tenant's review and acceptance.

5.4 **Integration of Working Drawings and Engineering Drawings into Final Plans.** After Tenant has accepted the Engineering Drawings, Landlord shall, as part of the Total TI Costs, cause the Architect to integrate the accepted Working Drawings with the accepted Engineering Drawings (collectively "Final Plans") and deliver the Final Plans to Tenant for Tenant's review in an AutoCAD 2015 (or later version) and Adobe PDF electronic format via a downloadable web-based link. The Final Plans shall be suitable for plan check review and permitting by local agencies having jurisdiction, for the layout, improvement and finish of the Premises consistent with the design and construction of the Base Building Improvements, including electrical and mechanical drawings, capacity reports, dimensioned partition plans, floor and wall finish plans, reflected ceiling plans, power, telephone communications and data plans, life safety devices,

construction detail sheets including millwork detail plans showing the location of partitions, light fixtures, electrical outlets, telephone outlets, sprinklers, doors, equipment specifications (including weight specifications and cooling requirements), power requirements (including voltage, amps, phase, and special plugs and connections), wall finishes, floor coverings, millwork and other Tenant Improvements. Landlord's review of the Space Plan, Working Drawings, Engineering Drawings, and Final Plans shall be at Landlord's sole cost and expense and shall not be unreasonably withheld, conditioned, or delayed.

5.5 Tenant's Plan Review and Acceptance. Tenant shall accept or reject the Working Drawings, the Engineering Drawings and the Final Plans within twenty-one (21) calendar days after Tenant receives the applicable plans and drawings from Landlord. If Tenant rejects any such plans or drawings, then Tenant shall notify Landlord thereof, specifying in detail the reason for such rejection, in which case Landlord shall revise the applicable plans or drawings and deliver revised plans or drawings to Tenant within fourteen (14) calendar days after receipt of Tenant's rejection notice. This procedure shall be repeated until the applicable plans are accepted by Tenant. Tenant's acceptance of the Working Drawings, Engineering Drawings and/or the Final Plans shall not be deemed to be a representation by Tenant as to the adequacy or correctness of the design of the Tenant Improvements.

5.6 Schedule. Within thirty (30) calendar days of the Plan Submission Date, Landlord shall submit to Tenant a detailed baseline construction schedule, subject to acceptance by Tenant, which shall not be unreasonably withheld, setting forth the completion dates of certain project milestones, including but not limited to completion of Working Drawings, completion of Engineering Drawings, submission of plans to local jurisdiction for review, issuance of building permit, submission of plans to contractors for bidding, award of the Construction Contract, construction commencement date, interim schedule milestone dates, and the date of Substantial Completion. The schedule shall be apportioned by construction activity and include time required for the completion of each portion of the work. As the construction continues, Landlord shall amend the construction schedule at least once each month to reflect any changes to the projected dates, and Landlord shall promptly submit the revised construction schedules to Tenant.

5.7 Submittals. The Landlord or Contractor shall submit to Tenant any Shop Drawings, Product Data Sheets / Samples or similar submittals required by the Final Plans in coordination with the construction schedule and with reasonable promptness, so as not to cause any delay in the construction of the Tenant Improvements. The purpose of Shop Drawings, Product Data, Samples and similar submittals is to demonstrate the way by which the Contractor proposes to construct a design concept expressed in the Final Plans. "Shop Drawings" include drawings, diagrams, schedules and other data specially prepared by the Contractor or a subcontractor, manufacturer, supplier or distributor to illustrate some portion of the Tenant Improvements. "Product Data Sheets / Samples" include illustrations, summary performance charts, instructions, brochures, diagrams, manufacturer specifications (if available) and other information furnished by the Landlord or Contractor to illustrate materials or equipment for some portion of the Tenant Improvements. "Samples" are physical examples that illustrate materials, equipment or workmanship for some portion of the Tenant Improvements. The Contractor shall construct no portion of the Tenant Improvements for which the Final Plans require submittal and review of Shop Drawings, Product Data, Samples or similar submittals until the respective submittal has been reviewed and accepted by the Architect.

6. Landlord's TI Cost Summary and Payment of Total TI Costs.

6.1 Cost Summary. Within twenty-one (21) calendar days after the Plan Submission Date, Landlord shall submit to Tenant a preliminary cost summary for the Tenant Improvements in a format similar to Addendum C attached hereto (the "Preliminary TI Cost Summary"), which must not exceed the sum of Landlord's TI Allowance and Tenant's TI Contribution. The Preliminary TI Cost Summary shall be revised into final form within ten (10) days after the date that the Contractor is selected and will be referred to herein as the "Final TI Cost Summary". Tenant shall have fourteen (14) calendar days after the date of receipt of the Final TI Cost Summary to accept or reject the Final TI Cost Summary, including but not limited to any Contractor overhead, profit and/or general conditions costs included therein; provided, however, that any proposed increase to Tenant's TI Contribution shown on the Final TI Cost Summary shall not be effective unless approved by a separate written agreement executed by Landlord and Tenant. Tenant's failure to accept or reject the Final TI Cost Summary in writing within such period shall be deemed to be rejected. Construction of the Tenant Improvements shall not begin until Tenant accepts the Final TI Cost Summary in writing, which approval shall not be unreasonably withheld, conditioned or delayed, and any delay by providing its approval of the Final TI Cost Summary shall extend the two hundred seventy (270) day time period set forth in Section 4.2 of the Lease on a day for day basis until Tenant provides its approval of the Final TI Cost Summary. If Tenant rejects the Final TI Cost Summary due to matters related to cost and the Final TI Cost Summary is ten percent (10%) or more higher in cost than projected in the Preliminary TI Cost Summary, then, at Tenant's request, Landlord shall cause the Architect and the Engineer to redesign the Tenant Improvements, at a cost to be deducted from Total TI Costs, to comply with the Preliminary TI Cost Summary, and any delay caused by the necessity to rebid or redesign the Tenant Improvements shall extend, on a day for day basis until the Tenant Improvements are redesigned and approved by Tenant, the two hundred seventy (270) day time period set forth in Section 4.2 of the Lease. If Tenant rejects the Preliminary TI Cost Summary or the Final TI Cost Summary, the parties shall promptly confer to resolve all issues relating thereto.

6.2 Landlord's TI Allowance and Tenant's TI Contribution. All improvements required by the Final Plans, as further described in Addendum B hereto, and any and all modular furniture described in the Modular Specifications (as defined below) shall be referred to herein, collectively, as "Tenant Improvements" or "TI." Costs of Tenant Improvements shall include costs for furniture, telecommunications equipment, if any, soft costs, and any other costs approved in writing by Tenant (collectively "Total TI Costs"), all of which must not exceed the sum of Landlord's TI Allowance, Tenant's TI Contribution, and the cost of any Change Authorizations (as defined below) that are approved in writing by both parties. Landlord shall be solely responsible for any delay or increased cost in completing the Tenant Improvements, except for delays or costs arising from Tenant Delays, Force Majeure or Change Authorizations as defined below. Except as otherwise provided herein, all Total TI Costs shall be paid by Landlord and deducted from Landlord's TI Allowance. If the Total TI Costs exceed Landlord's TI Allowance, then Tenant may authorize Landlord to pay the overage in an amount not exceeding Tenant's TI Contribution. Thereafter, Tenant shall pay such overage to Landlord as provided in Section 6.3 below.

6.3 Method of Payment. Tenant shall pay Landlord that portion of Tenant's TI Contribution used to pay for any Total TI Costs in excess of the Landlord's TI Allowance in a lump sum, within sixty (60) calendar days after all of the following conditions have been met: (i) Tenant Improvements are Substantially Complete (as defined in the Lease); and (ii) Landlord has provided Tenant with all documentation substantiating all Tenant Improvements' expenses, including, without limitation, receipts, invoices, proof of payment, unconditional lien releases and approved change orders, on a flow basis, so that Tenant may reconcile all Total TI Costs to

determine and confirm the total TI Costs spent and the amount of Tenant's TI Contribution owed to Landlord. Such payment shall be made in a lump sum.

6.4 Base Rent Credit for Unused Portions of Landlord's TI Allowance. If the Total TI Costs are less than the Landlord's TI Allowance, then the amount of any unused portion of the Landlord's TI Allowance shall be applied as a credit against the next installment(s) of Base Rent due under the Lease.

7. Construction of Tenant Improvements.

7.1 Tenant Improvements. Tenant Improvements to be constructed by Landlord are described more particularly on Addendum B hereto. If any work required by the Final Plans is not described on Addendum B hereto, such work shall be considered a Base Building Improvement and shall be performed by Landlord at its own cost and expense and not included in the cost of Tenant Improvements.

7.2 Bids. Unless waived by Tenant in writing, any major contractors, subcontractors and material suppliers providing labor and/or materials for the Tenant Improvements shall be selected only after a minimum of three (3) bids have been solicited from responsible and qualified persons. The bids shall include an itemized list of all materials and labor and shall include all additional costs, including architects and engineering fees, permits, reasonable contractor's profit and overhead, and project management fees. Landlord shall also obtain a minimum of three (3) bids from responsible and qualified bidders for the purchase and installation of Tenant's office furniture system, if applicable, in accordance with Section 9.1 below.

7.3 Permits. As part of the Total TI Costs, Landlord shall obtain the approval of all applicable governmental authorities and all permits required for the Tenant Improvements, promptly after Tenant's acceptance of the Final Plans. Landlord shall obtain plan check approval prior to soliciting bids from contractors pursuant to Section 4 hereof. Landlord agrees to submit the Final Plans to plan check for approval within twenty-five (25) days after Tenant's acceptance of the Final Plans. Subject to Force Majeure, Change Authorizations and Tenant Delays, if Landlord does not timely submit the Tenant-accepted Final Plans by the expiration of such twenty-five (25) day period, Tenant shall deliver written notice of such failure to Landlord and if Landlord does not submit the accepted Final Plans to plan check within ten (10) days after receipt of Tenant's written notice, and if as a result of such failure to timely submit the accepted Final Plans to plan check, the Commencement Date does not occur within two hundred seventy (270) days following the date of Landlord's receipt of the final governmental building permit, then Tenant shall have the right to exercise the remedies set forth in Section 14 below.

7.4 Commencement of Construction. Landlord shall commence construction of the Tenant Improvements within thirty (30) calendar days after the issuance of the necessary permits and governmental approvals. Contractor shall obtain the building permit for the Tenant Improvements prior to the commencement of construction. Thereafter, Landlord shall diligently proceed to construct and complete all Tenant Improvements in a good and workmanlike manner, subject only to any cessation that may be caused by Force Majeure Delays (as defined below) and/or Tenant Delays.

7.5 Construction. Construction of the Tenant Improvements will be subject to the following terms and conditions:

(a) Notice of Nonresponsibility. Landlord and the Contractor shall cooperate with Tenant in posting a notice or notices of nonresponsibility by Tenant in compliance with California Civil Code Section 8444.

(b) Decorating Decisions. As part of the Total TI Costs, all design and programming, space planning and interior decorating services, such as selection of wall paint colors and/or wall coverings, furniture, fixtures, flooring and base, and any other decor selection efforts required by Tenant, shall be provided by Landlord in accordance with Tenant's Space Plan. Landlord shall consult with Tenant with respect to all such decorating services and decisions.

(c) Warranties. As part of the Total TI Costs, Landlord shall cause the Contractor to issue a warranty stating that the Tenant Improvements shall be free from any defects in workmanship and materials for a period of not less than one (1) year from the date of Substantial Completion (as defined in the Lease); provided, however, Tenant may request that Contractor extend the one (1) year construction defect warranty for an additional one (1) year (for a total of two (2) years of construction defect warranty), in which case, Tenant shall pay, as part of the Tenant's TI Contribution, the cost charged by the Contractor for extending the construction defect warranty for an additional one (1) year. Landlord shall require each contractor and subcontractor to provide warranties of like duration in all construction contracts relating to the Tenant Improvements and, upon Tenant's request, Landlord shall assign to Tenant any such warranties relating to the Tenant Improvements. Patent defects in the Tenant Improvements shall be brought to Landlord's attention promptly. Latent or hidden defects in the Tenant Improvements shall be brought to Landlord's attention promptly upon Tenant's becoming aware of such defects. Landlord shall promptly cause such defects to be repaired following receipt of notice thereof, and Tenant shall have the same rights with respect thereto as set forth herein for all other punch-list items, subject to applicable warranties.

(d) Clean-Up and Substandard Work. As part of the Total TI Costs, Landlord will be responsible for all clean-up with respect to the Tenant Improvements, whether in the Premises or in other areas utilized by Landlord or its contractors, and Landlord agrees to reimburse Tenant for any and all reasonable expenses incurred by Tenant by reason of substandard work performed by Landlord's contractor or contractors (as reasonably determined by Tenant according to the usual standards of work in the Building) or as a result of inadequate clean-up.

(e) Compliance with Laws. As part of the Total TI Costs, the Premises shall comply with all applicable city, county, state and federal building codes, regulations and ordinances required for beneficial occupancy, including but not limited to all provisions of the California Labor Code. **Without limiting the generality of the foregoing, construction of the Tenant Improvements shall comply with all applicable laws and regulations, including but not limited to the provisions of the California Labor Code relating to the payment of prevailing wages on public works projects, unless the work is otherwise exempt therefrom pursuant to the California Labor Code. Under the provisions of the Labor Code, the State Department of Industrial Relations will ascertain the prevailing hourly wage rate and details pertinent thereto for each craft, classification, or type of workman or mechanic needed for the construction of the Tenant Improvements. Particulars of the current prevailing wage scale, as approved by the Board of Supervisors, which are applicable to the work, are filed with the Clerk of the Board of Supervisors and must be posted at the site. Notwithstanding the foregoing or any language to the contrary contained herein, the payment of prevailing wages according to the current prevailing wage scale and compliance with applicable prevailing wage statutes shall be required where there is a**

Tenant's TI Contribution made towards the Total TI Costs of the Tenant Improvements to be performed.

(f) Access During Construction. Tenant shall have the right to conduct site visits to observe progress of the Tenant Improvements during the course of construction. Additionally, pursuant to Section 4.3 of the Lease, Tenant shall be entitled to enter the Premises upon delivery of written notice at least thirty (30) calendar days prior to the Commencement Date, for the sole purpose of installing Tenant's furniture, fixtures and equipment in the Premises. Landlord and Tenant shall use reasonable good faith efforts to coordinate the work of their respective contractors to achieve timely completion of the Tenant Improvements and Tenant's installation work.

7.6 Completion/Close Out. The Premises shall not be considered Substantially Complete until the Tenant Improvements have been completed in accordance with the Final Plans and Section 4.1 of the Lease, subject only to the completion of minor punch-list items that will not interfere with Tenant's use and occupancy of the Premises for Tenant's permitted and intended use under the Lease. Upon Substantial Completion of the Tenant Improvements, Landlord shall notify Tenant in writing and, within ten (10) business days of Tenant's receipt of such notice, Landlord and Tenant shall conduct a "walk-through" inspection of the Premises and prepare a punch-list of known or apparent deficiencies or incomplete work required to be corrected or completed by Landlord. Landlord shall cause all punch-list items to be repaired or completed as soon as possible, but in no event later than thirty (30) days following the walk-through inspection, with the costs of such punch list items, if any, to be allocated to Landlord or Tenant, based on the party originally responsible for the cost of the item to be corrected. Any new or additional items added by Tenant to the punch list (which are not punch list items of deficiencies or incomplete work) shall be at Tenant's cost as part of Tenant's TI Contribution.

7.7 Conformed Plans. Within sixty (60) days after Substantial Completion of the Tenant Improvements and Landlord's receipt from the Contractor of all field changes, Landlord shall submit to Tenant a set of conformed plans ("as-builts") incorporating, in accordance with standard industry custom and practice, field changes made and changes and/or revisions that have been made subsequent to the submission of the Final Plans. Such "as-built" or "record documents" shall be submitted in an AutoCAD 2015 (or later version) format, along with one complete set of plans and specifications Adobe PDF electronic format via USB flash drive and set up of a web-based download link.

8. Requests for Change. Tenant and Landlord may request changes, additions, deletions or substitutions in the Final Plans (each, a "Request for Change"), provided that the requesting party must submit a written request to the other party and that Requests for Change will not be effective unless approved in writing by both Tenant and Landlord (a "Change Authorization"). At the time a Request for Change, Landlord shall inform Tenant of the number of days of delay caused by the Change Authorization. The two hundred seventy (270) day period for Landlord to complete the work described in Section 4.2 of the Lease shall be extended on a day for day basis for each day of delay due to the Change Authorization and the Project Commencement Date shall be extended on a day for day basis for each day of delay due to the Change Authorization.

Only the County's Chief Executive Officer or his/her designee is authorized to execute Change Authorizations on behalf of Tenant. If Tenant requests any changes or substitutions to the Tenant Improvements after the Final Plans and the Final TI Cost Summary have been accepted ("Tenant Requested Changes"), then any additional costs related thereto in excess of Landlord's TI Allowance shall be paid by Tenant, provided that Tenant executes a written Change Authorization

prior to the performance of the applicable work. Tenant shall be obligated to pay Landlord for the Tenant Request for Change as part of Tenant's portion of Tenant's TI Contribution used to pay for any Total TI Costs in excess of Landlord's TI Allowance as defined in Section 6.3. Such costs shall be paid in a lump sum, within sixty (60) days as required under Section 6.3. Landlord shall be solely responsible for the cost of any Change Authorizations or other Requests for Change that are not Tenant-Requested Changes or approved by the Chief Executive Officer or his/her designee, except for requirements of governmental agencies to achieve Tenant's approved tenant improvements. Landlord shall submit to the Chief Executive Officer or his/her designee with each Request for Change: (i) the specific cost of the requested change, (ii) the cumulative net total cost of all Change Authorizations previously executed, and (iii) an estimate of the number of days by which the construction time will be increased or shortened if the Request for Change is approved. Each Change Authorization must be signed and dated by tenant department, Landlord and the Chief Executive Officer or his/her designee in order to be effective.

9. Furniture System.

9.1 Tenant shall deliver to Landlord within fourteen (14) calendar days after the date of full execution of this Work Letter, modular furniture plans and specifications (the "Modular Specifications"). Based on the Modular Specifications, Landlord and /or Landlord's architect shall prepare a modular furniture specifications bid package for submission to no less than three (3) furniture vendors. The bid package shall be broken down into separate line items for material, delivery, and sales tax, and each furniture item shall be broken down by unit price, quantities, description and specification. Prior to submission for bids, Landlord shall review the bid package with Tenant, and Tenant shall have the right to accept or reject the bid package. Landlord shall order the modular furniture set forth in the Modular Specifications and install the same within the Premises, all of which shall be a Total TI Cost, payable by Landlord and/or Tenant as provided in Section 6.2 and Section 6.3 hereof. Tenant's acceptance of any bid package shall not be deemed to be a representation by Tenant as to the adequacy or correctness of any specifications contained therein.

9.2 Alternatively, Tenant may elect to finance the cost of modular furniture through lease-purchase financing with a third-party lender ("Creditor"). If Tenant elects to enter into a lease-purchase financing of any furniture or telecommunications equipment (individually or collectively, "Personal Property") through a Creditor, Landlord expressly agrees as follows:

(a) The Personal Property shall not become part of the real property, but shall remain personal property removable by the Creditor and its assigns, provided that any damage to the Building or the Premises caused by such removal shall be repaired by Creditor.

(b) Landlord must receive written notice from Creditor of any plan by Creditor to remove the Personal Property from the Building.

(c) This Section 9.2 shall be binding on the representatives, successors and assigns of all parties hereto and shall inure to the benefit of the successors-in-interest to all parties hereto.

(d) Landlord hereby waives any right to gain possession of any of Personal Property during the term of the Lease.

10. Total TI Costs Adjustment and Right to Audit. Within ten (10) business days of the issuance of a Certificate of Occupancy for the Premises or a final sign-off by the City of Los Angeles building inspector, whichever occurs first, Landlord shall provide to Tenant a statement showing (a) all Total TI Costs in reasonable detail and sorted into the same line items as the Final TI Cost Summary, and (b) the amount of Total TI Costs that is in excess of Landlord's TI Allowance and payable hereunder by Tenant to Landlord. Upon approval of such statement by Tenant, payments by either party pursuant to the Lease and this Work Letter shall be adjusted as appropriate based upon such statement. Tenant shall have the right to audit the Total TI Costs at any time until the fifth (5th) annual anniversary of the date of Tenant's Acceptance of the Premises (the "Audit Expiration Date") (and as of the Audit Expiration Date such audit right shall terminate and be of no further force or effect); provided, however, if this Lease shall be terminated prior to the Audit Expiration Date, then Tenant's audit right shall terminate as of the date of the termination of this Lease. If the audit shows that Tenant is entitled to a reduction in payments made by Tenant to the Landlord pursuant to this Work Letter, then Tenant shall provide Landlord with a copy of the audit summary for Landlord's review and confirmation. If Landlord confirms that Tenant is entitled to a reduction in the payment, then Landlord shall pay Tenant the amount of any over-payment made by Tenant within thirty (30) calendar days by business check. Landlord shall require the Contractor to include audit provisions in all subcontracts which allow Tenant to audit the subcontractors' books and records with respect to the Tenant Improvements.

11. Telephone/Computer Room and Equipment. As part of the Total TI Costs, Landlord shall complete the telephone equipment room(s), including permanent power and HVAC, in compliance with the Space Plan, Low-Voltage Plan and specifications provided by Tenant, at least thirty (30) calendar days prior to the Estimated Commencement Date. During this thirty (30) day period, the Landlord shall be responsible for the security and protection of any telephone/data equipment delivered to the site prior to the Estimated Commencement Date.

12. Delay.

12.1 Tenant Delays and Force Majeure Delays and Change Authorization. Except as set forth in this Section 12, Tenant shall not be charged as a result of any delay in the construction of Tenant Improvements. Subject to the provisions of Section 12.2, the Estimated Commencement Date set forth in the Lease and the two hundred seventy (270) day period to complete the Tenant Improvements set forth in Section 4.2 of the Lease shall be extended one (1) day for each day that: (a) Tenant fails or refuses to give authorizations or approvals within the time periods required herein, but only to the extent such delays delay the commencement or completion of construction of the Tenant Improvements (referred to herein as "Tenant Delay(s)"); or (b) Substantial Completion of the Tenant Improvements is delayed by lightning, earthquake, fire, storm, tornado, flood, washout, explosion, strike, lockout, labor disturbance, civil disturbance, riot, war, act of a public enemy, sabotage, delay in the issuance of building permits or other required governmental approvals, or other similar causes beyond the reasonable control of Landlord (referred to herein as "Force Majeure Delay(s)") or (c) Landlord's performance of the work described herein is delayed due to a Change Authorization. Notwithstanding any contrary provision contained herein, any delay of Substantial Completion which is due to or results from delays caused by vendors retained by Tenant to perform work or services required for Substantial Completion, including without limitation, the installation of any of Tenant's any low voltage, telephone or data equipment, then such delays shall also constitute a Tenant Delay.

12.2 Limitations.

(a) Notice. No Tenant Delay, Change Authorizations, or Force Majeure Delay shall be deemed to have occurred unless, Landlord has provided Tenant with written notice within two (2) days of the event giving rise to such claim, in compliance with the Lease specifying that a delay is claimed to have occurred because of actions, inaction or circumstances specified in the notice in reasonable detail. If such actions, inaction or circumstances qualify as a Tenant Delay or Force Majeure Delay, then a Tenant Delay or Force Majeure Delay, as applicable, shall be deemed to have occurred, commencing as of the date Tenant received such notice from Landlord.

(b) Mitigation. Tenant Delays and Force Majeure Delays shall delay the Estimated Commencement Date only if Substantial Completion of the Tenant Improvements is delayed, despite Landlord's reasonable efforts to adapt and compensate for such delays, efforts which Landlord shall be obligated to make (provided that the additional cost incurred by Landlord due to such efforts does not exceed \$1,000 on a cumulative basis, unless Tenant agrees to pay to the excess).

(c) Concurrent Delays. Tenant Delays and Force Majeure Delays shall be recognized hereunder only if they are not concurrent with any other Tenant Delay or Force Majeure Delay that is effective hereunder. For example, if fourteen (14) calendar days of Tenant Delays and six (6) calendar days of Force Majeure Delays occur during the same fourteen (14) calendar day period, then the Estimated Commencement Date would be extended by only fourteen (14) calendar days; on the other hand, if such Tenant Delays and Force Majeure Delays did not occur during the same period, then the Estimated Commencement Date would be extended by twenty (20) calendar days.

(d) Change Authorizations. Landlord may not claim that a Tenant-Requested Change was the cause of a delay in the construction of the Tenant Improvements unless the anticipated delay is specified in writing in the executed Change Authorization and affects the Critical Path of the Construction Schedule..

(e) Work Scope Precedence. In case of conflicts or discrepancies between or among this Landlord Work Letter, plans, and specifications, plans shall supersede specifications for quantity, specifications shall supersede plans for quality, and this Landlord Work Letter shall supersede both plans and specifications.

13. Tenant Remedies. Subject to Section 8 and 12.1, if Landlord fails to obtain the building permit to construct the Tenant Improvements within a reasonable time, taking all factors into consideration, then Tenant may, at its option:

13.1 Cancel the Lease upon thirty (30) calendar days' prior written notice to Landlord;
or

13.2 Upon thirty (30) calendar days' prior written notice to Landlord, assume the responsibility for constructing and/or completing the Tenant Improvements itself. If Tenant elects to construct or complete the Tenant Improvements itself, then:

(a) Tenant, its officers, employees, agents, contractors and assignees, shall have free access to the Premises and the Building at all reasonable times for the purpose of constructing the Tenant Improvements and for any other purposes reasonably related thereto; and

Any default by Landlord under the terms of this Work Letter beyond the expiration of all applicable notice and cure periods shall constitute a Landlord Default under the Lease and shall entitle Tenant to exercise all remedies set forth in the Lease.

14. Representatives.

14.1 Tenant Representative. Tenant has designated Tenant's Work Letter Representative as its sole representative with respect to the matters set forth in this Work Letter who, until further notice to Landlord, shall have the full authority and responsibility to act on behalf of Tenant as required in this Work Letter and whose address, for purposes of any notices to be given regarding matters pertaining to this Work Letter only, is Tenant's Address for Work Letter Notice as set forth in Section 1.2 of the Lease.

14.2 Landlord Representative. Landlord has designated Landlord's Work Letter Representative as its sole representative with respect to the matters set forth in this Work Letter who, until further notice to Tenant, shall have the full authority and responsibility to act on behalf of Landlord as required in this Work Letter and whose address, for purposes of any notices to be given regarding matters pertaining to this Work Letter only, is Landlord's Address for Work Letter Notice as set forth in Section 1.2 of the Lease.

15. Elevator Usage During Move-In. In the event that the use of the freight elevators and/or hoists is not sufficient to meet Tenant's requirements during the early entry period set forth in Section 4.3 of the Lease as part of the Total TI Costs, (a) Landlord shall cause to be made operational a temporary construction elevator and hoist, or (b) Tenant shall have priority usage of two (2) passenger elevators in the elevator bank that services the Premises in order to assist Tenant in the installation of Tenant's fixtures, furniture and equipment. With the exception of Tenant's usage of a temporary construction elevator and hoist, any existing elevator usage provided under this Section 15 shall be at no cost to Tenant.

16. Construction Meetings. During the course of construction, meetings shall be held between the Contractor, Landlord and Tenant at least once per week, unless Tenant directs otherwise, at a time and place that is mutually convenient. An initial construction meeting shall be held within seven (7) calendar days after the date the Contractor is selected. Contractor shall provide minutes of each construction meeting to Tenant within a reasonable time thereafter, but not later than three (3) calendar days after the date of the next construction meeting.

17. Delivery. Delivery of all plans and drawings referred to in this Work Letter shall be either by commercial messenger service, personal hand delivery or Landlord can set up a web-based download, unless otherwise agreed by Landlord and Tenant.

18. Miscellaneous. This Landlord Work Letter sets forth the entire understanding and agreement between the Parties with respect to the subject matter of this Landlord Work Letter. This Landlord Work Letter may be amended only in a writing signed by both Parties. Any notice to a party for a breach of this Landlord Work Letter must be delivered in writing per the terms as set forth in Section 30.6 of the Lease. This Landlord Work Letter shall be construed as if jointly drafted by the parties. This Landlord Work Letter will not be effective unless and until signed by both Parties. This Landlord Work Letter will be binding upon, enforceable by and inure to the benefit of the Parties and each of their successors and permitted assigns. Provisions contained in this Landlord Work Letter shall prevail in case of conflict over the terms of the Lease. This Landlord Work Letter is hereby incorporated into and made part of the Lease. All the terms and conditions of the Lease remain in full force and effect, except as expressly indicated otherwise in

this Landlord Work Letter. This Landlord Work Letter will become effective as of the Effective Date and shall continue in effect, except to the extent it is amended or terminated in accordance with terms of the Lease.

[Signatures on the following page.]

IN WITNESS WHEREOF, Landlord and Tenant have executed this Work Letter as of the dates set forth below.

LANDLORD:

Omninet Pacific Pointe, LP,
a Delaware Limited Partnership

By: Omninet Five GP, LLC,
A California limited liability company
Its: General Partner

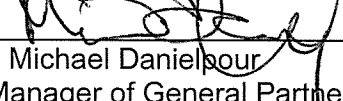
By: 
Name: Michael Daniel
Title: Manager of General Partner

TENANT:

COUNTY OF LOS ANGELES,
a body corporate and politic

By: _____
Name: _____
Title: _____
Date Signed: _____

ADDENDUM A To Landlord's Work Letter

BASE BUILDING IMPROVEMENTS

Landlord has constructed (or will construct) the Building to include the following:

(a) the Building shell and exterior, including perimeter window systems and mullions in good condition and shall ensure that the roof and exterior windows are watertight. If building has not been constructed or is still under construction, no tenant improvements work shall commence until building has been signed off by the City having jurisdiction and Certificate of Occupancy has been received.

(b) Landlord shall demise the Premises (as required) including any separation of mechanical, electrical, or plumbing, excluding any demising and separation work to separate the Premises;

(c) Must also include mechanical, electrical, sprinkler, plumbing, Fire life safety, heating, air conditioning, ventilation and structural systems within the Building core, stubbed out to the face of the core wall at locations reasonably determined by Landlord;

(d) Any demo required of the Premises in accordance with the Tenant's demo plan, unless the Final Plans show that such improvements and/or equipment will remain in the Premises.

(e) toilet rooms in the common areas per code, including necessary plumbing fixtures, ceramic tile floors, accessories, ceilings and lighting, with running hot and cold water; including but not limited to, new toilet partitions, lavatories, floor tile, counter tops, sinks, and "touchless" faucets, soap dispensers, and hand dryers (if needed) and in coordination with the Tenants assigned CEO Project Manager.

(f) Drywall or lath and plaster covering the exposed side of all exposed core walls, core and perimeter columns and the interior exposed side of all exterior building wall areas except at and under windows. Also included:

(g) public stairways;

(h) passenger and freight elevators;

(i) parking facilities

(j) ground floor lobby;

(k) Landlord shall (i) be responsible for delivering a finished elevator lobby on Tenant floor in compliance with code (carpet, lights, finished walls and ceiling) (as needed) and (ii) install new paint in the existing elevator lobby;

(l) Landlord shall (i) be responsible for any work required to construct or modify the existing common area corridor in connection with Tenant's Tenant Improvements to be in compliance with code.

- (m) loading dock and/or area;
- (n) water bottle filling stations/drinking fountains compliant with ADA at public lobbies and within the secured office area;
- (o) electrical/telephone closet with not less than seven (7) watts per square foot of rentable area of normal power in the floor electrical closet;
- (o) conduit access sufficient for Tenant's electrical wiring (no additional improvement to increase conduit access will be furnished by Landlord unless there is not sufficient riser space as required for a 1.5" diameter signal cable from the Building main telecommunication vault to the telephone closets on the 7th floor, in which case Landlord, at no cost to Tenant and without deduction from Landlord's TI Allowance, shall cause such riser space to be made available to Tenant, and provided further that Tenant shall be responsible for the cost for removing the riser floor seal at each floor and the patching of each seal after installation of Tenant's cable) and Landlord shall make available data (internet) and telecommunication fiber connectivity to the main point of entry (MPOE) room within the Building. Tenant shall pay for such internet services within the Premises.
- (p) One (1) 480/277 Volt (Volt Alternating Current) and two (2) 208/120 panels, including any transformer required to step down such power from 480 VAC to 208 VAC connected to the Building power system, ready for Tenant's use;
- (q) mechanical equipment room and existing ducting; provided, however, any new ducting for such mechanical exhaust system shall be Tenant's sole cost and paid by Tenant as part of Tenant's TI Contribution;
- (r) concrete floors with troweled finish ready for Tenant's floor finish, level to specified tolerances, including scraping of any existing glue, as needed, in connection with such levelling, and designed to support a minimum live load of fifty (50) pounds per square foot and a partition load of twenty (20) pounds per square foot;
- (s) existing primary fire-life safety enunciation system "backbone" and panels suitable for Tenant's secondary distribution, as described in Section 2.2(b)(ii) above and in accordance with the cost allocation set forth therein;
- (t) primary HVAC duct for cooling and primary HVAC duct for heating (heating is for perimeter zone only) to loop from the mechanical equipment room around the building core with such existing primary HVAC duct to be in working order prior to any modification to accommodate Tenant's specific ducting requirements and provided, further that, the cost of modifying the existing hot and cold air loops and ducting for Tenant's Final Plans and any work needed to cause the existing primary HVAC duct to be in working order for Tenant's Final Plans shall be Tenant's sole cost and paid by Tenant as part of Tenant's TI Contribution;
- (u) primary fire sprinkler distribution, including existing secondary piping and existing sprinkler heads; provided, however, the cost of modifying the existing secondary piping and existing sprinkler heads shall be Tenant's sole cost and paid by Tenant as part of Tenant's TI Contribution;

(v) Drywall on the service core walls, columns and sills in the Premises, as needed.

(w) Demolition and removal of any existing improvements or equipment situated within the Premises, unless the Final Plans show that such improvements and/or equipment will remain in the Premises.

(x) Landlord shall deliver all exterior lights, including lights in the parking area, in good working order-;

(y) Landlord shall maintain the planting along the perimeter of the Building and adjust the irrigation at planters to be away from the windows, and properly maintain the landscaping throughout the Term of the Lease, including any option periods;

(z) Landlord, at its sole expense, shall provide Tenant sixty (60) access cards or key fobs for Building and parking, if applicable. If required, Landlord shall provide access cards or fobs to all Tenant employees for Building entry, elevators, and/or floor access, at Landlord's sole cost and expense;

(aa) Landlord, at its sole costs and expense, shall perform the work required to correct the deficiencies identified in those two Disabled Access Surveys prepared by CASP Experts dated December 4, 2023, with the exception of those items listed below:

- Page 7: Concrete door entry landings.
- Page 9: Security counter.
- Page 10: Tactile characters on existing signage.

ADDENDUM B To Landlord's Work Letter

TENANT IMPROVEMENTS

Tenant improvements, to be paid by Tenant as part of Tenant's TI Contribution, shall include:

- (a) Tenant ceilings and lighting;
- (b) Floor finish in the Premises (except elevator lobbies and public corridors on multi-tenant floors and toilet rooms);
- (c) Interior finishes of any kind within the Premises (except elevator lobbies and public corridors on multi-tenant floors and core area toilet rooms);
- (d) Interior partitions, doors and hardware within the Premises;
- (e) Terminal boxes and reheat coils or other HVAC or air distribution devices to or within the Premises;
- (f) Tenant's furniture, fixtures and equipment, including telephones, computers and cabling therefor;
- (g) Distribution of electrical services, plumbing services and sprinklers from the core to the Premises, and domestic hot water heater and associated hot water piping;
- (h) Any and all signs for Tenant and the power therefor;
- (i) Security, fire and life-safety systems throughout the Premises, including exit signs, intercoms and extinguishers;
- (j) Additional and/or above standard electrical capacity; and
- (k) Fiber optic access.

ADDENDUM C To Landlord's Work Letter

PRELIMINARY AND FINAL TI COST SUMMARY

___ Preliminary TI Cost Summary
___ Final TI Cost Summary

Lease No. _____
Address _____

Cost Category	
Architecture and Engineering Contract	\$
Plan Check Fees & Permits	\$
General Contractor	\$
(Profit)	\$
(Overhead)	\$
Furniture	\$
Other (Specify)	\$
Total TI Costs	\$