

**BOARD OF  
SUPERVISORS**

Hilda L. Solis  
First District

Holly J. Mitchell  
Second District

Lindsey P. Horvath  
Third District

Janice Hahn  
Fourth District

Kathryn Barger  
Fifth District



**Chief  
Executive  
Office.**

**COUNTY OF LOS ANGELES**

Kenneth Hahn Hall of Administration  
500 West Temple Street, Room 713, Los Angeles, CA 90012  
(213) 974-1101      ceo.lacounty.gov

**Chief Executive Officer**  
Fesia A. Davenport

"To Enrich Lives Through Effective and Caring Service"

April 23, 2024

The Honorable Board of Supervisors  
County of Los Angeles  
383 Kenneth Hahn Hall of Administration  
500 West Temple Street  
Los Angeles, California 90012

Dear Supervisors:

**ADOPTED**

BOARD OF SUPERVISORS  
COUNTY OF LOS ANGELES

19 April 23, 2024

  
JEFF LEVINSON  
INTERIM EXECUTIVE OFFICER

**FIVE-YEAR LEASE  
DEPARTMENT OF PUBLIC HEALTH  
12440 EAST IMPERIAL HIGHWAY, NORWALK  
(FOURTH DISTRICT) (3 VOTES)**

**SUBJECT**

Approval of a proposed five-year lease to renew an existing lease to provide the Department of Public Health (DPH) continued use of 20,647 square feet of office space and 83 on-site parking spaces for its existing programs.

**IT IS RECOMMENDED THAT THE BOARD:**

1. Find that the proposed lease is exempt from the California Environmental Quality Act (CEQA) for the reasons stated in this Board letter and in the record of the project.
2. Authorize the Chief Executive Officer, or her designee, to execute the proposed lease with Sonnenblick Del Rio Norwalk, LLC, (Landlord), which will extend DPH's use of approximately 20,647 square feet of office space and 83 on-site parking spaces located at 12440 Imperial Highway, Norwalk (Premises) to be occupied by DPH. The estimated maximum first year base rental cost is \$459,000 for DPH. The estimated total proposed lease costs are \$2,551,000 over the five-year term. The rental costs for DPH will be fully funded 100 percent by State and Federal funding sources that is already included in the DPH's existing budget. DPH will not be requesting additional net County cost for this action.

3. Authorize and direct the Chief Executive Officer, or her designee, to execute any other ancillary documentation necessary to effectuate the proposed lease, and to take actions necessary and appropriate to implement the proposed lease, including, without limitation, exercising any early termination rights.

### **PURPOSE/JUSTIFICATION OF RECOMMENDED ACTION**

The purpose of this recommended action is to provide continuous, uninterrupted occupancy for 102 DPH staff members located at the Premises. The current lease term expired on April 30, 2020, and is currently on month-to-month holdover with no additional fees charged by the Landlord. The proposed lease will enable DPH to avoid immediate interruption of services.

Since April 2003, DPH has housed various programs at this site, including its Environmental Health and Health Facilities programs, which conducts surveillance and enforcement services for both retail and wholesale food facilities, as well as multi-family dwellings and performs public health complaint investigations. The DPH Health Facilities Inspection Division conducts inspections, certifications, and licensing of health care facilities, and performs healthcare complaint investigations.

Due to the ongoing need for these in-person services at the Premises, there are no immediate plans for additional teleworking or hoteling at the Premises. In addition, due to the short-term nature of the proposed lease, it would not be prudent to spend funds on significant tenant improvements. Parking is provided in the facility parking lot. The Premises is in proximity to local public transportation routes.

### **Implementation of Strategic Plan Goals**

The Countywide Strategic Plan Goal 1 – “Make Investments That Transform Lives” – provides that we will aggressively address society's most complicated social, health, and public safety challenges. We want to be a highly responsive organization capable of responding to complex societal challenges – one person at a time.

The proposed lease is also consistent with Strategic Asset Management Goal – Strengthen connection between service priorities and asset decisions and Key Objective No. 4 – Guide Strategic Decision Making.

The proposed lease supports the above goals and objective by renewing the use of an existing facility that includes proper accommodations for office and ancillary space in a centrally located facility that is accessible for employees and clients.

The proposed lease conforms with the Asset Management Principles outlined in Enclosure A.

### **FISCAL IMPACT/FINANCING**

The estimated maximum first year base rental cost for the proposed lease is \$459,000, which includes parking at no additional cost. The aggregate cost associated with the proposed lease over the entire five-year term, including electricity, is \$2,551,000, as shown in Enclosure B-1. The proposed lease costs will be 100 percent funded by State and Federal funding sources that is already included in DPH's existing budget. DPH will not be requesting additional net County cost for this action.

Sufficient funding to cover the proposed rent for the first year of the proposed lease is included in the Fiscal Year 2023-24 Rent Expense budget and will be billed back to DPH. DPH has sufficient funding in its Fiscal Year 2023-24 Operating Budget to cover the proposed rent for the first year. Future funding for the costs associated with the proposed lease will be addressed through the annual budget process for DPH.

### **FACTS AND PROVISIONS/LEGAL REQUIREMENTS**

In addition to the terms previously stated, the proposed lease also contains the following provisions:

- Upon commencement of the proposed lease, the annual rental rate will decrease from \$25.67 per square foot, per year to \$22.20 per square foot, per year. Base rent is subject to fixed annual increases of 3 percent.
- The Landlord is responsible for the operating, maintenance, and janitorial costs of the Premises, and the County is responsible for electricity. The County is not subject to the building's operating expense increases.
- The 83 on-site parking spaces are included in the base rent at no additional cost.
- The County shall have an ongoing right to terminate the proposed lease on or at any time after three years, with 180 days' prior written notice.
- Holdover at the proposed lease expiration is permitted on the same lease terms and conditions except the monthly base rent during the first four months of the holdover period will be at the base rent at the time of the lease expiration. If the County remains in holdover after the initial four-month period, the monthly base rent will increase by 25 percent of the base rent. The Landlord agrees to credit the County all holdover fees paid to the Landlord during the holdover period if the County renews the proposed lease.
- The proposed lease will be effective upon approval by the Board and full execution of the proposed lease.

The Chief Executive Office conducted a market search of available office space for lease but was unable to identify any sites that could accommodate this requirement more economically. Based upon a review of available industry data, it has been established that the annual rental range for a comparable lease in the area is between \$27.03 and \$31.83 per square foot, per year. The base annual rental rate of \$22.20 per square foot, per year for the proposed lease represents a rate that is below the market range for the area. We recommend the proposed Premises as the most suitable to meet the County's space requirements. In addition, co-working office space is not programmatically practical for the existing programs and activities at this facility.

Enclosure C shows County-owned or leased facilities within the surveyed area, and there are no suitable County-owned or leased facilities available for this space requirement.

The Department of Public Works has inspected this facility and found it suitable for the County's occupancy. The required notification letter to the City of Norwalk has been sent in accordance with Government Code Section 25351.

County Counsel has reviewed the proposed lease and approved it as to form. The proposed lease is authorized by Government Code Section 25351, which allows the County to enter into leases and agreements for the leasing of buildings, as necessary, to carry out the work of the county government.

The proposed lease will continue to provide a suitable location for DPH's programs, which is consistent with the County's Facility Location Policy, adopted by the Board on July 24, 2012, as outlined in Enclosure D.

### **ENVIRONMENTAL DOCUMENTATION**

This project is exempt from CEQA, as specified in Class 1 of the Environmental Document Reporting Procedures and Guidelines adopted by the Board, and section 15301 of the State CEQA Guidelines (Existing Facilities). The proposed lease, which involves the leasing of existing office space with minor tenant improvements within an existing building, with no expansion of the existing building, is within a class of projects that have been determined not to have a significant effect on the environment and meets the criteria set forth in section 15301 of the State CEQA Guidelines (Guidelines), and Class 1 of the County's Environmental Document Reporting Procedures and Guidelines, Appendix G. In addition, based on the proposed project records, it will comply with all applicable regulations, and there are no cumulative impacts, unusual circumstances, damage to scenic highways, listing on hazardous waste site lists compiled, pursuant to Government Code Section 65962.5, or indications that it may cause a substantial adverse change in the significance of a historical resource that would make the exemption inapplicable.

Upon the Board's approval of the recommended actions, a Notice of Exemption will be filed with the Registrar-Recorder/County Clerk in accordance with section 21152 of the California Public Resources Code.

### **IMPACT ON CURRENT SERVICES (OR PROJECTS)**

The proposed lease will adequately provide the necessary office space and parking for this County requirement. DPH concurs with the proposed lease and recommendation.

The Honorable Board of Supervisors

4/23/2024

Page 5

Respectfully submitted,

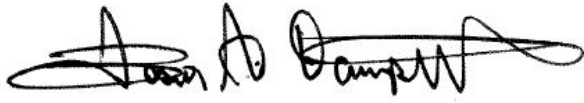
A handwritten signature in black ink, appearing to read "Fesia A. Davenport", with a stylized, flowing script.

FESIA A. DAVENPORT

Chief Executive Officer

FAD:JMN:JTC:JLC

HD:ANR:NH:gb

Enclosures

c: Executive Office, Board of Supervisors  
County Counsel  
Auditor-Controller  
Public Health

**DEPARTMENT OF PUBLIC HEALTH  
12440 EAST IMPERIAL HIGHWAY, NORWALK  
Asset Management Principles Compliance Form<sup>1</sup>**

<b>1.</b>	<b><u>Occupancy</u></b>		<b>Yes</b>	<b>No</b>	<b>N/A</b>
A	Does lease consolidate administrative functions? <sup>2</sup>				<b>X</b>
B	Does lease co-locate with other functions to better serve clients? <sup>2</sup>		<b>X</b>		
C	Does this lease centralize business support functions? <sup>2</sup>		<b>X</b>		
D	Does this lease meet the guideline of 200 sq. ft of space per person? <sup>2</sup> <b>DPH exceeds guideline due to the need for client meeting space.</b>			<b>X</b>	
E	Does lease meet the 4/1000 sq. ft. parking ratio guideline? <sup>2</sup>		<b>X</b>		
F	Does public parking and mass-transit exist to facilitate employee, client and visitor access to the proposed lease location? <sup>2</sup>		<b>X</b>		
<b>2.</b>	<b><u>Capital</u></b>				
A.	Is it a substantial net County cost (NCC) program?			<b>X</b>	
B	Is this a long-term County program?		<b>X</b>		
C	If yes to 2 A or B; is it a capital lease or an operating lease with an option to buy?			<b>X</b>	
D	If no, are there any suitable County-owned facilities available?			<b>X</b>	
E	If yes, why is lease being recommended over occupancy in County-owned space?				<b>X</b>
F	Is Building Description Report attached as Enclosure C?		<b>X</b>		
G	Was build-to-suit or capital project considered? <sup>2</sup> <b>Program will move to proposed new County-owned facility at Rancho Los Amigos campus.</b>			<b>X</b>	
<b>3.</b>	<b><u>Portfolio Management</u></b>				
A	Did department utilize CEO Space Request Evaluation (SRE)?		<b>X</b>		
B	Was the space need justified?		<b>X</b>		
C	If a renewal lease, was co-location with other County departments considered?		<b>X</b>		
D	Why was this program not co-located with other County departments?				<b>X</b>
	1. ____ The program clientele requires a "stand alone" facility.				
	2. ____ No suitable County occupied properties in project area.				
	3. ____ No County-owned facilities available for the project.				
	4. ____ Could not get City clearance or approval.				
	5. <b>X</b> The Program is being co-located.				
E	Is lease a full-service lease? <sup>2</sup> <b>This landlord does not cover lease electrical expenses.</b>			<b>X</b>	
F	Has growth projection been considered in space request?		<b>X</b>		
G	<sup>1</sup> Has the Dept. of Public Works completed seismic review/approval?		<b>X</b>		
<sup>1</sup> As approved by the Board of Supervisors 11/17/98					
<sup>2</sup> If not, why not?					

## OVERVIEW OF THE PROPOSED BUDGETED LEASE COSTS

12440 Imperial Highway, Suites 519 & 531, Norwalk  
Department of Public Health

### Basic Lease Assumptions

Leased Area (sq.ft.)	20,647	
	<b>Monthly</b>	<b>Annual</b>
Rent (per sq. ft.)	\$1.85	\$22.20
Term (months)	96	
Annual Rent Adjustment <sup>(1)</sup>	3%	

	1 <sup>st</sup> Year	2 <sup>nd</sup> Year	3 <sup>rd</sup> Year	4 <sup>th</sup> Year	5 <sup>th</sup> Year	Total 5 Year Rental Costs
<b>Annual Base Rent Costs <sup>(1)</sup></b>	\$458,363	\$472,114	\$486,278	\$500,866	\$515,892	<b>\$2,434,000</b>
<b>Total Paid to Landlord</b>	\$458,363	\$472,114	\$486,278	\$500,866	\$515,892	<b>\$2,434,000</b>
<b>Electricity Costs <sup>(2)</sup></b>	\$23,221	\$23,221	\$23,221	\$23,221	\$23,221	<b>\$117,000</b>
<b>Total Annual Lease Costs</b>	<b>\$481,585</b>	<b>\$495,336</b>	<b>\$509,499</b>	<b>\$524,088</b>	<b>\$539,113</b>	<b>\$2,551,000</b>

### Footnotes

<sup>(1)</sup> The Base Rent is subject to fixed 3 percent increases per annum.

<sup>(2)</sup> Tenant shall reimburse Landlord monthly for submeter power, based on actual usage. Estimated costs based on actual usage Sept ' 22 through Sept 23.

**\*Calculation note: All numbers are rounded up to ensure sufficient funds available to pay the specified expense.**

**COMPARISON OF THE PROPOSED LEASE TO EXISTING LEASE****DEPARTMENT OF PUBLIC HEALTH**

	<b>Existing Lease: 12440 E. Imperial Highway, Norwalk</b>	<b>Proposed Lease: 12440 E. Imperial Highway, Norwalk</b>	<b>Change</b>
Area (Square Feet)	20,647 sq. ft.	20,647 sq. ft.	None
Term (Years)	5 years	5 years	None
Annual Base Rent (Includes 83 parking spaces)	\$530,008	\$458,363	-\$71,645 annually
Total Annual Lease Costs Payable to Landlord	\$530,008	\$458,363	-\$71,645 annually
Rental rate Annual Adjustment	CPI increases capped at 3 percent.	Fixed 3 percent increases.	Fixed 3 percent increases.

<sup>(1)</sup> Costs based on actual usage Sept. 2022 through Sept. 2023. Future cost subject to change.



**DEPARTMENT OF PUBLIC HEALTH  
SPACE SEARCH – 3 MILE RADIUS FROM  
12440 IMPERIAL HIGHWAY, NORWALK**

LACO	Name	Address	Ownership Type	Gross Sq. Ft.	Vacant
A176	Health Services – EMS	10100 Pioneer Blvd Santa Fe Springs, 90670	Leased	41,720	None
A279	DPW – South Whittier District / Sheriff's Sub Station	13523 Telegraph Rd South Whittier 90605	Leased	3,162	None
A355	DCFS – Santa Fe Springs (SPA 7)	10355 Slusher Dr Santa Fe Springs, 90670	Leased	65,568	None
A358	DPSS – Information Technology Division (ITD)	14714 Carmenita Rd Norwalk, 90650	Leased	44,250	None
D221	DPSS – Norwalk WS District Office	12727 Norwalk Blvd Norwalk, 90650	Leased	40,500	None
X168	Harry Hufford Registrar- Recorder/Co Clerk Building	12400 E Imperial Hwy Norwalk, 90650	Owned	262,510	None
Y531	Star Center – Administration Building	11515 S Colima Rd Whittier 90604	Owned	8,884	None
Y533	Star Center – Academy Building C	11515 S Colima Rd Whittier 90604	Owned	15,578	None
Y534	Star Center – Academy Building D	11515 S Colima Rd Whittier 90604	Owned	16,551	None
Y535	Star Center – Academy Building E	11515 S Colima Rd Whittier 90604	Owned	19,984	None
Y542	Star Center – Academy Building M	11515 S Colima Rd Whittier 90604	Owned	9,097	None
5685	Norwalk Courthouse	12720 Norwalk Blvd Norwalk, 90650	Owned	225,008	None

## **FACILITY LOCATION POLICY ANALYSIS**

**Proposed lease:** A Five-year Lease for the Department of Public Health – 12440 Imperial Highway, Norwalk – 4<sup>th</sup> District.

**A. Establish Service Function Category –** Regional and local public service function.

**B. Determination of the Service Area –** The proposed lease will provide the uninterrupted use of 20,647 square feet of office space for DPH's Environmental Health and Health Facilities programs.

**C. Apply Location Selection Criteria to Service Area Data**

- Need for proximity to service area and population: Continuing need for existing programs in Service Area 7 and surrounding areas for DPH.
- Need for proximity to existing County facilities: Close to other County departments including DCFS, and the Departments of Mental Health, Public Social Services, and the Sheriff.
- Need for proximity to Los Angeles Civic Center: N/A
- Economic Development Potential: N/A
- Proximity to public transportation: The location is accessible to the 5 and 605 freeways and adequately served by local bus transit services in the Norwalk vicinity.
- Availability of affordable housing for County employees: The surrounding area provides for affordable housing and rental opportunities.
- Use of historic buildings: N/A
- Availability and compatibility of existing buildings: Located within a long-standing commercial building with multiple County departments.
- Compatibility with local land use plans: The City of Norwalk has been notified of the proposed County use which is consistent with its use and zoning for office space at this location.
- Estimated acquisition/construction and ongoing operational costs: The aggregate cost associated with the proposed lease over the entire term is \$2,551,000.

**D. Analyze results and identify location alternatives**

Based upon a review of available industry data, it has been established that the annual rental range for a comparable lease in the area is between \$27.03 and \$31.83 per square foot, per year. The base annual rental rate of \$22.20 per square foot, per year for the proposed lease represents a rate that is below the market range for the area. We were unable to identify any sites that could accommodate this requirement more economically. We recommend the current premises as the most suitable to meet the County's space requirements before the relocation to Rancho Los Amigos.

**E. Determine benefits and drawbacks of each alternative based upon functional needs, service area, cost, and other Location Selection Criteria**

The proposed lease will provide adequate and efficient office space for approximately 102 employees consistent with the County's Facility Location Policy, adopted by the Board on July 24, 2012. There are no other available buildings in the area that meet the Department's requirements.

**COUNTY OF LOS ANGELES  
CHIEF EXECUTIVE OFFICE**

**LEASE AGREEMENT**

**COUNTY OF LOS ANGELES - Tenant  
SONNENBLICK DEL RIO NORWALK LLC - Landlord**

**12440 IMPERIAL HIGHWAY, SUITES 519-531  
NORWALK, CALIFORNIA 90650**

## TABLE OF CONTENTS

	Page
<b>CONTENTS</b>	
<b>1. BASIC LEASE INFORMATION</b> .....	1
1.1 Terms.....	1
(a) Landlord's Address for Notices:.....	1
(b) Tenant's Address for Notices:.....	1
(c) Premises:.....	1
(d) Building:.....	1
(e) Term: .....	1
(f) Estimated Commencement Date.....	2
(g) Termination Date .....	2
(h) Irrevocable Offer Expiration Date: (see Section 33) .....	2
(i) Base Rent:.....	2
(j) Early Termination (see Section 4.4) .....	2
(k) Rentable Square Feet in the Premises:.....	2
(l) Initial Departmental Use: .....	2
(m) Parking Spaces: .....	2
(n) Tenant's Hours of Operation:.....	2
(o) Asbestos Report: .....	2
(p) Seismic Report .....	2
(q) Disabled Access Survey .....	2
1.2 Exhibits to Lease .....	3
<b>2. PREMISES</b> .....	3
2.1 Lease of Premises .....	3
2.2 Measurement of Premises .....	3
<b>3. COMMON AREAS</b> .....	3
<b>4. COMMENCEMENT AND EXPIRATION DATES</b> .....	4
4.1 Term.....	4
4.2 Intentionally Omitted .....	4
4.3 Intentionally Omitted .....	4
4.4 Early Termination .....	4
<b>5. RENT</b> .....	4
5.1 Base Rent .....	4
5.2 Base Rent Adjustments .....	4
<b>6. USES</b> .....	5
<b>7. HOLDOVER</b> .....	5
<b>8. COMPLIANCE WITH LAW</b> .....	5
<b>9. DAMAGE OR DESTRUCTION</b> .....	5
9.1 Damage.....	5
9.2 Tenant Termination Right .....	6
9.3 Damage In Last Year .....	6
9.4 Default By Landlord .....	6
<b>10. REPAIRS AND MAINTENANCE</b> .....	7
10.1 Landlord Representations.....	7
10.2 Landlord Obligations .....	8

10.3	Tenant Obligations.....	10
10.4	Tenant's Right to Repair .....	10
<b>11.</b>	<b>SERVICES AND UTILITIES .....</b>	<b>11</b>
11.1	Services.....	11
	(a) Premises Heating and Ventilation and Air Conditioning (VAC) .....	11
	(b) Electricity .....	12
	(c) Elevators.....	12
	(d) Water .....	12
	(e) Janitorial .....	12
	(f) Access .....	13
	(g) Pest Control.....	13
	11.2 Utilities.....	13
<b>12.</b>	<b>TAXES .....</b>	<b>13</b>
<b>13.</b>	<b>LANDLORD ACCESS .....</b>	<b>13</b>
<b>14.</b>	<b>TENANT DEFAULT .....</b>	<b>14</b>
	14.1 Default.....	14
	14.2 Termination .....	14
	14.3 No Effect on Indemnity .....	14
<b>15.</b>	<b>LANDLORD DEFAULT .....</b>	<b>14</b>
	15.1 Remedies .....	14
	15.2 Waiver .....	15
	15.3 Emergency.....	15
<b>16.</b>	<b>ASSIGNMENT AND SUBLETTING .....</b>	<b>15</b>
	16.1 Assignment and Subletting .....	15
	16.2 Sale.....	15
<b>17.</b>	<b>ALTERATIONS AND ADDITIONS .....</b>	<b>16</b>
	17.1 Landlord Consent .....	16
	17.2 End of Term .....	17
<b>18.</b>	<b>CONDEMNATION .....</b>	<b>17</b>
	18.1 Controlling Terms .....	17
	18.2 Total Taking .....	17
	18.3 Partial Taking .....	17
	18.4 Restoration .....	18
	18.5 Award .....	18
	18.6 Waiver of Statute .....	18
<b>19.</b>	<b>INDEMNIFICATION .....</b>	<b>18</b>
	19.1 Landlord's Indemnity .....	18
	19.2 Tenant's Indemnity.....	18
<b>20.</b>	<b>INSURANCE.....</b>	<b>18</b>
	20.1 Waiver .....	19
	20.2 General Insurance Provisions – Landlord Requirements .....	19
	20.3 Insurance Coverage Types And Limits .....	22
	20.4 Landlord Requirements .....	22
<b>21.</b>	<b>PARKING.....</b>	<b>23</b>
	21.1 Tenant's Rights .....	23
	21.2 Remedies .....	23
	21.3 Alternative Parking.....	24

<b>22.</b>	<b>ENVIRONMENTAL MATTERS</b> .....	24
	22.1 Hazardous Materials .....	24
	22.2 Landlord Indemnity .....	24
<b>23.</b>	<b>ESTOPPEL CERTIFICATES</b> .....	25
<b>24.</b>	<b>TENANT IMPROVEMENTS</b> .....	25
<b>25.</b>	<b>LIENS</b> .....	25
<b>26.</b>	<b>SUBORDINATION AND MORTGAGES</b> .....	25
	26.1 Subordination and Non-Disturbance .....	25
	26.2 Existing Deeds of Trust .....	25
	26.3 Notice of Default .....	26
<b>27.</b>	<b>SURRENDER OF POSSESSION</b> .....	26
<b>28.</b>	<b>SIGNAGE</b> .....	26
	28.1 Directory Signage .....	26
<b>29.</b>	<b>QUIET ENJOYMENT</b> .....	26
<b>30.</b>	<b>GENERAL</b> .....	26
	30.1 Headings .....	26
	30.2 Successors and Assigns .....	26
	30.3 Brokers .....	27
	30.4 Entire Agreement .....	27
	30.5 Severability .....	27
	30.6 Notices .....	27
	30.7 Governing Law and Venue .....	27
	30.8 Waivers .....	27
	30.9 Time of Essence .....	28
	30.10 Consent .....	28
	30.11 Community Business Enterprises .....	28
	30.12 Memorandum of Lease .....	28
	30.13 Counterparts; Electronic Signatures .....	28
<b>31.</b>	<b>AUTHORITY</b> .....	29
<b>32.</b>	<b>ACKNOWLEDGEMENT BY LANDLORD</b> .....	29
	32.1 Consideration of GAIN Program Participants .....	29
	32.2 Solicitation of Consideration .....	29
	32.3 Landlord Assignment .....	30
	32.4 Smoking in County Facilities .....	31
<b>33.</b>	<b>INTENTIONALLY OMITTED</b> .....	32

## EXHIBITS

- Exhibit A – Floor Plan of the Premises
- Exhibit B – Commencement Date Memorandum and Confirmation of Lease Terms
- Exhibit C – Heating, Ventilation, and Air Conditioning Standards
- Exhibit D – Cleaning and Maintenance Schedule
- Exhibit E – Subordination, Non-disturbance and Attornment Agreement
- Exhibit F – Tenant Estoppel Certificate
- Exhibit G – Community Business Enterprises Form
- Exhibit H – Memorandum of Lease Terms

COUNTY OF LOS ANGELES  
CHIEF EXECUTIVE OFFICE

LEASE AGREEMENT

This LEASE AGREEMENT ("Lease") is entered into as of the \_\_\_\_\_ day of \_\_\_\_\_, 20\_\_ between SONNENBLICK DEL RIO NORWALK LLC, a Delaware limited liability company ("Landlord"), and COUNTY OF LOS ANGELES, a body corporate and politic ("Tenant" or "County").

Landlord and Tenant agree:

**1. BASIC LEASE INFORMATION**

**1.1 Terms**

The following terms as used herein shall have the meanings provided in this Section 1, unless otherwise specifically modified by provisions of this Lease:

(a) Landlord's Address for Notices:	12440 Imperial Highway Office of the Building, Suite 101 Norwalk, CA 90650 Email: bob@sonndev.com, nelson.delrio@icloud.com
(b) Tenant's Address for Notices:	County of Los Angeles Chief Executive Office - Real Estate Division 320 West Temple Street, 7th Floor Los Angeles, CA 90012 Attention: Director of Real Estate  With a copy to:  County of Los Angeles Office of the County Counsel 648 Kenneth Hahn Hall of Administration 500 West Temple Street, Suite 648 Los Angeles, CA 90012-2713 Attention: Property Division
(c) Premises:	Approximately 20,647 rentable square feet designated as Suites 519-531 in the Building (defined below), as shown on <u>Exhibit A</u> attached hereto.
(d) Building:	The Building located at 12440 Imperial Highway, Norwalk, California, which is currently assessed by the County Assessor as APN 8047-006-004 and 8047-006-007 (collectively, the "Property").
(e) Term:	Five (5) years



(f) Estimated Commencement Date	April 1, 2024
(g) Termination Date	March 31 <sup>st</sup> , 2029
(h) Intentionally Omitted	
(i) Base Rent:	\$38,196.95 per month [i.e., \$1.85 per RSF; \$458,363.40 per year (\$22.20 per RSF)]
(j) Early Termination (See Section 4.4)	At or after Three (3) years with One-hundred eighty (180) days' notice.
(k) Rentable Square Feet in the Premises:	20,647 rentable square feet (RSF)
(l) Initial Departmental Use:	Department of Public Health administrative offices, subject to Section 6.
(m) Parking Spaces: (see Section 21)	83 unreserved spaces.
(n) Tenant's Hours of Operation:	6 a.m. to 6 p.m. Monday through Friday, and 6 a.m. to 12 p.m. on Saturdays, except for legal holidays.
(o) Asbestos Report:	A report dated March 7, 2019, prepared by Partner Engineering North Carolina, PLLC, a licensed California Asbestos contractor.
(p) Seismic Report	A report dated March 7, 2019, prepared by Partner Engineering North Carolina, PLLC and a report dated March 10, 2022, prepared by the Department of Public Works.
(q) Disabled Access Survey	A report dated December 22, 2011, prepared by County of Los Angeles County Affirmative Action.

<p>1.2     <u>Exhibits to Lease</u></p>	<p>Exhibit A - Floor Plan of Premises  Exhibit B - Commencement Date Memorandum and Confirmation of Lease Terms  Exhibit C - VAC Standards  Exhibit D - Cleaning and Maintenance Schedule  Exhibit E - Subordination, Non-Disturbance and Attornment Agreement  Exhibit F - Tenant Estoppel Certificate  Exhibit G - Community Business Enterprises Form  Exhibit H - Memorandum of Lease</p>
---	---

## 2.     **PREMISES**

### 2.1     Lease of Premises

Landlord does hereby lease to Tenant, and Tenant does hereby lease from Landlord, upon the terms and conditions herein set forth, the Premises described in Section 1.1 and depicted on Exhibit A attached hereto.

### 2.2     Measurement of Premises

Tenant shall have the right at any time during the Term of this Lease to field-measure and verify the exact footage of the Premises and/or the Building. All measurements shall be taken in accordance with the methods of measuring rentable area as described in the Standard Method for Measuring Floor Area in Office Buildings, ANSI/BOMA Z65.1-2010, as promulgated by the Building Owners and Management Association ("BOMA") International, except that no penthouse mechanical room space shall be included in the measurement. Should this measurement be less than the square footage stated above, then Tenant shall have the right to adjust such square footage and reduce the Base Rent in Section 1.1 accomplished by the mutual execution of an amendment to this Lease. Landlord acknowledges the space has been marketed at the above-indicated rental amount and in the event of subsequent physical measurements, Landlord agrees there will be no increase made to the Base Rent if the measured square footage exceeds the amount represented by Landlord.

## 3.     **COMMON AREAS**

Tenant may use the following areas ("Common Areas") in common with Landlord and any other tenants of the Building: the entrances, lobbies, corridors and other public areas of the Building, walkways, landscaped areas, driveways necessary for access to the Premises, parking areas and other common facilities designated by Landlord from time to time for common use of all tenants of the Building. Landlord shall have the right to make changes to the Common Areas, in Landlord's sole discretion, from time to time provided such changes do not unreasonably interfere with Tenant's use of or access to the Premises or availability of parking. Tenant shall comply with all reasonable, non-discriminatory rules and regulations regarding the use of the Common Area established by Landlord.

#### 4. **COMMENCEMENT AND EXPIRATION DATES**

##### 4.1 Term

The term of this Lease shall commence on the date of mutual execution of the Lease (the Commencement Date) and terminate on the Termination Date. Within thirty (30) days of the Commencement Date, Landlord and Tenant shall acknowledge in writing the Commencement Date by executing a Commencement Date Memorandum and Confirmation of Lease Terms in the form attached hereto as Exhibit B. Tenant is the prior occupant of the Premises and shall accept the furniture, fixtures, and equipment ("FF&E") located in the Premises in "as is, where is" condition and, notwithstanding anything to the contrary in this Lease, Landlord is not required to modify or add to such FF&E or to reimburse Tenant for the modification of or addition to such FF&E.

##### 4.2 Intentionally Omitted

##### 4.3 Intentionally Omitted

##### 4.4 Early Termination

Tenant shall have the right to terminate this Lease at any time after the Early Termination date specified in Section 1.1, by giving Landlord not less than One-hundred eighty (180) days' prior written notice, executed by Tenant's Chief Executive Officer or his/her designee.

#### 5. **RENT**

##### 5.1 Base Rent

Tenant shall pay Landlord the Base Rent stated in Section 1.1 during the Term hereof within fifteen (15) days after (a) the Commencement Date, and (b) the first day of each calendar month thereafter, provided that at least fifteen (15) business days prior to the Commencement Date, Landlord must provide the Auditor of the County of Los Angeles with the following information: (i) name and address of Landlord or other party to whom Base Rent should be paid, (ii) Landlord's federal tax ID number; (iii) name of contact person and contact information (including phone number) for Landlord; (iv) a completed IRS form W-9, and (v) evidence of insurance in compliance with Section 20.2. If Landlord fails to timely provide the information required pursuant to this Section 5.1, or to provide updates for any changed information, then Tenant shall not be required to pay Base Rent to Landlord until fifteen (15) business days after Landlord provides such information. Base Rent for any partial calendar month during the Term shall be prorated in proportion to the number of days during the Term within such calendar month.

##### 5.2 Base Rent Adjustments

- (a) Base Rent is subject to fixed three percent (3%) annual increase over the previous year's Base Rent as follows:

Months	Rate	Monthly Rent
1 - 12	\$1.85	\$38,196.95

13 - 24	\$1.91	\$39,342.86
25 - 36	\$1.96	\$40,523.14
37 - 48	\$2.02	\$41,738.84
49 - 60	\$2.08	\$42,991.00

## 6. **USES**

Landlord agrees that the demised Premises, together with all appurtenances thereto, shall be used by the Tenant for the government department set forth in Section 1.1, any other County Department the County designates, any other governmental purposes, or other lawful purposes that do not materially adversely interfere with other uses or occupants in the Building, during Tenant's Hours of Operation, after Tenant's Hours of Operation, and on weekends and holidays.

## 7. **HOLDOVER**

If Tenant remains in possession of the Premises or any part thereof after the expiration of the term of this Lease ("Holdover Period"), such occupancy shall be a tenancy which is terminable only upon ninety (90) days written notice from Landlord or thirty (30) days written notice from Tenant's Chief Executive Officer or his/her designee.

During the first four (4) months of the Holdover Period, monthly Base Rent shall be equal to the last monthly Base Rent payable under this Lease prior to the Holdover Period, plus any other charges payable under this Lease, and subject to all of the terms, covenants, and conditions of this Lease. After the aforementioned initial 4-month Holdover Period, Monthly Base Rent shall increase to be 125% of the Base Rent ("Holdover Fee") and monthly Base Rent shall remain at this rate for the remainder of the Holdover Period. In the event Tenant elects to renew its Lease during the Holdover Period, then Landlord shall credit to Tenant as a credit against Base Rent next due during the renewal period the amount, if any, that the Holdover Fee exceeds the total Monthly Base Rent that otherwise would have been paid during the Holdover Period had the Monthly Base Rent been equal to that at the commencement of the new lease.

## 8. **COMPLIANCE WITH LAW**

Tenant shall, at Tenant's expense, comply promptly with all applicable statutes, ordinances, rules, regulations, orders and requirements in effect during the term hereof regulating the use, occupancy or improvement of the Premises by Tenant. Landlord, not Tenant, shall, at its sole cost, at all times cause the Premises and the Building to comply with all applicable statutes, ordinances, rules, regulations, orders and requirements in effect and binding upon Tenant or Landlord during the term hereof, including but not limited to the Americans with Disabilities Act ("ADA"), except if such compliance is made necessary as a result of Tenant's particular use of or alterations or improvements to the Premises, and in such event Tenant shall be solely responsible for the cost and expense of such compliance limited to within the Premises.

## 9. **DAMAGE OR DESTRUCTION**

### 9.1 **Damage**

If any portion of the Premises is damaged by fire or any other cause rendering the Premises totally or partially inaccessible or unusable, and the Premises may be

restored to a complete architectural unit of the same value, condition and character that existed immediately prior to such casualty in less than one hundred eighty (180) days, then Landlord shall promptly, at Landlord's expense, repair such damage, and this Lease shall continue in full force and effect. If all or any portion of the Premises shall be made unusable by fire or other casualty, Landlord shall immediately secure the area to prevent injury to persons and/or vandalism to the improvements. Landlord shall promptly, but in any event within ten (10) days engage an architect or general contractor selected by Landlord to provide Landlord and Tenant with a written estimate of the amount of time required to substantially complete the repair and restoration of the Premises and make the Premises leasable again using standard working methods. The failure to do so shall be a material default hereunder. Base Rent shall abate to the extent that the Premises are unusable by Tenant.

## 9.2 Tenant Termination Right

If any portion of the Premises is damaged by fire or any other cause rendering the Premises totally or partially inaccessible or unusable, and the Premises will not be restored to a complete architectural unit of the same value, condition and character that existed immediately prior to such casualty in less than one hundred eighty (180) days for any reason, then Tenant may terminate this Lease by giving Landlord written notice within ten (10) days after Tenant's receipt of written notice from Landlord or its agents specifying such time period of repair; and this Lease shall terminate and the Base Rent shall be abated from the date the Premises became unusable. If Tenant does not elect to terminate this Lease, then Landlord shall promptly commence and diligently prosecute to completion the repairs to the Building or Premises, provided that insurance proceeds are available to repair the damages and Tenant shall continue to pay Base Rent subject to abatement to the extent that the Premises are unusable by Tenant.

## 9.3 Damage In Last Year

Notwithstanding the foregoing provisions, if any material destruction to the Premises occurs during the last year of the Term, then either Landlord or Tenant may terminate this Lease by giving written notice to the other not more than thirty (30) days after such destruction, in which case:

- (a) Landlord shall have no obligation to restore the Premises;
- (b) Landlord may retain all insurance proceeds relating to such destruction, and
- (c) This Lease shall terminate as of the date which is thirty (30) days after such written notice of termination.

## 9.4 Default By Landlord

If Landlord is required to repair and restore the Premises as provided for in this Section 9, and Landlord thereafter fails to diligently prosecute said repair and restoration work to completion, as determined by Tenant in its reasonable discretion, then Tenant may, at its sole election:

- (a) Declare a default hereunder, or

- (b) Perform or cause to be performed the restoration work and deduct the cost thereof, plus interest thereon at ten percent (10%) per annum, from the next installment(s) of Base Rent due as a charge against the Landlord.

## 10. **REPAIRS AND MAINTENANCE**

### 10.1 Landlord Representations

- (a) Landlord represents to Tenant that, to the Landlord's knowledge, as of the date hereof and on the Commencement Date:
  - i. The Premises, the Building, and all Common Areas (including electrical, heating (Premises only), and ventilating and air conditioning ("VAC"), mechanical, plumbing, gas and fire/life safety systems in the Building and similar building service systems) comply with all current laws, codes, and ordinances, including but not limited to the Americans With Disabilities Act, and are in good working order and condition;
  - ii. The Building and the Premises comply with all covenants, conditions, restrictions and insurance underwriter's requirements;
  - iii. The Premises, the Building and the Common Areas are free of the presence of Hazardous Materials (as hereinafter defined); and
  - iv. Landlord has not received any notice from any governmental agency that the Building or the Premises are in violation of any law or regulation.
- (b) Landlord represents to Tenant that, to the Landlord's knowledge and based upon a professional inspection of the Premises and the Building and the Asbestos Report (as defined in Section 1.1) that the Premises and the Building contain no asbestos containing materials (other than as may be reflected in the Asbestos Report). Landlord shall, prior to Tenant's occupancy, abate, at Landlord's sole cost and expense, all asbestos-containing materials to the extent required by law and provide Tenant with an updated report from a licensed California Asbestos contractor to that effect. In the event asbestos is subsequently found to exist, it shall be the Landlord's responsibility to remove such asbestos at its sole cost and expense unless such asbestos was introduced by the Tenant, in which case such cost shall be paid by Tenant.

- (c) CASp Inspection:

In accordance with California Civil Code Section 1938, Landlord hereby states that the Premises and the Common Areas:  
*[Check the appropriate box]*

☐ Have undergone inspection by a Certified Access Specialist (a "CASp") and have been determined to meet all applicable construction related accessibility standards pursuant to California Civil Code Section 55.53. Landlord shall provide Tenant with a copy of the CASp inspection

report and a current disability access inspection certificate for the Premises within seven (7) days after the execution of this Lease.

☐ Have undergone inspection by a Certified Access Specialist and have not been determined to meet all applicable construction related accessibility standards pursuant to California Civil Code Section 55.53. Landlord has provided Tenant with a copy of the CASp inspection report at least 48 hours prior to the execution of this Lease. A Certified Access Specialist (CASp) can inspect the subject premises and determine whether the subject premises comply with all of the applicable construction-related accessibility standards under state law. Although state law does not require a CASp inspection of the subject premises, the commercial property owner or lessor may not prohibit the lessee or tenant from obtaining a CASp inspection of the subject premises for the occupancy or potential occupancy of the lessee or tenant, if requested by the lessee or tenant. The parties shall mutually agree on the arrangements for the time and manner of the CASp inspection, the payment of the fee for the CASp inspection, and the cost of making any repairs necessary to correct violations of construction-related accessibility standards within the premises.

☒ Have not undergone inspection by a Certified Access Specialist. A Certified Access Specialist (CASp) can inspect the subject premises and determine whether the subject premises comply with all of the applicable construction-related accessibility standards under state law. Although state law does not require a CASp inspection of the subject premises, the commercial property owner or lessor may not prohibit the lessee or tenant from obtaining a CASp inspection of the subject premises for the occupancy or potential occupancy of the lessee or tenant, if requested by the lessee or tenant. The parties shall mutually agree on the arrangements for the time and manner of the CASp inspection, the payment of the fee for the CASp inspection, and the cost of making any repairs necessary to correct violations of construction-related accessibility standards within the premises.

The foregoing statement is provided solely for the purpose of complying with California Civil Code Section 1938 and shall not affect the Landlord's and Tenant's respective responsibilities for compliance with any design and construction related accessibility obligations as provided under this Lease or any Work Letter.

- (d) Landlord agrees to indemnify and hold harmless Tenant from all damages, costs, and expenses, which result from a material breach of Landlord's representations contained in this Section 10.1 except in the case such damages, costs, and expenses arise from or are related to the Tenant's or Tenant's vendors, employees, agents, invitees and visitors use or alteration of the Premises.

## 10.2 Landlord Obligations

- (a) Landlord shall keep and maintain the Property in good condition and repair and promptly make repairs to and perform maintenance upon and replace as needed:

- i. the structural elements of the Building, including without limitation, all permanent exterior and interior walls, floors and ceilings, foundations, roof, concealed plumbing, stairways, concealed electrical systems and intra-building telephone network cables;
  - ii. mechanical (including both Landlord and Tenant installed Premises electric in-duct heating coils ("Premises Heating") and Building VAC), electrical, plumbing and fire/life systems serving the Building;
  - iii. the Common Areas;
  - iv. exterior windows of the Building; and
  - v. elevators serving the Building.
- (b) Landlord, at its sole cost and expense unless otherwise stated herein, shall also perform all maintenance and repairs to the Premises, and shall keep the Premises in good condition and repair, reasonable wear and tear excepted. Landlord's repair and maintenance obligations include, without limitation, maintenance of, or repairs to, or replacements of:
- i. spot clean floor covering if it will properly remove/address any soiled conditions;
  - ii. interior partitions;
  - iii. doors, door frames and hardware;
  - iv. spot clean the interior side of demising walls and/or spot clean the walls if it will properly remove/address any soiled conditions;
  - v. signage, excepting Tenant's personal signage within the Premises;
  - vi. emergency exit signage and battery replacement;
  - vii. VAC equipment dedicated to the mechanical rooms housing Tenant's computer servers and related equipment (at Tenant's expense and with Tenant's assigned Chief Executive Office Property Manager's review and written approval of said costs in advance of any material work to be performed that is not otherwise scheduled repair and maintenance);
  - viii. Light fixtures, bulbs, tubes and ballasts;
  - ix. Parking areas (including resurfacing, restriping, landscaping, sweeping, and lighting as applicable); and
  - x. Furniture systems and any other fabric or upholstered surfaces including chairs, couches, walls, etc., spot cleaned, or if determined to be necessary in Tenant's sole discretion, professionally cleaned in their entirety using a water extraction system, on an annual basis at Tenant's sole cost and expense.



- (c) Landlord shall, to the best of its ability, provide all reports, maintenance records, or other documentation as may be requested from time to time.
- (d) Landlord shall provide security, maintenance, repairs, water and other services to the Premises and common area to a standard similar to other comparable class office buildings in the Norwalk area sub-market.

### 10.3 Tenant Obligations

Without limiting Landlord's repair and maintenance obligations, and subject to Section 20.4 hereof, Tenant shall be responsible for the cost of (i) repairing any area of the Property damaged by Tenant or by Tenant's agents, employees, invitees or visitors, (ii) the repair of low voltage electronic, phone and data cabling and related equipment that is installed by or for the exclusive benefit of Tenant, (iii) reimbursing the Landlord for the cost of repair, maintenance, or replacement of Tenant's VAC serving its computer server room pursuant to the terms in Section 10.2(b) vii above), and (iv) repair, maintenance, or replacement of any Tenant fixtures, furniture and equipment, including telephones, and computers. All repairs and replacements shall:

- (a) be made and performed by contractors or mechanics approved by Landlord, which consent shall not be unreasonably withheld, conditioned or delayed;
- (b) be at least equal in quality, value and utility to the original work or installation; and
- (c) be in accordance with all applicable laws.

### 10.4 Tenant's Right to Repair

- (a) If Tenant provides written notice (or oral notice in the event of an emergency, such as damage or destruction to or of any portion of the Building structure and/or the Building systems, and/or anything that could cause material disruption to Tenant's business) to Landlord of an event or circumstance which requires the action of Landlord with respect to repair and/or maintenance, and if Landlord fails to provide such action within a reasonable period of time given the circumstances after the giving of such notice, but in any event not later than five (5) days after the giving of such notice, then Tenant may proceed to take the required action (provided, however, that no such notice shall be required in the event of an emergency which threatens life or where there is imminent danger to property or a possibility that a failure to take immediate action could cause a material disruption in Tenant's normal and customary business activities). Tenant shall have access to the Building to the extent necessary to perform the work contemplated by this provision. If such action was required under the terms of this Lease to have been taken by Landlord and was not taken by Landlord within such period (unless such notice was not required as provided above), and Tenant took such required action, then Tenant shall be entitled to prompt reimbursement by Landlord of Tenant's reasonable costs and expenses in having taken such action plus interest thereon at ten percent (10%) per annum. If not reimbursed by Landlord within ten (10) days after written notice, then Tenant shall be entitled to deduct from Base

Rent payable by Tenant under this Lease the amount set forth in its invoice for such work. The remedies provided in this Section are in addition to the remedies provided in Section 15.

- (b) Notwithstanding any provisions of this Lease to the contrary, Tenant, acting through the County's Chief Executive Office, may request that the Landlord perform, supply and administer any repairs, maintenance, building services and/or alterations that are the responsibility of the Tenant, not to exceed \$5,000, as part of a separate purchase order issued by the County on Tenant's behalf. Any improvements by Landlord shall be subject to compliance with County Internal Services Department Purchasing Policy and Procedure No. A-0300, effective November 22, 2016, delivered to Landlord and incorporated by reference herein. This Section shall not apply to any Tenant Improvements as defined in Section 24.

## **11. SERVICES AND UTILITIES**

### **11.1 Services**

#### **(a) Premises Heating and Ventilation and Air Conditioning (VAC)**

Landlord shall furnish Premises Heating and VAC (other than server or IT room VAC that Tenant may install and operate at its own expense), during Tenant's Hours of Operations in amounts required for the use and occupancy of the Premises for normal office purposes to a standard comparable to other first-class buildings and not less than the standard set forth in Exhibit C attached hereto. All heat provided to the Premises is derived from electric in-duct heat boxes within the Premises and all such heat boxes are to be connected to the Tenant's metered electric panel and the cost of operations of such boxes is a Tenant expense.

Landlord also shall provide VAC services during hours other than Tenant's Hours of Operation ("After Hours VAC"), subject to the following terms and conditions:

(1) Landlord shall provide the After Hours VAC if Tenant gives Landlord advance notice of its need for such service no later than 24 hours before such need on Monday through Friday (except holidays referred to above) that Tenant requires the services, and no later than 24 hours before the last business day preceding the weekend or holiday that Tenant requires the service. In addition, and notwithstanding the foregoing, Tenant may contact the Building manager or on-site Building engineer at any reasonable time to order After Hours VAC, and Landlord shall, to the extent reasonably practicable and at Tenant's expense to the extent of actual and reasonable labor costs incurred, provide After Hours VAC service as requested by Tenant, even if Tenant failed to give notice within the time periods specified above.

(2) Landlord will provide the After Hours VAC at "Actual Cost", defined herein as the actual costs incurred by Landlord in providing any particular service (including Landlord's reasonable estimate of related administrative cost for the cost of such service (to the extent not duplicative of costs included in Operating Costs) and applicable depreciation related to the

increased utilization of equipment used in providing the service). There shall be no start-up charges and minimum usage for After Hours VAC service. The foregoing direct charges shall be payable by Tenant as Additional Rent. The rate for After Hours VAC currently is Eighty-Five Dollars (\$85.00) per hour, which Landlord and Tenant acknowledge is appropriate in accordance with the foregoing. Landlord shall be entitled to increase such charge from time to time, upon at least thirty (30) days prior written notice to Tenant, but only to reflect increases in the cost of labor, electricity, water, and water treatment in connection therewith.

(b) Electricity

Landlord shall furnish to the Premises the amount of electric current necessary for power and lighting and electric current for Premises Heating and VAC, and Landlord shall provide the existing transformers or sub-panels for the Premises necessary for Tenant to utilize such capacity in the Premises. The Premises shall be metered for electricity by a meter installed by Landlord at Landlord's cost and expense. If Landlord elects to furnish non-public utility sourced electrical service to the Premises, Tenant must purchase its requirements thereof from Landlord and Tenant shall be billed monthly for its actual usage at a cost never to exceed 97% of the cost of similar electricity offered directly by the local public utility over the same billing period (local utility per kWh charge for any given month for similar load shall be included on all billing). Tenant shall pay Landlord for the cost of Premises metered electricity within fifteen (15) business days of billing.

If Tenant requires additional telecommunications service, Landlord shall arrange it at Tenant's expense and Landlord will cooperate.

(c) Elevators

Landlord shall furnish freight and passenger elevator services to the Premises during Tenant's Hours of Operations. During all other hours, Landlord shall furnish passenger elevator cab service in the elevator bank serving the Premises on an as needed basis, and, by prior arrangement with Landlord's building manager, freight elevator service.

(d) Water

Landlord shall make available to the Premises warm and cold water for normal and potable water purposes, all of which shall meet applicable government standards.

(e) Janitorial

Landlord, at its sole cost and expense, shall provide janitorial service five (5) days per week, generally consistent with that furnished in comparable office buildings in the County of Los Angeles, but not less than the services set forth in the specifications set forth in Exhibit D attached hereto.

(f) Access

Landlord shall furnish to Tenant's employees and agents access to the Building, Premises and Common Areas on a seven day per week, 24 hour per day basis, subject to compliance with such reasonable security measures as shall from time to time be in effect for the Building. If required, Landlord shall provide the initial 14 access cards or fobs to all Tenant employees for Building entry, elevators, and/or floor access at Landlord's sole cost and expense. Tenant shall pay Landlord Ten Dollars (\$10) for any replacement or additional building access cards or fobs required.

(g) Pest Control

Landlord at its sole cost and expense shall provide any and all pest control services to the Premises per the specifications set forth in Exhibit D attached hereto.

11.2 Utilities

Landlord agrees to pay when due, whether reimbursed pursuant to the terms of this Lease or not, all charges for the use of the sewer, effluent treatment (when and if imposed by any governmental authority), all water, sprinkler standby charges, electricity, gas, Premises Heating, and common area power and lighting, trash removal service, fire/life safety systems, charges associated with the Premises Heating and VAC, and other utility rents and charges accruing or payable in connection with the Premises and the Common Areas during the Term of this Lease or any renewal, extension, or holdover thereof, whether the same are prorated or measured by separate meters. In the event Landlord fails or refuses to pay any or all of such charges when due, Tenant may give Landlord ten (10) calendar days prior written notice and thereafter pay directly such charges and deduct the payments from the next installments of rent due as a charge against the Landlord.

12. TAXES

Landlord, at its sole cost and expense, shall pay, prior to delinquency, all real property taxes, assessments and special assessments which may be levied or assessed against the Premises or the Building during the term of this Lease or any renewal or holdover period thereof.

In the event Landlord fails or refuses to pay any or all taxes or assessments when due, Tenant may, at its sole discretion, give Landlord thirty (30) calendar days prior written notice and thereafter pay such taxes and assessments and deduct the payments from the next installments of rent due as a charge against the Landlord.

13. LANDLORD ACCESS

Tenant shall permit Landlord and its agents to enter the Premises during Tenant's Hours of Operations upon prior written notice only for the purpose of inspecting the Premises for any reasonable purpose; provided, however, in the event of an emergency, Landlord shall be allowed to enter the Premises to perform repairs related to the emergency. If Landlord temporarily closes any portion of the Building or the Premises, Base Rent shall be prorated based upon the percentage of the Premises or the Building rendered unusable and not

used by Tenant. Landlord shall have the right at any and all times to enter the Premises in the event of an emergency and notify Tenant immediately thereafter.

## **14. TENANT DEFAULT**

### **14.1 Default**

The occurrence of any one or more of the following events shall constitute a material default and breach of this Lease by Tenant ("Default"):

- (a) the failure by Tenant to make any payment of Base Rent or any other payment required to be made by Tenant hereunder (except to the extent an offset is expressly permitted hereunder) as and when due, and the failure continues for a period of ten (10) days after written notice to Tenant;
- (b) the failure by Tenant to observe or perform any of the other covenants, conditions or provisions of this Lease, where such failure shall continue for a period of thirty (30) days after written notice from Landlord specifying in detail the nature of the default; provided, however, if more than thirty (30) days are reasonably required for its cure then Tenant shall not be deemed to be in default if Tenant commences such cure, within said thirty (30)-day period and thereafter diligently prosecutes such cure to completion.

### **14.2 Termination**

Tenant agrees that if a Default should occur and should not be cured within the time periods set forth above, it shall be lawful for Landlord to terminate this Lease upon the giving of written notice to Tenant. In addition thereto, Landlord shall have such other rights or remedies as may be provided by law.

### **14.3 No Effect on Indemnity**

Nothing in this Article shall be deemed to affect either Landlord or Tenant's right to indemnification under any indemnification clause or clauses set forth in this Lease.

## **15. LANDLORD DEFAULT**

### **15.1 Remedies**

In addition to the provisions for Landlord's default provided by Sections 9.4, 10.4, 19, 21.2 and 32.3, Landlord shall be in default ("Landlord Default") in the performance of any obligation required to be performed by Landlord under this Lease if Landlord has failed to perform such obligation within five (5) days after the giving of written notice with respect thereto by Tenant (which notice shall be, if appropriate, the same notice given under Section 10.4); provided, however, that if the nature of the Landlord Default is such that the same cannot reasonably be cured within such five (5) day period, Landlord shall not be deemed to be in Landlord Default if Landlord shall within such period commence such cure and thereafter diligently prosecute the same to completion. If the Landlord Default is of such a nature that it materially and substantially interferes with Tenant's occupancy and use of the Premises and if such Landlord Default is not cured within the foregoing cure period, then Tenant shall have the right, at its option, with or without further notice or demand of any kind to Landlord or any other person, to

any one or more of the following described remedies in addition to all other rights and remedies provided at law or in equity or elsewhere herein:

- (a) to remedy such default or breach and deduct the costs thereof (including but not limited to attorney' fees) plus interest at the rate of ten percent (10%) per annum from the installments of Base Rent next falling due;
- (b) to pursue the remedy of specific performance;
- (c) to seek money damages for loss arising from Landlord's failure to discharge its obligations under this Lease or offset such damages against Base Rent next coming due; and/or
- (d) to terminate this Lease.

#### 15.2 Waiver

Nothing herein contained shall relieve Landlord from its duty to effect the repair, replacement, correction or maintenance required to restore any affected services, or to perform any other obligations to the standard prescribed in this Lease, nor shall this Section be construed to obligate Tenant to undertake any such work.

#### 15.3 Emergency

Notwithstanding the foregoing cure period, Tenant may cure any default where the failure promptly to cure such default would, in the reasonable opinion of Tenant, create or allow to persist an emergency condition, or materially and adversely affect the operation of Tenant's business in the Premises. In such cases, Tenant may perform the necessary work through its Internal Services Department and deduct the cost of said work from the Base Rent next due.

### 16. **ASSIGNMENT AND SUBLETTING**

#### 16.1 Assignment and Subletting

Tenant may assign or otherwise transfer this Lease or sublet the whole or any part of the Premises by providing prior written notice to Landlord; provided (i) the intended use of any such assignment or transfer is allowed under the terms of the GSA Lease for FBI and Homeland Security within the Building, and (ii) no such assignment, subletting or other transfer shall relieve Tenant of any liability under this Lease unless Landlord has given its written consent thereto, which Landlord shall not unreasonably withhold, condition or delay if the assignee has a financial condition which is reasonably sufficient for it to be responsible for all future obligations under this Lease.

#### 16.2 Sale

If Landlord sells or conveys the Property, then all liabilities and obligations of Landlord accruing under this Lease after the sale or conveyance shall be binding upon the new owner, and the transferor shall be released from all liability under this Lease accruing subsequent to such sale or conveyance, provided that the transferee assumes Landlord's remaining obligations hereunder in writing. Nothing in this Section 16.2 shall be deemed to release Landlord's successor in

interest from responsibility for any condition (including but not limited to deferred maintenance) existing on the date of transfer.

Upon any sale or transfer of the Property by Landlord, Landlord shall provide thirty (30) days prior written notice of said sale or transfer to Tenant. In addition, Landlord shall provide the following information to Tenant, at Tenant's Address for Notice (set forth in Section 1.1 hereof), as a condition of Tenant's obligation to pay Base Rent to the new owner:

- (a) A letter from the Landlord confirming that the Property was transferred to the new owner, along with written evidence of the transfer of the Property (e.g., a recorded deed).
- (b) A signed letter from the new owner including the following information:
  - i. Name and address of new owner or other party to whom Base Rent should be paid
  - ii. Federal tax ID number for new owner
  - iii. Name of contact person and contact information (including phone number) for new owner
  - iv. Proof of insurance
- (c) A W-9 form for new owner.

Tenant shall not be obligated to pay any rental amounts to any party other than the Landlord named herein until such time as all the requirements of this Section 16.2 are satisfied.

## **17. ALTERATIONS AND ADDITIONS**

### **17.1 Landlord Consent**

Tenant shall not make any structural alterations, improvements, additions, or utility installations in or about the Premises (collectively, "Alterations") without first obtaining the written consent of Landlord, which consent shall not be unreasonably withheld, conditioned or delayed. If Landlord fails to respond in writing within thirty (30) days after Tenant's request, then Landlord shall be deemed to have approved the requested Alterations. However, Landlord's consent shall not be required for any Alteration that satisfies all of the following criteria:

- (a) complies with all laws;
- (b) is not visible from the exterior of the Premises or Building;
- (c) will not materially affect the systems or structure of the Building; and
- (d) does not unreasonably interfere with the normal and customary business office operations of other tenants in the Building.

## 17.2 End of Term

Any Alterations, fixtures, equipment, and all other personal property placed or installed in or upon the Premises or otherwise owned by Tenant, or under its authority (including any modular furniture) shall, if Landlord so requests, be removed by Tenant at the end of the Term. Any Alterations, fixtures, equipment and all other personal property owned, placed or installed in or upon the Premises by Tenant, or under its authority (including any modular furniture) not removed by Tenant shall become the property of Landlord and remain upon and be surrendered with the Premises at the expiration of the Term.

## 18. **CONDEMNATION**

### 18.1 Controlling Terms

If during the Term, or during the period of time between the execution of this Lease and the Commencement Date, there is any taking of all or any part of the Premises or any interest in this Lease by Condemnation (as defined below), this Section shall determine the rights and obligations of Tenant and Landlord. "Condemnation" shall mean the exercise of any governmental power to take title to any portion of the Premises, whether by legal proceedings or otherwise, by a Condemnor (as defined below) or a voluntary sale or transfer by Landlord to any Condemnor either under threat of a Condemnor's exercise of such power or while legal proceedings are pending for the exercise of such power. "Condemnor" shall mean any public or quasi-public authority, or private corporation or individual, having the power of Condemnation.

### 18.2 Total Taking

If the Premises are totally taken by Condemnation, this Lease shall terminate on the date the Condemnor has a right to possession of the Premises (the "Date of Taking").

### 18.3 Partial Taking

If any portion, but not all, of the Premises or the Common Areas is taken by Condemnation, this Lease shall remain in effect, except that Tenant may elect to terminate this Lease if, in Tenant's reasonable judgment, the remaining portion of the Premises (including the space available for parking) is rendered unsuitable for Tenant's continued use of the Premises. If Tenant elects to so terminate this Lease, Tenant must exercise its right to terminate by giving notice to Landlord within thirty (30) days after the date that the nature and the extent of the Condemnation have been determined (the "Determination Date"), which notice shall set forth the date of termination. Such termination date shall not be earlier than thirty (30) days nor later than ninety (90) days after Tenant has notified Landlord of its election to terminate; except that this Lease shall terminate on the Date of Taking if the Date of Taking falls on a date before the termination date designated by Tenant. If Tenant does not so notify Landlord within thirty (30) days after the Determination Date, all obligations of Tenant under this Lease shall remain in effect, except that Base Rent shall be equitably abated in proportion to the degree to which Tenant's use of the Premises and the Common Areas is impaired by such Condemnation.



#### 18.4 Restoration

Notwithstanding the preceding paragraph, if, within thirty (30) days after the Determination Date, Landlord notifies Tenant that Landlord, at its sole cost, will add to the remaining Premises and/or the Common Areas so that the Premises and the space available for parking, will be substantially the same (as reasonably determined by Tenant) after the Date of Taking as they were before the Date of Taking, and Landlord commences the restoration promptly and, subject to reasonable allowance for delays that are not caused by Landlord, completes it within ninety (90) days after Landlord so notifies Tenant, then this Lease shall continue in effect. In such event, all obligations of Tenant under this Lease shall remain in effect, except that Base Rent shall be equitably abated or reduced during the period from the Date of Taking until the completion of such restoration.

#### 18.5 Award

The Award (as defined below) shall be divided between Landlord and Tenant as their respective interests may appear. "Award" shall mean all compensation, sums or anything of value awarded, paid or received on a total or partial Condemnation of the Premises. Tenant shall be entitled to any awards for relocation benefits or goodwill belonging to Tenant.

#### 18.6 Waiver of Statute

Landlord and Tenant hereby waive the provision of California Code of Civil Procedure Section 1265.130 allowing Landlord or Tenant to petition the Superior Court to terminate this Lease in the event of a partial taking of the Premises.

### 19. INDEMNIFICATION

#### 19.1 Landlord's Indemnity

The Landlord shall indemnify, defend and hold harmless the Tenant from and against any and all liability, loss, injury or damage including (but not limited to) demands, claims, actions, fees, costs and expenses (including attorney and expert witness fees), arising from or connected with the Landlord's repair, maintenance and other acts and omissions arising from and/or relating to the Landlord's ownership of the Premises.

#### 19.2 Tenant's Indemnity

The Tenant shall indemnify, defend and hold harmless the Landlord, from and against any and all liability, loss, injury or damage, including (but not limited to) demands, claims, actions, fees, costs and expenses (including attorney and expert witness fees) arising from or connected with the Tenant's repair, maintenance and other acts and omissions, negligence or willful misconduct of Tenant, or its contractors, licensees, agents, employees, guests or visitors, or arising from any breach or default under this Lease and/or relating to the Tenant's use of the Premises.

### 20. INSURANCE

During the term of this Lease, the following insurance requirements will be in effect:

## 20.1 Waiver

Both the Tenant and Landlord each agree to release the other and waive their rights of recovery against the other for damage to their respective property arising from perils insured in the Causes-of-Loss Special Form (ISO form CP 10 30).

## 20.2 General Insurance Provisions – Landlord Requirements

Without limiting the Landlord's indemnification of Tenant and during the term of this Lease, and until all of its obligations pursuant to this Lease have been met, Landlord shall provide and maintain at its own expense insurance coverage satisfying the requirements specified in this Lease. These minimum insurance coverage terms, types and limits (the "Required Insurance") also are in addition to and separate from any other contractual obligation imposed upon Landlord pursuant to this Lease. The Tenant in no way warrants that the Required Insurance is sufficient to protect the Landlord for liabilities which may arise from or relate to this Lease.

### (a) Evidence of Coverage and Notice to Tenant

- i. Certificate(s) of insurance coverage ("Certificate") satisfactory to Tenant, and a copy of an Additional Insured endorsement confirming that Tenant and its Agents (defined below) has been given additional insured status under the Landlord's General Liability policy, shall be delivered to Tenant at the address shown below and provided prior to the start day of this Lease.
- ii. Renewal Certificates shall be provided to Tenant not less than 10 days after the Landlord's policy expiration dates. The Tenant reserves the right to obtain complete, certified copies of any required Landlord insurance policies at any time.
- iii. Certificates shall identify all Required Insurance coverage types and limits specified herein, reference this Lease by name or number or the Premises, and be signed by an authorized representative of the insurer(s). The Tenant shall be named as an additional insured (or its equivalent) for the Premises only. Certificates shall provide the full name of each insurer providing coverage, its NAIC (National Association of Insurance Commissioners) identification number, its financial rating, the amounts of any policy deductibles or self-insured retentions exceeding one hundred thousand dollars (\$100,000.00) dollars, and list any Tenant-required endorsement forms.
- iv. Neither the Tenant's failure to obtain, nor the Tenant's receipt of, or failure to object to a non-complying insurance certificate or endorsement, or any other insurance documentation or information provided by the Landlord, its insurance broker(s) and/or insurer(s), shall be construed as a waiver of any of the Required Insurance provisions.
- v. Certificates and copies of any required endorsements, and/or notices of cancellation shall be delivered to:

County of Los Angeles  
Chief Executive Office - Real Estate Division  
320 West Temple Street, 7th Floor  
Los Angeles, CA 90012  
Attention: Director of Real Estate

Landlord also shall promptly notify Tenant of any third party claim or suit filed against Landlord which arises from or relates to this Lease, and could result in the filing of a claim or lawsuit against Landlord and/or Tenant.

(b) Additional Insured Status and Scope of Coverage

The Tenant, which is the County of Los Angeles, its Special Districts, Elected Officials, Officers, Agents, Employees and Volunteers (collectively, "Tenant and its Agents"), shall be provided additional insured status under Landlord's General Liability policy with respect to liability arising from or connected with the Landlord's acts, errors, and omissions arising from and/or relating to the Landlord's operations on and/or its ownership of the Premises with respect to Tenant. Tenant's additional insured status shall apply with respect to liability and defense of suits arising out of the Landlord's acts or omissions, whether such liability is attributable to the Landlord or to the Tenant. The full policy limits and scope of protection also shall apply to the Tenant as an additional insured with respect to the Tenant's use of the Premises as stated in Section 1.1(k) of the Lease, even if they exceed the Tenant's minimum Required Insurance specifications herein. Use of an automatic additional insured endorsement form is acceptable providing it satisfies the Required Insurance provisions herein.

(c) Cancellation of or Changes in Insurance

Landlord shall provide the Tenant with, or Landlord's insurance policies shall contain a provision that the Tenant shall receive, written notice of cancellation or any material change in Required Insurance, including insurer, limits of coverage, term of coverage or policy period. The written notice shall be provided to the Tenant at least ten (10) days in advance of cancellation for non-payment of premium and thirty (30) days in advance for any other cancellation or policy change. Failure to provide written notice of cancellation or any material change in Required Insurance may, in the reasonable discretion of the Tenant, constitute a Landlord Default under this Lease.

(d) Failure to Maintain Insurance

Landlord's failure to maintain or to provide acceptable evidence that it maintains the Required Insurance shall constitute a Landlord Default. In lieu of treating the failure as a Landlord Default, the County in its sole discretion may purchase the Required Insurance, and without further notice to Landlord, deduct the premium cost from sums due to Landlord or pursue Landlord reimbursement.

(e) Insurer Financial Ratings

Insurance is to be provided by an insurance company authorized to do business in California, with an A.M. Best rating of not less than A:VII, unless otherwise approved by the Tenant..

(f) Landlord's Insurance Shall Be Primary

Landlord's insurance policies, with respect to any claims related to this Lease, shall be primary with respect to all other sources of coverage available to Tenant. Any Landlord maintained insurance or self-insurance coverage shall be in excess of and not contribute to any Tenant coverage.

(g) Waiver of Subrogation

To the fullest extent permitted by law, the Landlord hereby waives its and its insurer(s) rights of recovery against Tenant under all required insurance policies for any loss arising from or related to this Lease. The Landlord shall require its insurers to execute any waiver of subrogation endorsements which may be necessary to affect such waiver.

(h) Deductibles and Self-Insured Retentions ("SIRs")

Landlord's policies shall not obligate the Tenant to pay any portion of any Landlord deductible or SIR. The Tenant retains the right to require Landlord to reduce or eliminate policy deductibles and SIRs as respects the Tenant, or to provide a bond guaranteeing Landlord's payment of all deductibles and SIRs, including all related claims investigation, administration and defense expenses. Such bond shall be executed by a corporate surety licensed to transact business in the State of California.

(i) Claims Made Coverage

If any part of the Required Insurance is written on claims made basis, any policy retroactive date shall precede the start date of this Lease. Landlord understands and agrees it shall maintain such coverage for a period of not less than three (3) years following Lease expiration, termination or cancellation.

(j) Application of Excess Liability Coverage

Landlord may use a combination of primary and excess insurance policies which provide coverage as broad as ("follow form" over) the underlying primary policies, to satisfy the Required Insurance provisions.

(k) Separation of Insureds

All liability policies shall provide cross-liability coverage as would be afforded by the standard ISO (Insurance Services Office, Inc.) separation of insureds provision with no insured versus insured exclusions or limitations.

(l) Tenant Review and Approval of Insurance Requirements

The Tenant reserves the right to review and adjust the Required Insurance provisions, conditioned upon Tenant's determination of changes in risk exposures.

20.3 Insurance Coverage Types And Limits

(a) Tenant Requirements: During the term of this Lease, Tenant shall maintain a program of insurance coverage as described below:

i. Commercial General Liability Insurance, providing scope of coverage equivalent to ISO policy form CG 00 01, naming Landlord and its Agents as an additional insured, with limits of not less than:

General Aggregate:	\$ 2 million
Products/Completed Operations Aggregate:	\$ 2 million
Personal and Advertising Injury:	\$ 1 million
Each Occurrence:	\$ 1 million
Damage to Premises:	\$ 1 million
Medical Expense Limit:	\$ 10,000

Tenant, at its sole option, may satisfy all or any part of this insurance requirement through use of a program of self-insurance (self-funding of its liabilities). Certificate evidencing coverage or letter evidencing self-funding will be provided to Landlord after execution of this Lease at Landlord's request. Notwithstanding Tenant's right to self-insure, Landlord shall not waive its right to tender third party claims to Tenant caused by Tenant's intentional or negligent acts or omissions or such intentional or negligent acts or omissions of Tenant's contractors, invitees and/or licensees.

20.4 Landlord Requirements During the term of this Lease, Landlord shall provide and maintain the following programs of insurance coverage:

(a) Commercial General Liability Insurance, providing scope of coverage equivalent to ISO policy form CG 00 01, naming Tenant and Tenant's Agents as an additional insured, with limits of not less than:

General Aggregate:	\$ 10 million
Products/Completed Operations Aggregate:	\$ 10 million
Personal and Advertising Injury:	\$ 5 million
Each Occurrence:	\$ 5 million

(b) Commercial Property Insurance. Such insurance shall:

i. Provide coverage for any tenant improvements and betterments to the Premises that constitute "fixtures" (excludes all other furniture, fixtures, and equipment, including but not limited to the computer server room and any equipment therein); this coverage shall be at least as broad as that provided by the Causes-of-Loss Special Form (ISO form CP 10 30), excluding earthquake and including flood and ordinance or law coverage.

- ii. Be written for the full replacement cost of the Property, with a deductible no higher than the greater \$250,000 or 5% of the Property value. Insurance proceeds shall be payable to the Landlord and Tenant, as their interests may appear, and be utilized for repair and restoration of the Premises or Landlord's property, as determined by the nature of the loss.

## **21. PARKING**

### **21.1 Tenant's Rights**

Tenant shall have the right to the number of unreserved parking spaces set forth in Section 1.1 for the Term of this Lease. No tandem parking shall be required or allowed except as provided below, and Tenant shall be entitled to full in and out access privileges at all times. Tenant's parking rights shall be subject to reasonable parking rules and regulations adopted by Landlord from time to time, provided that such procedures shall be uniformly applied to all tenants. Tenant acknowledges that all unreserved parking spaces are not for the exclusive use of Tenant, rather, all such parking spaces are to be used on a non-exclusive, first-come, first-served basis by Tenant and other tenants, occupants, licensees, invitees and permittees of the Building. Tenant shall have the right to increase or decrease the number of reserved and/or unreserved parking subject to availability and thirty (30) days written notice to the Landlord; provided, however, Landlord shall have the right to recapture any increase in parking should such parking be required for other tenancies. Landlord, at its sole expense, shall provide Tenant with at least one (1) parking access card or key fob for each unreserved parking space set forth in Section 1.1, if applicable. If additional access cards or key fobs are later required, lost, stolen, or replaced, Tenant shall pay ten dollars (\$10) per access card or key fob.

### **21.2 Remedies**

Landlord acknowledges that it is a material term of this Lease that Tenant receives all of the parking spaces to which it is entitled under this Lease for the entire Term of this Lease and that it would be impracticable and extremely difficult to fix the actual damages for a breach of such provisions. It is therefore agreed that if, for any reason whatsoever, a material number of the parking spaces required above are not available to Tenant (in addition to the rights given to Tenant under Section 14 and Sections 9 and 17 in the event of casualty or condemnation), following written notice to Landlord and Landlord's ability to cure in a reasonable time, then Tenant may:

- (a) terminate this Lease by giving written notice of such termination to Landlord, which notice shall be effective thirty (30) days thereafter, or
- (b) negotiate with Landlord for an equitable reduction in the monthly rent based upon the fair market value of such parking or the loss of such parking if not replaced.

### 21.3 Alternative Parking.

Notwithstanding the above, if during the Term (as it may be extended), Landlord is unable to provide all or any portion of the parking required under Lease, Landlord may, but is not required to, provide valet parking or such alternative parking that Landlord may reasonably believe will satisfy Tenant's parking needs or provide additional parking at an off-site location nor more than a three-minute drive from the Premises. In the event Landlord provides off-site parking Landlord shall provide a shuttle service from the off-site parking location to the Premises. Provided Landlord offers Tenant alternative parking pursuant to this paragraph, Landlord shall not be deemed in default of the Lease and the remedies as set forth in Paragraph 21.2 shall not be applicable. Landlord may also, offer stacked parking to satisfy Tenant's parking only if Landlord also provides valet parking at Landlord's sole cost and expense.

## 22. ENVIRONMENTAL MATTERS

### 22.1 Hazardous Materials

Tenant shall not cause nor permit, nor allow any of Tenant's employees agents, customers, visitors, invitees, licensee, contractor, assignees or subtenants to cause or permit, any Hazardous Materials to be brought upon, stored, manufactured, generated, blended, handled, recycled, treated, disposed or used on, under or about the Premises, the Building or the Common Areas, except for routine office and janitorial supplies in usual and customary quantities stored, used and disposed of in accordance with all applicable Environmental Laws. As used herein, "Hazardous Materials" means any chemical, substance, material, controlled substance, object, condition, waste, living organism or combination thereof, whether solid, semi solid, liquid or gaseous, which is or may be hazardous to human health or safety or to the environment due to its radioactivity, ignitability, corrosivity, reactivity, explosivity, toxicity, carcinogenicity, mutagenicity, phytotoxicity, infectiousness or other harmful or potentially harmful properties or effects, including, without limitation, molds, toxic levels of bacteria, tobacco smoke within the Premises, petroleum and petroleum products, asbestos, radon, polychlorinated biphenyls (PCBs), refrigerants (including those substances defined in the Environmental Protection Agency's "Refrigerant Recycling Rule," as amended from time to time) and all of those chemicals, substances, materials, controlled substances, objects, conditions, wastes, living organisms or combinations thereof which are now or become in the future listed, defined or regulated in any manner by any Environmental Law based upon, directly or indirectly, such properties or effects. As used herein, "Environmental Laws" means any and all federal, state or local environmental, health and/or safety-related laws, regulations, standards, decisions of courts, ordinances, rules, codes, orders, decrees, directives, guidelines, permits or permit conditions, currently existing and as amended, enacted, issued or adopted in the future which are or become applicable to Tenant, the Premises, the Building or the Common Areas.

### 22.2 Landlord Indemnity

Landlord shall indemnify, protect, defend (by counsel acceptable to Tenant) and hold harmless Tenant from and against any and all claims, judgments, causes of

action, damage, penalties, fines, taxes, costs, liabilities, losses and expenses arising at any time during or after the Term as a result (directly or indirectly) of, or in connection with, the presence of Hazardous Materials on, under or about the Premises, Building or Common Areas or other violation of laws relating to Hazardous Materials other than those caused by Tenant. This indemnity shall include, without limitation, the cost of any required or necessary repair, cleanup or detoxification, and the preparation and implementation of any closure, monitoring or other required plans, as such action is required by local or state laws or any governmental agency. Landlord shall promptly deliver to Tenant a copy of any notice received from any governmental agency during the Term of this Lease concerning the presence of Hazardous Materials in the Building or the Premises. Landlord's obligations pursuant to the foregoing indemnity shall survive the expiration or termination of this Lease. A default by Landlord under this Section shall constitute a material default under this Lease.

**23. ESTOPPEL CERTIFICATES**

Tenant shall, within thirty (30) business days after written request of Landlord, execute, acknowledge, and deliver to Landlord or its designee a written statement in the form of Exhibit F attached hereto (properly completed) but shall have no other obligation to deliver any other form of estoppel certificate. It is intended that any such statement delivered pursuant to this Section may be relied upon by a prospective purchaser of Landlord's interest in the Premises or a holder of any mortgage upon Landlord's interest in the Premises.

**24. INTENTIONALLY OMITTED**

**25. LIENS**

Tenant shall keep its interest in this Lease and the Premises free from any liens arising out of any work performed or materials ordered, or obligations incurred by Tenant. Landlord shall keep its interest in this Lease and the Premises free from any liens which would impair the interest of Tenant hereunder and hereby indemnifies and holds Tenant harmless from any liability or loss from any such lien.

**26. SUBORDINATION AND MORTGAGES**

**26.1 Subordination and Non-Disturbance**

Tenant agrees, at Landlord's option, to subordinate this Lease to the lien of any mortgages or deeds of trust now or hereafter in force against the Building; provided, however, Tenant's obligation to subordinate this Lease is expressly conditioned upon Tenant receiving a written agreement in the form of Exhibit E attached hereto and provided further that no such subordination shall affect any option to extend the Term of this Lease, right of first offer to lease additional premises, option to purchase, or right of first offer to purchase the Property included herein.

**26.2 Existing Deeds of Trust**

The beneficiary under any existing deed of trust affecting the Building shall provide a written agreement to Tenant in the form of Exhibit E attached hereto, within sixty (60) days after the execution of this Lease.



### 26.3 Notice of Default

If any mortgagee or beneficiary under a deed of trust affecting the Property gives written notice of its name and address to Tenant by registered mail and requests copies of any notice of default that Tenant serves upon Landlord, Tenant agrees to use its best efforts (but without liability for failure to do so) to give such mortgagee or beneficiary a copy of any notice of default that Tenant serves upon Landlord which could permit Tenant to terminate this Lease, along with an additional ten (10) days within which to cure such default.

## 27. **SURRENDER OF POSSESSION**

Subject to casualty, at the expiration of the Term of this Lease, whether by lapse of time or otherwise, Tenant shall promptly and peacefully surrender the Premises to Landlord in a "broom-clean" condition, ordinary wear and tear, damage by earthquake, fire or the elements and other disaster or casualty excepted. Tenant and Landlord agree, Landlord may require Tenant to remove, at its own expense, during or at the expiration or other termination of the term of this Lease, or any termination of any extension or holdover period thereof, as the case may be, all furniture, fixtures, equipment and all other personal property placed or installed in or upon the Premises by Tenant, or under its authority (including any modular furniture).

## 28. **SIGNAGE**

### 28.1 Directory Signage

Tenant shall be allowed building standard signage on the directory located in the ground floor lobby of the Building and elevator lobbies of the floors of the Premises and suite signage, all of which shall be at Landlord's expense. Tenant shall have the right to install, at Landlord's sole cost and expense, up to two (2) lines per 1,000 rentable square feet of the Premises on the Building's directory board in the main lobby of the Building. Tenant shall be permitted to install signs at the Premises that conform with any and all applicable laws and ordinances and Building Rules and Regulations.

## 29. **QUIET ENJOYMENT**

So long as Tenant is not in default hereunder, Tenant shall have the right to the peaceful and quiet enjoyment and possession of the Premises and the Common Areas during the Term of this Lease, subject to the terms and conditions of this Lease.

## 30. **GENERAL**

### 30.1 Headings

Titles to Sections of this Lease are not a part of this Lease and shall have no effect upon the construction or interpretation of any part hereof.

### 30.2 Successors and Assigns

All of the covenants, agreements, terms and conditions contained in this Lease shall inure to and be binding upon the Landlord and Tenant and their respective successors and assigns.

### 30.3 Brokers

Landlord and Tenant each represent and warrant to each other that it has not engaged any broker, finder or other person who would be entitled to any commission or fees in respect of the negotiation, execution or delivery of this Lease and shall indemnify and hold harmless each other against any loss, cost, liability or expense incurred by the other party as a result of any claim asserted by any such broker, finder or other person on the basis of any arrangements or agreements made or alleged to have been made in variance with this representation.

### 30.4 Entire Agreement

This Lease (including all exhibits hereto) is the final and complete expression of Landlord and Tenant relating in any manner to the leasing, use and occupancy of the Premises, to Tenant's use of the Building and other matters set forth in this Lease. No prior agreements or understanding pertaining to the same shall be valid or of any force or effect, and the covenants and agreements of this Lease shall not be altered, modified or added to except in writing signed by both Landlord and Tenant.

### 30.5 Severability

Any provision of this Lease which shall prove to be invalid, void or illegal shall in no way affect, impair or invalidate any other provision hereof, and the remaining provisions hereof shall nevertheless remain in full force and effect.

### 30.6 Notices

The parties shall give all notices in writing by (i) personal delivery, (ii) national-recognized, next-day courier service, or (iii) first-class registered or certified mail, postage prepaid, to the Landlord's Address for Notice and Tenant's Address for Notice as set forth in Section 1.1. Without limiting the generality of the foregoing, Landlord's notices to Tenant shall not be effective if they are delivered to the Premises or to another address that is not set forth in Section 1.1(b) hereof. Any notice given under this Lease shall be deemed effective upon the date of delivery (whether accepted or refused), which, for certified mail and courier service, shall be established by U.S. Post Office return receipt or the courier's proof of delivery, respectively.

### 30.7 Governing Law and Venue

This Lease shall be governed by and construed in accordance with the internal laws of the State of California. Any litigation with respect to this Lease shall be conducted in the County of Los Angeles, State of California.

### 30.8 Waivers

No waiver by Landlord or Tenant of any provision hereof shall be deemed a waiver of any other provision hereof or of any subsequent breach by Landlord or Tenant of the same or any other provision. Landlord's or Tenant's consent to or approval of any act shall not be deemed to render unnecessary the obtaining of Landlord's or Tenant's consent to or approval of any subsequent act by Landlord or Tenant.

30.9 Time of Essence

Time is of the essence for the performance of all of the obligations specified hereunder.

30.10 Consent

Whenever any consent is required by Landlord or Tenant hereunder, such consent shall not be unreasonably withheld, conditioned or delayed and, unless otherwise specifically provided herein, shall be deemed granted if not refused within ten (10) business days after written request is made therefore, together with all necessary information.

30.11 Community Business Enterprises

Landlord shall complete and deliver to Tenant concurrently with the execution hereof a Community Business Enterprises form set forth as Exhibit G attached hereto.

30.12 Memorandum of Lease

If requested by Tenant, Landlord and Tenant shall execute and acknowledge a Memorandum of Lease in the form of Exhibit H attached hereto, which Memorandum may be recorded by Tenant in the Official Records of Los Angeles County.

30.13 Counterparts; Electronic Signatures

This Lease and any other documents necessary for the consummation of the transaction contemplated by this Lease may be executed in counterparts, including both counterparts that are executed on paper and counterparts that are in the form of electronic records and are executed electronically. An electronic signature means any electronic sound, symbol or process attached to or logically associated with a record and executed and adopted by a party with the intent to sign such record, including facsimile or e-mail electronic signatures. All executed counterparts shall constitute one agreement, and each counterpart shall be deemed an original. The parties hereby acknowledge and agree that electronic records and electronic signatures, as well as facsimile signatures, may be used in connection with the execution of this Lease and electronic signatures, facsimile signatures or signatures transmitted by electronic mail in so-called pdf format shall be legal and binding and shall have the same full force and effect as if a paper original of this Lease had been delivered had been signed using a handwritten signature. Landlord and Tenant (i) agree that an electronic signature, whether digital or encrypted, of a party to this Lease is intended to authenticate this writing and to have the same force and effect as a manual signature, (ii) intended to be bound by the signatures (whether original, faxed or electronic) on any document sent or delivered by facsimile or, electronic mail, or other electronic means, (iii) are aware that the other party will rely on such signatures, and (iv) hereby waive any defenses to the enforcement of the terms of this Lease based on the foregoing forms of signature. If this Lease has been executed by electronic signature, all parties executing this document are expressly consenting under the United States Federal Electronic Signatures in Global and National Commerce Act of 2000 ("E-SIGN") and California Uniform Electronic Transactions Act ("UETA")(Cal. Civ.

Code § 1633.1, et seq.), that a signature by fax, email or other electronic means shall constitute an Electronic Signature to an Electronic Record under both E-SIGN and UETA with respect to this specific transaction.

**31. AUTHORITY**

Only the County's Board of Supervisors ("Board of Supervisors") has the authority, by formally approving and/or executing this Lease, to bind Tenant to the terms included herein. Landlord understands that no material terms of this Lease may be altered or deleted, nor may any new material terms be added to this Lease, without the express written approval of the Board of Supervisors, either through an amendment to the Lease or by other formal board action. No County officer, employee, agent or independent contractor has any authority to alter, add or delete the material terms of this Lease, and Landlord may not rely upon any representations to the contrary. This limitation of authority applies to all material terms of the Lease including, without limitation, any monetary ceiling established for Tenant Improvements or other project costs of Landlord which are subject to reimbursement by Tenant. Tenant shall not reimburse Landlord for any expenses which exceed this ceiling. Notwithstanding the foregoing, the Chief Executive Office of the County (the "Chief Executive Office") may take any administrative act on behalf of Tenant hereunder which does not have the effect of increasing Base Rent or other financial obligations of Tenant under this Lease, including without limitation, granting any approvals, terminating this Lease in the manner provided herein by an early termination notice or otherwise, signing estoppel certificates, signing the Commencement Date Memorandum and Confirmation of Lease Terms or subordinating this Lease. Each individual executing this Lease on behalf of Landlord represents and warrants that he or she is duly authorized to execute and deliver this Lease on behalf of Landlord, and that this Lease is binding upon Landlord in accordance with its terms.

**32. ACKNOWLEDGEMENT BY LANDLORD**

Landlord acknowledges that it is aware of the following provisions:

**32.1 Consideration of GAIN Program Participants**

Should Landlord require additional or replacement personnel after the effective date of this Lease, Landlord shall give consideration for any such employment openings to participants in the County Department of Public Social Services' Greater Avenues for Independence ("GAIN") Program who meet Landlord's minimum qualifications for the open position. The County will refer GAIN participants by job category to Landlord.

**32.2 Solicitation of Consideration**

It is improper for any County officer, employee or agent to solicit consideration in any form from a landlord. A landlord shall not offer or give, either directly or through an intermediary, consideration in any form to a County officer, employee or agent who has had any involvement in the procurement, negotiation, consummation, administration or management of a lease.

Landlord shall immediately report any attempt by a County officer, employee or agent to solicit such improper consideration. The report shall be made to the County Auditor-Controller's Employee Fraud Hotline at (800) 544-6861.

Landlord hereby represents and warrants that it has not provided, and will not provide, any financial benefits to any County official, employee or agent who has had any involvement in the procurement, negotiation, consummation, administration or management of this Lease. Landlord hereby agrees that if it violates any of the terms of this Section 32.2, then the County may declare this Lease null and void, and the County reserves the right to exercise any and all other remedies available under applicable law.

### 32.3 Landlord Assignment

- (a) Landlord may assign, transfer, mortgage, hypothecate or encumber Landlord's right, title and interest in and to this Lease or any portion thereof (including the right to receive rental payments but excluding its duties and obligations hereunder), and Landlord may execute any and all instruments providing for the payment of Base Rent directly to an assignee or transferee, but only if the conditions set forth in this Section are met.
- (b) Any document or agreement purporting to assign, transfer, mortgage, hypothecate or encumber Landlord's right, title and interest in and to this Lease, or any portion thereof, as security for the Landlord's obligation to repay any monetary obligation, is hereinafter referred to as a "Security Agreement." Any Security Agreement which is executed without full compliance with the requirements of this Section shall be void.
- (c) Each assignee or transferee under the Security Agreement shall certify and agree in writing that such assignee or transferee has read and is familiar with the requirements of Sections 5950-5955 of California Government Code, which prohibits the offer or sale of any security constituting a fractional interest in this Lease or any portion thereof, without the prior written consent of the Tenant. Notwithstanding the foregoing, the Tenant hereby acknowledges and agrees that Landlord shall have the right to encumber the Property with CMBS (commercial mortgage backed securities) financing or other traditional real estate financing. However, Landlord may not encumber the Property through any type of bond financing vehicle, including but not limited to certificate of participation financing.
- (d) Violation by Landlord of the provisions of Section 5951 of the California Government Code will constitute a material breach of this Lease, upon which the Tenant may impose damages in an amount equal to the greater of \$500,000 or 10% of the aggregate principal portion of all rental payments payable by the Tenant during the entire Term of this Lease, it being expressly agreed that the aforesaid amount shall be imposed as liquidated damages, and not as a forfeiture or penalty. It is further specifically agreed that the aforesaid amount is presumed to be the amount of damages sustained by reason of any such violation, because from the circumstances and nature of the violation it would be impracticable and extremely difficult to fix actual damages. In addition, the Tenant may exercise or pursue any other right or remedy it may have under this Lease or applicable law.
- (e) Landlord shall give Tenant written notice and a copy of each and every assignment, transfer, hypothecation or encumbrance of Landlord's interest

in this Lease and any instrument relating thereto (including, but not limited to, instruments providing for the payment of Base Rent directly to an assignee or transferee) at least thirty (30) days prior to the effective date thereof.

- (f) Except to an existing or future mortgagor or lender, Landlord shall not furnish any information concerning Tenant or the subject matter of this Lease (including, but not limited to, offering memoranda, financial statements, economic and demographic information, and legal opinions rendered by the office of counsel for the Tenant) to any person or entity, except with Tenant's prior written consent. Landlord shall indemnify, defend and hold Tenant and its officers, agents and employees harmless from and against all claims and liability alleged to arise from the inaccuracy or incompleteness of any information furnished by Landlord in violation of this Section 32.3.
- (g) The provisions of this Section 32.3 shall be binding upon and applicable to the parties hereto and their respective successors and assigns. Whenever in this Section Landlord is referred to, such reference shall be deemed to include Landlord's successors or assigns, and all covenants and agreements by or on behalf of Landlord herein shall bind and apply to Landlord's successors and assigns, whether so expressed or not.

32.4 Smoking in County Facilities The Surgeon General of the United States has concluded that passive smoke exposure is the third leading cause of preventable death in the United States. The United States Environmental Protection Agency has found second-hand smoke to be a known carcinogen. It is recognized that the County has a responsibility to establish, maintain and promote a healthful and safe working environment and to reduce health and safety risks of its employees and the public at large. Tobacco smoke is a hazard to the health of County employees and the general public and represents an annoyance which should be regulated and banned in all county facilities to the end that air quality in all such facilities be improved for the preservation and improvement of the health of all County employees and the public. Therefore, to the greatest extent possible, the rights and comfort of all employees shall be respected. Reasonable effort shall be made to provide smokers a place to smoke in areas open to the sky or otherwise located outside County facilities and, except as provided under Los Angeles County, California - Code of Ordinances Chapter 2.126 ("LAMC 2.126"), all portions of County-owned facilities and all portions of facilities leased by or from the County, which areas are not open to the sky, shall be designated as "no smoking" areas. Smoking, including the use of electronic smoking devices, shall be prohibited in the following areas of County facilities: (1) Within 50 feet of any operable entry or exit door or operable window of any County building and within 25 feet of any access ramp or handicap path; (2) Within any County parking lot, parking structure, or parking garage, whether enclosed or open to the sky; or (3) Within any driving range and eating area, including outdoor eating areas, of any County golf course. International no-smoking signs and other appropriate signs which designate no-smoking areas shall be clearly, sufficiently and conspicuously posted in every room, building or other place so covered by LAMC 2.126. The manner of such posting, including the wording, size, color and place of posting, whether on the walls, doors, tables, counters, stands or elsewhere, shall be at the discretion of the building proprietor so long as clarity, sufficiency and conspicuousness are

apparent in communicating the intent. (Los Angeles County, California - Code of Ordinances Chapter 2.126.)

**33. INTENTIONALLY OMITTED**

**34. RIGHT OF FIRST OFFER TO LEASE ADDITIONAL PREMISES**

- (a) Provided that no material Default has occurred and is continuing under the Lease, if at any time prior to the last twelve (12) months of the Term, Landlord intends to offer leasable space located contiguous to the Premises (the "Additional Premises") for lease to third parties or to accept an offer of a third party to lease the Additional Premises, Landlord shall first give written notice to Tenant of the rental rate and other material terms upon which Landlord is willing to lease the Additional Premises ("Landlord's Lease Notice"). Landlord's Lease Notice shall constitute an offer to lease the Additional Premises to Tenant at the rental rate and upon the terms and conditions contained in Landlord's Lease Notice and shall state the anticipated date of availability of the Additional Premises. Tenant shall have ninety (90) business days after receipt of Landlord's Lease Notice to accept such offer. Tenant shall accept such offer, if at all, only by delivery to Landlord of Tenant's irrevocable written commitment to lease the Additional Premises at the rental rate and upon the terms and conditions contained in Landlord's Lease Notice (the "Expansion Commitment").
- (b) If Tenant delivers to Landlord the Expansion Commitment within such ninety (90) business day period, all (but not part) of the Additional Premises shall be leased to Tenant commencing on the earlier of (a) the date Tenant first uses the Additional Premises for the Permitted Use; or (b) thirty (30) days after Landlord provides Tenant with possession of the Additional Premises and continuing for a period of time coterminous with the remaining Term, including any options to extend the Term. Tenant shall lease the Additional Premises upon the same terms, conditions, and covenants as are contained in the Lease except that (i) the Base Rent for the Additional Premises shall be at the rate set forth in Landlord's Lease Notice, and (ii) any terms and conditions set forth in Landlord's Lease Notice that are inconsistent with the terms and conditions of the Lease shall control.
- (c) Except as otherwise set forth in Landlord's Lease Notice, possession of the Additional Premises shall be delivered to Tenant on an "asis" basis. Landlord shall prepare and Landlord and Tenant shall execute and deliver a written agreement modifying and supplementing the Lease and specifying that the Additional Premises are part of the Premises and, except as otherwise specified in Landlord's Lease Notice, subject to all of the terms and conditions of the Lease.
- (d) Time is of the essence with respect to the exercise by Tenant of its rights granted hereunder. In the event Tenant fails to deliver to Landlord Tenant's Expansion Commitment within the ninety (90) business day period prescribed above, all rights of Tenant to lease the Additional Premises shall terminate and Landlord shall have no further obligation to notify Tenant of any proposed leasing of the Additional Premises, and Landlord shall thereafter have the unconditional right to lease the Additional Premises to third parties or to accept offers from third parties to lease the Additional

Premises without further obligation to Tenant. The rights granted to Tenant under this Section 34 shall be personal to the original Tenant and not apply to any sales or similar transfers of the Additional Premises.



IN WITNESS WHEREOF this Lease has been executed the day and year first set forth above.

LANDLORD:

SONNENBLICK DEL RIO NORWALK LLC,  
a Delaware limited liability company

By: \_\_\_\_\_

Name: \_\_\_\_\_

Its: \_\_\_\_\_

TENANT:

COUNTY OF LOS ANGELES,  
a body corporate and politic

FESIA A. DAVENPORT  
Chief Executive Officer

By: \_\_\_\_\_

John T. Cooke

Assistant Chief Executive Officer

ATTEST:

DEAN C. LOGAN  
Registrar-Recorder/County Clerk  
of the County of Los Angeles

By: \_\_\_\_\_

Deputy

APPROVED AS TO FORM:

DAWYN R. HARRISON  
County Counsel

By:  \_\_\_\_\_

Senior Deputy

EXHIBIT A  
Floor Plan

 Premises

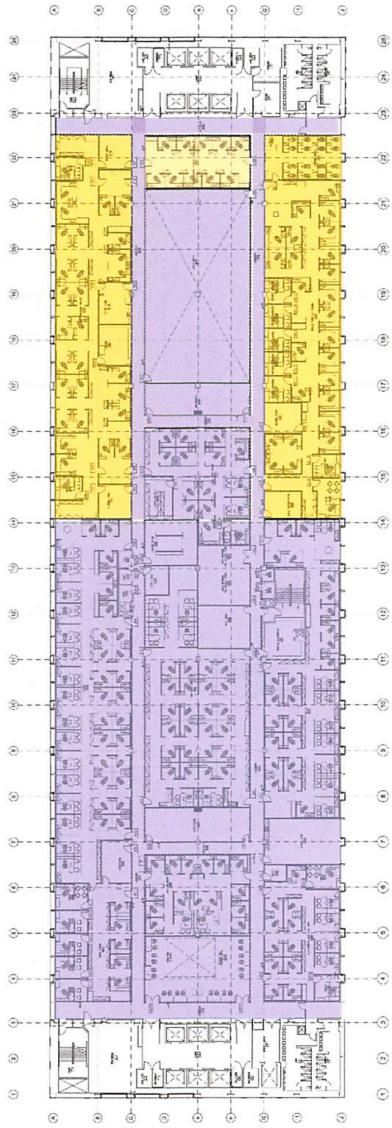

## EXHIBIT B

### COMMENCEMENT DATE MEMORANDUM AND CONFIRMATION OF LEASE TERMS

Reference is made to that certain Lease Agreement ("Lease") dated \_\_\_\_\_, 20\_\_, between County of Los Angeles, a body corporate and politic ("Tenant"), and Sonnenblick Del Rio Norwalk LLC, a Delaware limited liability company ("Landlord"), whereby Landlord leased to Tenant and Tenant leased from Landlord certain premises in the building located at 12440 Imperial Highway, Suite 500, Norwalk, CA 90650, Landlord and Tenant hereby acknowledge as follow:

- 1) Landlord delivered possession of the Premises to Tenant in a Substantially Complete condition on March , 2024 ("Possession Date");
- 2) Tenant has accepted possession of the Premises and now occupies the same;
- 3) The Lease commenced on March , 2024 ("Commencement Date");
- 4) The Premises contain 20,647 rentable square feet of space;
- 5) Base Rent per month is \$38,196.95.
- 6) Parking Rent per month is included.
- 7) Base Rent Adjustments
  - (a) Base Rent is subject to fixed three percent (3%) annual increases over the previous year's Base Rent as follows:

Months	Rate	Monthly Rent
1 - 12	\$1.85	\$38,196.95
13 - 24	\$1.91	\$39,342.86
25 - 36	\$1.96	\$40,523.14
37 - 48	\$2.02	\$41,738.84
49 - 60	\$2.08	\$42,991.00

IN WITNESS WHEREOF, this memorandum is executed this \_\_\_\_\_ day of \_\_\_\_\_, 2024.

Tenant:

Landlord:

COUNTY OF LOS ANGELES,  
a body corporate and politic

SONNENBLICK DEL RIO NORWALK LLC,  
a Delaware limited liability company

By: \_\_\_\_\_  
Name \_\_\_\_\_  
Its \_\_\_\_\_

By: \_\_\_\_\_  
Name \_\_\_\_\_  
Its \_\_\_\_\_

## **EXHIBIT C**

### **PREMISES HEATING AND VENTILATION, AND AIR CONDITIONING IN OTHER THAN DATA AND SERVER ROOMS**

Landlord shall supply cooling, ventilating, and Premises heating with capacity to produce the following results effective during Tenant's Hours of Operation established by the Lease and within tolerances normal in comparable office buildings; maintenance of inside space conditions of not greater than 78 degrees Fahrenheit when the outside air temperature is not more than 93 degrees Fahrenheit dry bulb and 70 degrees Fahrenheit wet bulb and not less than 70 degrees Fahrenheit when the outside air temperature is not lower than 42 degrees Fahrenheit dry bulb. Interior space is designated at a rate of one zone for approximately each 1,000 square feet (+/- 200-sq.ft. to allow for marginal situations) and one diffuser for each 200 square feet (+/- 50-sq.ft. to allow for marginal situations) of usable/net square footage within the Premises (distribution within the Premises shall be considered a Tenant Improvement and be paid for from funds available for Tenant Improvements). If energy requirements prohibit Landlord from complying with these requirements, Tenant shall not unreasonably withhold its consent to temporary waivers or modifications.

## **EXHIBIT D**

### **CLEANING AND MAINTENANCE SCHEDULE**

#### **A. DAILY (Monday through Friday)**

1. Carpets vacuumed.
2. Composition floors dust-mopped.
3. Desks, desk accessories and office furniture dusted. Papers and folders left on desk not to be moved.
4. Waste baskets, other trash receptacles emptied.
5. Chairs and waste baskets returned to proper position.
6. Fingerprints removed from glass doors and partitions.
7. Drinking fountains cleaned, sanitized and polished.
8. Lavatories, toilets and toilet rooms cleaned and mopped. Toilet supplies replenished.
9. Bulb and tube replacements, as required.
10. Emergency exit signage and egress battery replacement (if applicable)
11. Graffiti expunged as needed within two working days after notice by Tenant
12. Floors washed as needed.
13. Standard kitchen/lunchroom/restroom supplies replenished, including, but, not limited to, paper supplies and soap, if applicable.

#### **B. WEEKLY**

14. Low-reach areas, chair rungs, baseboards and insides of door jambs dusted.
15. Window sills, ledges and wood paneling and molding dusted.

#### **C. MONTHLY**

16. Floors washed and waxed in uncarpeted office area.
17. High-reach areas, door frames and tops of partitions dusted.
18. Picture moldings and frames dusted.
19. Carpet professionally spot cleaned as required to remove stains.

20. VAC chiller water checked for bacteria, water conditioned as necessary, if applicable.

D. QUARTERLY

21. Light fixtures cleaned and dusted.
22. Wood furniture polished.
23. Draperies or mini-blinds cleaned as required, but not less frequently than quarterly.
24. Upholstered furniture vacuumed, plastic and leather furniture wiped.
25. Wall vents and ceiling vents vacuumed.

E. SEMI-ANNUALLY

26. Exterior windows washed as required inside and outside but not less frequently than twice annually.
27. All painted wall and door surfaces washed and stains removed.
28. All walls treated with vinyl covering washed and stains removed.

F. ANNUALLY

29. Carpets cleaned and spot cleaned as needed. Landlord shall not use bonnet cleaning on carpets.
30. Furniture Systems and any other fabric or upholstered surfaces including chairs, couches, walls, etc., spot cleaned, or if determined to be necessary in Tenant's sole discretion, professionally cleaned in their entirety using a water extraction system.
31. Bathroom and any other ceramic tile surfaces professionally cleaned. All grout and porous surfaces resealed with a professional grade sealant, as needed.
32. Touch-up paint interior painted surfaces in a color and finish to match existing, as needed.
33. Server Room VAC units serviced for preventative maintenance purposes and other service as required and filters as needed, if applicable
34. Interior windows washed as required inside and outside

G. AS NEEDED

35. The sidewalks, driveways, parking areas and all means of access and egress for the Premises should be maintained in good repair, and in clean and safe condition at all times.

36. All lawns, shrubbery and foliage on the grounds of the Premises should be maintained in good condition and neat in appearance. Grass and shrubbery must be replanted as needed to maintain the grounds in good appearance and condition.
37. Interior and exterior pest control inspections and remediation, as needed.
38. All VAC ducts cleaned as needed.

H. GENERAL

39. Landlord shall, upon request of Tenant, produce written service contracts or services orders, as appropriate, as evidence of compliance with the terms of this Cleaning and Maintenance Schedule

**EXHIBIT E**

**SUBORDINATION, NON-DISTURBANCE  
AND ATTORNMENT AGREEMENT**

**RECORDING REQUESTED BY  
AND WHEN RECORDED MAIL TO:**

County of Los Angeles  
Chief Executive Office  
Real Estate Division  
320 W. Temple Street  
7th Floor  
Los Angeles, California 90012

)  
)  
)  
)  
)  
)  
)

Space above for Recorder's Use

---

**SUBORDINATION, NON-DISTURBANCE  
AND ATTORNMENT AGREEMENT**

**NOTICE: THIS SUBORDINATION, NON-DISTURBANCE AND ATTORNMENT AGREEMENT RESULTS IN YOUR LEASEHOLD ESTATE BECOMING SUBJECT TO AND OF LOWER PRIORITY THAN THE LIEN OF SOME OTHER OR LATER SECURITY INSTRUMENT.**

This Subordination, Non-disturbance and Attornment Agreement ("Agreement") is entered into as of the \_\_\_\_ day of \_\_\_\_\_, 20\_\_ by and among COUNTY OF LOS ANGELES, a body corporate and politic ("Tenant"), [*Insert name of Landlord*], ("Borrower") and [*Insert name of Lender*], ("Lender").

Factual Background

A. Borrower owns certain real property more particularly described in the attached Exhibit A. The term "Property" herein means that real property together with all improvements (the "Improvements") located on it.

B. Lender has made or agreed to make a loan to Borrower. The Loan is or will be secured by a deed of trust or mortgage encumbering the Property (the "Deed of Trust").

C. Tenant and Borrower (as "Landlord") entered into a lease dated \_\_\_\_\_ (the "Lease") under which Borrower leased to Tenant a portion of the Improvements located within the Property and more particularly described in the Lease (the "Premises").

D. Tenant is willing to agree to subordinate certain of Tenant's rights under the Lease to the lien of the Deed of Trust and to attorn to Lender on the terms and conditions of this Agreement. Tenant is willing to agree to such subordination and attornment and other conditions, provided that Lender agrees to a non-disturbance provision, all as set forth more fully below.

Agreement

Therefore, the parties agree as follows:

HOA.104512500.1

Exhibit E  
SUBORDINATION, NON-DISTURBANCE  
AND ATTORNMENT AGREEMENT



1. Subordination. The lien of the Deed of Trust and all amendments, modifications and extensions thereto shall be and remain at all times a lien on the Property prior and superior to the Lease, except that if Tenant is granted any option to extend the Term of the Lease, right of first offer to lease additional premises or option to purchase the Property or right of first offer to purchase the Property in the Lease, such provisions shall not be affected or diminished by any such subordination.

2. Definitions of "Transfer of the Property" and "Purchaser". As used herein, the term "Transfer of the Property" means any transfer of Borrower's interest in the Property by foreclosure, trustee's sale or other action or proceeding for the enforcement of the Deed of Trust or by deed in lieu thereof. The term "Purchaser", as used herein, means any transferee, including Lender, of the interest of Borrower as a result of any such Transfer of the Property and also includes any and all successors and assigns, including Lender, of such transferee.

3. Non-disturbance. The enforcement of the Deed of Trust shall not terminate the Lease or disturb Tenant in the possession and use of the leasehold estate created thereby.

4. Attornment. Subject to Section 3 above, if any Transfer of the Property should occur, Tenant shall and hereby does attorn to Purchaser, including Lender if it should be the Purchaser, as the landlord under the Lease, and Tenant shall be bound to Purchaser under all of the terms, covenants and conditions of the Lease for the balance of the Lease term and any extensions or renewals of it which may then or later be in effect under any validly exercised extension or renewal option contained in the Lease, all with the same force and effect as if Purchaser had been the original landlord under the Lease. This attornment shall be effective and self-operative without the execution of any further instruments upon Purchaser's succeeding to the interest of the landlord under the Lease.

5. Lender Not Obligated. Lender, if it becomes the Purchaser or if it takes possession under the Deed of Trust, and any other Purchaser shall not:

(a) be liable for any damages or other relief attributable to any act or omission of any prior Landlord under the Lease, including Borrower, unless such act or omission continues after the date that Lender or Purchaser succeeds to the interest of such prior landlord; or

(b) be subject to any offset or defense not specifically provided for in the Lease which Tenant may have against any prior landlord under the Lease, unless resulting from a default or breach by such prior landlord which continues after Lender or Purchaser succeeds to the interest of such prior landlord; and provided that any offsets deducted by Tenant prior to the date that Lender or Purchaser succeeds to the interest of such prior landlord shall not be subject to challenge; or

(c) be bound by any prepayment by Tenant of more than one (1) month's installment of rent, unless the Lease expressly requires such prepayment; or

(d) be obligated for any security deposit not actually delivered to Purchaser; or

(e) be bound by any modification or amendment of or to the Lease which materially increases Landlord's obligations under the Lease or materially decreases Tenant's

obligation under the Lease, unless Lender has approved such modification or amendment in writing, which approval shall not be unreasonably withheld, conditioned or delayed.

6. Notices. All notices given under this Agreement shall be in writing and shall be given by personal delivery, overnight receipted courier or by registered or certified United States mail, postage prepaid, sent to the party at its address appearing below. Notices shall be effective upon receipt (or on the date when proper delivery is refused). Addresses for notices may be changed by any party by notice to all other parties in accordance with this Section.

To Lender: \_\_\_\_\_  
\_\_\_\_\_  
\_\_\_\_\_  
\_\_\_\_\_

To Borrower: \_\_\_\_\_  
\_\_\_\_\_  
\_\_\_\_\_  
\_\_\_\_\_

To Tenant: County of Los Angeles  
Chief Executive Office  
Real Estate Division  
320 W. Temple Street, 7th Floor  
Los Angeles, California 90012  
Attention: Director of Real Estate

7. Miscellaneous Provisions. This Agreement shall inure to the benefit of and be binding upon the parties and their respective successors and assigns. This Agreement is governed by the laws of the State of California without regard to the choice of law rules of that State.

TENANT: COUNTY OF LOS ANGELES,  
a body corporate and politic

By: \_\_\_\_\_  
Name: \_\_\_\_\_  
Title: \_\_\_\_\_

BORROWER: *[Insert name of Landlord]*

By: \_\_\_\_\_  
Name: \_\_\_\_\_  
Title: \_\_\_\_\_

LENDER: *[Insert name of Lender],*

By: \_\_\_\_\_  
Name: \_\_\_\_\_  
Title: \_\_\_\_\_

A notary public or other officer completing this certificate verifies only the identity of the individual who signed the document to which this certificate is attached, and not the truthfulness, accuracy, or validity of that document.

STATE OF CALIFORNIA )  
 ) SS.  
COUNTY OF \_\_\_\_\_ )

On \_\_\_\_\_, before me, \_\_\_\_\_  
Date Name And Title Of Officer (e.g. "Jane Doe, Notary Public")

personally appeared \_\_\_\_\_,  
Name of Signer(s)

who proved to me on the basis of satisfactory evidence to be the person(s) whose name(s) is/are subscribed to the within instrument and acknowledged to me that he/she/they executed the same in his/her/their authorized capacity(ies), and that by his/her/their signature(s) on the instrument the person(s), or the entity upon behalf of which the person(s) acted, executed the instrument.

I certify under PENALTY OF PERJURY under the laws of the State of California that the foregoing paragraph is true and correct.

WITNESS my hand and official seal.

\_\_\_\_\_  
Signature (Seal)

## EXHIBIT F

### TENANT ESTOPPEL CERTIFICATE

To: [Insert name of party to rely on document]

\_\_\_\_\_  
\_\_\_\_\_  
\_\_\_\_\_  
Attn: \_\_\_\_\_

Re:    Date of Certificate: \_\_\_\_\_  
      Lease Dated: \_\_\_\_\_  
      Current Landlord: \_\_\_\_\_  
      Located at: \_\_\_\_\_  
      Premises: \_\_\_\_\_  
      Commencement Date of Term: \_\_\_\_\_  
      Expiration Date: \_\_\_\_\_  
      Current Rent: \_\_\_\_\_

County of Los Angeles ("Tenant") hereby certifies that, to its actual knowledge, as of the date hereof:

1.     Tenant is the present holder of the tenant's interest under the lease described above, as it may be amended to date (the "Lease"). The Lease covers the premises described above (the "Premises") in the building (the "Building") at the address set forth above.

2.     (a)    A true, correct and complete copy of the Lease (including all modifications, amendments, supplements, side letters, addenda and riders of and to it) is attached to this Certificate as Exhibit A.

      (b)    The current Rent is set forth above.

      (c)    The term of the Lease commenced on the Commencement Date set forth above and will expire on the Expiration Date set forth above, including any presently exercised option or renewal term. Tenant has no option or right to renew, extend or cancel the Lease, or to lease additional space in the Premises or Building, or to use any parking other than that specified in the Lease.

      (d)    Except as specified in the Lease, Tenant has no option or preferential right to purchase all or any part of the Premises (or the land of which the Premises are a part).

      (e)    Tenant has made no agreement with Landlord or any agent, representative or employee of Landlord concerning free rent, partial rent, rebate of rental payments or any other similar rent concession except as expressly set forth in the Lease.

3.     (a)    The Lease constitutes the entire agreement between Tenant and Landlord with respect to the Premises, has not been modified changed, altered or amended, except as set forth in Exhibit A, and is in full force and effect. There are no other agreements, written or oral, which affect Tenant's occupancy of the Premises.

[(b) To the knowledge of Tenant, Tenant has not given Landlord written notice of a material default under the Lease which has not been cured.]

(c) Tenant's interest in the Lease has not been assigned or encumbered.

(d) Tenant is not entitled to any credit against any rent or other charge or rent concession under the Lease, except as set forth in the Lease.

(e) No rental payments have been made more than one (1) month in advance.

4. All contributions required to be paid by Landlord to date for improvements to the Premises have been paid in full, and all of Landlord's obligations with respect to tenant improvements have been fully performed, except: \_\_\_\_\_.

IN WITNESS WHEREOF, the Tenant has executed this Tenant Estoppel Certificate as of the day set forth above.

COUNTY OF LOS ANGELES,  
a body corporate and politic

By: \_\_\_\_\_  
Name: \_\_\_\_\_  
Title: \_\_\_\_\_

# EXHIBIT G

## COMMUNITY BUSINESS ENTERPRISE FORM

INSTRUCTIONS: All Landlords shall submit this form on an annual basis on or before December 30th of each year of the term of this agreement as evidence of MBE/WBE participation. The information requested below is for statistical purposes only. The final analysis and consideration of the lease will be determined without regard to race, creed, color or gender. *(Categories listed below are based on those described in 49 CFR Section 23.5)*

### I. Minority/Women Participation in Firm (Partners, Associate Partners, Managers, Staff, etc.)

1. Firm Name:			3. Contact Person/Telephone Number:			
2. Address:						
4. Total number of employees in the firm:						
Provide the number of all minority employees and	Owners, Partners and Associate Partners		Managers		Staff	
	All O.P & AP	Women	All Managers	Women	All Staff	Women
Black/African American						
Hispanic/Latin American						
Asian American						
Portuguese American						
American Indian/Alaskan						
All Others						

### II. PERCENTAGE OF MINORITY/WOMEN OWNERSHIP IN FIRM

1. Type of Business Structure: (Corporation, Partnership, Sole Proprietorship, Etc.) _____		
2. Total Number of Ownership/Partners, Etc.:		<b>MINORITY/WOMEN-OWNED FIRM CERTIFICATION</b>
3. Provide the percentage of	All Empl	Women
Black/African		
Hispanic/Latin		
Asian American		
Portuguese American		
American		

Is your firm currently certified as a minority owned business firm by the: State of California? ☐ Yes ☐ No

City of Los Angeles? ☐ Yes ☐ No

**Section D. OPTION TO PROVIDE REQUESTED INFORMATION**

☐ We do not wish to provide the information required in this form.

All Others			Firm Name: _____
			Signature/Title: _____



## EXHIBIT H

### MEMORANDUM OF LEASE

#### RECORDING REQUESTED BY AND WHEN RECORDED MAIL TO:

County of Los Angeles  
Chief Executive Office  
Real Estate Division  
320 W. Temple Street, 7th Floor  
Los Angeles, California 90012  
Attention: Director of Real Estate

This document is recorded for the benefit of the County of Los Angeles and recording is exempt from recording fees pursuant to California Government Code Section 27383. This transaction is exempt from documentary transfer tax pursuant to California Revenue and Taxation Code Section 11922.

---

### MEMORANDUM OF LEASE

This Memorandum of Lease ("Memorandum") is made and entered into by and between \_\_\_\_\_, a \_\_\_\_\_ (the "Landlord"), and the COUNTY OF LOS ANGELES, a public body corporate and politic, duly organized and existing under the laws of the State of California (the "Tenant"), who agree as follows:

Landlord and Tenant have entered into an unrecorded lease dated \_\_\_\_\_, 20\_\_ (the "Lease") of certain real property located in the County of Los Angeles, State of California, described in Exhibit A attached hereto and incorporated herein by reference, for a term commencing on \_\_\_\_\_, 20\_\_, and ending on a date \_\_\_\_\_ years after the commencement date, unless such term is extended or sooner terminated pursuant to the terms and conditions set forth in the Lease.

This Memorandum has been prepared for the purpose of giving notice of the Lease and of its terms, covenants, and conditions, and for no other purposes. The provisions of this Memorandum shall not in any way change or affect the provisions of the Lease, the terms of which remain in full force and effect.

Dated: \_\_\_\_\_, 20\_\_.

LANDLORD: \_\_\_\_\_

By: \_\_\_\_\_

Its: \_\_\_\_\_

By: \_\_\_\_\_

Its: \_\_\_\_\_

TENANT:

COUNTY OF LOS ANGELES,  
a body corporate and politic

FESIA A. DAVENPORT  
Chief Executive Officer

By: \_\_\_\_\_

John T. Cooke  
Assistant Chief Executive Officer

ATTEST:

DEAN C. LOGAN  
Recorder/County Clerk  
of the County of Los Angeles

By: \_\_\_\_\_  
Deputy

APPROVED AS TO FORM:

DAWYN R. HARRISON  
County Counsel

By: \_\_\_\_\_  
Senior Deputy

A notary public or other officer completing this certificate verifies only the identity of the individual who signed the document to which this certificate is attached, and not the truthfulness, accuracy, or validity of that document.

STATE OF CALIFORNIA )  
 ) SS.  
COUNTY OF \_\_\_\_\_ )

On \_\_\_\_\_, before me,

\_\_\_\_\_ Date Name And Title Of Officer (e.g. "Jane Doe, Notary Public")  
personally appeared \_\_\_\_\_,  
Name of Signer(s)

who proved to me on the basis of satisfactory evidence to be the person(s) whose name(s) is/are subscribed to the within instrument and acknowledged to me that he/she/they executed the same in his/her/their authorized capacity(ies), and that by his/her/their signature(s) on the instrument the person(s), or the entity upon behalf of which the person(s) acted, executed the instrument.

I certify under PENALTY OF PERJURY under the laws of the State of California that the foregoing paragraph is true and correct.

WITNESS my hand and official seal.

\_\_\_\_\_  
Signature (Seal)