

**BOARD OF
SUPERVISORS**

Hilda L. Solis
First District

Holly J. Mitchell
Second District

Lindsey P. Horvath
Third District

Janice Hahn
Fourth District

Kathryn Barger
Fifth District



**Chief
Executive
Office.**

COUNTY OF LOS ANGELES

Kenneth Hahn Hall of Administration
500 West Temple Street, Room 713, Los Angeles, CA 90012
(213) 974-1101
ceo.lacounty.gov

Chief Executive Officer
Fesia A. Davenport

"To Enrich Lives Through Effective and Caring Service"

February 27, 2024

The Honorable Board of Supervisors
County of Los Angeles
383 Kenneth Hahn Hall of Administration
500 West Temple Street
Los Angeles, California 90012

Dear Supervisors:

ADOPTED

BOARD OF SUPERVISORS
COUNTY OF LOS ANGELES

32 February 27, 2024

JEFF LEVINSON
INTERIM EXECUTIVE OFFICER

**NINE YEAR LEASE
PROBATION DEPARTMENT
4710 SOUTH EASTERN AVENUE, BELL
(FOURTH DISTRICT) (3 VOTES)**

SUBJECT

Approval of a proposed new nine-year lease for 20,116 square feet of warehouse/office space, and 43 on-site parking spaces for the Probation Department (Probation), Facilities Operations.

IT IS RECOMMENDED THAT THE BOARD:

1. Find that the proposed lease is exempt from the California Environmental Quality Act (CEQA) for the reasons stated in this Board letter and in the record of the project.
2. Authorize the Chief Executive Officer, or her designee, to execute the proposed lease with NINOS I L.P., a California limited partnership (Landlord), for approximately 20,116 square feet of warehouse space including an office component and 43 on-site parking spaces located at 4710 South Eastern Avenue, Bell (Premises) to be occupied by Probation. The estimated maximum first year base rental cost is \$459,000. The estimated total proposed lease cost is \$5,192,000 over the nine-year term and does not include the costs for utilities and janitorial for which Probation will be responsible. The rental costs will be funded 100 percent by net County cost (NCC) that is already included in Probation's existing budget. Probation will not be requesting additional NCC for this action.

3. Authorize the Probation Officer, or his designee, to contract with and direct the Internal Services Department (ISD), in coordination with the Chief Executive Officer, or her designee, for the acquisition and installation of telephone, data, and low-voltage systems and vendor installation (Low-Voltage Items) at a total cost not to exceed \$284,000 paid in a lump sum. The cost for the Low-Voltage Items is in addition to the rental costs and County's Tenant Improvement (TI) contribution payable to a County-approved third-party vendor.
4. Authorize the Probation Officer, or his designee, to contract with a County-approved registered third-party vendor, in coordination with the Chief Executive Officer, or her designee, for the County's TI work for electrical work and installation of a Master Control Room which is required for the Low-Voltage Items to be implemented by ISD. The total cost shall not exceed \$54,000 paid in a lump sum.
5. Authorize and direct the Chief Executive Officer, or her designee, to execute any other ancillary documentation necessary to effectuate the terms of the proposed lease, and to take actions necessary and appropriate to implement the proposed lease, including, without limitation, exercising early termination rights.

PURPOSE/JUSTIFICATION OF RECOMMENDED ACTION

Probation's Facilities Operations has been located at a stand-alone facility within a residential area located at 4549 East Telegraph Road, Commerce (Commerce Facility), since 1981. There are 24 employees who work at this facility. The existing lease expires on October 28, 2027, and provides the County with the right to terminate the existing lease early at any time. This existing lease will be terminated once Probation begins operations at the proposed Premises.

Facilities Operations is an administrative function responsible for distributing supplies to juvenile halls and camps, including the Department of Justice's mandated critical supply stock, furniture, and equipment to over 123 Probation facilities Countywide. These supplies are stocked every day to address the daily needs of the minors under Probation's care. The Commerce Facility does not receive any probationers or minors; however, they do receive eight to twelve vendors throughout the day, which visits may last up to one hour each.

Since 2019, Probation has identified and toured approximately 20 prospective sites within a 10-mile radius of its existing location. Probation needs to remain in close proximity to its headquarters in Downey. Probation has pursued and lost several prospective sites over the last four years due to the limited supply of industrial space within the search area and the velocity of the industrial market which has a strong demand. Probation was interested in four different sites, but the prospective landlords for each site required an "as-is" delivery and firm immediate start dates. The proposed Premises was selected because of the location, access to a loading dock, and most importantly, adequate secured warehouse space, which allows Probation to consolidate the storage of equipment and supplies from multiple sites.

The new location will house 16 employees, primarily warehouse employees and drivers, while the remaining eight administrative employees will be relocated to Probation's headquarters in Downey. Probation's warehouse employees and drivers are unable to telework due to the nature of the program, however, the eight employees that are moving to headquarters will telework three days per week.

Parking is provided in the Commerce Facility parking lot. The proposed Premises is in proximity to local public transportation routes.

Implementation of Strategic Plan Goals

The Countywide Strategic Plan Goal 3 – “Realize Tomorrow’s Government Today” – provides that our increasingly dynamic, and complex environment, challenges our collective abilities to respond to public needs and expectations. We want to be an innovative, flexible, effective, and transparent partner focused on advancing the common good.

The proposed lease is also consistent with Strategic Asset Management Goal – prioritize needs to optimize highest and best use of assets, and Key Objective No. 4 – Guide Strategic Decision-Making.

The proposed lease supports the above goals and objective by relocating the warehouse functions for the Facilities Operations Section into one facility to improve the delivery of services to Probation’s other facilities throughout the County.

The proposed lease conforms with the Asset Management Principles outlined in Enclosure A.

FISCAL IMPACT/FINANCING

The estimated maximum first year base rental cost is \$459,000, which includes parking at no additional cost. The aggregate cost associated with the proposed lease over the entire nine-year term is \$5,192,000 as shown in Enclosure B. Probation is also responsible for utilities and janitorial costs. The proposed lease costs will be fully funded by NCC that is already included in Probation’s existing budget. Probation will not be requesting additional NCC for this action.

Sufficient funding to cover the proposed rent for the first year of the proposed lease term is included in the Fiscal Year 2023-24 Rent Expense budget and will be billed back to Probation. Probation has sufficient funding in its Fiscal Year 2023-24 Operating Budget to cover the proposed rent and Low-Voltage Items for the first year. Future funding for the costs associated with the proposed lease will be addressed through the annual budget process for Probation.

FACTS AND PROVISIONS/LEGAL REQUIREMENTS

In addition to the terms previously stated, the proposed lease also includes the following provisions:

- The annual rental rate will be \$1.90 per square foot, per year and is subject to annual increases based on the Consumer Price Index adjustments with a 2 percent minimum and a 4 percent maximum per annum.
- The County will be taking the space “as-is” and will have no base TI allowance.
- The County, in collaboration with the Landlord, will be completing minimal electrical work and the installation of a master control room needed for ISD to proceed with the low-voltage implementation. The County’s contribution for this work will not exceed \$54,000 to be paid in lump sum.
- The County will pay \$284,000 for the lump sum cost of the Low-Voltage Items.

- The Landlord is responsible for the operating and maintenance cost, and real estate taxes of the building, and the County is responsible for utilities and janitorial costs. The County is not subject to the building's operating expense increases.
- A nine-year initial term with no option to extend the proposed lease.
- The County has the right to terminate the proposed lease any time after the 84th month, with 120 days' notice.
- Holdover at the proposed lease expiration is permitted on the same lease terms and conditions except the monthly base rent during the holdover period will be subject to the regular annual Consumer Price Index adjustments.
- The proposed lease will be effective upon approval by the Board and full execution of the proposed lease, but the term and rent will commence on the first day of the month following Board approval and full execution of the proposed lease by both parties.

The Chief Executive Office (CEO) issued a flyer soliciting proposals for available space from landlords, brokers, and other owner representatives, for this space need, through the Board's Executive Office website and Real Estate's County website. There was only one response received which was not suitable for Probation's needs because it was an office space. The CEO conducted a market search of available warehouse/office space for lease to locate the proposed Premises. Based upon a review of available industry data, it has been established that the annual rental range for a comparable lease in the area is between \$20.40 and \$31.20 per square foot, per year. The base annual rental rate of \$22.80 per square foot, per year for the proposed lease represents a rate that is on the lower end of the market range for the area. We were unable to identify any sites that could accommodate this requirement more economically. We recommend the proposed Premises as the most suitable to meet the County's space requirements.

Co-working office space is not conducive to the Probation programmatic needs for warehouse use, which will be used to store equipment, furniture, and supplies.

Enclosure C shows all County-owned and leased facilities within the surveyed areas and there are no County-owned or leased facilities available for this space requirement.

The Department of Public Works has inspected the facility and found it suitable for County occupancy. Construction of the TIs will be completed in compliance with relevant building and construction laws and regulations, including the Americans with Disabilities Act. The required notification letter to the City of Bell has been sent in accordance with Government Code Section 25351.

County Counsel has reviewed the proposed lease and has approved it as to form. The proposed lease is authorized by Government Code Section 25351, which allows the County to enter into leases and agreements for the leasing of buildings, as necessary, to carry out the work of the county government.

The proposed lease will provide a suitable location for Probation's Facilities Operations, which is consistent with the County's Facility Location Policy, adopted by the Board of Supervisors on July 24, 2012, as outlined in Enclosure D.

ENVIRONMENTAL DOCUMENTATION

This project is exempt from CEQA, as specified in Class 1 of the Environmental Document Reporting Procedures and Guidelines adopted by the Board, and section 15301 of the State CEQA Guidelines (Existing Facilities). The proposed lease, which involves the leasing of existing warehouse/office space with minor tenant improvements within an existing building, with no expansion of the existing building, is within a class of projects that have been determined not to have a significant effect on the environment and meets the criteria set forth in section 15301 of the State CEQA Guidelines (Guidelines), and Class 1 of the County's Environmental Document Reporting Procedures and Guidelines, Appendix G. In addition, based on the proposed project records, it will comply with all applicable regulations, and there are no cumulative impacts, unusual circumstances, damage to scenic highways, listing on hazardous waste site lists compiled, pursuant to Government Code Section 65962.5, or indications that it may cause a substantial adverse change in the significance of a historical resource that would make the exemption inapplicable.

Upon the Board's approval of the recommended actions, a Notice of Exemption will be filed with the Registrar-Recorder/County Clerk in accordance with section 21152 of the California Public Resources Code.

IMPACT ON CURRENT SERVICES (OR PROJECTS)

The proposed lease will adequately provide the necessary warehouse, office space, and parking spaces for this County requirement. Probation concurs with the proposed lease and recommendations.

Respectfully submitted,



FESIA A. DAVENPORT

Chief Executive Officer

FAD:JMN:JTC

JLC:HD:ANR:EG:gb

Enclosures

c: Executive Office, Board of Supervisors
County Counsel
Auditor-Controller
Probation

**PROBATION DEPARTMENT
4710 SOUTH EASTERN AVENUE, BELL**

Asset Management Principles Compliance Form¹

1.	<u>Occupancy</u>	Yes	No	N/A
A	Does lease consolidate administrative functions?			X
B	Does lease co-locate with other functions to better serve clients?			X
C	Does this lease centralize business support functions?	X		
D	Does this lease meet the guideline of 200 sq. ft of space per person? ² This is not office space and will be used as ancillary/ storage/warehouse space			X
E	Does lease meet the 4/1000 sq. ft. parking ratio guideline? ² Approximately 2.15/1,000 because it will be used as ancillary/ storage/warehouse space		X	
F	Does public parking and mass-transit exist to facilitate employee, client and visitor access to the proposed lease location?	X		
2.	<u>Capital</u>			
A	Is it a substantial net County cost (NCC) program?	X		
B	Is this a long-term County program?	X		
C	If yes to 2 A or B; is it a capital lease or an operating lease with an option to buy?		X	
D	If no, are there any suitable County-owned facilities available?		X	
E	If yes, why is lease being recommended over occupancy in County-owned space?			X
F	Is Building Description Report enclosed as Enclosure C?	X		
G	Was build-to-suit or capital project considered?			X
3.	<u>Portfolio Management</u>			
A	Did department utilize CEO Space Request Evaluation (SRE)?	X		
B	Was the space need justified?	X		
C	If a renewal lease, was co-location with other County departments considered?			X
D	Why was this program not co-located?			
	1. ____ The program clientele requires a "stand alone" facility.			
	2. ____ No suitable County occupied properties in project area.			
	3. <u>X</u> No County-owned facilities available for the project.			
	4. ____ Could not get City clearance or approval.			
	5. ____ The Program is being co-located.			
E	Is lease a full-service lease? ² County is responsible for the cost of its electric, gas, water, and janitorial usage.		X	
F	Has growth projection been considered in space request?	X		
G	¹ Has the Dept. of Public Works completed seismic review/approval?	X		
¹ As approved by the Board of Supervisors 11/17/98				
² If not, why not?				

OVERVIEW OF THE PROPOSED BUDGETED LEASE COSTS										
4710 S. Eastern Avenue, Bell										
Probation Department										
Basic Lease Assumptions										
Leased Area (sq.ft.)	20,116									
	Monthly	Annual								
Rent (per sq. ft.) ⁽¹⁾	\$1.90	\$22.80								
Rent Amount (\$)	38,220.40									
Term (Month/Years)	108 mos/9 yrs.									
Annual Rent Adjustment	4%									
	Lump Sum									
Low Voltage ⁽²⁾	\$297,695									
	1 st Year	2 nd Year	3 rd Year	4 th Year	5 th Year	6 th Year	7 th Year	8 th Year	9 th Year	Total 9 Year Rental Costs
Annual Base Rent Costs ⁽¹⁾	\$458,645	\$476,991	\$496,070	\$515,913	\$536,550	\$558,012	\$580,332	\$603,545	\$627,687	\$4,854,000
Total Cost Paid to Landlord	\$458,645	\$476,991	\$496,070	\$515,913	\$536,550	\$558,012	\$580,332	\$603,545	\$627,687	\$4,854,000
Low Voltage Costs	\$284,000	\$0	\$0	\$0	\$0	\$0	\$0	\$0	\$0	\$284,000
Tenant Improvement Costs ⁽²⁾	\$53,900	\$0	\$0	\$0	\$0	\$0	\$0	\$0	\$0	\$54,000
Total Annual Lease Costs ⁽³⁾	\$796,545	\$476,991	\$496,070	\$515,913	\$536,550	\$558,012	\$580,332	\$603,545	\$627,687	\$5,192,000
Footnotes										
⁽¹⁾ The Base Rent is subject to annual Consumer Price Index adjustments capped at four percent (4%) increases per annum.										
⁽²⁾ Costs associated to required electrical and minor miscellaneous work required for the low voltage implementation work.										
⁽³⁾ County is also responsible for utility and janitorial costs. This is a new lease acquisition and estimates are unavailable.										
*Calculation note: All numbers are rounded up to ensure sufficient funds available to pay the specified expense.										

**PROBATION DEPARTMENT
SPACE SEARCH – CITY OF VERNON, SANTA FE SPRINGS, AND COMMERCE**

Property ID	Name	Address	Ownership	Gross SqFt	Vacant
A069	DA – Auto Insurance Fraud Office	5900 S. Eastern Ave Commerce 90040	Leased	11,720	NONE
A133	Child Support Services – Division II Headquarters	5770 S. Eastern Ave Commerce 90040	Leased	84,477	NONE
A146	Fire – Hazardous Materials Division Headquarters	5825 Rickenbacker Rd Commerce 90040	Leased	16,670	NONE
A332	Child Support Services – Training/IT Division	5500 S. Eastern Ave Commerce 90040	Leased	39,991	NONE
A427	Fire – Mapping & Engineering Section Offices	5828 Rickenbacker Rd Commerce 90040	Leased	7,177	NONE
A446	Fire – Information Management Division Offices	5815 Rickenbacker Rd Commerce 90040	Leased	3,722	NONE
A460	DHS – Ferguson Administrative Services Center	5555 Ferguson Dr Commerce 90022	Owned	268,400	NONE
A463	Human Resources – Commerce Office	1436 S. Goodrich Blvd Commerce 90022	Leased	26,200	NONE
A570	Health Services / Administrative	5701 S. Eastern Ave Commerce 90040	Leased	40,539	NONE
A580	Fire – Administrative Headquarters Office Annex	5801 S. Eastern Ave Commerce 90040	Leased	31,355	NONE
A823	Fire – Fire Prevention Division / Forestry Division Headquarters	5823 Rickenbacker Rd Commerce 90040	Leased	17,710	NONE
B460	DPSS – Gain Program Region VI Office	5460 Bandini Blvd Bell 90201	Leased	31,400	NONE
Y640	DPSS – Cudahy A/P District Office	8130 S. Atlantic Ave Cudahy 90201	Owned	30,873	NONE
4465	DF Kirby Center – Administration Building	1500 S McDonnell Ave Commerce 90022	Owned	18,170	NONE
10260	DCSS – Customer Contact Center	5801 E. Slauson Ave Commerce 90040	Leased	26,360	NONE
A176	Health Services - EMS	10100 Pioneer Blvd Santa Fe Springs 90670	Leased	41,720	NONE
D812	PW - Inc City Office (Santa Fe Springs)	11710 Telegraph Rd Santa Fe Springs 90670	Gratis Use	221,285	NONE

FACILITY LOCATION POLICY ANALYSIS

Proposed lease: Nine-year lease agreement for the Probation Department – 4710 South Eastern Avenue, Bell – Fourth District.

A. Establish Service Function Category – Facilities Operations is an administrative function that is in charge of distributing supplies, furniture, and equipment to the juvenile halls and camps and over 123 Probation facilities Countywide.

B. Determination of the Service Area – This program provides services to all Probation locations throughout Los Angeles County and the subject property is ideally located for their operations. Facilities Operations will be leaving their existing leased facility to move into a secured warehouse space in an industrial area with sufficient storage and access to a loading dock.

C. Apply Location Selection Criteria to Service Area Data

- Need for proximity to service area and population: This facility is centrally located within the County.
- Need for proximity to existing County facilities: Close to several other County departments including the Departments of Public Social Services, and Public Health.
- Need for proximity to Los Angeles Civic Center: N/A
- Economic Development Potential: N/A
- Proximity to public transportation: The location is adequately served by local transit services, i.e., 2-minute walk to the nearest bus station and 5-minute drive to the Metrolink – Commerce Station.
- Availability of affordable housing for County employees: The surrounding area provides for affordable housing and rental opportunities.
- Use of historic buildings: N/A
- Availability and compatibility of existing buildings: There is no space available in existing County-owned buildings to meet the departments service needs.
- Compatibility with local land use plans: The City of Bell has been notified of the proposed County use which is consistent with its use and zoning for warehouse and office space at this location.

- Estimated acquisition/construction and ongoing operational costs: The aggregate cost associated with the proposed lease over the entire term is \$5,192,000 and does not include the costs for utilities and janitorial that Probation is responsible for.

D. Analyze results and identify location alternatives

It has been established that the annual rental range for a comparable lease in the area is between \$20.40 and \$31.20 per square foot, per year. The base annual rental rate of \$22.80 per square foot, per year for the proposed lease represents a rate that is on the low end the market range for the area.

E. Determine benefits and drawbacks of each alternative based upon functional needs, service area, cost, and other Location Selection Criteria

The proposed lease will provide adequate and efficient warehouse/office space for 16 employees consistent with the County's Facility Location Policy, adopted by the Board on July 24, 2012.

**COUNTY OF LOS ANGELES
CHIEF EXECUTIVE OFFICE**

LEASE AGREEMENT

COUNTY OF LOS ANGELES - Tenant

NINOS I, L.P. - Landlord

4710 SOUTH EASTERN AVENUE

BELL, CALIFORNIA

TABLE OF CONTENTS

	Page
1. BASIC LEASE INFORMATION.....	1
1.1 Terms	1
1.2 Defined Terms Relating to Landlord's Work Letter.....	3
2. PREMISES.....	3
2.1 Lease of Premises.....	3
2.2 Measurement of Premises	3
3. COMMON AREAS	3
4. COMMENCEMENT AND EXPIRATION DATES	3
4.1 Term	3
4.2 Termination Right	3
4.3 Early Entry	3
4.4 Early Termination	4
5. RENT	4
5.1 Base Rent.....	4
6. USES	5
7. HOLDOVER	5
8. COMPLIANCE WITH LAW	5
9. DAMAGE OR DESTRUCTION	5
9.1 Damage.....	5
9.2 Tenant Termination Right.....	6
9.3 Damage In Last Year	6
9.4 Default By Landlord.....	6
10. REPAIRS AND MAINTENANCE.....	7
10.1 Landlord Representations	7
10.2 Landlord Obligations	8
10.3 Tenant Obligations	9
10.4 Tenant's Right to Repair.....	9
11. SERVICES AND UTILITIES.....	10
11.1 Services.....	10
11.2 Utilities.....	11
12. TAXES	11
13. LANDLORD ACCESS.....	12
14. TENANT DEFAULT	12
14.1 Default.....	12
14.2 Termination	12
14.3 No Effect on Indemnity	12
15. LANDLORD DEFAULT	13
15.1 Remedies	13
15.2 Waiver	13
15.3 Emergency	13
16. ASSIGNMENT AND SUBLETTING	14
16.1 Assignment and Subletting.....	14
16.2 Sale	14
17. ALTERATIONS AND ADDITIONS	15
17.1 Landlord Consent	15
17.2 End of Term.....	15
18. CONDEMNATION.....	15
18.1 Controlling Terms	15

18.2	Total Taking.....	16
18.3	Partial Taking	16
18.4	Restoration	16
18.5	Award	16
18.6	Waiver of Statute	16
19.	INDEMNIFICATION	17
19.1	Landlord's Indemnity	17
19.2	Tenant's Indemnity	17
20.	INSURANCE	17
20.1	Waiver	17
20.2	General Insurance Provisions – Landlord Requirements	17
20.3	Insurance Coverage Types And Limits	20
20.4	Landlord Requirements	21
21.	PARKING	21
21.1	Tenant's Rights.....	21
21.2	Remedies	21
22.	ENVIRONMENTAL MATTERS	22
22.1	Hazardous Materials	22
22.2	Landlord Indemnity	22
23.	ESTOPPEL CERTIFICATES	23
24.	TENANT IMPROVEMENTS.....	23
25.	LIENS.....	23
26.	SUBORDINATION AND MORTGAGES	23
26.1	Subordination and Non-Disturbance	23
26.2	Existing Deeds of Trust	23
26.3	Notice of Default.....	24
27.	SURRENDER OF POSSESSION	24
28.	SIGNAGE.....	24
29.	QUIET ENJOYMENT	24
30.	GENERAL	24
30.1	Headings	24
30.2	Successors and Assigns	24
30.3	Brokers	24
30.4	Entire Agreement	25
30.5	Severability	25
30.6	Notices	25
30.7	Governing Law and Venue	25
30.8	Waivers	25
30.9	Time of Essence.....	26
30.10	Consent	26
30.11	Community Business Enterprises.....	26
30.12	Memorandum of Lease	26
30.13	Counterparts; Electronic Signatures	26
31.	AUTHORITY	27
32.	ACKNOWLEDGEMENT BY LANDLORD	27
32.1	Consideration of GAIN Program Participants	27
32.2	Solicitation of Consideration	27
32.3	Landlord Assignment.....	28
32.4	Smoking in County Facilities.	29
33.	IRREVOCABLE OFFER	30

EXHIBITS

- Exhibit A – Floor Plan of the Premises
- Exhibit B – Commencement Date Memorandum and Confirmation of Lease Terms
- Exhibit C – Heating, Ventilation, and Air Conditioning Standards
- Exhibit D – Intentionally Omitted
- Exhibit E – Subordination, Non-disturbance and Attornment Agreement
- Exhibit F – Tenant Estoppel Certificate
- Exhibit G – Community Business Enterprises Form
- Exhibit H – Memorandum of Lease Terms
- Exhibit I – Landlord's Work Letter

COUNTY OF LOS ANGELES
CHIEF EXECUTIVE OFFICE

LEASE AGREEMENT

This LEASE AGREEMENT ("Lease") is entered into as of the _____ day of _____, 2023 between NINOS I, L.P., a California limited partnership ("Landlord"), and COUNTY OF LOS ANGELES, a body corporate and politic ("Tenant" or "County").

Landlord and Tenant agree:

1. BASIC LEASE INFORMATION

1.1 Terms

The following terms as used herein shall have the meanings provided in this Section 1, unless otherwise specifically modified by provisions of this Lease:

(a) Landlord's Address for Notices:	NINOS I, L.P. 260 East Baker Street, Suite 100 Costa Mesa, CA 92626 ATTN: Brian R. Burkeor & Christine Malikowski
(b) Tenant's Address for Notices:	County of Los Angeles Chief Executive Office - Real Estate Division 320 West Temple Street, 7th Floor Los Angeles, CA 90012 Attention: Director of Real Estate With a copy to: County of Los Angeles Office of the County Counsel 648 Kenneth Hahn Hall of Administration 500 West Temple Street, Suite 648 Los Angeles, CA 90012-2713 Attention: Property Division
(c) Premises:	Approximately 20,116 rentable square feet, designated as the entire Building (defined below), as shown on <u>Exhibit A</u> attached hereto.
(d) Building:	The Building located at 4710 South Eastern Avenue, Bell, California, which is currently assessed by the County Assessor as APN 6332-005-024 (collectively, the "Property");
(e) Term:	Nine (9) years, commencing on the first day of the month following approval of this Lease by the Board of Supervisors and full execution of

	<p>this Lease by both parties (the "Commencement Date"), and terminating at midnight on the day before the ninth annual anniversary of the Commencement Date (the "Termination Date"), subject to earlier termination by Tenant as provided herein. The phrase "Term of this Lease" or "the Term hereof" as used in this Lease, or words of similar import, shall refer to the initial Term of this Lease together with any additional Extension Term for which an option has been validly exercised.</p>
(f) Estimated Commencement Date:	March 1, 2024
(g) Irrevocable Offer Expiration Date: (see Section 33)	N/A
(h) Base Rent:	<p>\$1.90 per rentable square foot per month for the first year of the term, subject to annual increase as set forth in Section 5.2 below.</p> <p>(i.e., \$38,220.40 per month or \$458,644.80 per year for the first year of the term, subject to annual increase as set forth in Section 5.2 below)</p>
(i) Early Termination (see Section 4.4)	One hundred and twenty (120) days' notice after the 84 th month following the Commencement Date of the Lease
(j) Rentable Square Feet in the Premises:	20,116 rentable square feet
(k) Initial Departmental Use:	Storage space and administrative functions, subject to Section 6.
(l) Parking Spaces:	43 spaces
(m) Tenant's Hours of Operation:	6 a.m. to 8 p.m. Monday through Friday, and 9 a.m. to 2 p.m. on Saturdays
(n) Asbestos Report:	N/A
(o) Seismic Report	A report dated <u>October 23, 2023</u> prepared by the Department of Public Works.
(p) Disabled Access Survey	A report dated <u>October 17, 2023</u> prepared by the Capital Programming Division.

1.2 Intentionally Omitted

2. PREMISES

2.1 Lease of Premises

Landlord does hereby lease to Tenant, and Tenant does hereby lease from Landlord, upon the terms and conditions herein set forth, the Premises described in Section 1.1 and depicted on Exhibit A attached hereto.

2.2 Measurement of Premises

Tenant shall have the right at any time during the Term of this Lease to field-measure and verify the exact footage of the Premises and/or the Building. All measurements shall be taken in accordance with the methods of measuring rentable area as described in the Standard Method for Measuring Floor Area in Industrial Buildings, ANSI/BOMA Z65.2-2019, as promulgated by the Building Owners and Management Association ("BOMA") International, except that no penthouse mechanical room space shall be included in the measurement. Should this measurement be less than the square footage stated above, then Tenant shall have the right to adjust such square footage and reduce the Base Rent in Section 1.1 accomplished by the mutual execution of an amendment to this Lease. Landlord acknowledges the space has been marketed at the above-indicated rental amount and in the event of subsequent physical measurements, Landlord agrees there will be no increase made to the Base Rent if the measured square footage exceeds the amount represented by Landlord.

3. COMMON AREAS

Tenant may use the following areas ("Common Areas") in common with Landlord and any other tenants of the Building: the entrances, lobbies, corridors and other public areas of the Building, walkways, landscaped areas, driveways necessary for access to the Premises, parking areas and other common facilities designated by Landlord from time to time for common use of all tenants of the Building. Tenant shall comply with all reasonable, non-discriminatory rules and regulations regarding the use of the Common Area established by Landlord.

4. COMMENCEMENT AND EXPIRATION DATES

4.1 Term

The term of this Lease shall be for a period of 9 years and shall commence upon the Commencement Date and terminate on the Termination Date

4.2 Intentionally Omitted

4.3 Early Entry

Tenant shall be entitled to enter the Premises not less than thirty (30) days prior to the Commencement Date for the purpose of installing Tenant's furniture, fixtures, and equipment in the Premises. Such early entry shall be subject to all provisions

hereof, but shall not advance the Termination Date, and Tenant shall not pay Base Rent nor any other charges for such early entry period.

4.4 Early Termination

Tenant shall have the right to terminate this Lease at any time after the Early Termination date specified in Section 1.1, by giving Landlord not less than one hundred twenty (120) days prior written notice, executed by Tenant's Chief Executive Officer or his/her designee.

5. RENT

5.1 Base Rent

Tenant shall pay Landlord the Base Rent stated in Section 1.1 during the Term hereof within fifteen (15) days after (a) the Commencement Date, and (b) the first day of each calendar month thereafter, provided that at least fifteen (15) business days prior to the Commencement Date, Landlord must provide the Auditor of the County of Los Angeles with the following information: (i) name and address of Landlord or other party to whom Base Rent should be paid, (ii) Landlord's federal tax ID number; (iii) name of contact person and contact information (including phone number) for Landlord; (iv) a completed IRS form W-9, and (v) evidence of insurance in compliance with Section 20.2. If Landlord fails to timely provide the information required pursuant to this Section 5.1, or to provide updates for any changed information, then Tenant shall not be required to pay Base Rent to Landlord until fifteen (15) business days after Landlord provides such information. Base Rent for any partial calendar month during the Term shall be prorated in proportion to the number of days during the Term within such calendar month.

5.2 Base Rent Adjustments

- (a) CPI. From and after the first (1st) anniversary of the Commencement Date, on the first day of the first full calendar month thereafter (the "Adjustment Date") and on every anniversary of the Adjustment Date thereafter, Base Rent shall be adjusted by applying the CPI Formula set forth below. The "Base Index" shall be the Index published for the month the Lease commences.
- (b) CPI Formula. The Index means the Consumer Price Index for all Urban Consumers for the Los Angeles-Long Beach-Anaheim area, all items, published by the United States Department of Labor, Bureau of Labor Statistics (1982-84=100). The "CPI Formula" means Base Rent for the first full month after the Commencement Date multiplied by a fraction, the numerator being the Index published for the month immediately preceding the month in which the adjustment is to be effective (the "New Index"), and the denominator being the Base Index. If the Index is changed so that the Index differs from that used as of the Commencement Date of the Lease, the Index shall be converted in accordance with the conversion factor published by the United States Department of Labor, Bureau of Labor Statistics. If the Index is discontinued or revised during the Term of this Lease, such other governmental Index or computation with which it is replaced shall be used in order to obtain substantially the same results as would be obtained if the Index had not been discontinued or revised.

- (c) Illustration of Formula. The formula for determining the new rent shall be as follows:

$$\frac{\text{New Index}}{\text{Base Index}} \times \text{Base Rent at the Commencement Date} = \text{Adjusted Base Rent}$$

- (d) Limitations on CPI Adjustment. In no event shall the monthly Base Rent adjustment based upon the CPI Formula result in an increase less than two percent (2%) per year or greater than four percent (4%) per year, of the Base Rent payable in the month preceding the applicable adjustment.

6. USES

Landlord agrees that the demised Premises, together with all appurtenances thereto, shall be used by the Tenant for the government department set forth in Section 1.1, any other County Department the County designates, any other governmental purposes, or other lawful purposes that do not materially adversely interfere with other uses in the Building, during Tenant's Hours of Operation, after Tenant's Hours of Operation, and on weekends and holidays.

7. HOLDOVER

If Tenant remains in possession of the Premises or any part thereof after the expiration of the term of this Lease, such occupancy shall be a tenancy which is terminable only upon ninety (90) days written notice from Landlord or thirty (30) days written notice from Tenant's Chief Executive Officer or his/her designee at the last monthly Base Rent payable under this Lease, plus any other charges payable under this Lease, and subject to all of the terms, covenants and conditions of this Lease.

8. COMPLIANCE WITH LAW

Tenant shall, at Tenant's expense, comply promptly with all applicable statutes, ordinances, rules, regulations, orders and requirements in effect during the term hereof regulating the use, occupancy or improvement of the Premises by Tenant. Landlord, not Tenant, shall, at its sole cost, at all times cause the Premises and the Building to comply with all applicable statutes, ordinances, rules, regulations, orders and requirements in effect and binding upon Tenant or Landlord during the term hereof, including but not limited to the Americans with Disabilities Act ("ADA"), except if such compliance is made necessary as a result of Tenant's particular use of or alterations or improvements to the Premises.

9. DAMAGE OR DESTRUCTION

9.1 Damage

If any portion of the Premises is damaged by fire or any other cause rendering the Premises totally or partially inaccessible or unusable, and the Premises may be restored to a complete architectural unit of the same value, condition and character that existed immediately prior to such casualty in less than one hundred eighty (180) days, then Landlord shall promptly, at Landlord's expense, repair such damage, and this Lease shall continue in full force and effect. If all or any portion of the Premises shall be made unusable by fire or other casualty, Landlord shall immediately secure the area to prevent injury to persons and/or vandalism to the

improvements. Landlord shall promptly, but in any event within thirty (30) days after the event of casualty, cause an architect or general contractor selected by Landlord to provide Landlord and Tenant with a written estimate of the amount of time required to substantially complete the repair and restoration of the Premises and make the Premises leasable again using standard working methods. The failure to do so shall be a material default hereunder. Base Rent shall abate to the extent that the Premises are unusable by Tenant during any such period of repair.

9.2 Tenant Termination Right

If any portion of the Premises is damaged by fire or any other cause rendering the Premises totally or partially inaccessible or unusable, and the Premises will not be restored to a complete architectural unit of the same value, condition and character that existed immediately prior to such casualty in less than one hundred eighty (180) days for any reason, then Tenant may terminate this Lease by giving Landlord written notice within ten days after Tenant's receipt of written notice from Landlord or its agents specifying such time period of repair; and this Lease shall terminate and the Base Rent shall be abated from the date the Premises became unusable. If Tenant does not elect to terminate this Lease, then Landlord shall promptly commence and diligently prosecute to completion the repairs to the Building or Premises, provided that insurance proceeds are available to repair the damages.

9.3 Damage In Last Year

Notwithstanding the foregoing provisions, if any material destruction to the Premises occurs during the last year of the Term, then either Landlord or Tenant may terminate this Lease by giving written notice to the other not more than thirty (30) days after such destruction, in which case:

- (a) Landlord shall have no obligation to restore the Premises;
- (b) Landlord may retain all insurance proceeds relating to such destruction, and
- (c) This Lease shall terminate as of the date which is thirty (30) days after such written notice of termination.

9.4 Default By Landlord

If Landlord is required to repair and restore the Premises as provided for in this Section 9, and Landlord thereafter fails to diligently prosecute said repair and restoration work to completion, as determined by Tenant in its reasonable discretion, then Tenant may, at its sole election:

- (a) Declare a default hereunder, or
- (b) Perform or cause to be performed the restoration work and deduct the cost thereof, plus interest thereon at ten percent (10%) per annum, from the next installment(s) of Base Rent due as a charge against the Landlord.

10. REPAIRS AND MAINTENANCE

10.1 Landlord Representations

- (a) Landlord represents to Tenant that, as of the date hereof and on the Commencement Date:
- i. To Landlord's constructive knowledge, the Premises, the Building, and all Common Areas (including electrical, heating, ventilating, and air conditioning ("HVAC"), mechanical, plumbing, gas and fire/life safety systems in the Building and similar building service systems) comply with all current laws, codes, and ordinances, including but not limited to the Americans With Disabilities Act, and are in good working order and condition;
 - ii. To Landlord's constructive knowledge, the Building and the Premises comply with all covenants, conditions, restrictions and insurance underwriter's requirements;
 - iii. The Premises, the Building and the Common Areas are free of the presence of Hazardous Materials (as hereinafter defined); and
 - iv. Landlord has not received any notice from any governmental agency that the Building or the Premises are in violation of any law or regulation.
- (b) Landlord represents, based upon a professional inspection of the Premises and the Building and the Asbestos Report (as defined in Section 1.1) that the Premises and the Building contain no asbestos containing materials (other than as may be reflected in the Asbestos Report). Landlord shall, prior to Tenant's occupancy, abate, at Landlord's sole cost and expense, all asbestos-containing materials to the extent required by law and provide Tenant with an updated report from a licensed California Asbestos contractor to that effect.
- (c) CASp Inspection:

In accordance with California Civil Code Section 1938, Landlord hereby states that the Premises and the Common Areas:
[Check the appropriate box]

☒ Have undergone inspection by a Certified Access Specialist (a "CASp") and have been determined to meet all applicable construction related accessibility standards pursuant to California Civil Code Section 55.53. Landlord shall provide Tenant with a copy of the CASp inspection report and a current disability access inspection certificate for the Premises within seven (7) days after the execution of this Lease.

☐ Have undergone inspection by a Certified Access Specialist and have not been determined to meet all applicable construction related accessibility standards pursuant to California Civil Code Section 55.53. Landlord has provided Tenant with a copy of the CASp inspection report at

least 48 hours prior to the execution of this Lease. A Certified Access Specialist (CAsp) can inspect the subject premises and determine whether the subject premises comply with all of the applicable construction-related accessibility standards under state law. Although state law does not require a CAsp inspection of the subject premises, the commercial property owner or lessor may not prohibit the lessee or tenant from obtaining a CAsp inspection of the subject premises for the occupancy or potential occupancy of the lessee or tenant, if requested by the lessee or tenant. The parties shall mutually agree on the arrangements for the time and manner of the CAsp inspection, the payment of the fee for the CAsp inspection, and the cost of making any repairs necessary to correct violations of construction-related accessibility standards within the premises.

☐ Have not undergone inspection by a Certified Access Specialist. A Certified Access Specialist (CAsp) can inspect the subject premises and determine whether the subject premises comply with all of the applicable construction-related accessibility standards under state law. Although state law does not require a CAsp inspection of the subject premises, the commercial property owner or lessor may not prohibit the lessee or tenant from obtaining a CAsp inspection of the subject premises for the occupancy or potential occupancy of the lessee or tenant, if requested by the lessee or tenant. The parties shall mutually agree on the arrangements for the time and manner of the CAsp inspection, the payment of the fee for the CAsp inspection, and the cost of making any repairs necessary to correct violations of construction-related accessibility standards within the premises.

The foregoing statement is provided solely for the purpose of complying with California Civil Code Section 1938 and shall not affect the Landlord's and Tenant's respective responsibilities for compliance with any design and construction related accessibility obligations as provided under this Lease.

- (d) Landlord agrees to indemnify and hold harmless Tenant from all damages, costs, and expenses, which result from a material breach of Landlord's representations contained in this Section 10.1.

10.2 Landlord Obligations

- (a) Landlord shall keep and maintain the Property in good condition and repair and promptly make repairs to and perform maintenance upon and replace as needed:
 - i. the structural elements of the Building, including without limitation, all permanent exterior and interior walls, floors and ceilings, foundations, roof, concealed plumbing, stairways, concealed electrical systems and intra-building telephone network cables;
 - ii. mechanical (including HVAC), electrical, plumbing and fire/life systems serving the Building;
 - iii. the Common Areas;

- iv. exterior windows of the Building; and
 - v. elevators serving the Building.
- (b) Landlord, at its sole cost and expense, shall also perform all maintenance and repairs to the Premises, and shall keep the Premises in good condition and repair, reasonable wear and tear excepted. Landlord's repair obligations include, without limitation, repairs to, or replacements of:
- i. the floor covering (if such floor covering is carpeting as of the Commencement Date it shall be replaced as needed, but not less often than after five (5) years of use);
 - ii. interior partitions;
 - iii. doors, door frames and hardware;
 - iv. the interior side of demising walls (which shall be repainted as needed but not less often than every five (5) years);
 - v. signage;
 - vi. emergency exit signage and battery replacement;
 - vii. intentionally omitted; and
 - viii. Light fixtures, bulbs, tubes and ballasts.
- (c) Landlord shall, to the best of its ability, provide all reports, maintenance records, or other documentation as may be requested from time to time.

10.3 Tenant Obligations

Without limiting Landlord's repair and maintenance obligations, Tenant shall be responsible for (i) the cost of repairing any area of the Property damaged by Tenant or by Tenant's agents, employees, invitees or visitors, and (ii) the repair of low voltage electronic, phone and data cabling and related equipment that is installed by or for the exclusive benefit of Tenant. All repairs and replacements shall:

- (a) be made and performed by contractors or mechanics approved by Landlord, which consent shall not be unreasonably withheld, conditioned or delayed;
- (b) be at least equal in quality, value and utility to the original work or installation; and
- (c) be in accordance with all applicable laws.

10.4 Tenant's Right to Repair

- (a) If Tenant provides written notice (or oral notice in the event of an emergency, such as damage or destruction to or of any portion of the Building structure and/or the Building systems, and/or anything that could

cause material disruption to Tenant's business) to Landlord of an event or circumstance which requires the action of Landlord with respect to repair and/or maintenance, and if Landlord fails to provide such action within a reasonable period of time given the circumstances after the giving of such notice, but in any event not later than five (5) days after the giving of such notice, then Tenant may proceed to take the required action (provided, however, that no such notice shall be required in the event of an emergency which threatens life or where there is imminent danger to property or a possibility that a failure to take immediate action could cause a material disruption in Tenant's normal and customary business activities). Tenant shall have access to the Building to the extent necessary to perform the work contemplated by this provision. If such action was required under the terms of this Lease to have been taken by Landlord and was not taken by Landlord within such period (unless such notice was not required as provided above), and Tenant took such required action, then Tenant shall be entitled to prompt reimbursement by Landlord of Tenant's reasonable costs and expenses in having taken such action plus interest thereon at ten percent (10%) per annum. If not reimbursed by Landlord within ten (10) days after written notice, then Tenant shall be entitled to deduct from Base Rent payable by Tenant under this Lease the amount set forth in its invoice for such work. The remedies provided in this Section are in addition to the remedies provided in Section 15.

- (b) [Notwithstanding any provisions of this Lease to the contrary, Tenant, acting through the Chief Executive Office, may request that Landlord perform, supply and administer repairs, maintenance, building services and/or alterations that are the responsibility of the Tenant, not to exceed \$5,000, as part of a separate purchase order issued by the County on Tenant's behalf. Any improvements by Landlord shall be subject to compliance with County Internal Services Department Purchasing Policy and Procedure No. A-0300, effective November 22, 2016, delivered to Landlord and incorporated by reference herein. This Section shall not apply to Tenant Improvements, as defined in Section 24.]

11. SERVICES AND UTILITIES

11.1 Services

- (a) **Heating, Ventilation and Air Conditioning (HVAC)**

Landlord shall furnish heating, ventilation and air conditioning ("HVAC"), during Tenant's Hours of Operations in amounts required for the use and occupancy of the Premises for normal office purposes to a standard comparable to other first-class buildings and not less than the standard set forth in Exhibit C attached hereto.

- (b) **Electricity**

Landlord shall furnish to the Premises not less than seven (7) watts of electric current (connected load) per square foot of rentable square feet in the Premises, for power and lighting and electric current for HVAC, and Landlord shall provide the existing or new transformers or sub-panels on

each floor of the Premises necessary for Tenant to utilize such capacity in the Premises.

(c) Elevators

Landlord shall furnish freight and passenger elevator services to the Premises during Tenant's Hours of Operations. During all other hours, Landlord shall furnish passenger elevator cab service in the elevator bank serving the Premises on an as needed basis, and, by prior arrangement with Landlord's building manager, freight elevator service.

(d) Water

Landlord shall make available in the Premises warm and cold water for normal lavatory and kitchen purposes and potable water for drinking purposes, all of which shall meet applicable government standards.

(e) Janitorial

Tenant, at its sole cost and expense, shall provide janitorial service five (5) nights per week, generally consistent with that furnished in comparable office buildings in the County of Los Angeles.

(f) Access

Landlord shall furnish to Tenant's employees and agents access to the Building, Premises and Common Areas on a seven day per week, 24 hour per day basis, subject to compliance with such reasonable security measures as shall from time to time be in effect for the Building. If required, Landlord shall provide access cards or fobs to all Tenant employees for Building entry, elevators, and/or floor access, at Landlord's sole cost and expense.

(g) Pest Control

Landlord at its sole cost and expense shall provide any and all pest control services to the Premises.

11.2 Utilities

Tenant agrees to pay, at its sole cost, when due, all charges for the use of the sewer, effluent treatment (when and if imposed by any governmental authority), all water, sprinkler standby charges, electricity, gas, heating and common area power and lighting, trash removal service, fire/life safety systems, charges associated with the HVAC, and other utility rents and charges accruing or payable in connection with the Premises and the Common Areas during the Term of this Lease or any renewal, extension, or holdover thereof, whether the same are pro-rated or measured by separate meters.

12. TAXES

Landlord, at its sole cost and expense, shall pay, prior to delinquency, all real property taxes, assessments and special assessments which may be levied or assessed against

the Premises or the Building during the term of this Lease or any renewal or holdover period thereof.

In the event Landlord fails or refuses to pay any or all taxes or assessments when due, Tenant may, at its sole discretion, give Landlord thirty (30) calendar days prior written notice and thereafter pay such taxes and assessments and deduct the payments from the next installments of rent due as a charge against the Landlord.

13. LANDLORD ACCESS

Tenant shall permit Landlord and its agents to enter the Premises during Tenant's Hours of Operations upon prior written notice only for the purpose of inspecting the Premises for any reasonable purpose. If Landlord temporarily closes any portion of the Building or the Premises, Base Rent shall be prorated based upon the percentage of the Premises or the Building rendered unusable and not used by Tenant. Landlord shall have the right at any and all times to enter the Premises in the event of an emergency and notify Tenant immediately thereafter.

14. TENANT DEFAULT

14.1 Default

The occurrence of any one or more of the following events shall constitute a material default and breach of this Lease by Tenant ("Default"):

- (a) the failure by Tenant to make any payment of Base Rent or any other payment required to be made by Tenant hereunder (except to the extent an offset is expressly permitted hereunder) as and when due, and the failure continues for a period of ten (10) days after written notice to Tenant;
- (b) the failure by Tenant to observe or perform any of the other covenants, conditions or provisions of this Lease, where such failure shall continue for a period of thirty (30) days after written notice from Landlord specifying in detail the nature of the default; provided, however, if more than thirty (30) days are reasonably required for its cure then Tenant shall not be deemed to be in default if Tenant commences such cure, within said thirty (30)-day period and thereafter diligently prosecutes such cure to completion.

14.2 Termination

Tenant agrees that if a Default should occur and should not be cured within the time periods set forth above, it shall be lawful for Landlord to terminate this Lease upon the giving of written notice to Tenant. In addition thereto, Landlord shall have such other rights or remedies as may be provided by law.

14.3 No Effect on Indemnity

Nothing in this Article shall be deemed to affect either Landlord or Tenant's right to indemnification under any indemnification clause or clauses set forth in this Lease.

15. LANDLORD DEFAULT

15.1 Remedies

In addition to the provisions for Landlord's default provided by Sections 9.4, 10.4, 19, 21.2 and 32.3, Landlord shall be in default ("Landlord Default") in the performance of any obligation required to be performed by Landlord under this Lease if Landlord has failed to perform such obligation within fifteen (15) days after the giving of written notice with respect thereto by Tenant (which notice shall be, if appropriate, the same notice given under Section 10.4); provided, however, that if the nature of the Landlord Default is such that the same cannot reasonably be cured within such five day period, Landlord shall not be deemed to be in Landlord Default if Landlord shall within such period commence such cure and thereafter diligently prosecute the same to completion. If the Landlord Default is of such a nature that it materially and substantially interferes with Tenant's occupancy and use of the Premises and if such Landlord Default is not cured within the foregoing cure period, then Tenant shall have the right, at its option, with or without further notice or demand of any kind to Landlord or any other person, to any one or more of the following described remedies in addition to all other rights and remedies provided at law or in equity or elsewhere herein:

- (a) to remedy such default or breach and deduct the costs thereof (including but not limited to attorney' fees) plus interest at the rate of ten percent (10%) per annum from the installments of Base Rent next falling due;
- (b) to pursue the remedy of specific performance;
- (c) to seek money damages for loss arising from Landlord's failure to discharge its obligations under this Lease or offset such damages against Base Rent next coming due; and/or
- (d) to terminate this Lease.

15.2 Waiver

Nothing herein contained shall relieve Landlord from its duty to effect the repair, replacement, correction or maintenance required to restore any affected services, or to perform any other obligations to the standard prescribed in this Lease, nor shall this Section be construed to obligate Tenant to undertake any such work.

15.3 Emergency

Notwithstanding the foregoing cure period, Tenant may cure any default where the failure promptly to cure such default would, in the reasonable opinion of Tenant, create or allow to persist an emergency condition, or materially and adversely affect the operation of Tenant's business in the Premises. In such cases, Tenant may perform the necessary work through its Internal Services Department and deduct the cost of said work from the Base Rent next due.

16. ASSIGNMENT AND SUBLETTING

16.1 Assignment and Subletting

Tenant may assign, mortgage, encumber or otherwise transfer this Lease or sublet the whole or any part of the Premises without first obtaining Landlord's prior consent; provided, however, no such assignment, subletting or other transfer shall relieve Tenant of any liability under this Lease.

16.2 Sale

If Landlord sells or conveys the Property, then all liabilities and obligations of Landlord accruing under this Lease after the sale or conveyance shall be binding upon the new owner, and the transferor shall be released from all liability under this Lease accruing subsequent to such sale or conveyance, provided that the transferee assumes Landlord's remaining obligations hereunder in writing. Nothing in this Section 16.2 shall be deemed to release Landlord's successor in interest from responsibility for any condition (including but not limited to deferred maintenance) existing on the date of transfer.

Upon any sale or transfer of the Property by Landlord, Landlord shall provide thirty (30) days prior written notice of said sale or transfer to Tenant. In addition, Landlord shall provide the following information to Tenant, at Tenant's Address for Notice (set forth in Section 1.1 hereof), as a condition of Tenant's obligation to pay Base Rent to the new owner:

- (a) A letter from the Landlord confirming that the Property was transferred to the new owner, along with written evidence of the transfer of the Property (e.g., a recorded deed).
- (b) A signed letter from the new owner including the following information:
 - i. Name and address of new owner or other party to whom Base Rent should be paid
 - ii. Federal tax ID number for new owner
 - iii. Name of contact person and contact information (including phone number) for new owner
 - iv. Proof of insurance
- (c) A W-9 form for new owner.

Tenant shall not be obligated to pay any rental amounts to any party other than the Landlord named herein until such time as all the requirements of this Section 16.2 are satisfied.

17. ALTERATIONS AND ADDITIONS

17.1 Landlord Consent

Tenant shall not make any structural alterations, improvements, additions, or utility installations in or about the Premises (collectively, "Alterations") without first obtaining the written consent of Landlord, which consent shall not be unreasonably withheld, conditioned, or delayed. If Landlord fails to respond in writing within thirty (30) days after Tenant's request, then Landlord shall be deemed to have approved the requested Alterations. However, Landlord's consent shall not be required for any Alteration that satisfies all of the following criteria:

- (a) complies with all laws;
- (b) is not visible from the exterior of the Premises or Building;
- (c) will not materially affect the systems or structure of the Building; and
- (d) does not unreasonably interfere with the normal and customary business office operations of other tenants in the Building.

17.2 End of Term

When Tenant requests Landlord's consent to a proposed Alterations, or before the commencement of any Alterations for which Landlord's consent is not required, Tenant may ask Landlord in writing whether Landlord will require that the Alterations be removed on expiration or earlier termination of the Lease Term. Landlord shall respond to such inquiry in writing within fifteen (15) days. If Landlord responds that it will not require removal of the Alterations or fails to respond, Tenant shall not be required to remove the Alterations. Any Alterations not removed by Tenant shall become the property of the Landlord and remain upon and be surrendered with the Premises at the expiration of the Term..

18. CONDEMNATION

18.1 Controlling Terms

If during the Term, or during the period of time between the execution of this Lease and the Commencement Date, there is any taking of all or any part of the Premises or any interest in this Lease by Condemnation (as defined below), this Section shall determine the rights and obligations of Tenant and Landlord. "Condemnation" shall mean the exercise of any governmental power to take title to any portion of the Premises, whether by legal proceedings or otherwise, by a Condemnor (as defined below) or a voluntary sale or transfer by Landlord to any Condemnor either under threat of a Condemnor's exercise of such power or while legal proceedings are pending for the exercise of such power. "Condemnor" shall mean any public or quasi-public authority, or private corporation or individual, having the power of Condemnation.

18.2 Total Taking

If the Premises are totally taken by Condemnation, this Lease shall terminate on the date the Condemnor has a right to possession of the Premises (the "Date of Taking").

18.3 Partial Taking

If any portion, but not all, of the Premises or the Common Areas is taken by Condemnation, this Lease shall remain in effect, except that Tenant may elect to terminate this Lease if, in Tenant's reasonable judgment, the remaining portion of the Premises (including the space available for parking) is rendered unsuitable for Tenant's continued use of the Premises. If Tenant elects to so terminate this Lease, Tenant must exercise its right to terminate by giving notice to Landlord within thirty (30) days after the date that the nature and the extent of the Condemnation have been determined (the "Determination Date"), which notice shall set forth the date of termination. Such termination date shall not be earlier than thirty (30) days nor later than ninety (90) days after Tenant has notified Landlord of its election to terminate; except that this Lease shall terminate on the Date of Taking if the Date of Taking falls on a date before the termination date designated by Tenant. If Tenant does not so notify Landlord within thirty (30) days after the Determination Date, all obligations of Tenant under this Lease shall remain in effect, except that Base Rent shall be equitably abated in proportion to the degree to which Tenant's use of the Premises and the Common Areas is impaired by such Condemnation.

18.4 Restoration

Notwithstanding the preceding paragraph, if, within thirty (30) days after the Determination Date, Landlord notifies Tenant that Landlord, at its sole cost, will add to the remaining Premises and/or the Common Areas so that the Premises and the space available for parking, will be substantially the same (as reasonably determined by Tenant) after the Date of Taking as they were before the Date of Taking, and Landlord commences the restoration promptly and, subject to reasonable allowance for delays that are not caused by Landlord, completes it within ninety (90) days after Landlord so notifies Tenant, then this Lease shall continue in effect. In such event, all obligations of Tenant under this Lease shall remain in effect, except that Base Rent shall be equitably abated or reduced during the period from the Date of Taking until the completion of such restoration.

18.5 Award

The Award (as defined below) shall be divided between Landlord and Tenant as their respective interests may appear. "Award" shall mean all compensation, sums or anything of value awarded, paid or received on a total or partial Condemnation of the Premises. Tenant shall be entitled to any awards for relocation benefits or goodwill belonging to Tenant.

18.6 Waiver of Statute

Landlord and Tenant hereby waive the provision of California Code of Civil Procedure Section 1265.130 allowing Landlord or Tenant to petition the Superior Court to terminate this Lease in the event of a partial taking of the Premises.

19. INDEMNIFICATION

19.1 Landlord's Indemnity

The Landlord shall indemnify, defend and hold harmless the Tenant from and against any and all liability, loss, injury or damage including (but not limited to) demands, claims, actions, fees, costs and expenses (including attorney and expert witness fees), arising from or connected with the Landlord's repair, maintenance and other acts and omissions arising from and/or relating to the Landlord's ownership of the Premises.

19.2 Tenant's Indemnity

The Tenant shall indemnify, defend and hold harmless the Landlord, from and against any and all liability, loss, injury or damage, including (but not limited to) demands, claims, actions, fees, costs and expenses (including attorney and expert witness fees) arising from or connected with the Tenant's repair, maintenance and other acts and omissions arising from and/or relating to the Tenant's use of the Premises.

20. INSURANCE

During the term of this Lease, the following insurance requirements will be in effect:

20.1 Waiver

Both the Tenant and Landlord each agree to release the other and waive their rights of recovery against the other for damage to their respective property arising from perils insured in the Causes-of-Loss Special Form (ISO form CP 10 30).

20.2 General Insurance Provisions – Landlord Requirements

Without limiting the Landlord's indemnification of Tenant and during the term of this Lease, and until all of its obligations pursuant to this Lease have been met, Landlord shall provide and maintain at its own expense insurance coverage satisfying the requirements specified in this Lease. These minimum insurance coverage terms, types and limits (the "Required Insurance") also are in addition to and separate from any other contractual obligation imposed upon Landlord pursuant to this Lease. The Tenant in no way warrants that the Required Insurance is sufficient to protect the Landlord for liabilities which may arise from or relate to this Lease.

(a) Evidence of Coverage and Notice to Tenant

- i. Certificate(s) of insurance coverage ("Certificate") satisfactory to Tenant, and a copy of an Additional Insured endorsement confirming that Tenant and its Agents (defined below) has been given insured status under the Landlord's General Liability policy, shall be delivered to Tenant at the address shown below and provided prior to the start day of this Lease.
- ii. Renewal Certificates shall be provided to Tenant not less than 10 days prior to Landlord's policy expiration dates. The Tenant

reserves the right to obtain complete, certified copies of any required Landlord insurance policies at any time.

- iii. Certificates shall identify all Required Insurance coverage types and limits specified herein, reference this Lease by name or number, and be signed by an authorized representative of the insurer(s). The Insured party named on the Certificate shall match the name of the Landlord identified in this Lease. Certificates shall provide the full name of each insurer providing coverage, its NAIC (National Association of Insurance Commissioners) identification number, its financial rating, the amounts of any policy deductibles or self-insured retentions exceeding twenty-five thousand (\$25,000.00) dollars, and list any Tenant-required endorsement forms.
- iv. Neither the Tenant's failure to obtain, nor the Tenant's receipt of, or failure to object to a non-complying insurance certificate or endorsement, or any other insurance documentation or information provided by the Landlord, its insurance broker(s) and/or insurer(s), shall be construed as a waiver of any of the Required Insurance provisions.
- v. Certificates and copies of any required endorsements, and/or notices of cancellation shall be delivered to:

County of Los Angeles
Chief Executive Office - Real Estate Division
320 West Temple Street, 7th Floor
Los Angeles, CA 90012
Attention: Director of Real Estate

Landlord also shall promptly notify Tenant of any third party claim or suit filed against Landlord which arises from or relates to this Lease, and could result in the filing of a claim or lawsuit against Landlord and/or Tenant.

(b) Additional Insured Status and Scope of Coverage

The Tenant, which is the County of Los Angeles, its Special Districts, Elected Officials, Officers, Agents, Employees and Volunteers (collectively, "Tenant and its Agents"), shall be provided additional insured status under Landlord's General Liability policy with respect to liability arising from or connected with the Landlord's acts, errors, and omissions arising from and/or relating to the Landlord's operations on and/or its ownership of the premises. Tenant's additional insured status shall apply with respect to liability and defense of suits arising out of the Landlord's acts or omissions, whether such liability is attributable to the Landlord or to the Tenant. The full policy limits and scope of protection also shall apply to the Tenant as an additional insured, even if they exceed the Tenant's minimum Required Insurance specifications herein. Use of an automatic additional insured endorsement form is acceptable providing it satisfies the Required Insurance provisions herein.

(c) Cancellation of or Changes in Insurance

Landlord shall provide the Tenant with, or Landlord's insurance policies shall contain a provision that the Tenant shall receive, written notice of cancellation or any change in Required Insurance, including insurer, limits of coverage, term of coverage or policy period. The written notice shall be provided to the Tenant at least ten (10) days in advance of cancellation for non-payment of premium and thirty (30) days in advance for any other cancellation or policy change. Failure to provide written notice of cancellation or any change in Required Insurance may constitute a material breach of the Lease, in the sole discretion of the Tenant, upon which the Tenant may suspend or terminate this Lease.

(d) Failure to Maintain Insurance

Landlord's failure to maintain or to provide acceptable evidence that it maintains the Required Insurance shall constitute a material breach of the Lease, upon which County immediately may withhold payments due to Landlord, and/or suspend or terminate this Lease. County, at its sole discretion, may obtain damages from Landlord resulting from said breach. Alternatively, the County may purchase the Required Insurance, and without further notice to Landlord, deduct the premium cost from sums due to Landlord or pursue Landlord reimbursement.

(e) Insurer Financial Ratings

Insurance is to be provided by an insurance company authorized to do business in California and acceptable to the Tenant, with an A.M. Best rating of not less than A:VII, unless otherwise approved by the Tenant.

(f) Landlord's Insurance Shall Be Primary

Landlord's insurance policies, with respect to any claims related to this Lease, shall be primary with respect to all other sources of coverage available to Tenant. Any Tenant maintained insurance or self-insurance coverage shall be in excess of and not contribute to any Tenant coverage.

(g) Waiver of Subrogation

To the fullest extent permitted by law, the Landlord hereby waives its and its insurer(s) rights of recovery against Tenant under all required insurance policies for any loss arising from or related to this Lease. The Landlord shall require its insurers to execute any waiver of subrogation endorsements which may be necessary to affect such waiver.

(h) Deductibles and Self-Insured Retentions ("SIRs")

Landlord's policies shall not obligate the Tenant to pay any portion of any Landlord deductible or SIR. The Tenant retains the right to require Landlord to reduce or eliminate policy deductibles and SIRs as respects the Tenant, or to provide a bond guaranteeing Landlord's payment of all deductibles and SIRs, including all related claims investigation,

administration and defense expenses. Such bond shall be executed by a corporate surety licensed to transact business in the State of California.

(i) Claims Made Coverage

If any part of the Required Insurance is written on claims made basis, any policy retroactive date shall precede the start date of this Lease. Landlord understands and agrees it shall maintain such coverage for a period of not less than three (3) years following Lease expiration, termination or cancellation.

(j) Application of Excess Liability Coverage

Landlord may use a combination of primary and excess insurance policies which provide coverage as broad as ("follow form" over) the underlying primary policies, to satisfy the Required Insurance provisions.

(k) Separation of Insureds

All liability policies shall provide cross-liability coverage as would be afforded by the standard ISO (Insurance Services Office, Inc.) separation of insureds provision with no insured versus insured exclusions or limitations.

(l) Tenant Review and Approval of Insurance Requirements

The Tenant reserves the right to review and adjust the Required Insurance provisions, conditioned upon Tenant's determination of changes in risk exposures.

20.3 Insurance Coverage Types And Limits

(a) Tenant Requirements: During the term of this Lease, Tenant shall maintain a program of insurance coverage as described below:

i. Commercial General Liability Insurance, providing scope of coverage equivalent to ISO policy form CG 00 01, naming Landlord and its Agents as an additional insured, with limits of not less than:

General Aggregate:	\$ 3 million
Products/Completed Operations Aggregate:	\$ 1 million
Personal and Advertising Injury:	\$ 2 million
Each Occurrence:	\$ 2 million

Tenant, at its sole option, may satisfy all or any part of this insurance requirement through use of a program of self-insurance (self-funding of its liabilities). Certificate evidencing coverage or letter evidencing self-funding will be provided to Landlord after execution of this Lease at Landlord's request.

20.4 Landlord Requirements

During the term of this Lease, Landlord shall provide and maintain the following programs of insurance coverage:

- (a) Commercial General Liability Insurance, providing scope of coverage equivalent to ISO policy form CG 00 01, naming Tenant and Tenant's Agents as an additional insured, with limits of not less than:

General Aggregate:	\$ 6 million
Products/Completed Operations Aggregate:	\$ 6 million
Personal and Advertising Injury:	\$ 2 million
Each Occurrence:	\$ 3 million

- (b) Commercial Property Insurance. Such insurance shall:

- i. Provide coverage for any tenant improvements and betterments to the Premises; this coverage shall be at least as broad as that provided by the Causes-of-Loss Special Form (ISO form CP 10 30), excluding earthquake and including flood and ordinance or law coverage.
- ii. Be written for the full replacement cost of the Property, with a deductible no greater than \$250,000 or 5% of the Property value, whichever is less. Insurance proceeds shall be payable to the Landlord and Tenant, as their interests may appear.

21. PARKING

21.1 Tenant's Rights

Tenant shall have the right to the number of exclusive reserved parking spaces and unreserved parking spaces set forth in Section 1.1, without charge, for the Term of this Lease. No tandem parking shall be required or allowed, and Tenant shall be entitled to full in/out privileges at all times. Tenant's parking rights shall be subject to reasonable parking rules and regulations adopted by Landlord from time to time, provided that such procedures shall be uniformly applied to all tenants. Tenant acknowledges that all unreserved parking spaces are not for the exclusive use of Tenant, rather, all such parking spaces are to be used on a non-exclusive, first-come, first-served basis by Tenant and other tenants, occupants, licensees, invitees and permittees of the Building. Landlord, at its sole expense, shall provide Tenant with at least one (1) parking access card or key fob for each reserved or unreserved parking space set forth in Section 1.1, if applicable.

21.2 Remedies

Landlord acknowledges that it is a material term of this Lease that Tenant receives all of the parking spaces to which it is entitled under this Lease for the entire Term of this Lease and that it would be impracticable and extremely difficult to fix the actual damages for a breach of such provisions. It is therefore agreed that if, for any reason whatsoever, a material number of the parking spaces required above are not available to Tenant (in addition to the rights given to Tenant under Section

14 and Sections 9 and 17 in the event of casualty or condemnation), then Tenant may:

- (a) terminate this Lease by giving written notice of such termination to Landlord, which notice shall be effective thirty (30) days thereafter, or
- (b) deduct from the Base Rent thereafter accruing hereunder an amount each month equal to the Base Rent times the percentage of parking spaces not so provided times the number 1.5, but such deduction from Base Rent shall be not less than ten percent (10%) nor more than one hundred percent (100%) of the Base Rent.

22. ENVIRONMENTAL MATTERS

22.1 Hazardous Materials

Tenant shall not cause nor permit, nor allow any of Tenant's employees agents, customers, visitors, invitees, licensee, contractor, assignees or subtenants to cause or permit, any Hazardous Materials to be brought upon, stored, manufactured, generated, blended, handled, recycled, treated, disposed or used on, under or about the Premises, the Building or the Common Areas, except for routine office and janitorial supplies in usual and customary quantities stored, used and disposed of in accordance with all applicable Environmental Laws. As used herein, "Hazardous Materials" means any chemical, substance, material, controlled substance, object, condition, waste, living organism or combination thereof, whether solid, semi solid, liquid or gaseous, which is or may be hazardous to human health or safety or to the environment due to its radioactivity, ignitability, corrosivity, reactivity, explosivity, toxicity, carcinogenicity, mutagenicity, phytotoxicity, infectiousness or other harmful or potentially harmful properties or effects, including, without limitation, molds, toxic levels of bacteria, tobacco smoke within the Premises, petroleum and petroleum products, asbestos, radon, polychlorinated biphenyls (PCBs), refrigerants (including those substances defined in the Environmental Protection Agency's "Refrigerant Recycling Rule," as amended from time to time) and all of those chemicals, substances, materials, controlled substances, objects, conditions, wastes, living organisms or combinations thereof which are now or become in the future listed, defined or regulated in any manner by any Environmental Law based upon, directly or indirectly, such properties or effects. As used herein, "Environmental Laws" means any and all federal, state or local environmental, health and/or safety-related laws, regulations, standards, decisions of courts, ordinances, rules, codes, orders, decrees, directives, guidelines, permits or permit conditions, currently existing and as amended, enacted, issued or adopted in the future which are or become applicable to Tenant, the Premises, the Building or the Common Areas.

22.2 Landlord Indemnity

Landlord shall indemnify, protect, defend (by counsel acceptable to Tenant) and hold harmless Tenant from and against any and all claims, judgments, causes of action, damage, penalties, fines, taxes, costs, liabilities, losses and expenses arising at any time during or after the Term as a result (directly or indirectly) of, or in connection with, the presence of Hazardous Materials on, under or about the Premises, Building or Common Areas or other violation of laws relating to Hazardous Materials caused by Landlord. This indemnity shall include, without

limitation, the cost of any required or necessary repair, cleanup or detoxification, and the preparation and implementation of any closure, monitoring or other required plans, as such action is required by local or state laws or any governmental agency. Landlord shall promptly deliver to Tenant a copy of any notice received from any governmental agency during the Term of this Lease concerning the presence of Hazardous Materials in the Building or the Premises. Landlord's obligations pursuant to the foregoing indemnity shall survive the expiration or termination of this Lease. A default by Landlord under this Section shall constitute a material default under this Lease.

23. ESTOPPEL CERTIFICATES

Tenant shall, within 30 business days after written request of Landlord, execute, acknowledge and deliver to Landlord or its designee a written statement in the form of Exhibit F attached hereto (properly completed) but shall have no other obligation to deliver any other form of estoppel certificate. It is intended that any such statement delivered pursuant to this Section may be relied upon by a prospective purchaser of Landlord's interest in the Premises or a holder of any mortgage upon Landlord's interest in the Premises.

24. TENANT IMPROVEMENTS

Upon approval of this Lease by the Board of Supervisors and full execution of this lease by both parties, Landlord shall construct the Tenant Improvements in the manner set forth in Landlord's Work Letter (Exhibit I).

25. LIENS

Tenant shall keep its interest in this Lease and the Premises free from any liens arising out of any work performed or materials ordered or obligations incurred by Tenant. Landlord shall keep its interest in this Lease and the Premises free from any liens which would impair the interest of Tenant hereunder and hereby indemnifies and holds Tenant harmless from any liability or loss from any such lien.

26. SUBORDINATION AND MORTGAGES

26.1 Subordination and Non-Disturbance

Tenant agrees, at Landlord's option, to subordinate this Lease to the lien of any mortgages or deeds of trust now or hereafter in force against the Building; provided, however, Tenant's obligation to subordinate this Lease is expressly conditioned upon Tenant receiving a written agreement in the form of Exhibit E attached hereto and provided further that no such subordination shall affect any option to extend the Term of this Lease, right of first offer to lease additional premises, option to purchase, or right of first offer to purchase the Property included herein.

26.2 Existing Deeds of Trust

The beneficiary under any existing deed of trust affecting the Building shall provide a written agreement to Tenant in the form of Exhibit E attached hereto, within 30 days after the execution of this Lease.

26.3 Notice of Default

If any mortgagee or beneficiary under a deed of trust affecting the Property gives written notice of its name and address to Tenant by registered mail and requests copies of any notice of default that Tenant serves upon Landlord, Tenant agrees to use its best efforts (but without liability for failure to do so) to give such mortgagee or beneficiary a copy of any notice of default that Tenant serves upon Landlord which could permit Tenant to terminate this Lease, along with an additional ten days within which to cure such default.

27. SURRENDER OF POSSESSION

Subject to casualty, at the expiration of the Term of this Lease, whether by lapse of time or otherwise, Tenant shall promptly and peacefully surrender the Premises to Landlord in a "broom-clean" condition. Tenant shall remove, at its own expense, all fixtures, equipment and all other personal property placed or installed in or upon the Premises by Tenant, or under its authority (including any modular furniture), unless Tenant is not required to remove Alterations subject to Section 17.2.

28. SIGNAGE

Tenant shall be allowed building standard signage on the directory located in the ground floor lobby of the Building and elevator lobbies of the floors of the Premises and suite signage, all of which shall be at Landlord's expense. Tenant shall have the right to install, at Landlord's sole cost and expense, up to two (2) lines per 1,000 rentable square feet of the Premises on the Building's directory board in the main lobby of the Building. Tenant shall be permitted to install signs at the Premises that conform with any and all applicable laws and ordinances.

29. QUIET ENJOYMENT

So long as Tenant is not in default hereunder, Tenant shall have the right to the peaceful and quiet enjoyment and possession of the Premises and the Common Areas during the Term of this Lease, subject to the terms and conditions of this Lease.

30. GENERAL

30.1 Headings

Titles to Sections of this Lease are not a part of this Lease and shall have no effect upon the construction or interpretation of any part hereof.

30.2 Successors and Assigns

All of the covenants, agreements, terms and conditions contained in this Lease shall inure to and be binding upon the Landlord and Tenant and their respective successors and assigns.

30.3 Brokers

Landlord and Tenant each represent and warrant to each other that it has not engaged any broker, finder or other person who would be entitled to any commission or fees in respect of the negotiation, execution or delivery of this Lease

other than as disclosed to the other in writing and shall indemnify and hold harmless each other against any loss, cost, liability or expense incurred by the other party as a result of any claim asserted by any such broker, finder or other person on the basis of any arrangements or agreements made or alleged to have been made in variance with this representation. Tenant shall receive from Landlord or Landlord's broker, within ten days after the execution of this Lease, an amount equal to 25% of all commissions due to Landlord's broker as a result of the execution of this Lease, and an additional amount equal to 25% of all commissions due to Landlord's broker as a result of the execution of this Lease within ten days after Tenant has taken possession of the Premises, as set forth in a separate written agreement between Landlord and Landlord's broker, a copy of which has been delivered by Landlord to Tenant prior to the execution of this Lease.

30.4 Entire Agreement

This Lease (including all exhibits hereto) is the final and complete expression of Landlord and Tenant relating in any manner to the leasing, use and occupancy of the Premises, to Tenant's use of the Building and other matters set forth in this Lease. No prior agreements or understanding pertaining to the same shall be valid or of any force or effect, and the covenants and agreements of this Lease shall not be altered, modified or added to except in writing signed by both Landlord and Tenant.

30.5 Severability

Any provision of this Lease which shall prove to be invalid, void or illegal shall in no way affect, impair or invalidate any other provision hereof, and the remaining provisions hereof shall nevertheless remain in full force and effect.

30.6 Notices

The parties shall give all notices in writing by (i) personal delivery, (ii) national-recognized, next-day courier service, or (iii) first-class registered or certified mail, postage prepaid, to the Landlord's Address for Notice and Tenant's Address for Notice as set forth in Section 1.1. Without limiting the generality of the foregoing, Landlord's notices to Tenant shall not be effective if they are delivered to the Premises or to another address that is not set forth in Section 1.1(b) hereof. Any notice given under this Lease shall be deemed effective upon the date of delivery (whether accepted or refused), which, for certified mail and courier service, shall be established by U.S. Post Office return receipt or the courier's proof of delivery, respectively.

30.7 Governing Law and Venue

This Lease shall be governed by and construed in accordance with the internal laws of the State of California. Any litigation with respect to this Lease shall be conducted in the County of Los Angeles, State of California.

30.8 Waivers

No waiver by Landlord or Tenant of any provision hereof shall be deemed a waiver of any other provision hereof or of any subsequent breach by Landlord or Tenant

of the same or any other provision. Landlord's or Tenant's consent to or approval of any act shall not be deemed to render unnecessary the obtaining of Landlord's or Tenant's consent to or approval of any subsequent act by Landlord or Tenant.

30.9 Time of Essence

Time is of the essence for the performance of all of the obligations specified hereunder.

30.10 Consent

Whenever any consent is required by Landlord or Tenant hereunder, such consent shall not be unreasonably withheld, conditioned or delayed and, unless otherwise specifically provided herein, shall be deemed granted if not refused within ten (10) business days after written request is made therefore, together with all necessary information.

30.11 Community Business Enterprises

Landlord shall complete and deliver to Tenant concurrently with the execution hereof a Community Business Enterprises form set forth as Exhibit G attached hereto.

30.12 Memorandum of Lease

If requested by Tenant, Landlord and Tenant shall execute and acknowledge a Memorandum of Lease in the form of Exhibit H attached hereto, which Memorandum may be recorded by Tenant in the Official Records of Los Angeles County.

30.13 Counterparts; Electronic Signatures

This Lease and any other documents necessary for the consummation of the transaction contemplated by this Lease may be executed in counterparts, including both counterparts that are executed on paper and counterparts that are in the form of electronic records and are executed electronically. An electronic signature means any electronic sound, symbol or process attached to or logically associated with a record and executed and adopted by a party with the intent to sign such record, including facsimile or e-mail electronic signatures. All executed counterparts shall constitute one agreement, and each counterpart shall be deemed an original. The parties hereby acknowledge and agree that electronic records and electronic signatures, as well as facsimile signatures, may be used in connection with the execution of this Lease and electronic signatures, facsimile signatures or signatures transmitted by electronic mail in so-called pdf format shall be legal and binding and shall have the same full force and effect as if a paper original of this Lease had been delivered had been signed using a handwritten signature. Landlord and Tenant (i) agree that an electronic signature, whether digital or encrypted, of a party to this Lease is intended to authenticate this writing and to have the same force and effect as a manual signature, (ii) intended to be bound by the signatures (whether original, faxed or electronic) on any document sent or delivered by facsimile or, electronic mail, or other electronic means, (iii) are aware that the other party will rely on such signatures, and (iv) hereby waive any defenses to the enforcement of the terms of this Lease based on the foregoing

forms of signature. If this Lease has been executed by electronic signature, all parties executing this document are expressly consenting under the United States Federal Electronic Signatures in Global and National Commerce Act of 2000 ("E-SIGN") and California Uniform Electronic Transactions Act ("UETA")(Cal. Civ. Code § 1633.1, et seq.), that a signature by fax, email or other electronic means shall constitute an Electronic Signature to an Electronic Record under both E-SIGN and UETA with respect to this specific transaction.

31. AUTHORITY

Only the County's Board of Supervisors ("Board of Supervisors") has the authority, by formally approving and/or executing this Lease, to bind Tenant to the terms included herein. Landlord understands that no material terms of this Lease may be altered or deleted, nor may any new material terms be added to this Lease, without the express written approval of the Board of Supervisors, either through an amendment to the Lease or by other formal board action. No County officer, employee, agent or independent contractor has any authority to alter, add or delete the material terms of this Lease, and Landlord may not rely upon any representations to the contrary. This limitation of authority applies to all material terms of the Lease including, without limitation, any monetary ceiling established for Tenant Improvements or other project costs of Landlord which are subject to reimbursement by Tenant. Tenant shall not reimburse Landlord for any expenses which exceed this ceiling. Notwithstanding the foregoing, the Chief Executive Office of the County (the "Chief Executive Office") may take any administrative act on behalf of Tenant hereunder which does not have the effect of increasing Base Rent or other financial obligations of Tenant under this Lease, including without limitation, granting any approvals, terminating this Lease in the manner provided herein by an early termination notice or otherwise, signing estoppel certificates, signing the Commencement Date Memorandum and Confirmation of Lease Terms or subordinating this Lease. Each individual executing this Lease on behalf of Landlord represents and warrants that he or she is duly authorized to execute and deliver this Lease on behalf of Landlord, and that this Lease is binding upon Landlord in accordance with its terms.

32. ACKNOWLEDGEMENT BY LANDLORD

Landlord acknowledges that it is aware of the following provisions:

32.1 Consideration of GAIN Program Participants

Should Landlord require additional or replacement personnel after the effective date of this Lease, Landlord shall give consideration for any such employment openings to participants in the County Department of Public Social Services' Greater Avenues for Independence ("GAIN") Program who meet Landlord's minimum qualifications for the open position. The County will refer GAIN participants by job category to Landlord.

32.2 Solicitation of Consideration

It is improper for any County officer, employee or agent to solicit consideration in any form from a landlord. A landlord shall not offer or give, either directly or through an intermediary, consideration in any form to a County officer, employee or agent who has had any involvement in the procurement, negotiation, consummation, administration or management of a lease.

Landlord shall immediately report any attempt by a County officer, employee or agent to solicit such improper consideration. The report shall be made to the County Auditor-Controller's Employee Fraud Hotline at (800) 544-6861.

Landlord hereby represents and warrants that it has not provided, and will not provide, any financial benefits to any County official, employee or agent who has had any involvement in the procurement, negotiation, consummation, administration or management of this Lease. Landlord hereby agrees that if it violates any of the terms of this Section 32.2, then the County may declare this Lease null and void, and the County reserves the right to exercise any and all other remedies available under applicable law.

32.3 Landlord Assignment

- (a) Landlord may assign, transfer, mortgage, hypothecate or encumber Landlord's right, title and interest in and to this Lease or any portion thereof (including the right to receive rental payments but excluding its duties and obligations hereunder), and Landlord may execute any and all instruments providing for the payment of Base Rent directly to an assignee or transferee, but only if the conditions set forth in this Section are met.
- (b) Any document or agreement purporting to assign, transfer, mortgage, hypothecate or encumber Landlord's right, title and interest in and to this Lease, or any portion thereof, as security for the Landlord's obligation to repay any monetary obligation, is hereinafter referred to as a "Security Agreement." Any Security Agreement which is executed without full compliance with the requirements of this Section shall be void.
- (c) Each assignee or transferee under the Security Agreement shall certify and agree in writing that such assignee or transferee has read and is familiar with the requirements of Sections 5950-5955 of California Government Code, which prohibits the offer or sale of any security constituting a fractional interest in this Lease or any portion thereof, without the prior written consent of the Tenant. Notwithstanding the foregoing, the Tenant hereby acknowledges and agrees that Landlord shall have the right to encumber the Property with CMBS (commercial mortgage backed securities) financing or other traditional real estate financing. However, Landlord may not encumber the Property through any type of bond financing vehicle, including but not limited to certificate of participation financing.
- (d) Violation by Landlord of the provisions of Section 5951 of the California Government Code will constitute a material breach of this Lease, upon which the Tenant may impose damages in an amount equal to the greater of \$500,000 or 10% of the aggregate principal portion of all rental payments payable by the Tenant during the entire Term of this Lease, it being expressly agreed that the aforesaid amount shall be imposed as liquidated damages, and not as a forfeiture or penalty. It is further specifically agreed that the aforesaid amount is presumed to be the amount of damages sustained by reason of any such violation, because from the circumstances and nature of the violation it would be impracticable and extremely difficult

to fix actual damages. In addition, the Tenant may exercise or pursue any other right or remedy it may have under this Lease or applicable law.

- (e) Landlord shall give Tenant written notice and a copy of each and every assignment, transfer, hypothecation or encumbrance of Landlord's interest in this Lease and any instrument relating thereto (including, but not limited to, instruments providing for the payment of Base Rent directly to an assignee or transferee) at least thirty (30) days prior to the effective date thereof.
- (f) Landlord shall not furnish any information concerning Tenant or the subject matter of this Lease (including, but not limited to, offering memoranda, financial statements, economic and demographic information, and legal opinions rendered by the office of counsel for the Tenant) to any person or entity, except with Tenant's prior written consent. Landlord shall indemnify, defend and hold Tenant and its officers, agents and employees harmless from and against all claims and liability alleged to arise from the inaccuracy or incompleteness of any information furnished by Landlord in violation of this Section 32.3.
- (g) The provisions of this Section 32.3 shall be binding upon and applicable to the parties hereto and their respective successors and assigns. Whenever in this Section Landlord is referred to, such reference shall be deemed to include Landlord's successors or assigns, and all covenants and agreements by or on behalf of Landlord herein shall bind and apply to Landlord's successors and assigns, whether so expressed or not.

32.4 Smoking in County Facilities.

The Surgeon General of the United States has concluded that passive smoke exposure is the third leading cause of preventable death in the United States. The United States Environmental Protection Agency has found second-hand smoke to be a known carcinogen. It is recognized that the County has a responsibility to establish, maintain and promote a healthful and safe working environment and to reduce health and safety risks of its employees and the public at large. Tobacco smoke is a hazard to the health of County employees and the general public and represents an annoyance which should be regulated and banned in all county facilities to the end that air quality in all such facilities be improved for the preservation and improvement of the health of all County employees and the public. Therefore, to the greatest extent possible, the rights and comfort of all employees shall be respected. Reasonable effort shall be made to provide smokers a place to smoke in areas open to the sky or otherwise located outside County facilities and, except as provided under Los Angeles County, California - Code of Ordinances Chapter 2.126 ("LAMC 2.126"), all portions of County-owned facilities and all portions of facilities leased by or from the County, which areas are not open to the sky, shall be designated as "no smoking" areas. Smoking, including the use of electronic smoking devices, shall be prohibited in the following areas of County facilities: (1) Within 50 feet of any operable entry or exit door or operable window of any County building and within 25 feet of any access ramp or handicap path; (2) Within any County parking lot, parking structure, or parking garage, whether enclosed or open to the sky; or (3) Within any driving range and eating area, including outdoor eating areas, of any County golf course.

International no-smoking signs and other appropriate signs which designate no-smoking areas shall be clearly, sufficiently and conspicuously posted in every room, building or other place so covered by LAMC 2.126. The manner of such posting, including the wording, size, color and place of posting, whether on the walls, doors, tables, counters, stands or elsewhere, shall be at the discretion of the building proprietor so long as clarity, sufficiency and conspicuousness are apparent in communicating the intent. (Los Angeles County, California - Code of Ordinances Chapter 2.126.)

33. IRREVOCABLE OFFER

In consideration for the time and expense that Tenant will invest in this Lease, including but not limited to preliminary space planning, legal review, and preparation and noticing for presentation to the Tenant Real Estate Management Commission of Los Angeles County, as necessary, in reliance on Landlord's agreement to lease the Premises to Tenant under the terms of this Lease, Landlord irrevocably offers to enter into this Lease and not to revoke this offer until the Irrevocable Offer Expiration Date, as defined in Section 1.1.

IN WITNESS WHEREOF this Lease has been executed the day and year first set forth above.

LANDLORD:

NINOS I, L.P.,
a California limited partnership

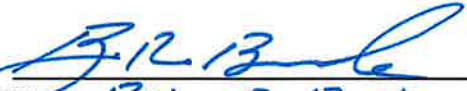
By: 
Name: Brian R. Burke
Its: President of General Partner

TENANT:

COUNTY OF LOS ANGELES,
a body corporate and politic

FESIA A. DAVENPORT
Chief Executive Officer

By: _____
John T. Cooke
Assistant Chief Executive Officer

ATTEST:

DEAN C. LOGAN
Registrar-Recorder/County Clerk
of the County of Los Angeles

By: _____
Deputy

APPROVED AS TO FORM:

DAWYN R. HARRISON
County Counsel

By: 
Senior Deputy

EXHIBIT A
FLOOR PLAN OF PREMISES

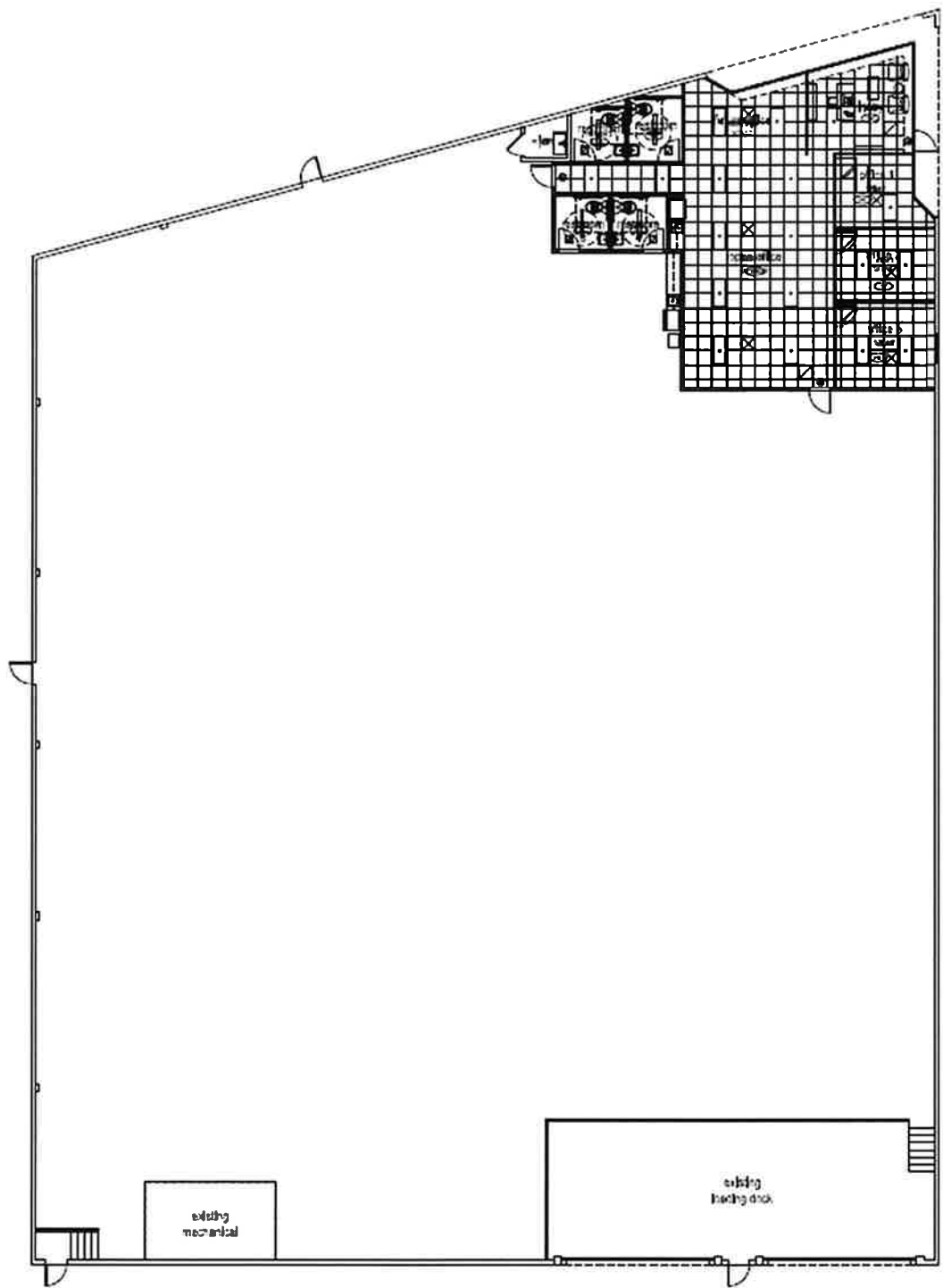

EXHIBIT B

COMMENCEMENT DATE MEMORANDUM AND CONFIRMATION OF LEASE TERMS

Reference is made to that certain Lease Agreement ("Lease") dated _____, 2023, between County of Los Angeles, a body corporate and politic ("Tenant"), and NINOS I, L.P., a California limited partnership ("Landlord"), whereby Landlord leased to Tenant and Tenant leased from Landlord certain premises in the building located at 4710 South Eastern Avenue, Bell, California 90201 ("Premises"),

Landlord and Tenant hereby acknowledge as follow:

- 4) Landlord delivered possession of the Premises to Tenant in a Substantially Complete condition on _____ ("Possession Date");
- 5) Tenant has accepted possession of the Premises and now occupies the same;
- 6) The Lease commenced on _____ ("Commencement Date");
- 7) The Premises contain _____ rentable square feet of space; and
- 8) Landlord has paid a commission in the amount of \$_____ to Tenant pursuant to Section 30.3 of the Lease.

[For clarification and the purpose of calculating future rental rate adjustments:

- 1) Base Rent per month is _____.
- 2) The Base Index month is _____.
- 3) The Base Index is _____.
- 4) The first New Index month is _____.]

IN WITNESS WHEREOF, this memorandum is executed this _____ day of _____,
2023.

Tenant:

Landlord:

COUNTY OF LOS ANGELES,
a body corporate and politic

NINOS I, L.P.,
a California limited partnership

By: _____
Name _____
Its _____

By: _____
Name _____
Its _____

EXHIBIT C

HEATING, VENTILATION AND AIR CONDITIONING

Landlord shall supply cooling, ventilating and heating with capacity to produce the following results within the office area of the Premises effective during Tenant's Hours of Operation established by the Lease and within tolerances normal in comparable office buildings; maintenance of inside space conditions of not greater than 78 degrees Fahrenheit when the outside air temperature is not more than 93 degrees Fahrenheit dry bulb and 70 degrees Fahrenheit wet bulb, and not less than 70 degrees Fahrenheit when the outside air temperature is not lower than 42 degrees Fahrenheit dry bulb. Interior space is designated at a rate of one zone for approximately each 1,000 square feet and one diffuser for each 200 square feet of usable/net square footage within the office area of the Premises. If energy requirements prohibit Landlord from complying with these requirements, Tenant shall not unreasonably withhold its consent to temporary waivers or modifications.

EXHIBIT D

INTENTIONALLY OMITTED

EXHIBIT E

**SUBORDINATION, NON-DISTURBANCE
AND ATTORNMENT AGREEMENT**

**RECORDING REQUESTED BY
AND WHEN RECORDED MAIL TO:**

County of Los Angeles
Chief Executive Office
Real Estate Division
320 W. Temple Street, 7th Floor
Los Angeles, California 90012

)
)
)
)
)
)
)

Space above for Recorder's Use

**SUBORDINATION, NON-DISTURBANCE
AND ATTORNMENT AGREEMENT**

NOTICE: THIS SUBORDINATION, NON-DISTURBANCE AND ATTORNMENT AGREEMENT RESULTS IN YOUR LEASEHOLD ESTATE BECOMING SUBJECT TO AND OF LOWER PRIORITY THAN THE LIEN OF SOME OTHER OR LATER SECURITY INSTRUMENT.

This Subordination, Non-disturbance and Attornment Agreement ("Agreement") is entered into as of the ____ day of _____, 20__ by and among COUNTY OF LOS ANGELES, a body corporate and politic ("Tenant"), [*Insert name of Landlord*], ("Borrower") and [*Insert name of Lender*], ("Lender").

Factual Background

A. Borrower owns certain real property more particularly described in the attached Exhibit A. The term "Property" herein means that real property together with all improvements (the "Improvements") located on it.

B. Lender has made or agreed to make a loan to Borrower. The Loan is or will be secured by a deed of trust or mortgage encumbering the Property (the "Deed of Trust").

C. Tenant and Borrower (as "Landlord") entered into a lease dated _____ (the "Lease") under which Borrower leased to Tenant a portion of the Improvements located within the Property and more particularly described in the Lease (the "Premises").

D. Tenant is willing to agree to subordinate certain of Tenant's rights under the Lease to the lien of the Deed of Trust and to attorn to Lender on the terms and conditions of this Agreement. Tenant is willing to agree to such subordination and attornment and other conditions, provided that Lender agrees to a non-disturbance provision, all as set forth more fully below.

Agreement

Therefore, the parties agree as follows:

1. Subordination. The lien of the Deed of Trust and all amendments, modifications and extensions thereto shall be and remain at all times a lien on the Property prior and superior to the Lease, except that if Tenant is granted any option to extend the Term of the Lease, right of first offer to lease additional premises or option to purchase the Property or right of first offer to purchase the Property in the Lease, such provisions shall not be affected or diminished by any such subordination.

2. Definitions of "Transfer of the Property" and "Purchaser". As used herein, the term "Transfer of the Property" means any transfer of Borrower's interest in the Property by foreclosure, trustee's sale or other action or proceeding for the enforcement of the Deed of Trust or by deed in lieu thereof. The term "Purchaser", as used herein, means any transferee, including Lender, of the interest of Borrower as a result of any such Transfer of the Property and also includes any and all successors and assigns, including Lender, of such transferee.

3. Non-disturbance. The enforcement of the Deed of Trust shall not terminate the Lease or disturb Tenant in the possession and use of the leasehold estate created thereby.

4. Attornment. Subject to Section 3 above, if any Transfer of the Property should occur, Tenant shall and hereby does attorn to Purchaser, including Lender if it should be the Purchaser, as the landlord under the Lease, and Tenant shall be bound to Purchaser under all of the terms, covenants and conditions of the Lease for the balance of the Lease term and any extensions or renewals of it which may then or later be in effect under any validly exercised extension or renewal option contained in the Lease, all with the same force and effect as if Purchaser had been the original landlord under the Lease. This attornment shall be effective and self-operative without the execution of any further instruments upon Purchaser's succeeding to the interest of the landlord under the Lease.

5. Lender Not Obligated. Lender, if it becomes the Purchaser or if it takes possession under the Deed of Trust, and any other Purchaser shall not:

(a) be liable for any damages or other relief attributable to any act or omission of any prior Landlord under the Lease, including Borrower, unless such act or omission continues after the date that Lender or Purchaser succeeds to the interest of such prior landlord; or

(b) be subject to any offset or defense not specifically provided for in the Lease which Tenant may have against any prior landlord under the Lease, unless resulting from a default or breach by such prior landlord which continues after Lender or Purchaser succeeds to the interest of such prior landlord; and provided that any offsets deducted by Tenant prior to the date that Lender or Purchaser succeeds to the interest of such prior landlord shall not be subject to challenge; or

(c) be bound by any prepayment by Tenant of more than one (1) month's installment of rent, unless the Lease expressly requires such prepayment; or

(d) be obligated for any security deposit not actually delivered to Purchaser; or

(e) be bound by any modification or amendment of or to the Lease which materially increases Landlord's obligations under the Lease or materially decreases Tenant's obligation under the Lease, unless Lender has approved such modification or amendment in writing, which approval shall not be unreasonably withheld, conditioned or delayed.

6. Notices. All notices given under this Agreement shall be in writing and shall be given by personal delivery, overnight receipted courier or by registered or certified United States mail, postage prepaid, sent to the party at its address appearing below. Notices shall be effective upon receipt (or on the date when proper delivery is refused). Addresses for notices may be changed by any party by notice to all other parties in accordance with this Section.

To Lender: _____

To Borrower: _____

To Tenant: County of Los Angeles
Chief Executive Office
Real Estate Division
320 W. Temple Street, 7th Floor
Los Angeles, California 90012
Attention: Director of Real Estate

7. Miscellaneous Provisions. This Agreement shall inure to the benefit of and be binding upon the parties and their respective successors and assigns. This Agreement is governed by the laws of the State of California without regard to the choice of law rules of that State.

TENANT: COUNTY OF LOS ANGELES,
a body corporate and politic

By: _____
Name: _____
Title: _____

BORROWER: *[Insert name of Landlord]*

By: _____
Name: _____
Title: _____

LENDER: *[Insert name of Lender],*

By: _____
Name: _____
Title: _____

A notary public or other officer completing this certificate verifies only the identity of the individual who signed the document to which this certificate is attached, and not the truthfulness, accuracy, or validity of that document.

STATE OF CALIFORNIA)
) SS.
COUNTY OF _____)

On _____, before me, _____
Date Name And Title Of Officer (e.g. "Jane Doe, Notary Public")

personally appeared _____,
Name of Signer(s)

who proved to me on the basis of satisfactory evidence to be the person(s) whose name(s) is/are subscribed to the within instrument and acknowledged to me that he/she/they executed the same in his/her/their authorized capacity(ies), and that by his/her/their signature(s) on the instrument the person(s), or the entity upon behalf of which the person(s) acted, executed the instrument.

I certify under PENALTY OF PERJURY under the laws of the State of California that the foregoing paragraph is true and correct.

WITNESS my hand and official seal.

Signature (Seal)

EXHIBIT F

TENANT ESTOPPEL CERTIFICATE

To: [Insert name of party to rely on document]

Attn: _____

Re: Date of Certificate: _____
 Lease Dated: _____
 Current Landlord: _____
 Located at: _____
 Premises: _____
 Commencement Date of Term: _____
 Expiration Date: _____
 Current Rent: _____

County of Los Angeles ("Tenant") hereby certifies that, to its actual knowledge, as of the date hereof:

1. Tenant is the present holder of the tenant's interest under the lease described above, as it may be amended to date (the "Lease"). The Lease covers the premises described above (the "Premises") in the building (the "Building") at the address set forth above.

2. (a) A true, correct and complete copy of the Lease (including all modifications, amendments, supplements, side letters, addenda and riders of and to it) is attached to this Certificate as Exhibit A.

 (b) The current Rent is set forth above.

 (c) The term of the Lease commenced on the Commencement Date set forth above and will expire on the Expiration Date set forth above, including any presently exercised option or renewal term. Tenant has no option or right to renew, extend or cancel the Lease, or to lease additional space in the Premises or Building, or to use any parking other than that specified in the Lease.

 (d) Except as specified in the Lease, Tenant has no option or preferential right to purchase all or any part of the Premises (or the land of which the Premises are a part).

 (e) Tenant has made no agreement with Landlord or any agent, representative or employee of Landlord concerning free rent, partial rent, rebate of rental payments or any other similar rent concession except as expressly set forth in the Lease.

3. (a) The Lease constitutes the entire agreement between Tenant and Landlord with respect to the Premises, has not been modified changed, altered or amended, except as set forth in Exhibit A, and is in full force and effect. There are no other agreements, written or oral, which affect Tenant's occupancy of the Premises.

[(b) To the knowledge of Tenant, Tenant has not given Landlord written notice of a material default under the Lease which has not been cured.]

(c) Tenant's interest in the Lease has not been assigned or encumbered.

(d) Tenant is not entitled to any credit against any rent or other charge or rent concession under the Lease, except as set forth in the Lease.

(e) No rental payments have been made more than one (1) month in advance.

4. All contributions required to be paid by Landlord to date for improvements to the Premises have been paid in full, and all of Landlord's obligations with respect to tenant improvements have been fully performed, except: _____.

IN WITNESS WHEREOF, the Tenant has executed this Tenant Estoppel Certificate as of the day set forth above.

COUNTY OF LOS ANGELES,
a body corporate and politic

By: _____
Name: _____
Title: _____

EXHIBIT G

COMMUNITY BUSINESS ENTERPRISE FORM

INSTRUCTIONS: All Landlords shall submit this form on an annual basis on or before December 30th of each year of the term of this agreement as evidence of MBE/WBE participation. The information requested below is for statistical purposes only. The final analysis and consideration of the lease will be determined without regard to race, creed, color or gender. (Categories listed below are based on those described in 49 CFR Section 23.5)

I. Minority/Women Participation in Firm (Partners, Associate Partners, Managers, Staff, etc.)						
1. Firm Name: _____				3. Contact Person/Telephone Number: _____		
2. Address: _____						
				4. Total number of employees in the firm: _____		
5. Provide the number of all minority employees and women in each category.	Owners, Partners and Associate Partners		Managers		Staff	
	All O,P & AP	Women	All Managers	Women	All Staff	Women
Black/African American						
Hispanic/Latin American						
Asian American						
Portuguese American						
American Indian/Alaskan Native						
All Others						
II. PERCENTAGE OF MINORITY/WOMEN OWNERSHIP IN FIRM						
1. Type of Business Structure: (Corporation, Partnership, Sole Proprietorship, Etc.) _____						
2. Total Number of Ownership/Partners, Etc.: _____			III. MINORITY/WOMEN-OWNED FIRM CERTIFICATION			
3. Provide the percentage of ownership in each	All Employee	Women	Is your firm currently certified as a minority owned business firm by the: State of California? <input type="checkbox"/> Yes <input type="checkbox"/> No City of Los Angeles? <input type="checkbox"/> Yes <input type="checkbox"/> No Federal Government? <input type="checkbox"/> Yes <input type="checkbox"/> No			
Black/African American						
Hispanic/Latin American						
Asian American						
Portuguese American						
American Indian/Alaskan Native						
All Others			Section D. OPTION TO PROVIDE REQUESTED INFORMATION			
			<input type="checkbox"/> We do not wish to provide the information required in this form.			
			Firm Name: _____			
			Signature/Title: _____			
			Date: _____			

EXHIBIT H

MEMORANDUM OF LEASE

**RECORDING REQUESTED BY AND
WHEN RECORDED MAIL TO:**

County of Los Angeles
Chief Executive Office
Real Estate Division
320 W. Temple Street, 7th Floor
Los Angeles, California 90012
Attention: Director of Real Estate

This document is recorded for the benefit of the County of Los Angeles and recording is exempt from recording fees pursuant to California Government Code Section 27383. This transaction is exempt from documentary transfer tax pursuant to California Revenue and Taxation Code Section 11922.

MEMORANDUM OF LEASE

This Memorandum of Lease ("Memorandum") is made and entered into by and between _____, a _____ (the "Landlord"), and the COUNTY OF LOS ANGELES, a public body corporate and politic, duly organized and existing under the laws of the State of California (the "Tenant"), who agree as follows:

Landlord and Tenant have entered into an unrecorded lease dated _____, 20__ (the "Lease") of certain real property located in the County of Los Angeles, State of California, described in Exhibit A attached hereto and incorporated herein by reference, for a term commencing on _____, 20__, and ending on a date _____ years after the commencement date, unless such term is extended or sooner terminated pursuant to the terms and conditions set forth in the Lease.

This Memorandum has been prepared for the purpose of giving notice of the Lease and of its terms, covenants, and conditions, and for no other purposes. The provisions of this Memorandum shall not in any way change or affect the provisions of the Lease, the terms of which remain in full force and effect.

Dated: _____, 20__.

LANDLORD:

NINOS I, L.P.,
a California limited partnership

By: _____
Its: _____

TENANT:

COUNTY OF LOS ANGELES,
a body corporate and politic

FESIA A. DAVENPORT
Chief Executive Officer

By: _____
John T. Cooke
Assistant Chief Executive Officer

ATTEST:

DEAN C. LOGAN
Registrar-Recorder/County Clerk
of the County of Los Angeles

By: _____
Deputy

APPROVED AS TO FORM:

DAWYN R. HARRISON
County Counsel

By: _____
Senior Deputy

A notary public or other officer completing this certificate verifies only the identity of the individual who signed the document to which this certificate is attached, and not the truthfulness, accuracy, or validity of that document.

STATE OF CALIFORNIA)
) SS.
COUNTY OF _____)

On _____, before me,

_____ Date Name And Title Of Officer (e.g. "Jane Doe, Notary Public")

personally appeared _____,
Name of Signer(s)

who proved to me on the basis of satisfactory evidence to be the person(s) whose name(s) is/are subscribed to the within instrument and acknowledged to me that he/she/they executed the same in his/her/their authorized capacity(ies), and that by his/her/their signature(s) on the instrument the person(s), or the entity upon behalf of which the person(s) acted, executed the instrument.

I certify under PENALTY OF PERJURY under the laws of the State of California that the foregoing paragraph is true and correct.

WITNESS my hand and official seal.

Signature (Seal)

EXHIBIT I

LANDLORD'S WORK LETTER

Landlord will perform the following work, at its sole cost and expense and no additional charge to Tenant:

1. Data wall outlets conduit stub-ups to accessible T-bar plenum ceiling space. (conduit and junction boxes only)
2. Telecom backboard (specs to be provided later).
3. Telecom Ground Bus Bar (specs to be provided on the low voltage plan) grounded to main electrical ground. See Detail C.
4. Two (2)-QUAD NEMA 5-20R on dedicated circuits for data equipment.
5. One (1) 125V-20A on dedicated circuit hard-wired to Intrusion Alarm panel. (will run circuit but not tie into alarm)
6. Wireless Access Points conduit run to Telecom closet. (conduit only)
7. Intrusion Alarm door contacts and motion detectors conduit run to Telecom closet. (conduit and junction boxes only)
8. Alarm Keypad, Siren and Glass Break sensors conduit/j-boxes rough ins.
9. Two (2) 125V-20A convenience outlets in the Telecom Closet.
10. Conduit & j-boxes for the Flat TV as shown on Detail 2.

Tenant will perform the following work, at its sole cost and expense:

1. One (1) 3" conduit from the MPOE to the TELCO provided POC (Point of Connection) in the street (to be determined later by TELCO provider and ISD Network Engineer).
2. One (1) 3" conduit from the MPOE to the proposed Telecom closet.
3. Power/Data pole for modular furniture. conduit and junction boxes only
4. Two (2)-3" conduit sleeves for data & intrusion alarm cable homerun to the Telecom Closet.