



MARK PESTRELLA, Director

COUNTY OF LOS ANGELES DEPARTMENT OF PUBLIC WORKS

"To Enrich Lives Through Effective and Caring Service"

900 SOUTH FREMONT AVENUE
ALHAMBRA, CALIFORNIA 91803-1331
Telephone (626) 458-5100
<http://dpw.lacounty.gov>

ADDRESS ALL CORRESPONDENCE TO:
P.O. BOX 1460
ALHAMBRA, CALIFORNIA 91802-1460

IN REPLY PLEASE
REFER TO FILE

ADOPTED

BOARD OF SUPERVISORS
COUNTY OF LOS ANGELES

48 January 5, 2021

CELIA ZAVALA
EXECUTIVE OFFICER

January 05, 2021

The Honorable Board of Supervisors
County of Los Angeles
383 Kenneth Hahn Hall of Administration
500 West Temple Street
Los Angeles, California 90012

Dear Supervisors:

**TRANSPORTATION CORE SERVICE AREA
TRAFFIC REGULATIONS IN THE UNINCORPORATED
COMMUNITIES OF ALTADENA, CASTAIC, COVINA, DEL SUR, LLANO, ROOSEVELT, AND
STEVENSON RANCH
(SUPERVISORIAL DISTRICT 5)
(3 VOTES)**

SUBJECT

Public Works is seeking Board approval to implement traffic regulations to support traffic safety, enhance traffic flow and street sweeping services, and provide parking for disabled persons in the unincorporated communities of Altadena, Castaic, Covina, Del Sur, Llano, Roosevelt, and Stevenson Ranch.

IT IS RECOMMENDED THAT THE BOARD:

1. Find that adopting traffic regulation orders and posting the corresponding regulatory and advisory signage are categorically exempt from the provisions of the California Environmental Quality Act.
2. Adopt a traffic regulation order requiring for eastbound and westbound traffic on Mariposa Street at its intersection with Santa Anita Avenue, establishing all-way stop control in the unincorporated community of Altadena.
3. Adopt a traffic regulation order establishing a disabled person's parking zone on the east side of Glenrose Avenue between a point 45 feet and a point 65 feet south of Laun Street in the unincorporated community of Altadena.

4. Adopt a traffic regulation order prohibiting parking for street sweeping purposes from 7 a.m. to 11 a.m., Thursdays only, on the east side of Casitas Avenue from Woodbury Road to a point 575 feet south of Woodbury Road in the unincorporated community of Altadena.
5. Adopt a traffic regulation order prohibiting parking from 10 p.m. to 6 a.m. along both sides of Fair Oaks Avenue between Woodbury Road and the City of Pasadena boundary in the unincorporated community of Altadena.
6. Adopt a traffic regulation order prohibiting parking for street sweeping purposes from 7 a.m. to 11 a.m., Thursdays only, on the north side of Sacramento Street between Raymond Lane and Marengo Avenue in the unincorporated community of Altadena.
7. Adopt a traffic regulation order prohibiting parking for street sweeping purposes from 7 a.m. to 11 a.m., Fridays only, on the south side of Sacramento Street between Raymond Lane and Marengo Avenue in the unincorporated community of Altadena.
8. Adopt a traffic regulation order prohibiting parking for street sweeping purposes from 7 a.m. to 11 a.m., Tuesdays only, on the north side of Sacramento Street between North Lake Avenue and a point 350 feet west of North Lake Avenue in the unincorporated community of Altadena.
9. Adopt a traffic regulation order prohibiting parking for street sweeping purposes from 7 a.m. to 11 a.m., Thursdays only, on the south side of Sacramento Street between a point 350 feet west of North Lake Avenue and North Lake Avenue in the unincorporated community of Altadena.
10. Adopt a traffic regulation order prohibiting stopping at any time along the east side of Chaney Trail between a point 1800 feet north of Loma Alta Drive and Loma Alta Drive in the unincorporated community of Altadena.
11. Adopt a traffic regulation order requiring eastbound and westbound traffic on Sloan Canyon Road to stop at its intersection with Parker Road, establishing all-way stop control in the unincorporated community of Castaic.
12. Adopt a traffic regulation order prohibiting commercial vehicles over 3 tons on Rancho La Floresta Road between Rancho Del Monico Road and its northern terminus in the unincorporated community of Covina.
13. Adopt a traffic regulation order prohibiting commercial vehicles over 3-tons on Rancho Del Monico Road between Covina Hills Road and its northern terminus in the unincorporated community of Covina.
14. Adopt a traffic regulation order prohibiting commercial vehicles over 3-tons on Rancho La Carlota Road between its southerly terminus and Rancho Del Monico Road in the unincorporated community of Covina.
15. Adopt a traffic regulation order requiring southbound traffic on Sierra Highway to stop at its intersection with Avenue G establishing all-way stop control in the unincorporated community of Del Sur.
16. Adopt a traffic regulation order requiring eastbound and westbound traffic on Avenue J to stop at its intersection with 90th Street West, establishing all-way stop control in the unincorporated community of Del Sur.

17. Adopt a traffic regulation order establishing a stop control for eastbound and westbound traffic on Avenue X at its intersection with 165th Street East in the unincorporated community of Llano.

18. Adopt a traffic regulation order requiring eastbound and westbound traffic on Avenue I to stop at its intersection with 70th Street East, establishing all-way stop control in the unincorporated community of Roosevelt.

19. Adopt a traffic regulation order establishing a stop control for northbound traffic on Webster Place to stop at its intersection with Wordsworth Lane in the unincorporated community of Stevenson Ranch.

20. Adopt a traffic regulation order establishing a stop control for northbound traffic on London Place to stop at its intersection with Wordsworth Lane in the unincorporated community of Stevenson Ranch.

21. Adopt a traffic regulation order establishing a stop control for southbound traffic on Hammet Circle (East) to stop at its intersection with Wordsworth Lane in the unincorporated community of Stevenson Ranch.

22. Adopt a traffic regulation order establishing a stop control for southbound traffic on Hammet Circle (West) to stop at its intersection with Wordsworth Lane in the unincorporated community of Stevenson Ranch.

23. Adopt a traffic regulation order establishing a stop control for southbound traffic on Sandburg Place to stop at its intersection with Hammet Circle in the unincorporated community of Stevenson Ranch.

24. Adopt a traffic regulation order establishing a stop control for southbound traffic on Topper Court to stop at its intersection with Hammet Circle in the unincorporated community of Stevenson Ranch.

PURPOSE/JUSTIFICATION OF RECOMMENDED ACTION

The purpose of the recommended actions is to support traffic safety, enhance traffic flow and street sweeping services, and provide parking for disabled persons. Requests for these traffic regulations were generated by residents or community groups. The affected areas are indicated on the enclosed maps (Attachments K to S).

Implementation of Strategic Plan Goals

These recommendations support the County Strategic Plan: Strategy II.3, Make Environmental Sustainability our Daily Reality. The recommended actions support a clean, flexible, and integrated Multi-Modal Transportation System that improves mobility and traffic safety.

FISCAL IMPACT/FINANCING

There will be no impact to the County General Fund. Sufficient funds are included in the Road Fund Fiscal Year 2020-21 Budget to cover the minor costs of removing and installing the necessary signs and markings.

FACTS AND PROVISIONS/LEGAL REQUIREMENTS

The California Vehicle Code authorizes the Board to implement these traffic regulations, which are required prior to enforcement by the California Highway Patrol and the Sheriff's Department.

ENVIRONMENTAL DOCUMENTATION

The establishment of these regulations, including the installation of related traffic control devices required to notify the motoring public, is categorically exempt from the provisions of the California Environmental Quality Act pursuant to Section 15301(c) of the California Environmental Quality Act Guidelines and Class I(x) 7 of the Environmental Reporting Procedures and Guidelines approved by the Board on November 17, 1987.

IMPACT ON CURRENT SERVICES (OR PROJECTS)

Implementation of these traffic controls will have a positive impact by enhancing traffic flow and safety. Upon the Board's approval of these traffic regulations, the corresponding signs and markings will be installed within 12 weeks.

CONCLUSION

Please return one adopted copy of this letter to Public Works, Traffic Safety and Mobility Division. Also, please forward adopted copies of this letter to the Sheriff's Department; Contract Law Enforcement Bureau; Field Operations Support Services; and Parking Enforcement Detail; and the California Highway Patrol's Lancaster, Altadena, and Newhall offices.

Respectfully submitted,

A handwritten signature in black ink, appearing to read "Mark Pestrella", written in a cursive style.

MARK PESTRELLA

Director

MP:EKT:dj

Enclosures

c: Chief Executive Office (Chia-Ann Yen)
County Counsel
Executive Office

● Indicates the location/recommendation number in the Board letter.

**ATTACHMENT L
PROPOSED TRAFFIC REGULATIONS
ALTADENA
SUPERVISORIAL DISTRICT 5**



● Indicates the location/recommendation number in the Board letter.

**ATTACHMENT M
PROPOSED TRAFFIC REGULATION
ALTADENA
SUPERVISORIAL DISTRICT 5**

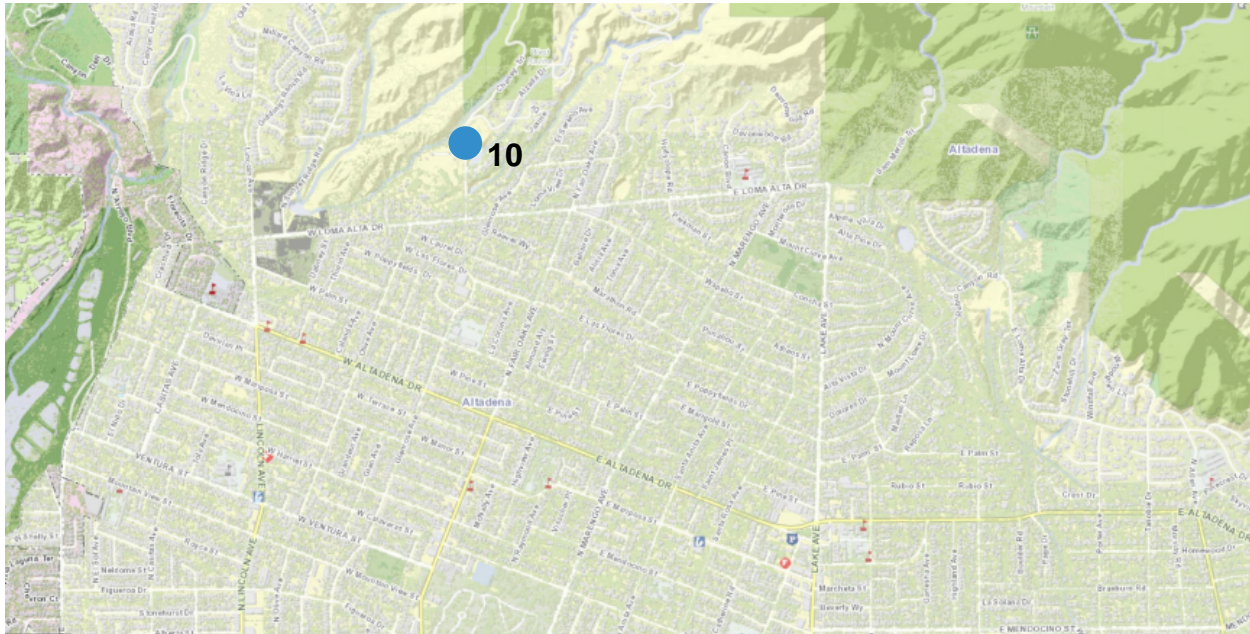

● Indicates the location/recommendation number in the Board letter.

**ATTACHMENT N
PROPOSED TRAFFIC REGULATIONS
ALTADENA
SUPERVISORIAL DISTRICT 5**

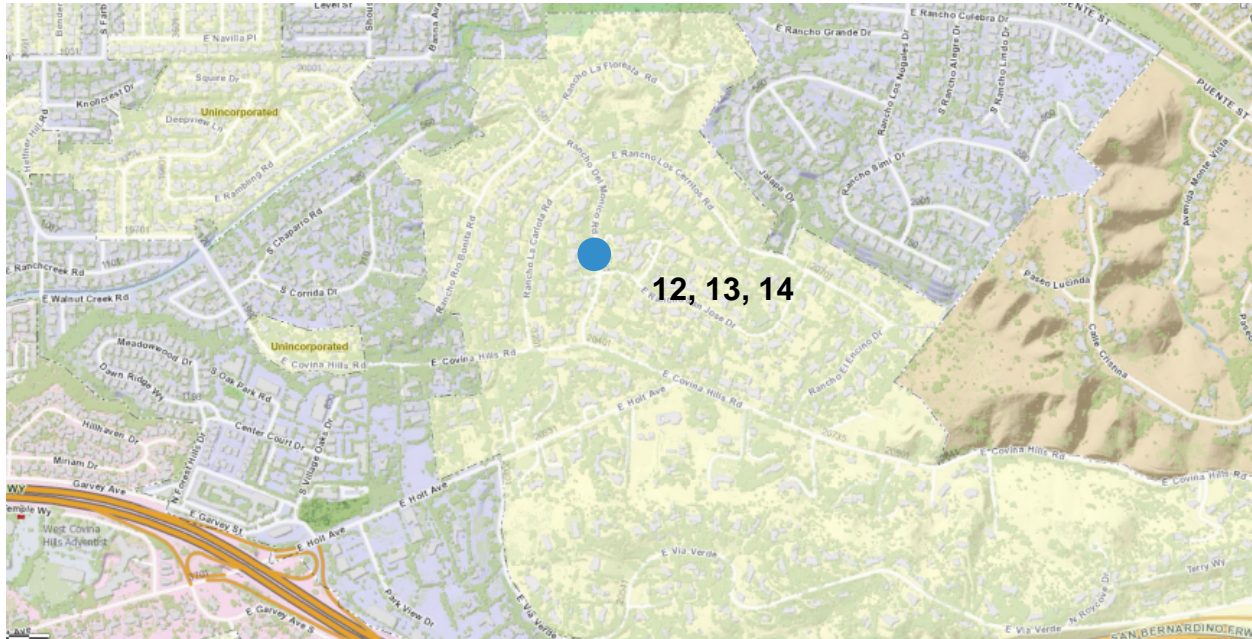

● Indicates the location/recommendation number in the Board letter.

**ATTACHMENT O
PROPOSED TRAFFIC REGULATION
CASTAIC
SUPERVISORIAL DISTRICT 5**

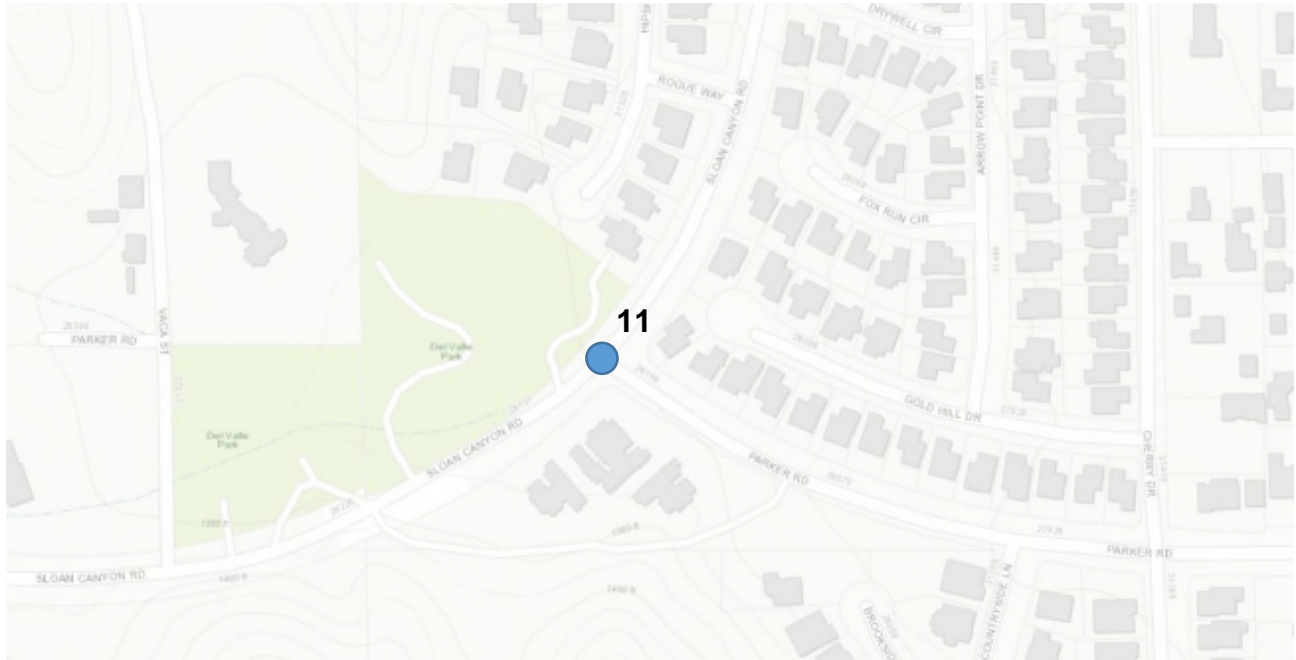

● Indicates the location/recommendation number in the Board letter.

**ATTACHMENT P
PROPOSED TRAFFIC REGULATIONS
DEL SUR
SUPERVISORIAL DISTRICT 5**

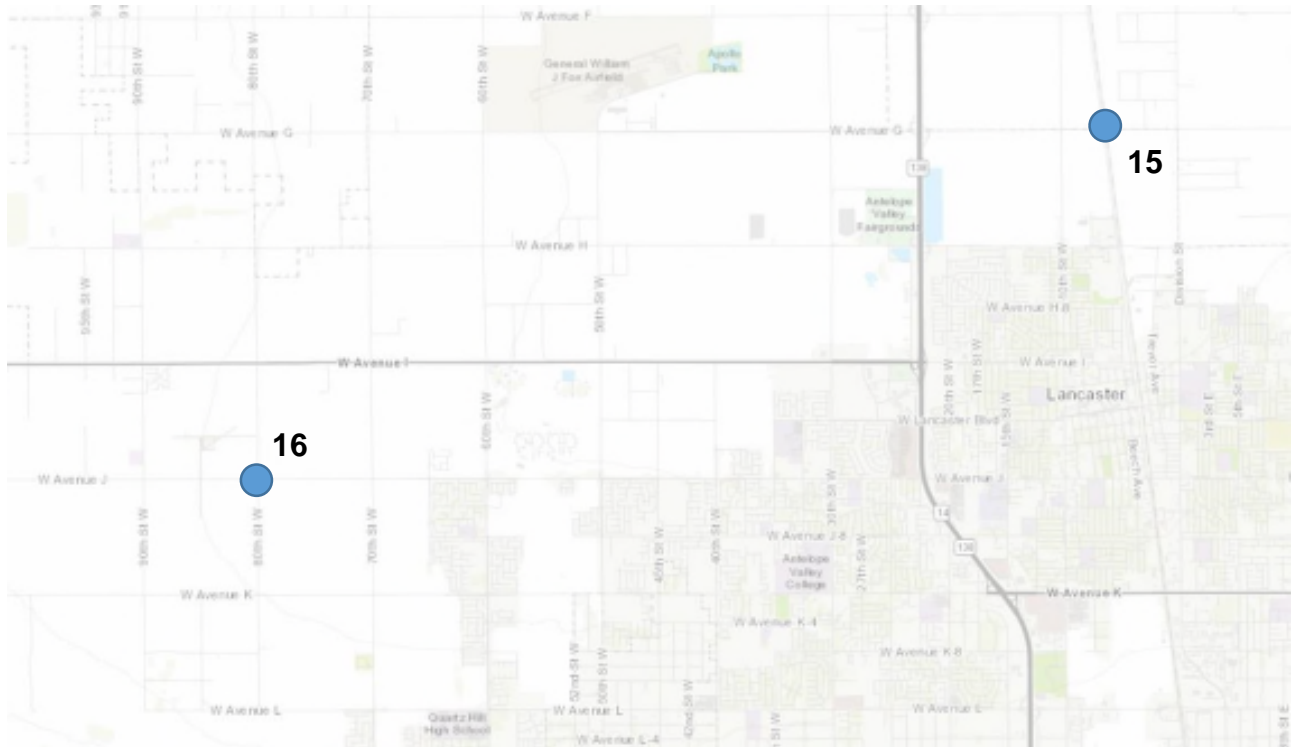

● Indicates the location/recommendation number in the Board letter.

**ATTACHMENT Q
PROPOSED TRAFFIC REGULATION
LLANO
SUPERVISORIAL DISTRICT 5**

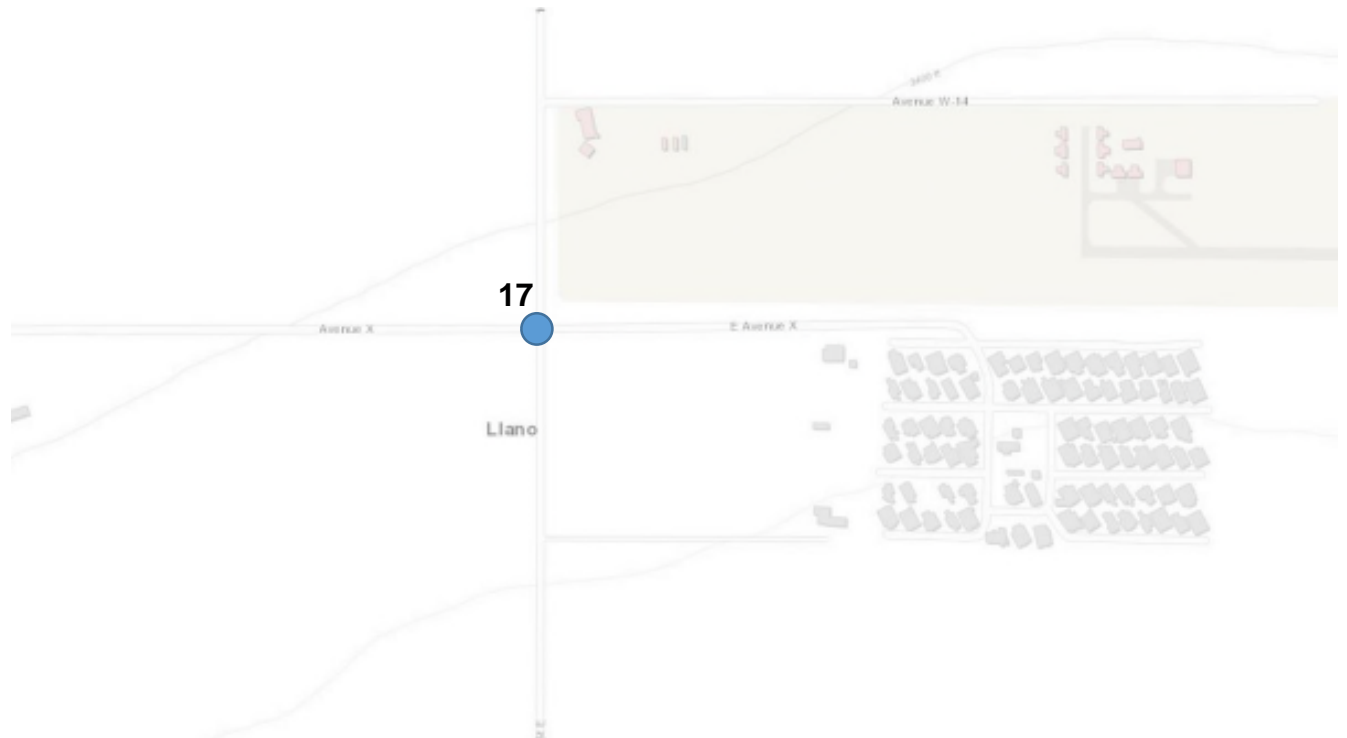

● Indicates the location/recommendation number in the Board letter.

**ATTACHMENT R
PROPOSED TRAFFIC REGULATION
ROOSEVELT
SUPERVISORIAL DISTRICT 5**

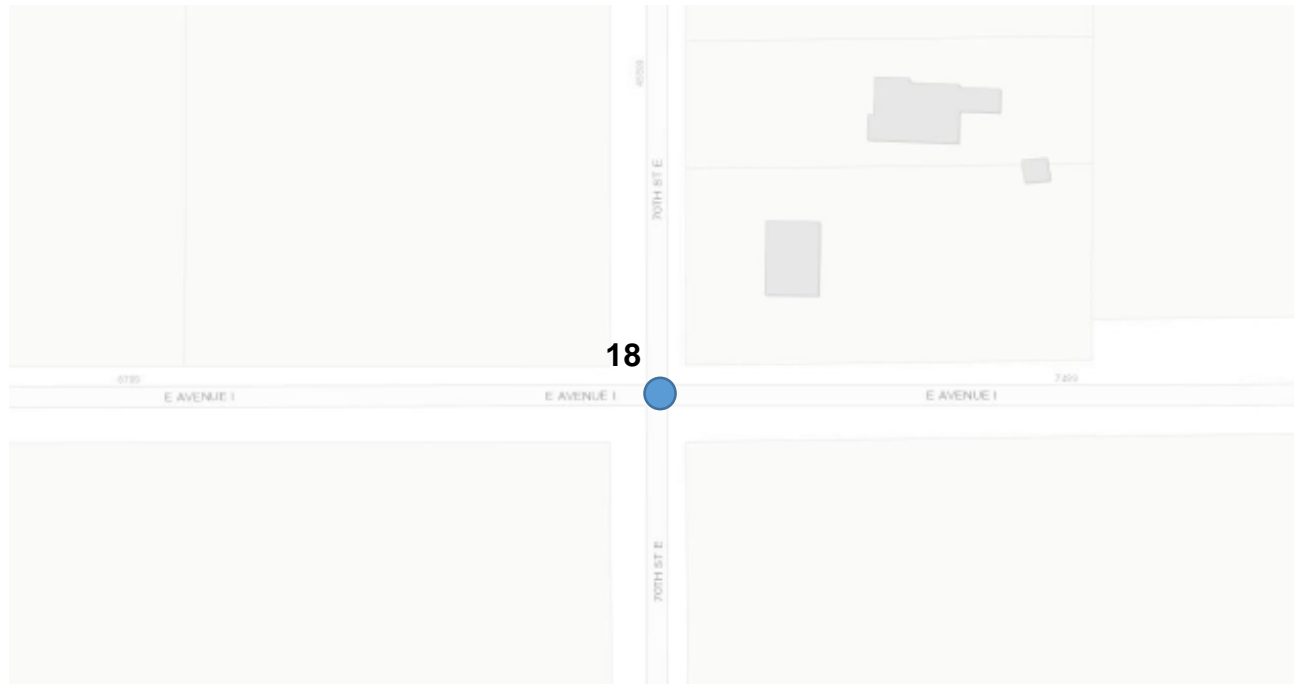

● Indicates the location/recommendation number in the Board letter.

**ATTACHMENT S
PROPOSED TRAFFIC REGULATIONS
STEVENSON RANCH
SUPERVISORIAL DISTRICT 5**

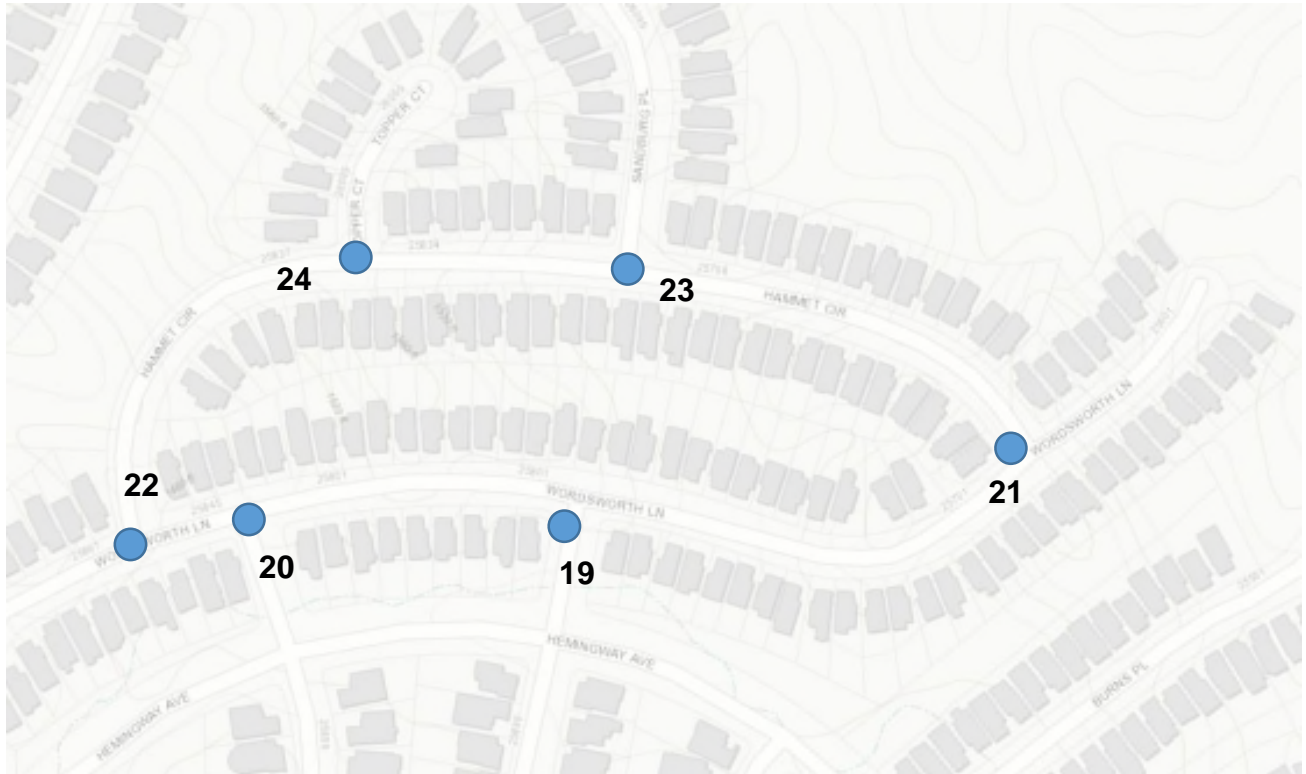

● Indicates the location/recommendation number in the Board letter.