

# DOORS

## COMMUNITY REENTRY CENTER

Developing Opportunities and Offering Reentry Solutions

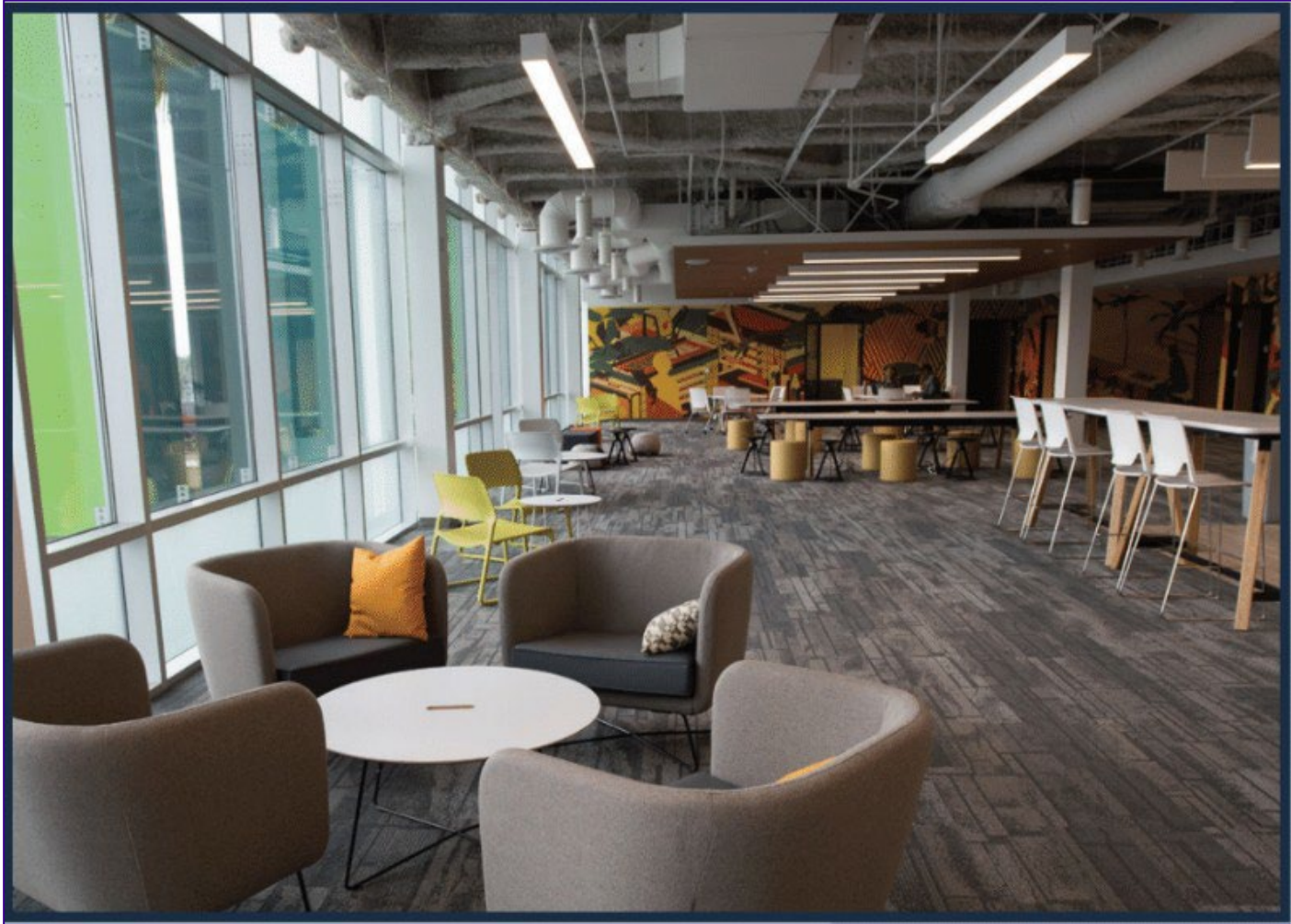

The **Community Reentry Center (CRC)** at DOORS provides an array of comprehensive supportive services to address the barriers to reentry for justice-involved individuals, particularly those on adult felony supervision, their families and the community. Such services include but are not limited to housing, employment, legal aid, educational support, mental health assessment and linkage, substance use counseling, and health and healing through the arts. The services are provided in a welcoming environment by county partners and community-based organizations that are considered leaders in reentry and experienced professionals with high-risk communities.



## OUR VISION

An inclusive community where everyone impacted by the justice system can thrive and fully participate in society.

## CENTER SERVICES

- Housing (Crisis Stabilization)
- Benefits Establishment
- Employment Support & Placement
- Education (GED/High School Diploma Program)
- Self-Help Groups (i.e., Anger Management & Parenting)
- Substance Abuse Assessment & Treatment Linkage
- Mental Wellness Linkage/Med. Support
- Legal Aid Support
- Visitation Monitoring
- Intensive Case Management
- Healing through the Arts
- Computer Lab
- Ancillary Services (i.e., Hygiene & Wellness Kits)

## LOCATION

3965 Vermont Avenue Los Angeles, CA 90037  
3rd Floor Reception: 323-730-4442  
[cstephens@jcod.lacounty.gov](mailto:cstephens@jcod.lacounty.gov)

## CENTER OPERATION HOURS (Modified)

Individuals (Clients/Consumers/Patients) and Community Organizations (Providers) can call directly to the DOORS line at **323-730-4442** at the following:

Monday-Friday 8:00am-12:00pm (to speak to a live person from DOORS team to take referral over the phone)

Or anytime after 12:00pm -5:00pm to leave a message on the voicemail that is followed up within 2 hours by DOORS Administrative Team

Community/Walk-In Referral can be submitted by Community Providers/Organizations via

email [rocdoorsreferral@jcod.lacounty.gov](mailto:rocdoorsreferral@jcod.lacounty.gov)

RUU referrals submitted by Probation DPOs only should continue to be sent to [rocdoorsreferral@jcod.lacounty.gov](mailto:rocdoorsreferral@jcod.lacounty.gov)

# CENTER SERVICES

## **HOUSING/INTENSIVE CASE MANAGEMENT AND SUBSTANCE ABUSE SCREENING**

SSG/HOPICS assists with placement into interim and permanent housing, systems navigation support and case management, referrals to behavioral health and trauma focused services, and screening for substance abuse and program linkage.

[www.hopics.org](http://www.hopics.org)

## **EMPLOYMENT**

The Chrysalis Center works with individuals to identify, prepare for and maintain employment.

[www.changelives.org](http://www.changelives.org)

## **LEGAL SUPPORT**

Legal Aid Foundation of LA provides legal assistance in the following areas: post-conviction/criminal record; housing; immigration; general law enforcement; family law; and consumer law.

[www.lafla.org](http://www.lafla.org)

## **EDUCATION/SOCIAL SKILLS TRAINING**

Five Keys Schools and Programs provides test preparation and financial assistance with testing fees for students in pursuit of their GED or High School diploma. Five Keys also offers social skills training in Parenting and Anger Management education.

[www.fivekeyscharter.org](http://www.fivekeyscharter.org)

## **CASE MANAGEMENT/FAMILY REUNIFICATION SERVICES**

A New Way of Life provides family preservation/reunification services including case management, DCFS system navigation, linkage to legal support for child custody issues, visitation monitoring, and education/advocacy.

[www.anewwayoflife.org](http://www.anewwayoflife.org)

## **VISUAL ART, EXPRESSIVE WRITING, POETRY, DRAMA, DANCE AND MUSIC**

Somos Los Arte Academy provides workshops, groups and trainings to engage clients and promote healing through the arts.

## **COMMUNITY OUTREACH AND ENGAGEMENT**

The Los Angeles Regional Reentry Partnership provides information and access to services for the reentry community. [www.lareentry.org](http://www.lareentry.org)

## **INVEST/WORKFORCE DEVELOPMENT, AGING AND COMMUNITY SERVICES(WDACS)**

Employment opportunities with Fair Chance employers and vocational training.

[www.wdacs.lacounty.gov](http://www.wdacs.lacounty.gov)

## **DEPARTMENT OF MENTAL HEALTH**

Mental Health Screening, Support Groups and Linkage

[www.dmh.lacounty.gov](http://www.dmh.lacounty.gov)

## **DEPARTMENT OF PUBLIC SOCIAL SERVICES**

Providing Benefit Eligibility Screening, Establishment and Support

[www.dpss.lacounty.gov](http://www.dpss.lacounty.gov)

## **PROBATION DEPARTMENT (ROC/REENTRY OPPORTUNITY CENTER)**

1st and 2nd Floor

[www.probation.lacounty.gov](http://www.probation.lacounty.gov)

---