

# WILLOWBROOK

## Community Parks & Recreation Plan



### PURPOSE OF THE PLAN

The Willowbrook Community Parks and Recreation Plan provides a vision and road map for a greener Willowbrook, including a key focus on the revitalization of Earvin 'Magic' Johnson Recreation Area at the heart of the community and the development of a more extensive network of publicly-accessible pedestrian corridors, green spaces, and recreational facilities. The plan includes recommendations for increasing access to parks and enhancing existing recreational facilities to meet community-identified needs. The plan builds on previous planning efforts and includes specific implementation actions to be taken by the County to improve parks and recreation in the community.

### ENVIRONMENTAL BENEFITS OF EXISTING PARKS

3.3 million  
gallons of  
stormwater  
intercepted  
annually

3,000  
pounds of  
reduced air  
pollutants  
annually

340,000  
tons of CO<sub>2</sub>  
sequestered  
annually

### PARKS AND GREENING PROFILE

Willowbrook has seven parks, totaling 142 acres of parkland. However, 98 acres are within Earvin 'Magic' Johnson Recreation Area, which is a regional facility designed to accommodate use by County residents up to 20 miles away. The other six parks in the community are intended to serve more local park needs. The Los Angeles County General Plan sets a standard of 4 acres of local parks per 1,000 residents. Willowbrook currently has a population of nearly 36,000 residents and approximately 44 acres of local parkland, which translates to **1.23 acres of local parks per 1,000 residents**, a figure below the General Plan standard.

Access to existing parkland in Willowbrook is not consistent throughout the community. **About 46 percent of the Willowbrook population is not within walking distance (1/2 mile) of a park.** Due to various socioeconomic conditions, including relatively low incomes, low levels of car ownership, and high crime, as well as a challenging pedestrian and bicycle environment, Willowbrook is in high need of a community-based vision and master plan for parks and urban greening.

### Where are Parks Most Needed in Willowbrook?

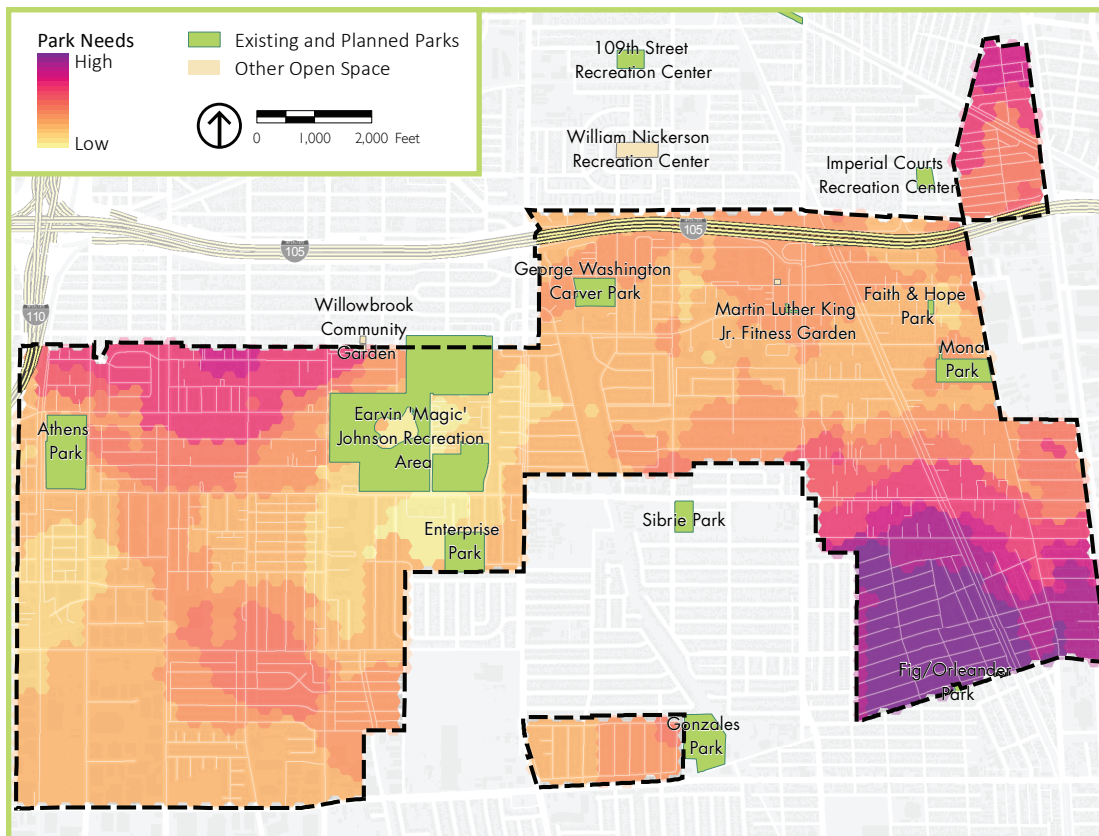

Community Bike Tour.



Priority Voting at Outreach Fair.



## WILLOWBROOK GREEN VISION MAP

This map identifies potential park, trail, and greening projects that may be implemented in the short, medium, and/or long term to meet the needs of Willowbrook.

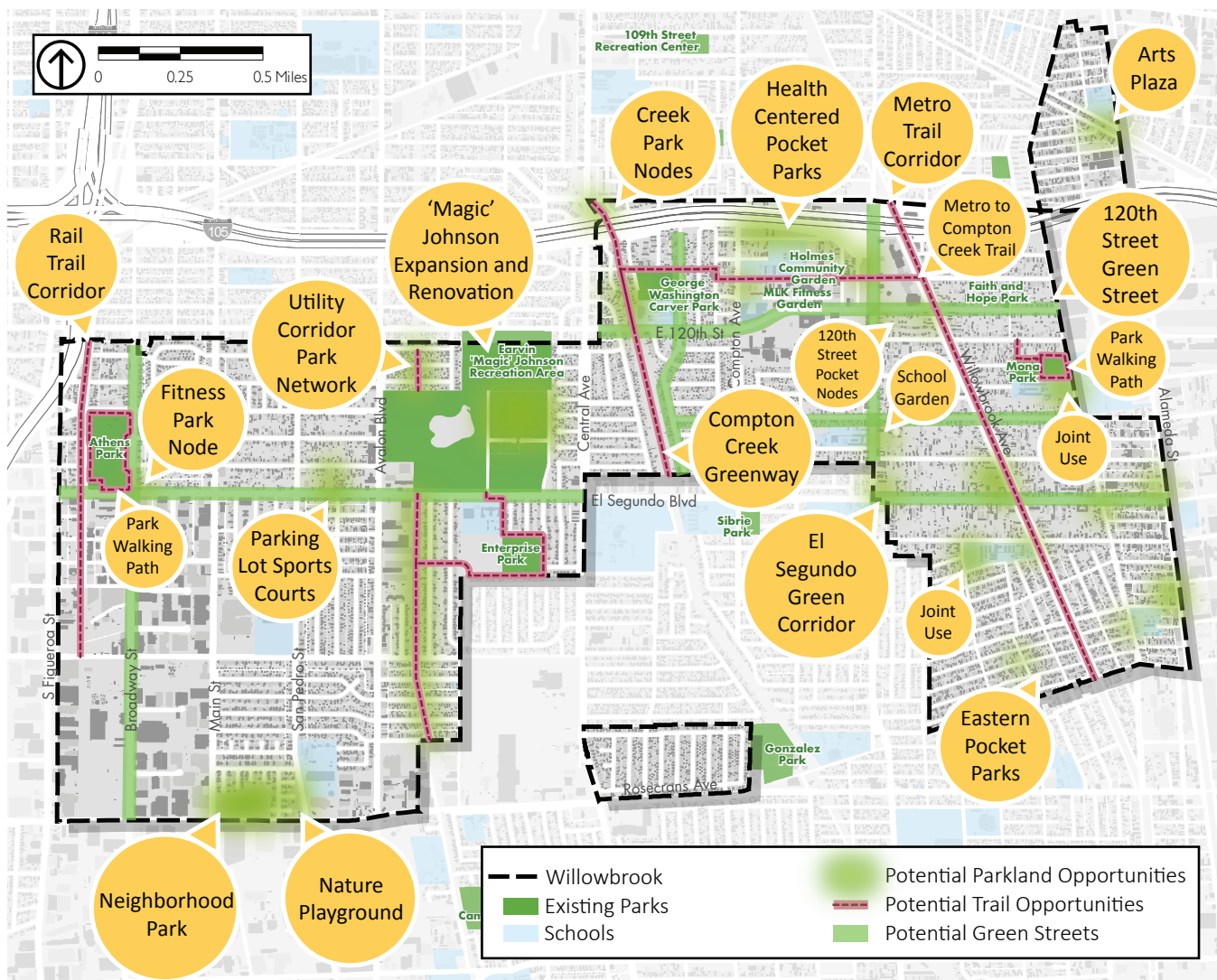

## CURRENT AND FUTURE CONNECTIONS

## SITE IDENTIFICATION PROCESS

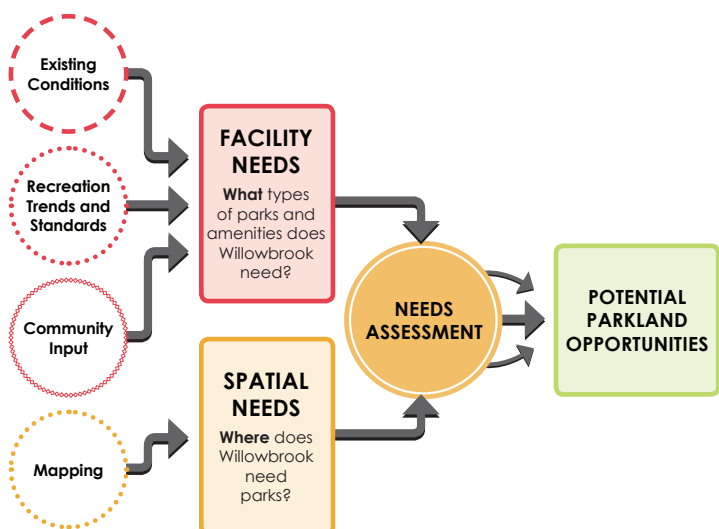



## GOALS FOR WILLOWBROOK

1. Create a regional and local hub at Earvin 'Magic' Johnson Recreation Area.
2. Improve access to existing parkland system by creating safe corridors for pedestrians, cyclists, and equestrians, and developing a greenway network.
3. Provide all residents with safe places to walk for exercise.
4. Ensure that recreational facilities and programs meet community needs and that residents are included in the decision-making process.
5. Improve actual and perceived safety of Willowbrook's parkland system.
6. Expand the recreational opportunities within Willowbrook's park system to incorporate more arts and cultural activities, as well as healthy food and lifestyle amenities.
7. Increase the sense of nature within the parkland system and in the everyday lives of Willowbrook residents.
8. Maintain and enhance Willowbrook's urban forest.
9. Focus on multi-benefit urban greening projects that optimize environmental services.

### Proposed Master Plan for Earvin 'Magic' Johnson Recreation Area

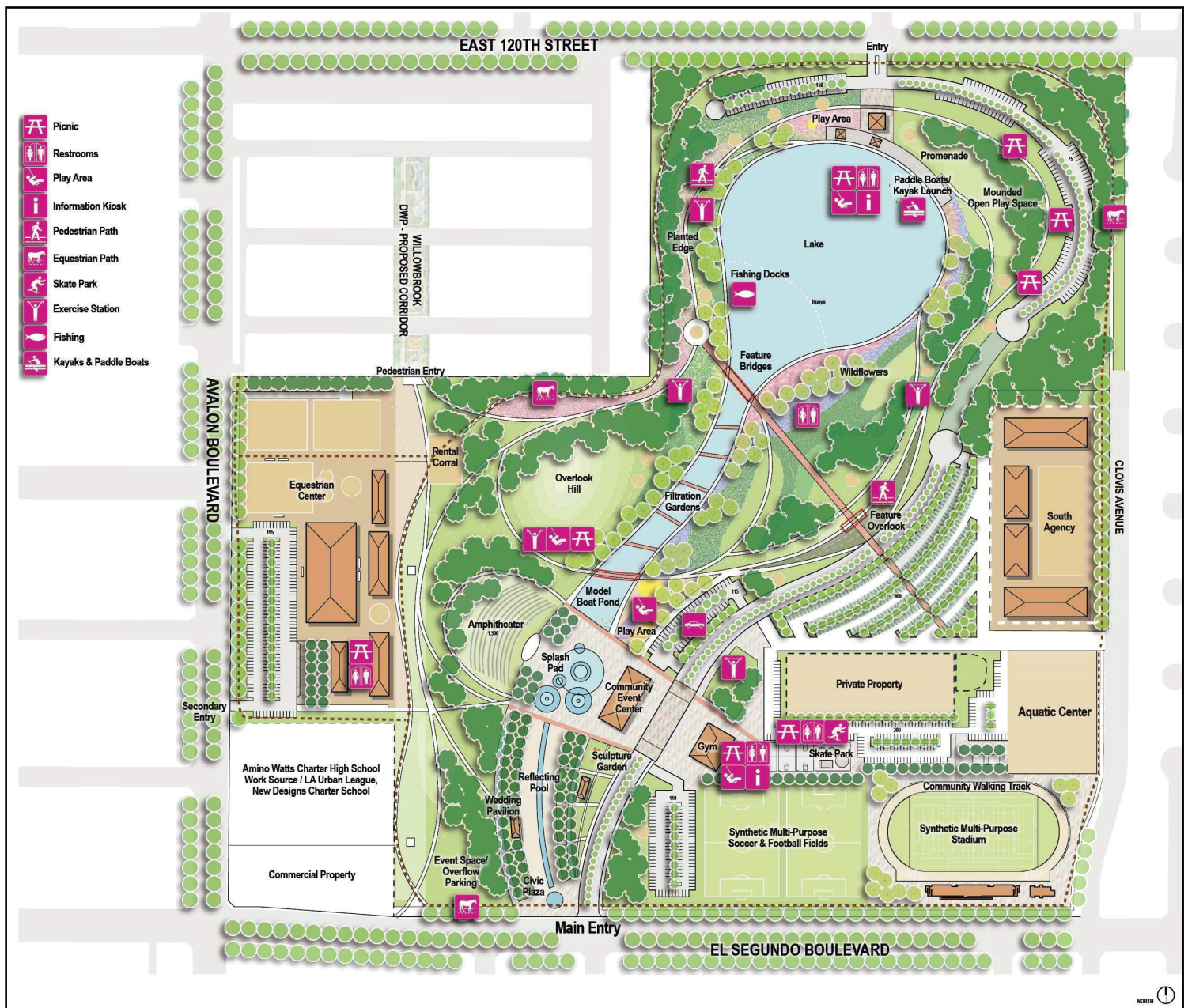



# A VISION FOR WILLOWBROOK'S WALKING PATHS AND TRAILS

Rail and Trail Corridors



Compton Creek Corridor



Utility Corridor



Sidewalk Trails



**For more information, contact:**  
 Clement Lau, AICP, Departmental Facilities Planner  
 County of Los Angeles Department of Parks and Recreation  
 Tel: (213) 351-5120; E-mail: [clau@parks.lacounty.gov](mailto:clau@parks.lacounty.gov)