



LOS ANGELES COUNTY
**DEPARTMENT OF
MENTAL HEALTH**
hope. recovery. wellbeing.

For Easy & Secure Access to
Your Mental Health Record

Visit Us Online at:
Just4me.dmh.lacounty.gov

How to sign up for the Just4me Client Portal

- You'll need a PIN and an email address
- You will receive a PIN like this one from the Front Desk



- Go to **Just4me.dmh.lacounty.gov**
- Find the **Click Here to Log In** button
- Select **Create an Account**



- Enter your information including your **PIN** and create a password

Welcome to the Patient Portal

To get started, simply complete the below fields to gain access to valuable information and services provided in a secure and confidential manner.

Please note: To be able to access your medical records within the Patient Portal, you must have been seen by a participating physician and have received a secure PIN from your doctor.

Email

Password Hide
Passwords must be at least 8 characters long.

Register Self Dependent(s) No PIN

PIN
PIN is case sensitive

- At the bottom, you will see a link to the Terms & Conditions. After reading them, click on the **I have read and agree to the Terms & Conditions** box and select **Complete**
- You will receive a Registration Successful pop up. If your email address is correct then select **Confirm**



- You are now in the Client Portal and have received a Welcome letter – click **OK**

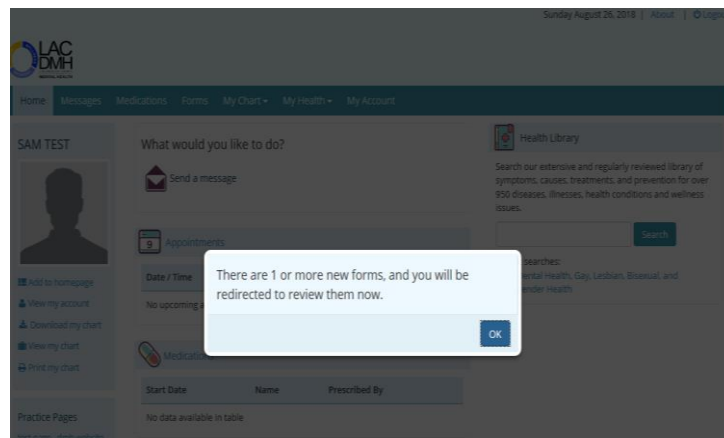

- Scroll down and read through it and then click **Submit**
- Take a look around and make sure to always **Logout** when you're finished

