

DOORS COMMUNITY REENTRY CENTER

.....
Developing Opportunities and Offering Reentry Solutions

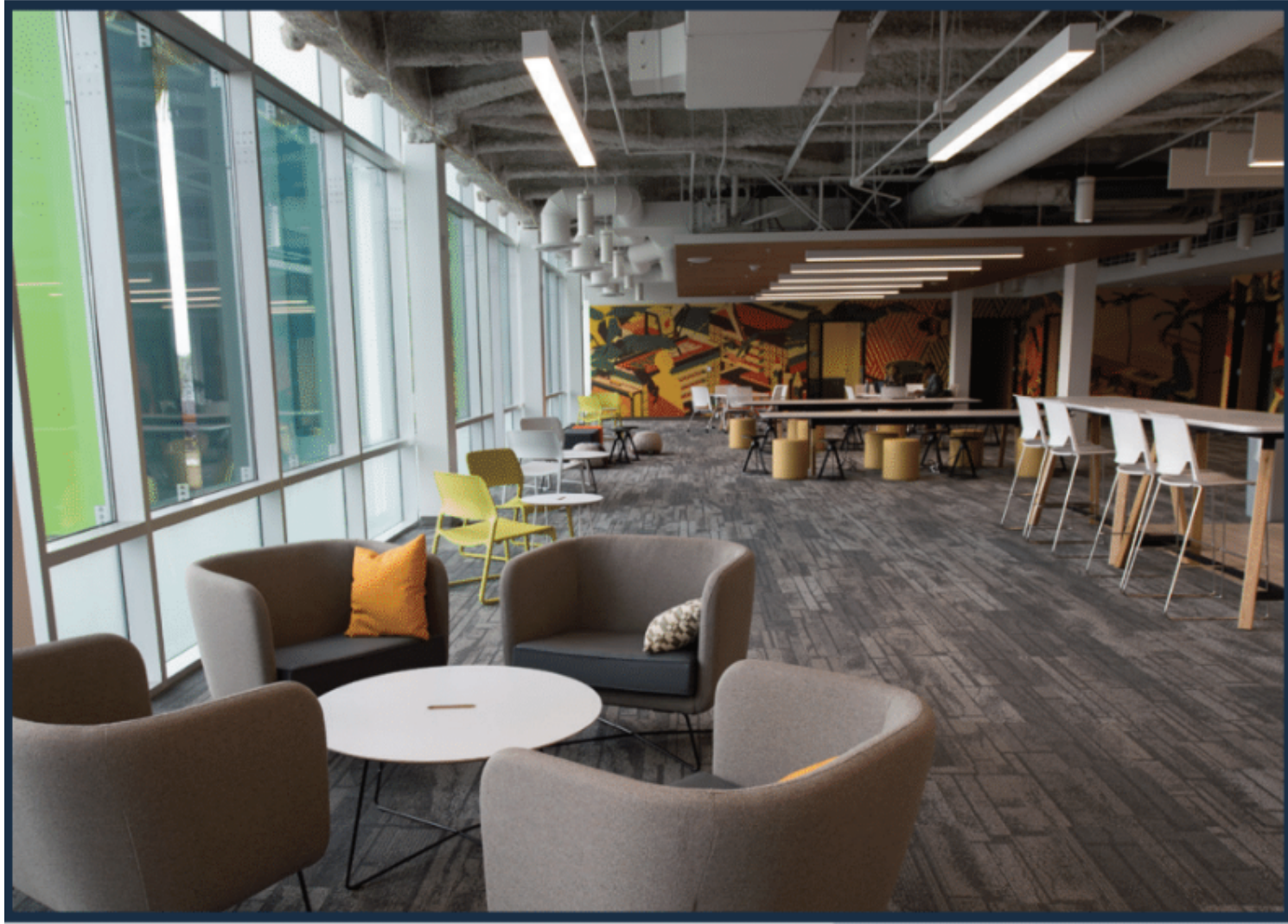

The Community Reentry Center (CRC) at DOORS provides an array of comprehensive supportive services to address the barriers to reentry for justice-involved individuals, particularly those on adult felony supervision, their families and the community. Such services include but are not limited to housing, employment, legal aid, educational support, mental health assessment and linkage, substance use counseling, and health and healing through the arts. The services are provided in a welcoming environment by county partners and community-based organizations that are considered leaders in reentry and experienced professionals with high risk communities.



OUR VISION

An inclusive community where everyone impacted by the justice system can thrive and fully participate in society.

CENTER SERVICES

- Housing (Crisis and Permanent)
- Benefits Establishment
- Employment Support
- Education (GED/High School Diploma Program)
- Substance Abuse Counseling and Treatment Linkage
- Mental Wellness Counseling
- Legal Aid Support
- Visitation Monitoring
- Intensive Case Management
- Healing through the Arts
- Community Events
- Computer Lab

LOCATION

3965 Vermont Avenue
Los Angeles, CA 90037
3rd Floor Reception: 323-730-4442
cstephens@dhs.lacounty.gov

CENTER OPERATION HOURS COVID-19 UPDATED HOURS

Individuals (Clients/Consumers/Patients) and Community Organizations (Providers) can call directly to the DOORS line at 323-730-4442 at the following:

Monday-Friday 8:00am-12:00pm (to speak to a live person from ODR DOORS team to take referral over the phone)

Or anytime after 12:00pm -5:00pm to leave a message on the voicemail that is followed up within 2 hours by ODR DOORS Administrative Team

Community/Walk In Referral can be submitted by Community Providers/Organizations via email rocdoorsreferral@dhs.lacounty.gov
RUU referrals submitted by Probation DPOs only should continue to be sent to rocdoorsreferral@dhs.lacounty.gov

CENTER SERVICES



HOUSING/INTENSIVE CASE MANAGEMENT AND SUBSTANCE ABUSE SCREENING

SSG/HOPICS assists with placement into interim and permanent housing, systems navigation support and case management, referrals to behavioral health and trauma focused services, and screening for substance abuse and program linkage.

www.hopics.org

EMPLOYMENT

The Chrysalis Center works with individuals to identify, prepare for and maintain employment.

www.changelives.org

LEGAL SUPPORT

Legal Aid Foundation of LA provides legal assistance in the following areas: post-conviction/criminal record; housing; immigration; general law enforcement; family law; and consumer law.

www.lafla.org

EDUCATION/SOCIAL SKILLS TRAINING

Five Keys Schools and Programs provides test preparation and financial assistance with testing fees for students in pursuit of their GED or High School diploma. Five Keys also offers social skills training in Parenting and Anger Management education.

www.fivekeyscharter.org

CASE MANAGEMENT/FAMILY REUNIFICATION SERVICES

A New Way of Life provides family preservation/reunification services including case management, DCFS system navigation, linkage to legal support for child custody issues, visitation monitoring, and education/advocacy.

www.anewwayoflife.org

VISUAL ART, EXPRESSIVE WRITING, POETRY, DRAMA, DANCE AND MUSIC

Somos Los Arte Academy provides workshops, groups and trainings to engage clients and promote healing through the arts.

COMMUNITY OUTREACH AND ENGAGEMENT

The Los Angeles Regional Reentry Partnership provides information and access to services for the reentry community.

www.lareentry.org

INVEST/WORKFORCE DEVELOPMENT, AGING AND COMMUNITY SERVICES(WDACS)

Employment opportunities with Fair Chance employers and vocational training.

www.wdacs.lacounty.gov

DEPARTMENT OF MENTAL HEALTH

Mental Health Screening, Support Groups and Linkage

www.dmh.lacounty.gov

DEPARTMENT OF PUBLIC SOCIAL SERVICES

Providing Benefit Eligibility Screening, Establishment and Support

www.dpss.lacounty.gov

PROBATION DEPARTMENT (ROC/REENTRY OPPORTUNITY CENTER)

1st and 2nd Floor

www.probation.lacounty.gov

OFFICE OF DIVERSION AND REENTRY

Leverages resources, improves systems and ultimately enhances the health and social outcomes of justice-involved populations.

www.dhs.lacounty.gov/wps/portal/dhs/diversionandreentry
