

AMLI MDR

MARINA DEL REY CA

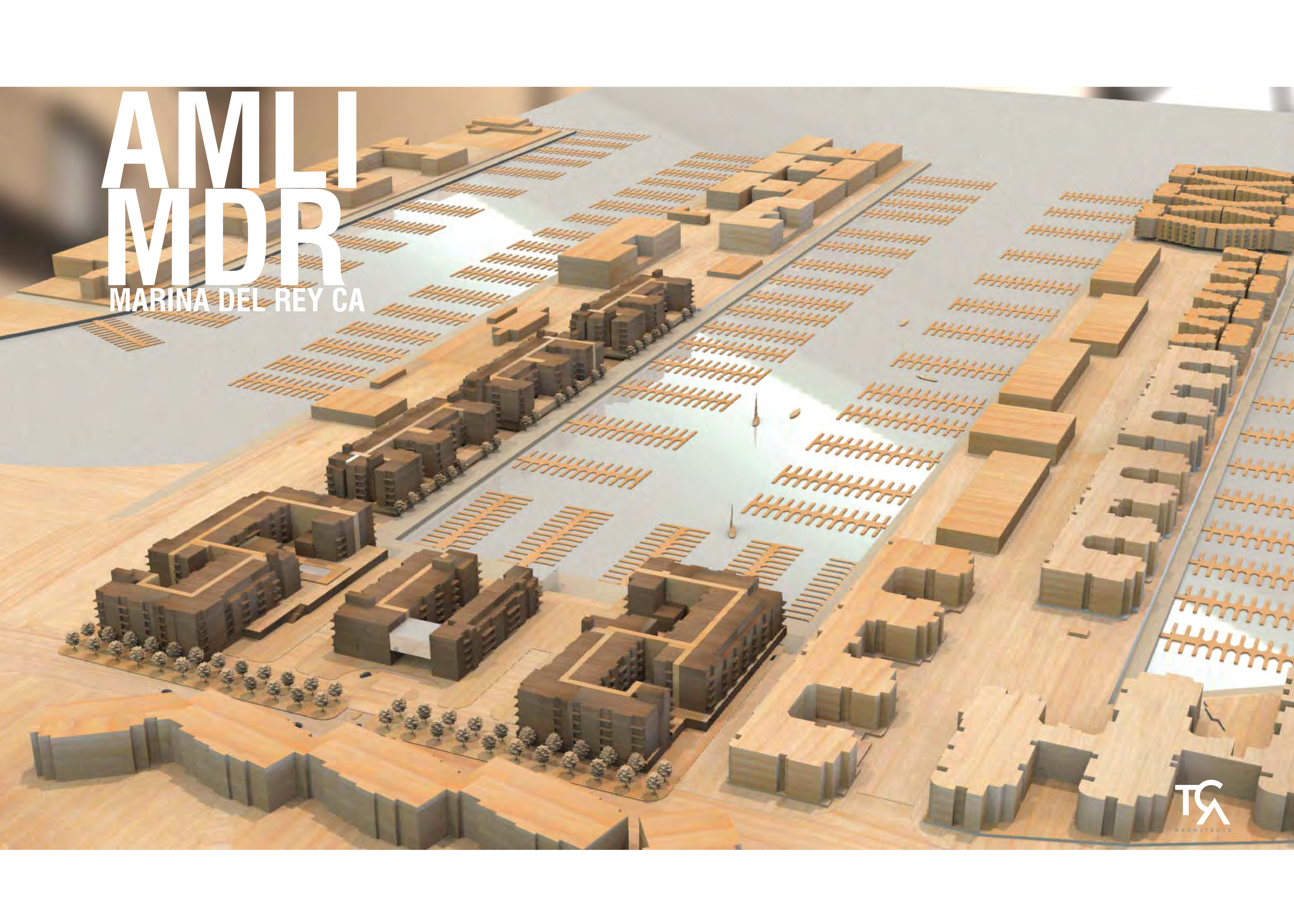

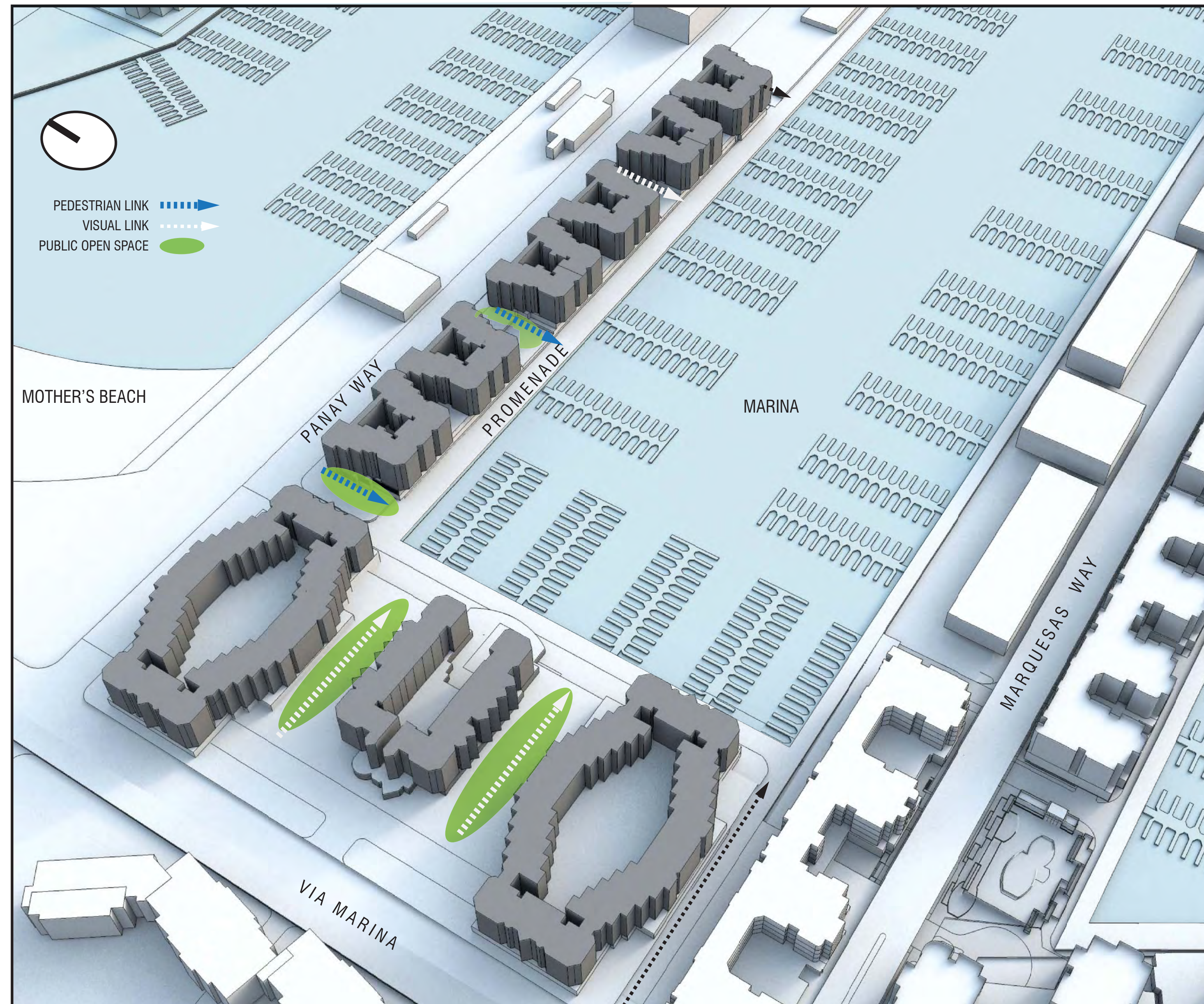

CURRENT BUILDING

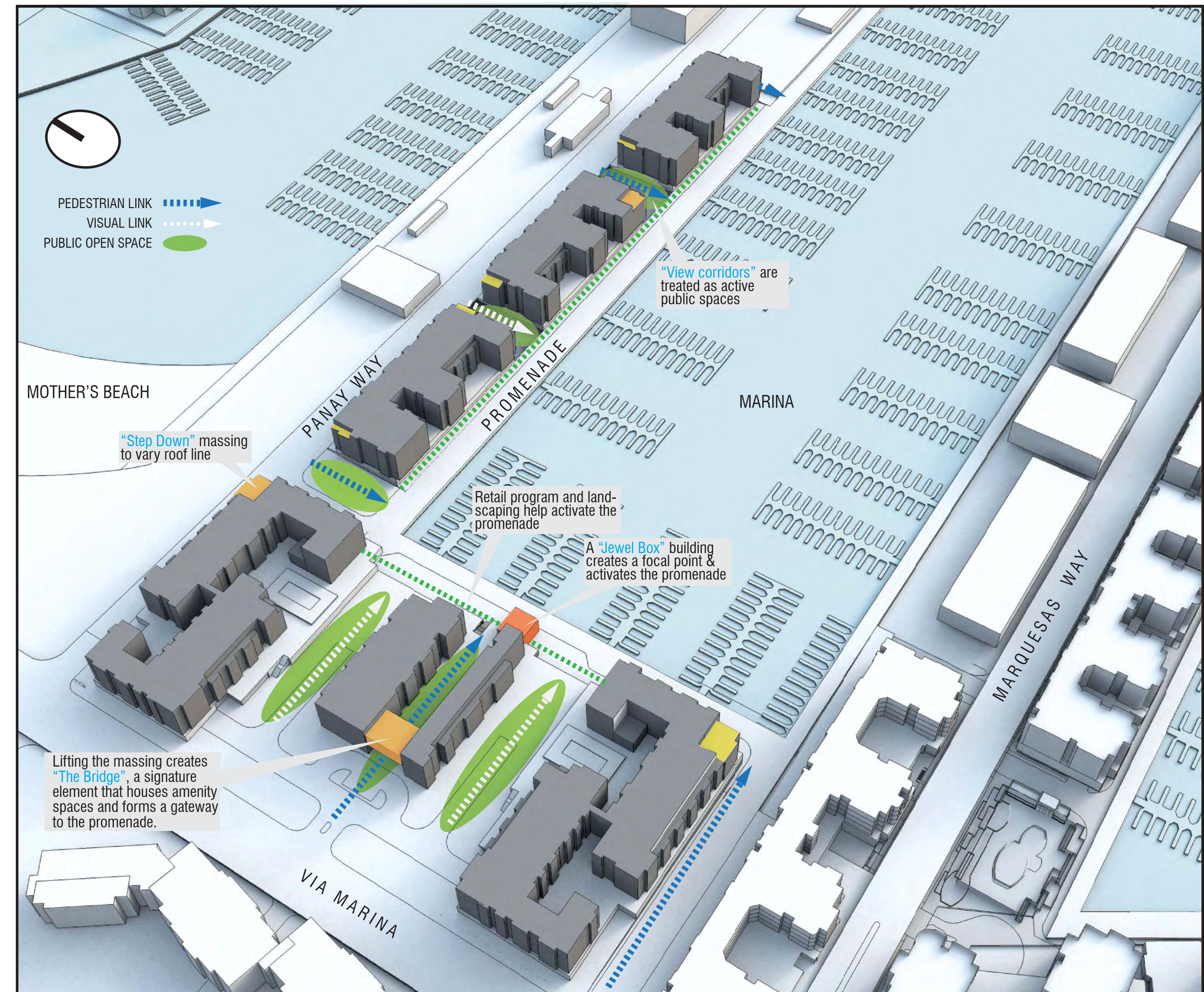

PROPOSED BUILDING

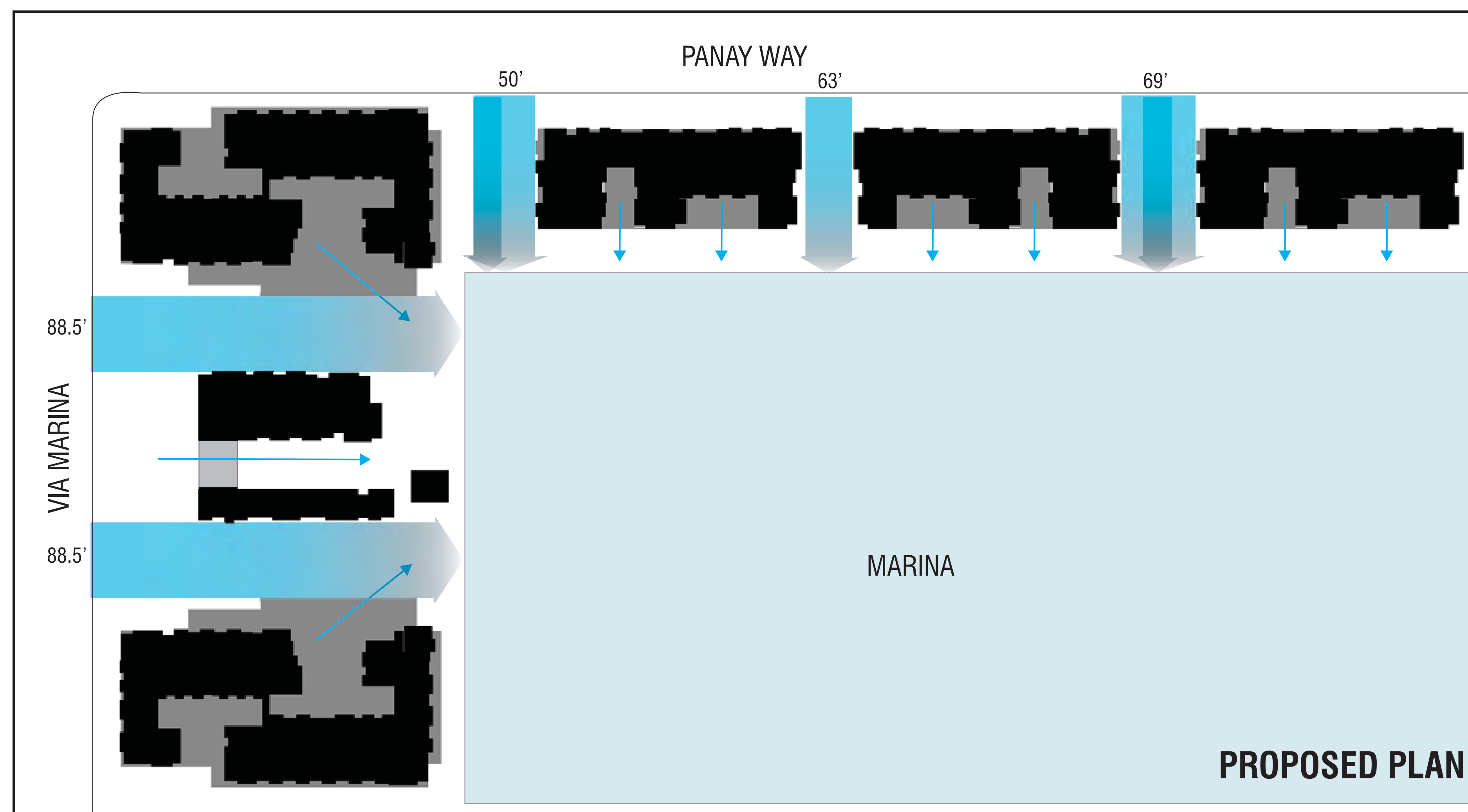
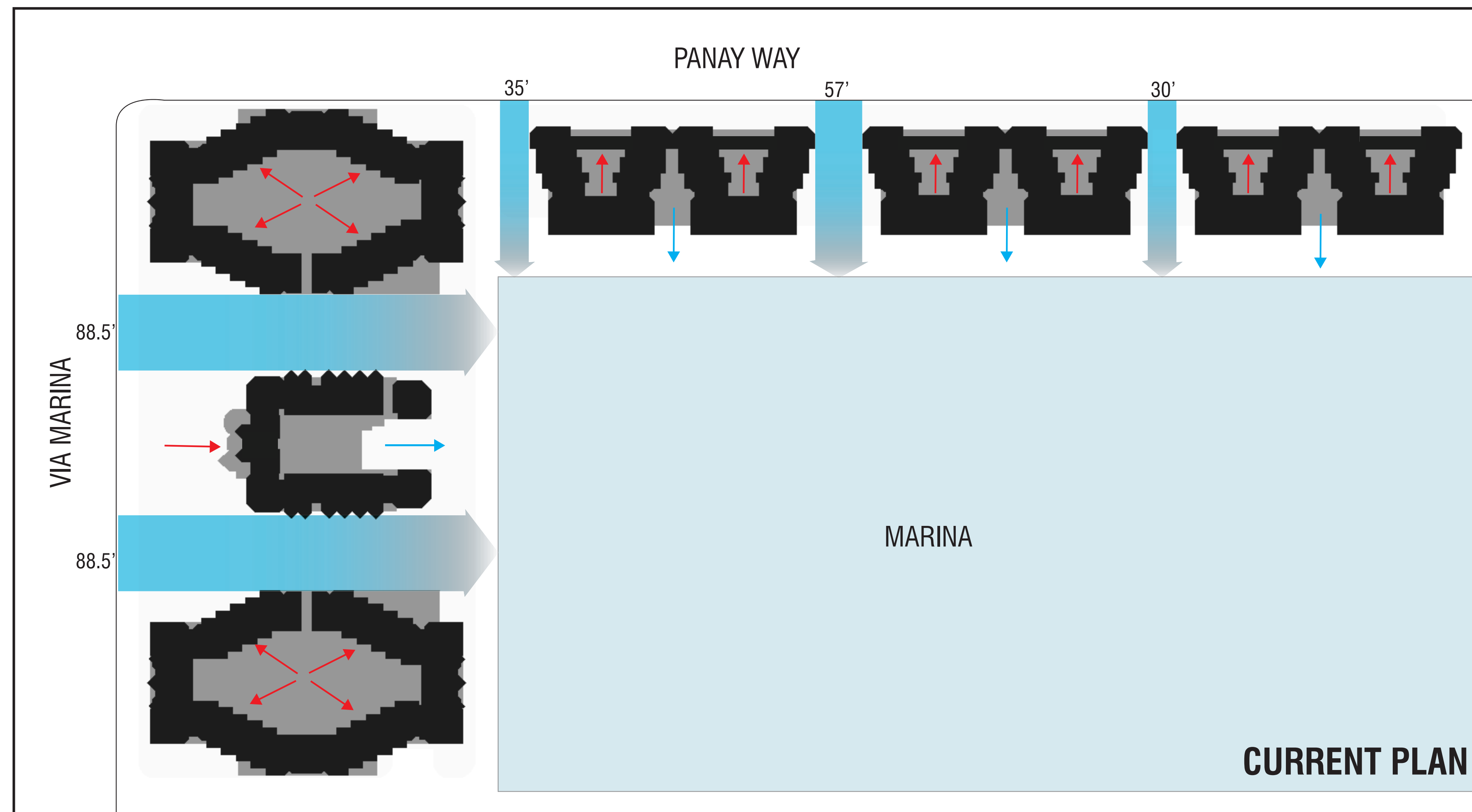

PLAN COMPARISOIN

Maintaining the view corridors was one of the major considerations in developing the site plan. This new layout is a refinement of the existing approved plan which aims to optimize access and views to the water. This is accomplished by reorienting open spaces towards the marina and providing additional view corridors with direct line of sight from the street to the promenade.

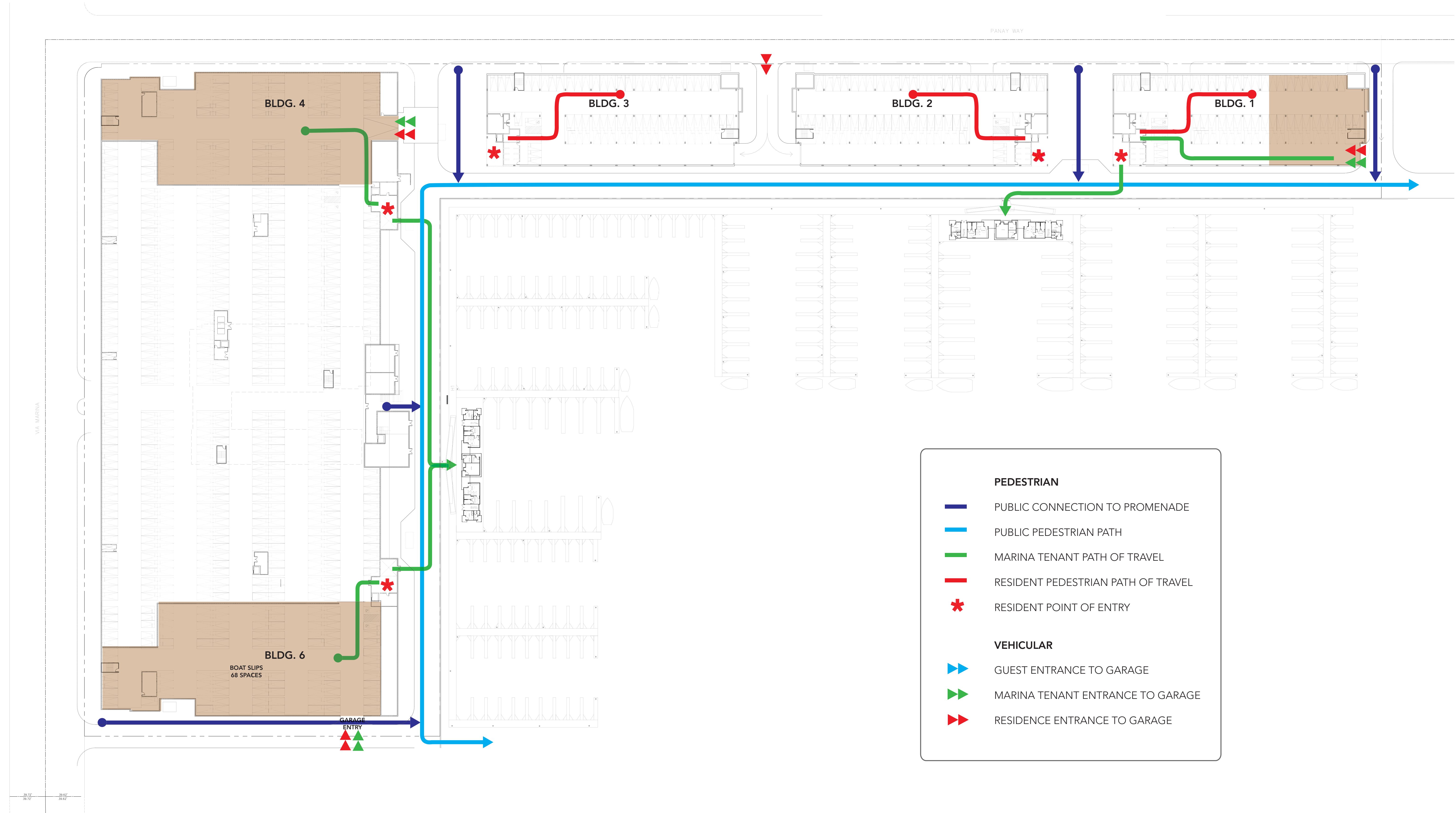

- | PEDESTRIAN | |
|------------|------------------------------------|
| | PUBLIC CONNECTION TO PROMENADE |
| | PUBLIC PEDESTRIAN PATH |
| | MARINA TENANT PATH OF TRAVEL |
| | RESIDENT PEDESTRIAN PATH OF TRAVEL |
| | RESIDENT POINT OF ENTRY |
| VEHICULAR | |
| | GUEST ENTRANCE TO GARAGE |
| | MARINA TENANT ENTRANCE TO GARAGE |
| | RESIDENCE ENTRANCE TO GARAGE |

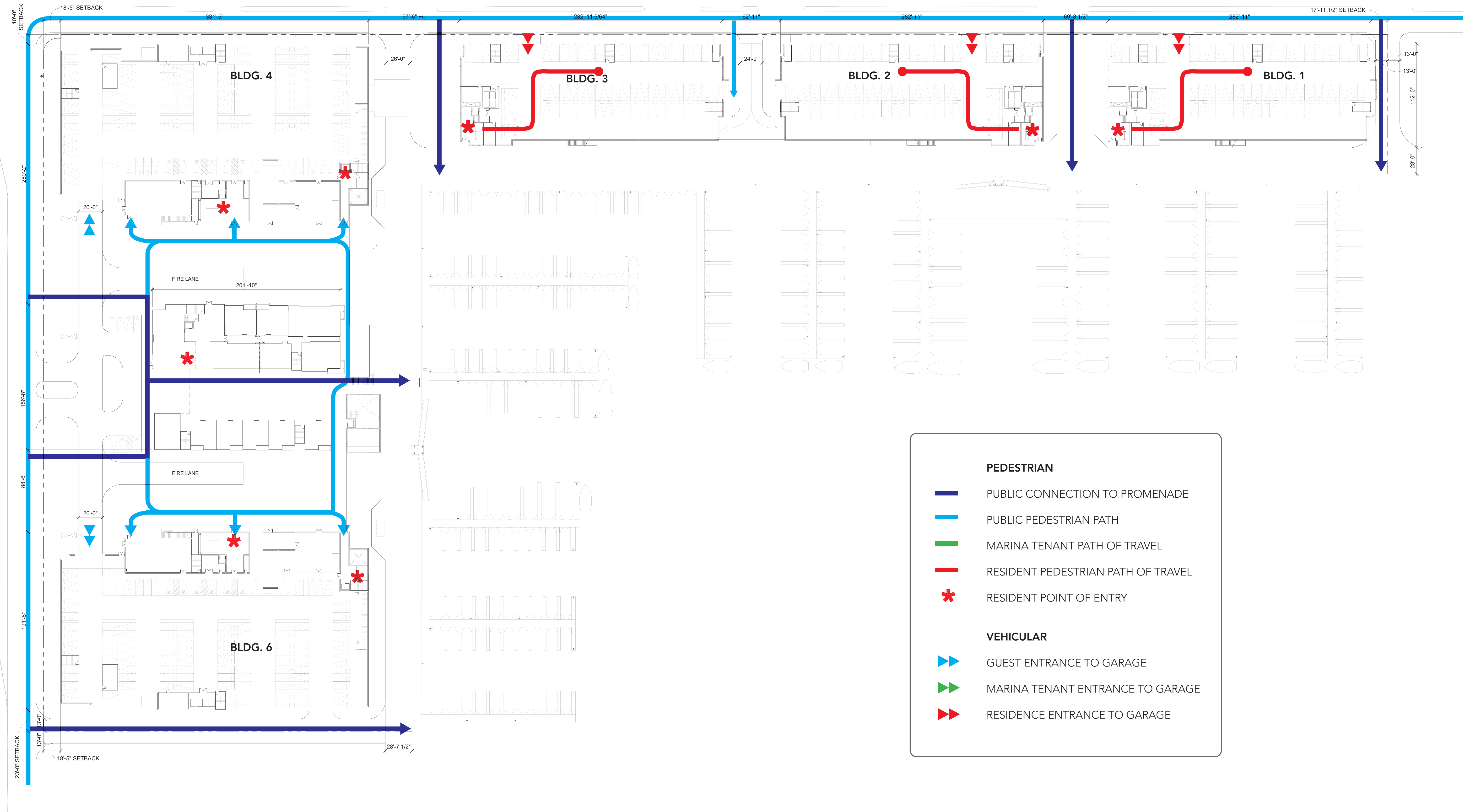

PEDESTRIAN	
	PUBLIC CONNECTION TO PROMENADE
	PUBLIC PEDESTRIAN PATH
	MARINA TENANT PATH OF TRAVEL
	RESIDENT PEDESTRIAN PATH OF TRAVEL
	RESIDENT POINT OF ENTRY
VEHICULAR	
	GUEST ENTRANCE TO GARAGE
	MARINA TENANT ENTRANCE TO GARAGE
	RESIDENCE ENTRANCE TO GARAGE

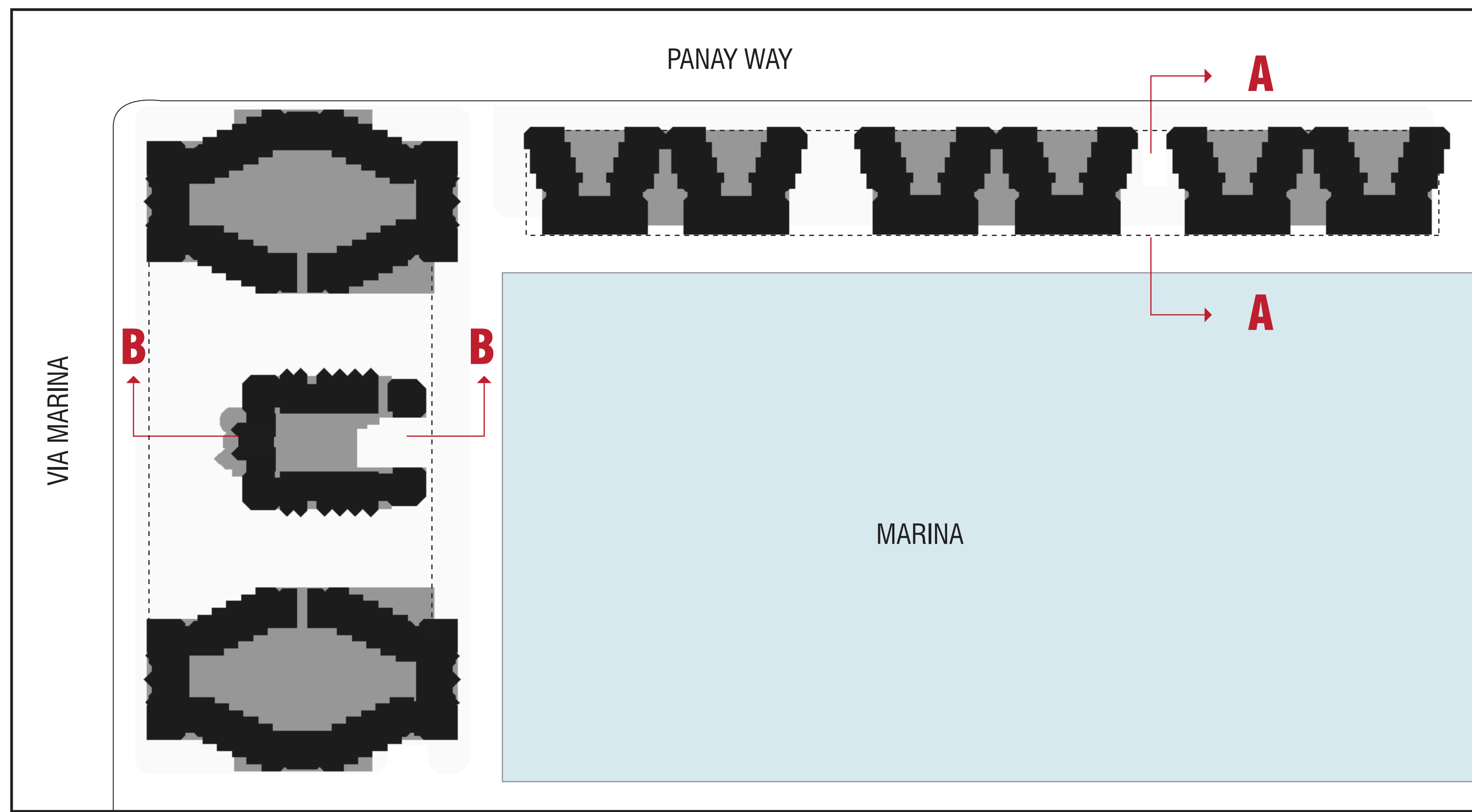

CURRENT PLAN

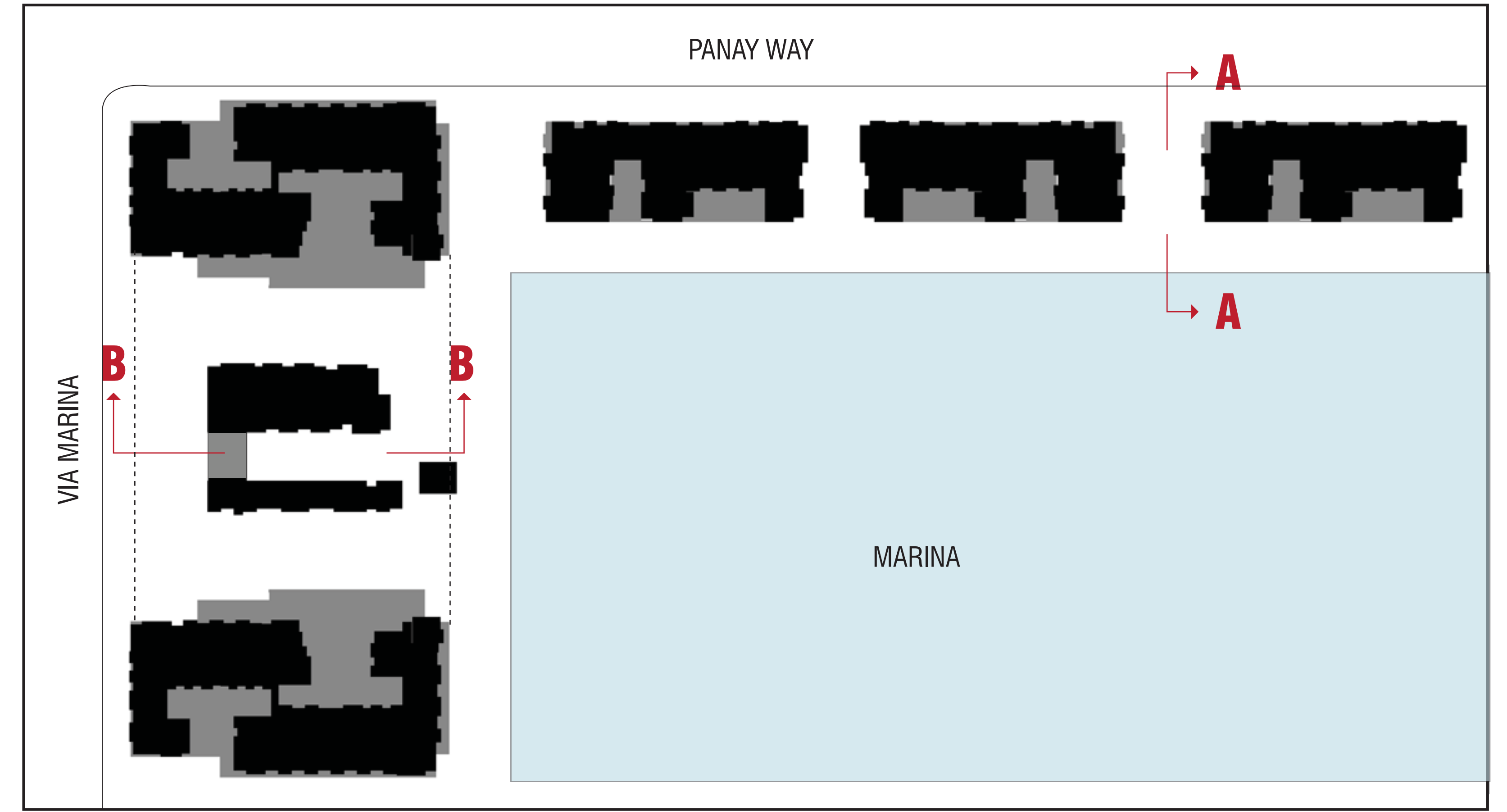

PROPOSED PLAN

