



County of Los Angeles
CHIEF ADMINISTRATIVE OFFICE

713 KENNETH HAHN HALL OF ADMINISTRATION • LOS ANGELES, CALIFORNIA 90012
(213) 974-1101
<http://cao.co.la.ca.us>

DAVID E. JANSSEN
Chief Administrative Officer

Board of Supervisors
GLORIA MOLINA
First District

YVONNE B. BURKE
Second District

ZEV YAROSLAVSKY
Third District

DON KNABE
Fourth District

MICHAEL D. ANTONOVICH
Fifth District

September 16, 2005

To: All Department Heads

From: David E. Janssen
Chief Administrative Officer

PETITIONERS' REQUEST FOR A BOUNDARY CHANGE INVOLVING KERN COUNTY AND THE COUNTY OF LOS ANGELES

The Executive Officer of the Board of Supervisors has received a petition from property owners in the unincorporated Gorman area of Los Angeles County requesting a boundary change that would provide for this territory to be within the boundary of Kern County. The area proposed for the detachment consists of approximately 1,531 acres and contains 75 parcels. The land includes public and private ownership, including commercial use. The proposed area is located East and West of Interstate 5, adjacent to the previous 1,000-acre Kern/Los Angeles County boundary change, approved by the Board of Supervisors in August 2000.

The Chief Petitioner, Mr. Clyde Martin of Gorman, has indicated that the reason for the petitioners' request is that County of Los Angeles public and emergency services and facilities are not conveniently accessible to the affected area due to their geographic location and that Kern County services are more proximate.

My office is requesting that your department review the attached materials and provide us with an impact analysis of the proposed boundary change. We ask that you consider providing input on service and financial issues, including property tax collection status and outstanding bond debts on the affected parcels that you believe could impact the proposed boundary change. The following documents are attached:

Attachment I – Chief Petitioner's letter and copy of the petition.

Attachment II – Map of the proposed area.

Attachment III – Assessor's parcel numbers and owner of record information.

All Department Heads
September 16, 2005
Page 2

I would appreciate receiving your input by **Friday, September 30, 2005**. If the proposed boundary change will not affect your department's services or resources, you may respond to this effect by e-mail to Marge Santos of my staff at msantos@cao.co.la.ca.us.

If you have any questions, please let me know, or your staff may contact Martin Zimmerman, Acting Branch Manager, Office of Unincorporated Area Services and Special Projects, at (213) 974-1326.

Thank you for your assistance.

DEJ:MKZ
DD:MJS:os

Attachments

c: Each Supervisor

ATTACHMENT I

August 31, 2005

Violet Varona-Lukens
Executive Officer to the Board of Supervisors
County of Los Angeles
500 W. Temple St., Room 383
Los Angeles, CA 90012

Dear Ms. Varona-Lukens:

Enclosed find our petitions for a county boundary change under the provisions of Article 4, Chapter 2, Division 1 of Title 3 of the Government Code Section 23205.

The signatures attached represent all but six percent of the privately held acreage and at least 75% of the assessor's tax base. It is apparent and clear that a substantial majority of the land owners and registered voters wish to be in Kern County.

We have contacted Supervisor Ray Watson's office (Supervisorial District 4, County of Kern) and Supervisor Antonovich's office both of whom have expressed their support.

The basic incentive for this petition is born of geographic distances having created an atmosphere where county services are at best inconvenient, generally unavailable, difficult for the county to provide, and nearly impossible for homeowners and businesses to navigate. As a direct result, the geographical area represented by these petitions has become stagnant, with zero growth over the past 15 years in the immediate Gorman vicinity and little, if any, in the remainder.

We look forward to your reply.

Sincerely yours,



Clyde Martin
Mailing Address: PO Box 506
Lebec, CA 93243

Physical Address: 49964 Peace Valley Rd
Gorman, CA 93243

Home Phone: 661-248-6984

Email Address: clydem@integrity.com

Enclosures: County Boundary Change Petition

cc: Supervisor Michael Antonovich
Paul Novak, Director of Planning
Millie J. Jones, Senior Deputy
Supervisor Ray Watson, County of Kern

COUNTY BOUNDARY CHANGE PETITION

To: Board of Supervisors, County of Los Angeles

A. We, the undersigned property owners, and Clyde Martin, designated as the Chief Petitioner, submit this petition to initiate the proceedings for a county boundary change in accordance with Article 4, Chapter 2, Division 1 of Title 3 of the Government Code Section 23205.

B. We make this request to move the affected territory from the County of Los Angeles to the County of Kern for the following reasons:

- Public and emergency services being more readily available to the affected territory from the County of Kern than from the County of Los Angeles, including but not limited to:

1. Law Enforcement: The County of Kern Sheriff's Department, headquarter in Frazier Park, patrols the territory adjacent to the affected territory with a staff of one sergeant, six deputies and four reserves on a 24- hour basis. The County of Los Angeles Sheriff's support is based in Santa Clarita, 45 miles south of the affected territory. Response times for the Los Angeles County Sheriff and even the Highway Patrol can be more than one hour.

2. Public Schools: The El Tejon School District (Kern County) operates an elementary school, a middle school and a high school adjacent to the affected territory. The Gorman School District operates just one small facility, serving grades K-8 only.

3. Waste Disposal: The closest Los Angeles County public dump is located in Palmdale, 50 miles east of the affected territory. There is a Kern County dump, free to Kern County residents, located in Lebec, two miles from the affected territory.

4. Building & Safety: The County of Kern maintains a full service satellite office for plan review and inspections in Frazier Park approximately 3.5 miles away. The closest County of Los Angeles Building & Safety office is located 50 miles from the affected territory in Lancaster.

5. Public Library: There is a Kern County public library branch located in Frazier Park. The closest Los Angeles County public library is located in Santa Clarita, 45 miles south of the affected territory.

6. Parks & Recreation: There is a Kern County public park located in Frazier Park, just three miles from the affected territory. The closest Los Angeles County Park (which is accessible on a restricted basis) is located in the Antelope Valley, more than 20 miles from the affected territory.

7. Health Care: Frazier Mountain Community Health Center, currently located in Frazier Park, is the only Family Medical Practice with an Advanced Cardiac Certified staff along with providing the only Pediatric and Elderly care in the area. The next closest Medical facility is in Santa Clarita 45 miles away.

COUNTY BOUNDARY CHANGE PETITION

Continued from page one

- The affected territory shares a strong economic identity with and dependency on the County of Kern.
 1. The majority of all commercial businesses serving the affected territory, primarily banking, grocery stores, pharmacies, hardware stores, and medical facilities, are located in the Kern County communities of Lebec and Frazier Park..
 2. Most local employment opportunities are provided by Kern County businesses.
 3. The Mountain Communities Chamber of Commerce, the sole organization representing the interests of business owners in the affected territory, is headquartered in Kern County.

- Due to economic and geographical ties, the affected area shares a much stronger political affinity with the County of Kern than with the County of Los Angeles, yet property owners in the affected territory are unable to participate in the political process.
 1. Property owners are able to vote in elections which decide the economic and political affinity with the County of Kern yet property owners in the County of Los Angeles, the affected territory, are unable to participate in the political process.
 2. Property owners must currently vote via absentee ballot since the County of Los Angeles does not provide any local polling locations.
 3. Property owners, most of who's children attend the El Tejon School District's elementary, middle and high schools, adjacent to the designated area, are unable to run for election to the school board.

- Property owners in the affected territory have easier and more frequent access to government leaders in the County of Kern than the County of Los Angeles.
 1. The Kern County Supervisor, The Honorable Ray Watson, representing the Mountain Communities makes regular visits to the Frazier Park area, maintains a satellite office facility, and participates in local community and chamber meetings.
 2. Kern County Department heads, including the Sheriff, regularly participate in local community meetings.

COUNTY BOUNDARY CHANGE PETITION

Continued from page two

- C. The proposed boundary change would move the following property from the County of Los Angeles to the County of Kern:

An area lying in Township 8 North, Range 19 West of the San Bernardino Meridian, containing the entirety of Section 11, portions of Sections 3, 4, 10, 12, 13, and 14, and more particularly described as follows:

Beginning at a point, point being on the North Line of Section 3, Township 8 North, Range 19 West and the East Right of Way Line of Interstate 5, point also being a cornering point in the current Kern / Los Angeles County line; thence in a westerly direction along the North Line of said section and the current Kern / Los Angeles County line to the Northeast corner of Section 4; thence in a westerly direction along the North Line of said Section 4 and the current Kern / Los Angeles County line to a point being a change in direction of said current county line; thence leaving the North Line of Section 4, and with said current county line in a southeasterly direction to a point in the South Line of Section 10; thence leaving said current county line and with the South Line of said Section 10, in an easterly direction to the Southwest corner of Section 11; thence with the South Line of said Section 11 to a point on said south line and being 459.68 feet from the common corner of Sections 11, 12, 13, and 14; thence leaving the South Line of Section 11, S 64° 41' 22" E a distance of 521.04 feet, crossing the section line between said Sections 13 and 14 to the beginning of a non-tangent curve, concave southeasterly, having a radius of 1500 feet, a radial to said curve bears N 64° 29' 14" W; thence northeasterly along said curve through a central angle of 09° 50' 55", an arc distance of 257.84 feet to a point in the South Line of said Section 12; thence easterly with the South Line of said Section 12 to the Southeast Corner of said section; thence northerly with the East Line of section 12 to the East Quarter Corner thereof; thence westerly with the Quarter Section Line to the center of said section; thence Northerly with the Quarter Section Line to the Southeast Corner of the North Half of the Northwest Quarter Section of Section 12; thence Westerly with the South Line of said North Half to the Southwest Corner of said North Half, and being on the line dividing Sections 11 and 12; thence Northerly with the Section Line to a common corner of Sections 1, 2, 11, and 12; thence Westerly with the North Line of Section 11 to a common corner of Sections 2, 3, 10, and 11; thence Westerly with the North Line of Section 10 to its intersection with the East Right of Way Line of Interstate 5; thence Northerly, leaving said Section Line, and with the East Right of Way Line of Interstate 5 to the Point of Beginning, and containing 1,915 Acres, more or less. (Please see the attached map.)

- D. The proposed new boundary line will not be more than five miles from its original location.
- E. The proposed new boundary line will not reduce the area of the County of Los Angeles by more than five percent.
- F. The proposed new boundary line will not reduce the population of the County of Los Angeles by more than five percent.
- G. The proposed boundary change includes inhabited and uninhabited territory.

COUNTY BOUNDARY CHANGE PETITION

Continued from page three

- H. Based on current input from the County of Los Angeles, the boundary change shall be subject to the following terms and conditions or similar actions to accomplish the identified purpose.
1. Not less than the date upon which it approves the ordinance approving the county boundary change, the Kern County Board of Supervisors will initiate proceedings with the appropriate Local Agency Formation Commission to detach the affected area from Los Angeles Consolidated Fire Protection District, and will bear all costs related to said proceedings.
 2. Effective upon the date of the boundary change, Kern County will accept full responsibility for the provision of all fire, rescues, hazardous materials, and emergency medical services to the affected area. In addition, Kern County will indemnify and hold the Los Angeles Consolidated Fire Protection District harmless from any liability and responsibility for providing services to the area.
 3. The boundary change shall be conditioned upon appropriate action to require Kern County to provide the County of Los Angeles with offsetting revenues equivalent to the amount that would have been collected for bond payments from the affected parcels in the absence of the boundary change. The offsetting payment shall be made by Kern County until such time as the outstanding bond debt for Los Angeles County is fully paid.
 4. The County of Los Angeles shall be made whole by Kern County for delinquent taxes on parcels included in the territory to be transferred.
- I. This petition is being submitted in separate counterparts, which together constitute more than 25 percent of the property owners within the affected territory who also own not less than 25 percent of the assessed value of land and improvements within the affected territory.

(Signatures appear on the following page)

Name: Clyde W. Martin and Judith J. Martin

APN#: portion of 3251-012-020

Clyde Martin
Property Owner

Clyde Martin
Signature

6/13/05
Date

Judy Martin
Property Owner

Judy Martin
Signature

6-13-05
Date

Mailing Address: Po Box 506
Lubbock CA 93243

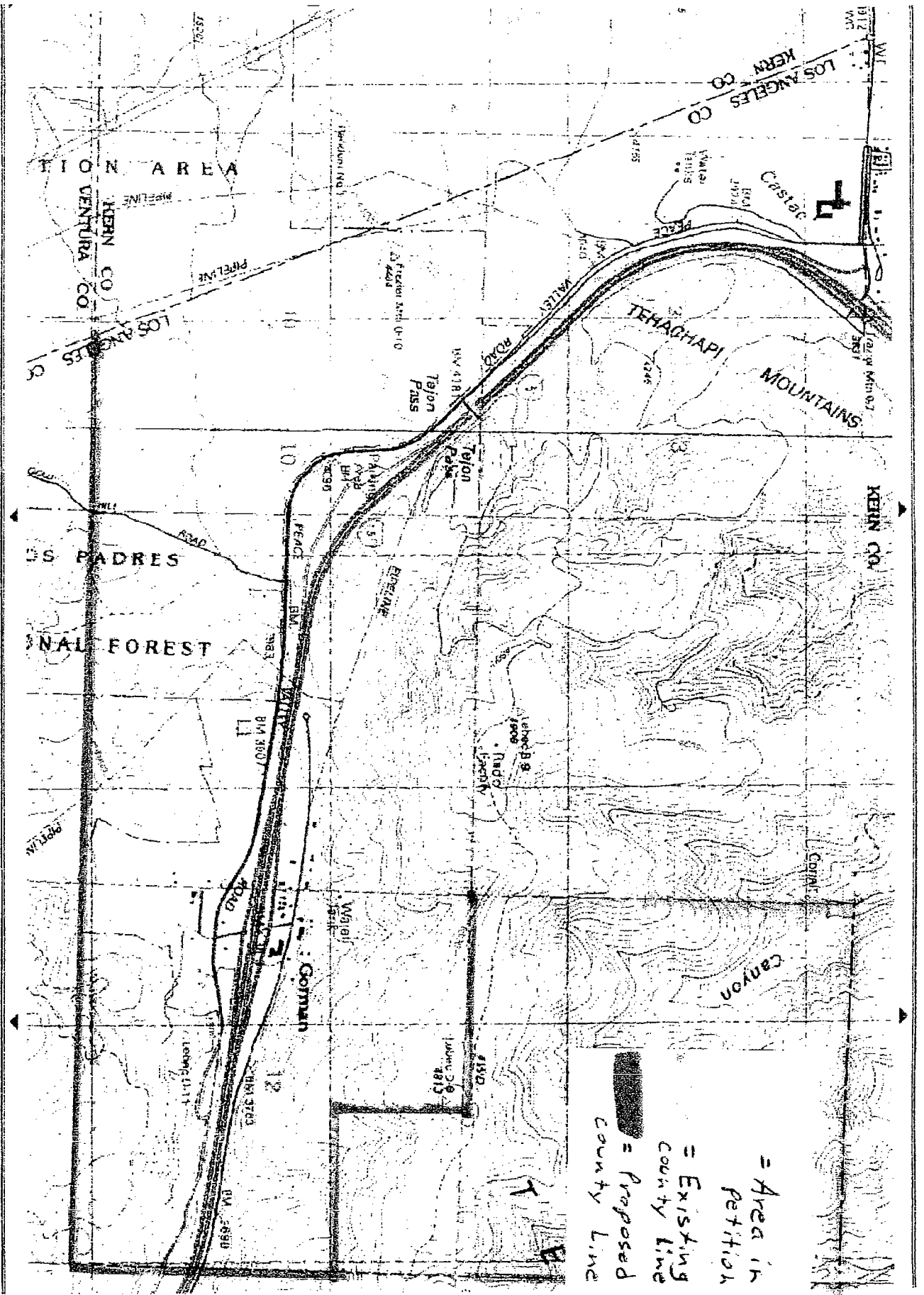

= Area in petition
 = Existing county line
 = Proposed county line

A

A

1000
500
0

ATTACHMENT II

PROPOSED KERN COUNTY ANNEX MAP

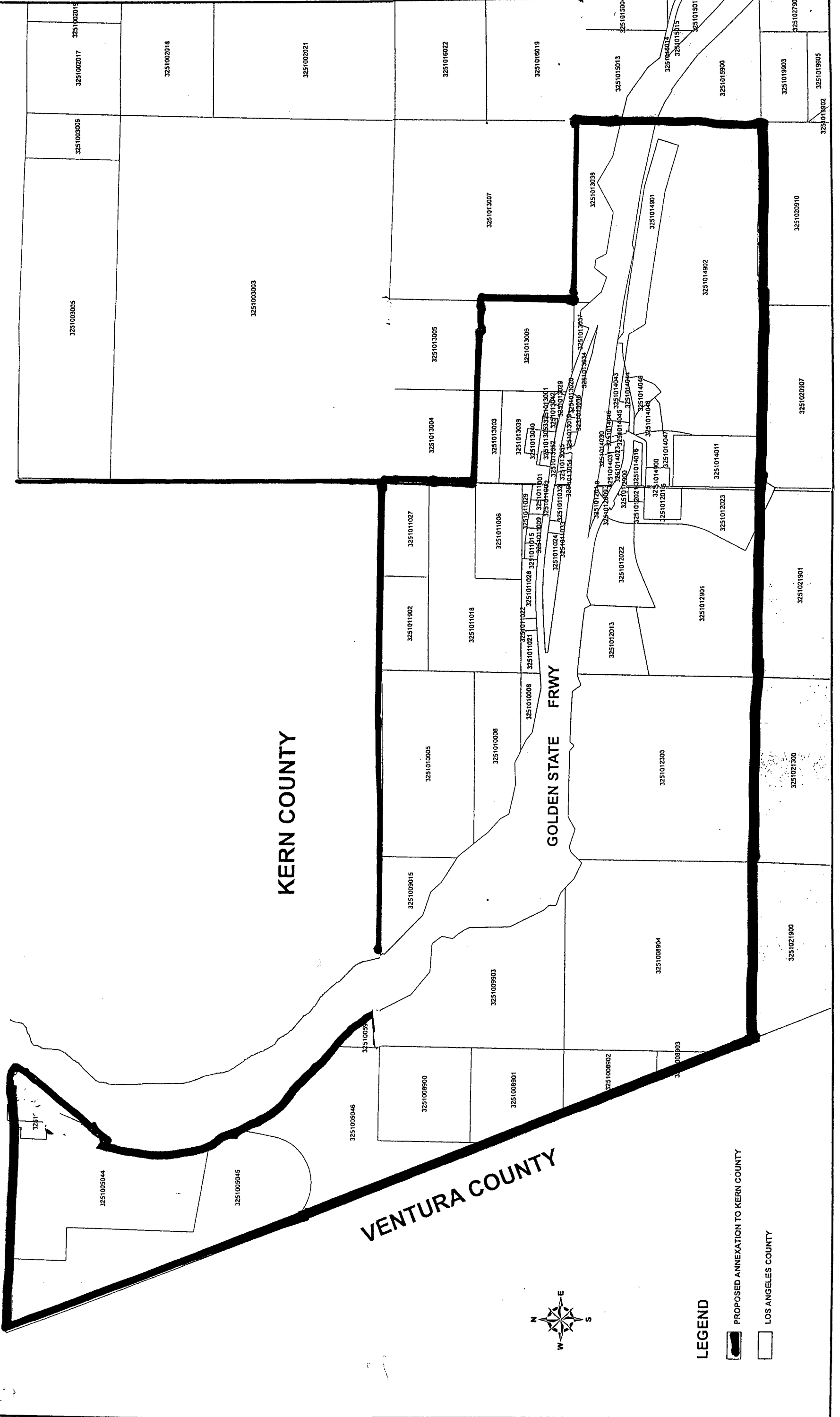

KERN COUNTY

GOLDEN STATE FRWY

VENTURA COUNTY

LEGEND

 PROPOSED ANNEXATION TO KERN COUNTY

 LOS ANGELES COUNTY

ATTACHMENT III

Kern/L.A. County Boundary Change Proposal 9/13/2006)
 Prepared by County of Los Angeles Assessor's Office

AIN	1st Owner Assee Name	Mail Street	Mail City	Assessed Value
1	3251005032 LYNN,CAROLYN M ET AL	6515 TEVIS DR	BAKERSFIELD CA 93309	24,923
2	3251005033 LYNN,CAROLYN M ET AL	6515 TEVIS DR	BAKERSFIELD CA 93309	8,953
3	3251005044 CFJ PROPERTIES	P O BOX 150310	OGDEN UT 84415	10,153,203
4	3251005045 WINEMILLER,JIMMY	114 HICKORY CREEK CIR	LITTLE ROCK AK 72212	326,159
5	3251005046 WINEMILLER,JIMMY	114 HICKORY CREEK CIR	LITTLE ROCK AK 72212	236,184
6	3251005900 STATE OF CALIF		00000	634
7	3251008900 STATE OF CALIF		00000	11,829
8	3251008901 STATE OF CALIF		00000	7,213
9	3251008902 STATE OF CALIF		00000	9,984
10	3251008903 STATE OF CALIF		00000	1,914
11	3251008904 STATE OF CALIF		00000	66,344
12	3251009015 RIDER,JACK	PO BOX 1167	LEBEC CA 93243	33,739
13	3251009903 STATE OF CALIF		00000	57,863
14	3251010005 RIDER,JACK	PO BOX 1167	LEBEC CA 93243	84,349
15	3251010006 BROWN,TREVOR AND	PO BOX 2083	FRAZIER PARK CA 93225	26,990
16	3251010008 GREEN,LOUISE M CO TR	9001 ELLISAN ST	BAKERSFIELD CA 93307	16,018
17	3251011001 RALPHS,RUTH M TR	PO BOX 81	LEBEC CA 93243	86,436
18	3251011002 DELAMERE,DOLORES B TR	49852 GORMAN POST RD	GORMAN CA 93243	32,667
19	3251011003 MARTIN,ISAAC B	P O BOX 879	LEBEC CA 93243	204,000
20	3251011006 RALPHS,RUTH M TR	PO BOX 81	LEBEC CA 93243	15,151
21	3251011009 MUSA,JOZEFINE	PO BOX 118	LEBEC CA 93243	33,963
22	3251011015 ORTEGA,JAVIER AND IRMA	49926 GOLDEN STATE HWY	GORMAN CA 93243	271,830
23	3251011018 GREEN,LOUISE M CO TR	9001 ELLISAN ST	BAKERSFIELD CA 93307	90,956
24	3251011021 GREEN,LOUISE M CO TR	9001 ELLISAN ST	BAKERSFIELD CA 93307	22,732
25	3251011022 GREEN,LOUISE M CO TR	9001 ELLISAN ST	BAKERSFIELD CA 93307	7,572
26	3251011024 MARTIN,ISAAC B AND LENA M	P O BOX 508	LEBEC CA 93243	69,914
27	3251011027 BURK HARRIS BURK INC	3537 LOWRY RD	LOS ANGELES CA 90027	2,858
28	3251011028 RALPHS,JAMES L AND EDNA L	PO BOX 81	GORMAN CA 93536	10,391
29	3251011029 RALPHS,RUTH M TR	PO BOX 81	LEBEC CA 93243	4,894

30	3251011032	MARTIN BROTHERS DEVELOPMENT INC	P O BOX 508	LEBEC CA 93243	357,377
31	3251011033	RALPHS,CHARLES D AND	HC 2 BOX 81	GORMAN CA 93243	14,291
32	3251011902	U S GOVT		00000	6,493
33	3251012009	RALPHS,RONALD AND JULIANNE C AND	PO BOX 81	GORMAN CA 93243	35,400
34	3251012013	RALPHS,RONALD A AND JULIANNE C	50007 N PEACE VALLEY RD	GORMAN CA 93243	187,154
35	3251012015	RALPHS,MARIAN L DECD EST OF	PO BOX 51	GORMAN CA 93243	85,703
36	3251012019	MARTIN BROTHERS DEVELOPMENT INC	P O BOX 508	LEBEC CA 93243	81,600
37	3251012021	SONDER,STEVEN C	PO BOX 81	LEBEC CA 93243	70,099
38	3251012022	MARTIN,CLYDE W AND JUDITH J	P O BOX 508	LEBEC CA 93243	192,474
39	3251012023	MARTIN,ISAAC B AND LENA M	P O BOX 508	LEBEC CA 93243	211,201
40	3251012300	U S GOVT		00000	0
41	3251012900	GORMAN SCHOOL DIST		00000	4,093
42	3251012901	STATE OF CALIFORNIA		00000	46,876
43	3251013001	MUSA INVESTMENTS INCORPORATED	PO BOX 429	LEBEC CA 93243	213,687
44	3251013003	MUSA INVESTMENTS INCORPORATED	PO BOX 429	LEBEC CA 93243	19,116
45	3251013006	MUSA INVESTMENTS INCORPORATED	PO BOX 429	LEBEC CA 93243	44,986
46	3251013019	DBN GORMAN INVESTMENTS LLC	1521 MALLORY PL	ROHNERT PARK CA 94928	1,729,630
47	3251013020	FMB LTD	P O BOX 3250	SANTA MONICA CA 90403	985,635
48	3251013029	MUSA INVESTMENTS INC	PO BOX 429	LEBEC CA 93243	245,930
49	3251013034	FMB LTD	P O BOX 3250	SANTA MONICA CA 90403	158,973
50	3251013035	DBN GORMAN INVESTMENTS LLC	1521 MALLORY PL	ROHNERT PARK CA 94928	227,011
51	3251013036	DBN GORMAN INVESTMENTS LLC	1521 MALLORY PL	ROHNERT PARK CA 94928	97,288
52	3251013037	KERNAN,STEPHEN M	270 N CANON DR	BEVERLY HILLS CA 90210	28,596
53	3251013038	HAGLER,LOUISE	P O BOX 2410	FRAZIER PARK CA 93225	21,802
54	3251013039	MUSA INVESTMENTS INCORPORATED	PO BOX 429	LEBEC CA 93243	61,856
55	3251013040	RALPHS,RONALD ET AL	PO BOX 81	GORMAN CA 93243	58,414
56	3251013042	MUSA INVESTMENTS INCORPORATED	PO BOX 429	LEBEC CA 93243	138,334
57	3251013052	TERLSIAN,SALPY S	49764 GORMAN POST RD	GORMAN CA 93243	426,996
58	3251013053	RALPHS,RONALD ET AL	PO BOX 81	GORMAN CA 93243	373,055
59	3251013054	MARTIN BROTHERS DEVELOPMENT INC	P O BOX 508	LEBEC CA 93243	155,331
60	3251013055	RALPHS,RONALD CO TR	PO BOX 81	GORMAN CA 93243	333,426
61	3251014011	MARTIN BROTHERS DEVELOPMENT INC	P O BOX 508	LEBEC CA 93243	112,883
62	3251014016	MARTIN BROTHERS DEVELOPMENT INC	P O BOX 508	LEBEC CA 93243	21,952
63	3251014023	MCDONALD'S CORP 04-2207	28409 VICTORIA RD	CASTAIC CA 91384	1,221,652
64	3251014030	RALPHS,JAMES L AND EDNA	HC 2 BOX 81	LEBEC CA 93243	340
65	3251014031	RALPHS,RONALD AND JULIANNE C AND	PO BOX 81	GORMAN CA 93243	153,671
66	3251014043	RALPHS,RONALD AND JULIANNE C AND	PO BOX 81	GORMAN CA 93243	28,843

67	3251014044	RALPHS, RONALD AND JULIANNE C AND	PO BOX 81	GORMAN CA 93243	15,632
68	3251014045	MUSA, JOZFINE N	PO BOX 429	LEBEC CA 93243	339,157
69	3251014046	RALPHS, JAMES L ADM	HC 2 BOX 81	LEBEC CA 93243	340
70	3251014047	MARTIN, CURTIS W	P O BOX 508	LEBEC CA 93243	57,222
71	3251014048	MARTIN, ISAAC B AND LENA M	P O BOX 508	LEBEC CA 93243	37,454
72	3251014049	MARTIN BROTHERS DEVELOPMENT INC	P O BOX 508	LEBEC CA 93243	33,916
73	3251014900	GORMAN SCHOOL DIST		00000	9,729
74	3251014901	STATE OF CALIF		00000	15,579
75	3251014902	STATE OF CALIF		00000	88,717
					\$20,669,577