

Los Angeles County: Marina del Rey Roadway Improvement Projects

DCB Meeting 7.16.13



**Presentation By: Richard Shieh, Mary Ann Bennett &
Brittany Barker**

Admiralty Way Street Improvement Project

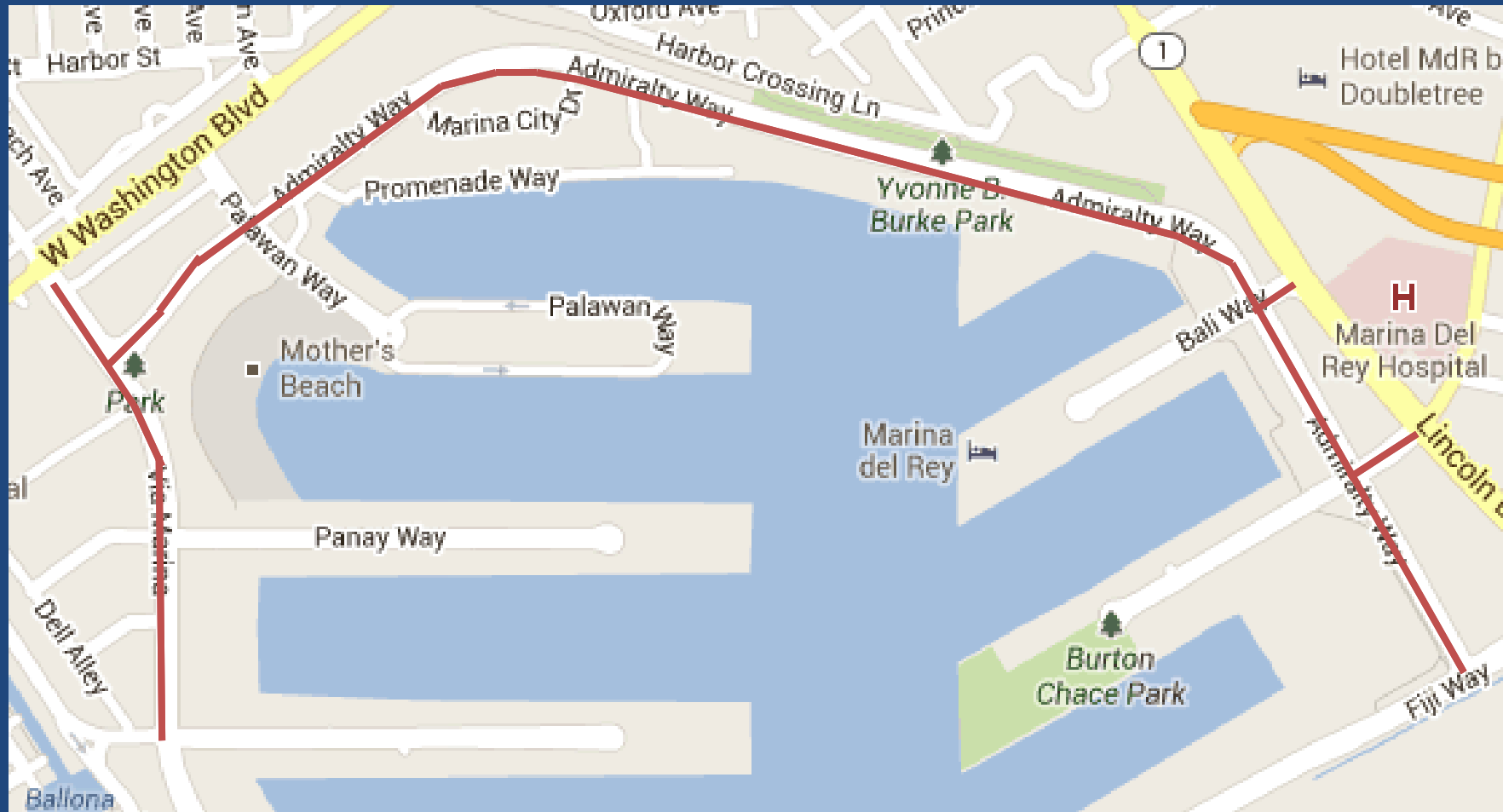

Construction Start Date: July 2013

Project Improvements

- Median island reconfigurations
- Provide sufficient traffic capacity
- Traffic signal upgrades
- Signing & striping modifications
- Street light relocations
- Median landscaping replacement
- Complete road resurfacing
- Enhanced mid-block crossings

Enhanced Crossings

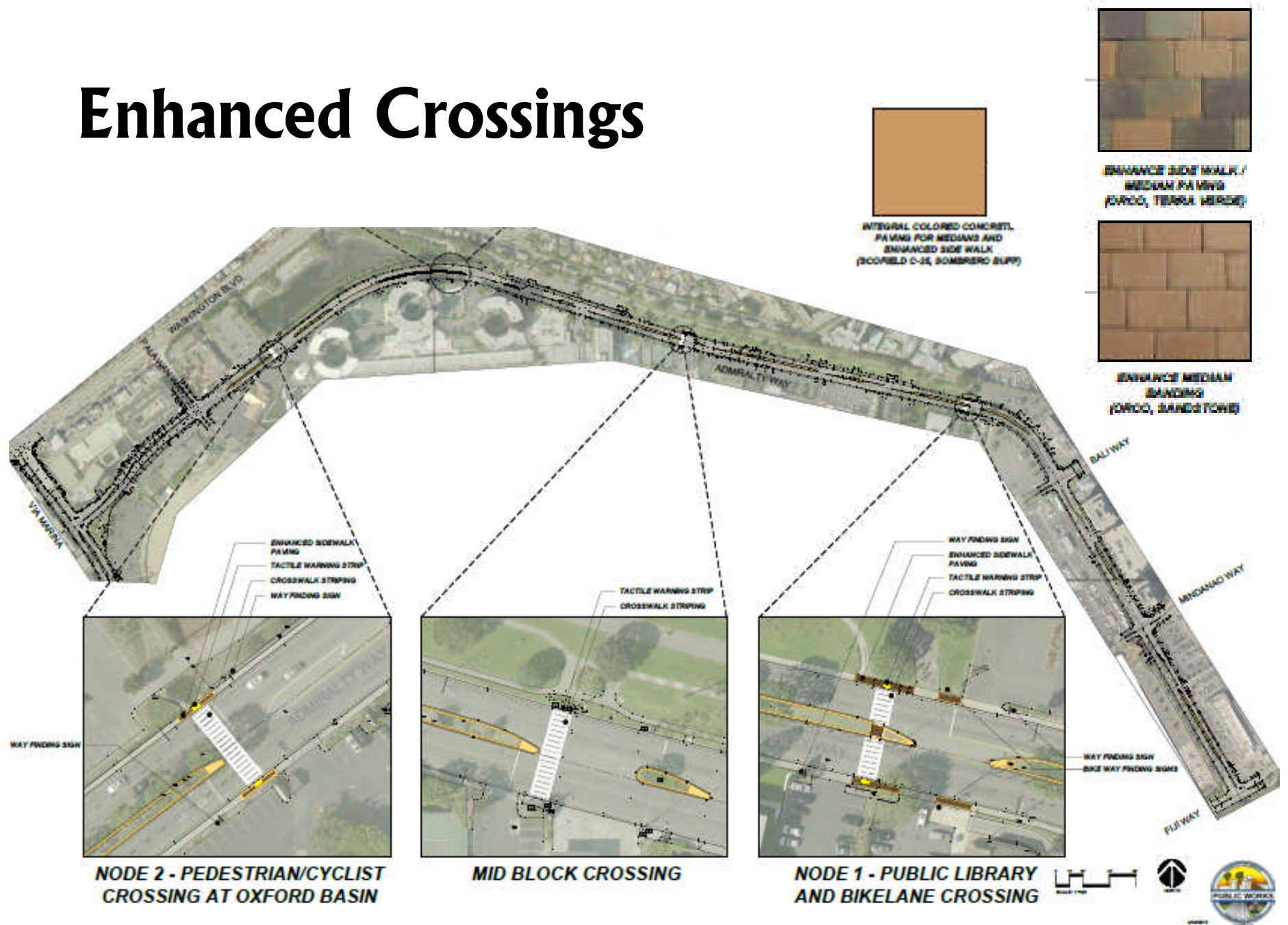

PROPOSED PARKWAY
TREES FOR OXFORD
BASIN

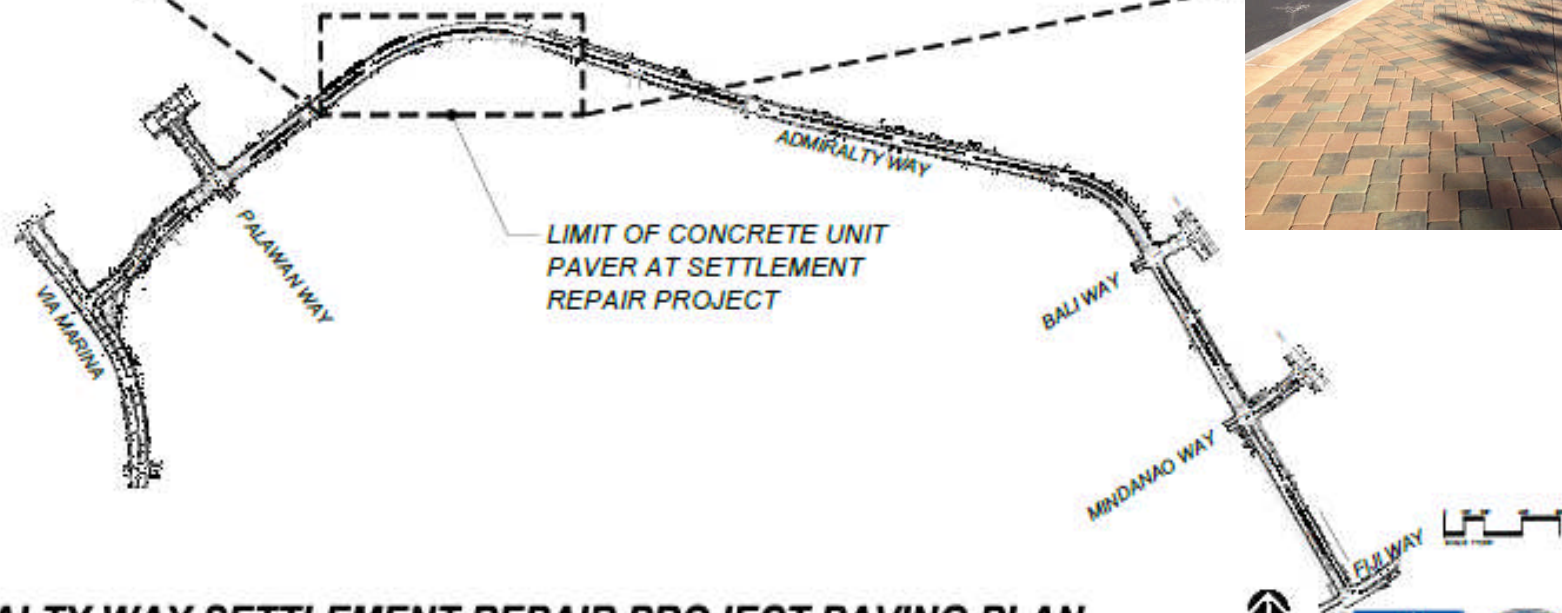
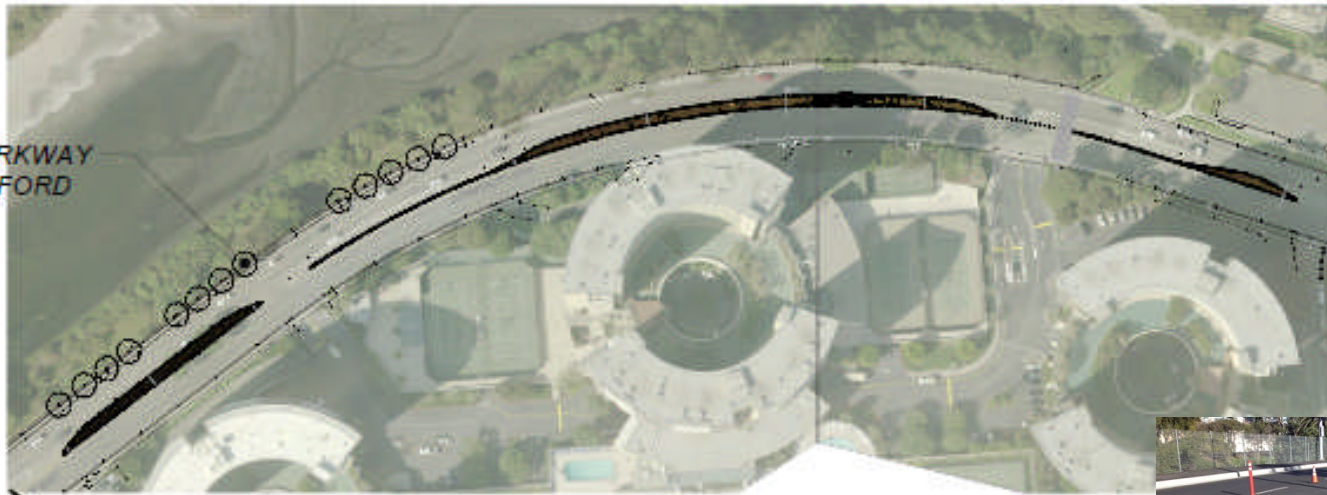

ADMIRALTY WAY SETTLEMENT REPAIR PROJECT PAVING PLAN

MARINA DEL REY



Admiralty Way Street Improvement Project

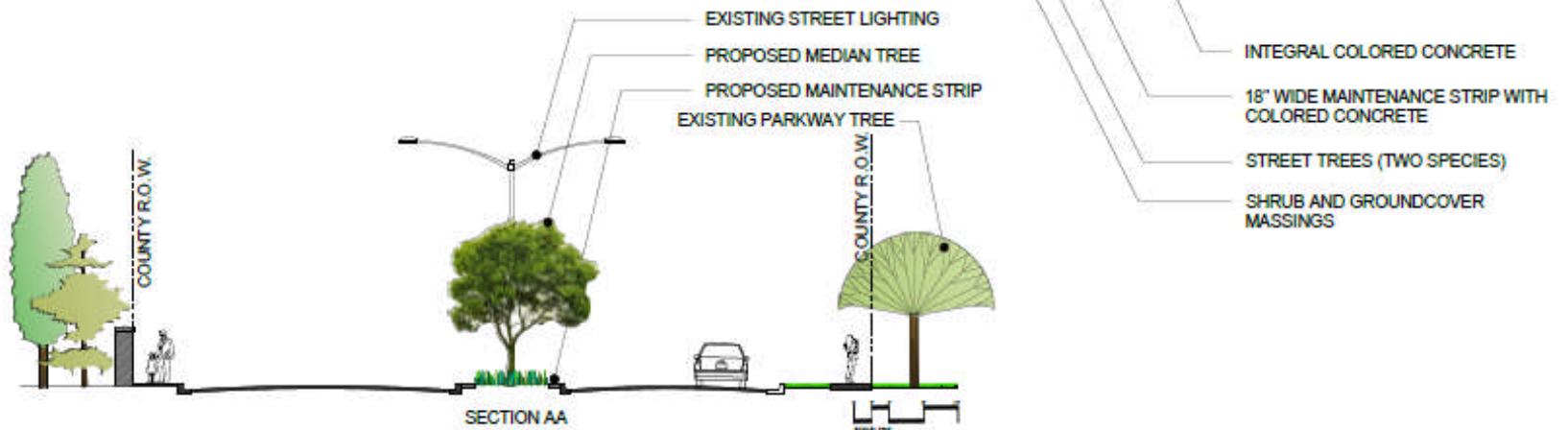



ARCTOSTAPHYLOS INSULARIS
ISLAND MANZANITA



* ERIBOTRYA DEFLEXA
BRONZE LOQUAT



* ARBUTUS 'MARINA'
STRAWBERRY TREE



AGAVE COLORATA
MESCAL



CEANOTHUS M. 'FROSTY DAWN'
MARITIME CEANOTHUS



SENECIO T. MANDRALISCAE
FLAME VINE



ACHILLEA M. 'PAPRIKA'
YARROW



BACCHARIS P. 'PIGEON POINT'
COYOTE BUSH



LOTUS SCOPARIUS
DEER WEED



LEYMUS TRITICOIDES
CREEPING WILD RYE



LIMONIUM PEREZII
SEA LAVENDER



MALOSMA LAURINA
LAUREL SUMAC



MYRICA CALIFORNICA
PACIFIC WAX MYRTLE

| | BOTANICAL NAME | COMMON NAME | CALIFORNIA NATIVE | SALT TOLERANT | EXPOSED | HEIGHT = 1-2' | HEIGHT = 3-4' | HEIGHT = 12-20' | FLOWER / FOLIAGE COLOR | DESIGN STANDARD | THREE LIST | DROUGHT TOLERANT PLANT |
|-------------------------|-----------------------------|--------------------|-------------------|---------------|---------|---------------|---------------|-----------------|------------------------|-----------------|------------|------------------------|
| TREES | ARCTOSTAPHYLOS INSULARIS | ISLAND MANZANITA | ● | ● | ● | ● | ● | ● | ● | ● | ● | ● |
| | * ARBUTUS 'MARINA' | STRAWBERRY TREE | ● | ● | ● | ● | ● | ● | ● | ● | ● | ● |
| | * ERIBOTRYA DEFLEXA | BRONZE LOQUAT | ● | ● | ● | ● | ● | ● | ● | ● | ● | ● |
| | MALOSMA LAURINA | LAUREL SUMAC | ● | ● | ● | ● | ● | ● | ● | ● | ● | ● |
| | MYRICA CALIFORNICA | PACIFIC WAX MYRTLE | ● | ● | ● | ● | ● | ● | ● | ● | ● | ● |
| SHRUBS AND GROUND COVER | ACHILLEA M. 'PAPRIKA' | YARROW | ● | ● | ● | ● | ● | ● | ● | ● | ● | ● |
| | AGAVE COLORATA | MESCAL | ● | ● | ● | ● | ● | ● | ● | ● | ● | ● |
| | BACCHARIS P. 'PIGEON POINT' | COYOTE BUSH | ● | ● | ● | ● | ● | ● | ● | ● | ● | ● |
| | CEANOTHUS M. 'FROSTY DAWN' | MARITIME CEANOTHUS | ● | ● | ● | ● | ● | ● | ● | ● | ● | ● |
| | LOTUS SCOPARIUS | DEER WEED | ● | ● | ● | ● | ● | ● | ● | ● | ● | ● |
| | SENECIO T. MANDRALISCAE | FLAME VINE | ● | ● | ● | ● | ● | ● | ● | ● | ● | ● |
| | LEYMUS TRITICOIDES | CREEPING WILD RYE | ● | ● | ● | ● | ● | ● | ● | ● | ● | ● |
| | LIMONIUM PEREZII | SEA LAVENDER | ● | ● | ● | ● | ● | ● | ● | ● | ● | ● |
| | TRADESCANTIA P. 'PURPUREA' | PURPLE HEART | ● | ● | ● | ● | ● | ● | ● | ● | ● | ● |
| | TRICHOSTEMA LANATUM | WOOLY BLUE CURLS | ● | ● | ● | ● | ● | ● | ● | ● | ● | ● |
| | TULBAGHIA V. 'SILVER LACE' | SOCIETY GARLIC | ● | ● | ● | ● | ● | ● | ● | ● | ● | ● |

* RECOMMENDED TREE SPECIES

PROPOSED PLANT PALETTE FOR STREET MEDIAN PLANTING ALONG ADMIRALTY WAY FROM FIJI WAY TO PALAWAN WAY

PREPARED BY LOS ANGELES COUNTY DEPARTMENT OF PUBLIC WORKS, APRIL 10, 2012



TRADESCANTIA P. 'PURPUREA'
PURPLE HEART

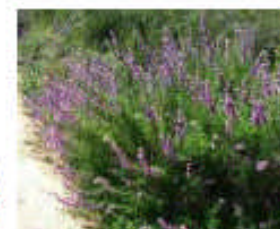

TRICHOSTEMA LANATUM
WOOLY BLUE CURLS



TULBAGHIA V. 'SILVER LACE'
SOCIETY GARLIC



VIEW OF ADMIRALTY WAY WESTBOUND

Fiji Way Street Improvement Project

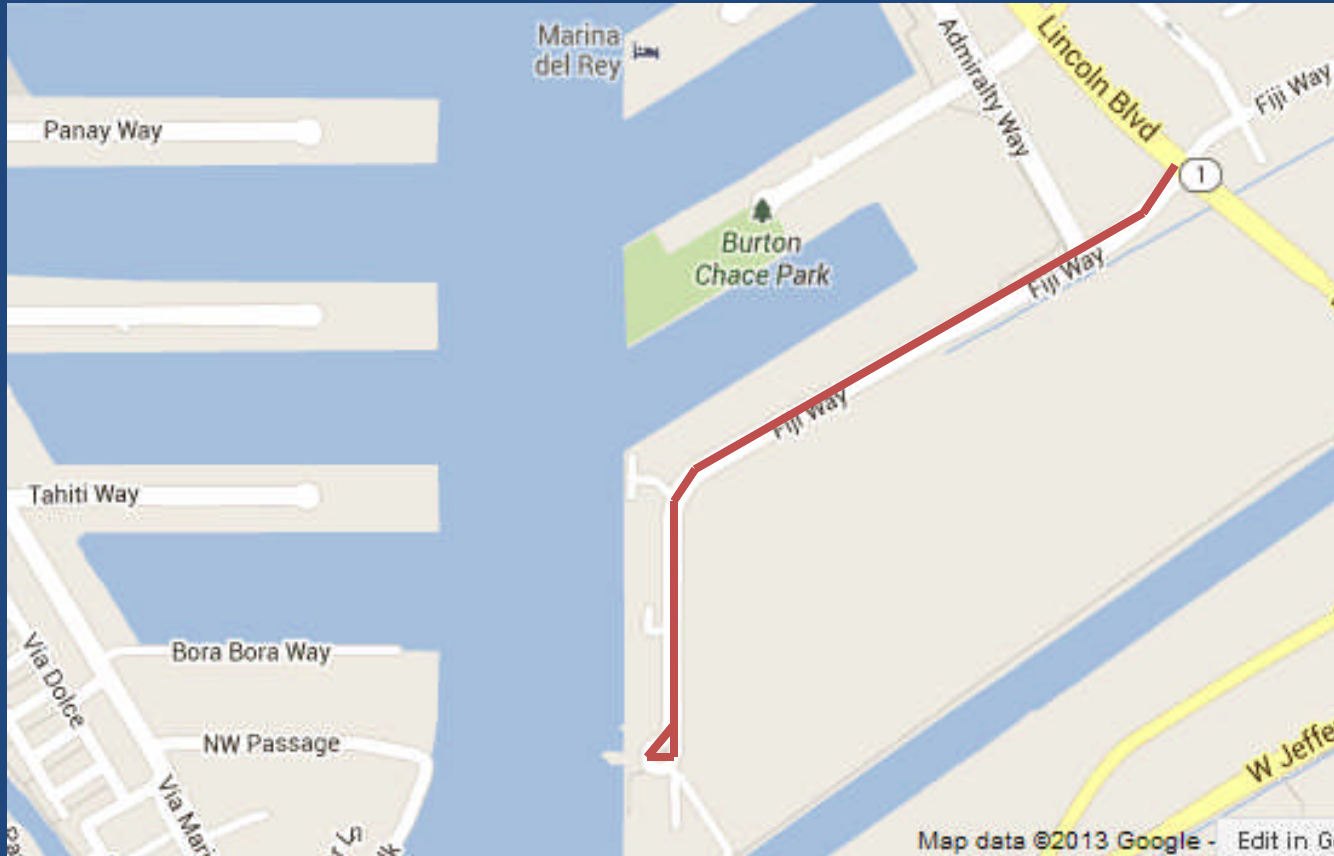

Estimated Construction Start Date: January 2015

Project Improvements

- Median landscaping replacement
- Wider sidewalk around the cul-de-sac
- Complete road resurfacing
- Designated bicycle lane

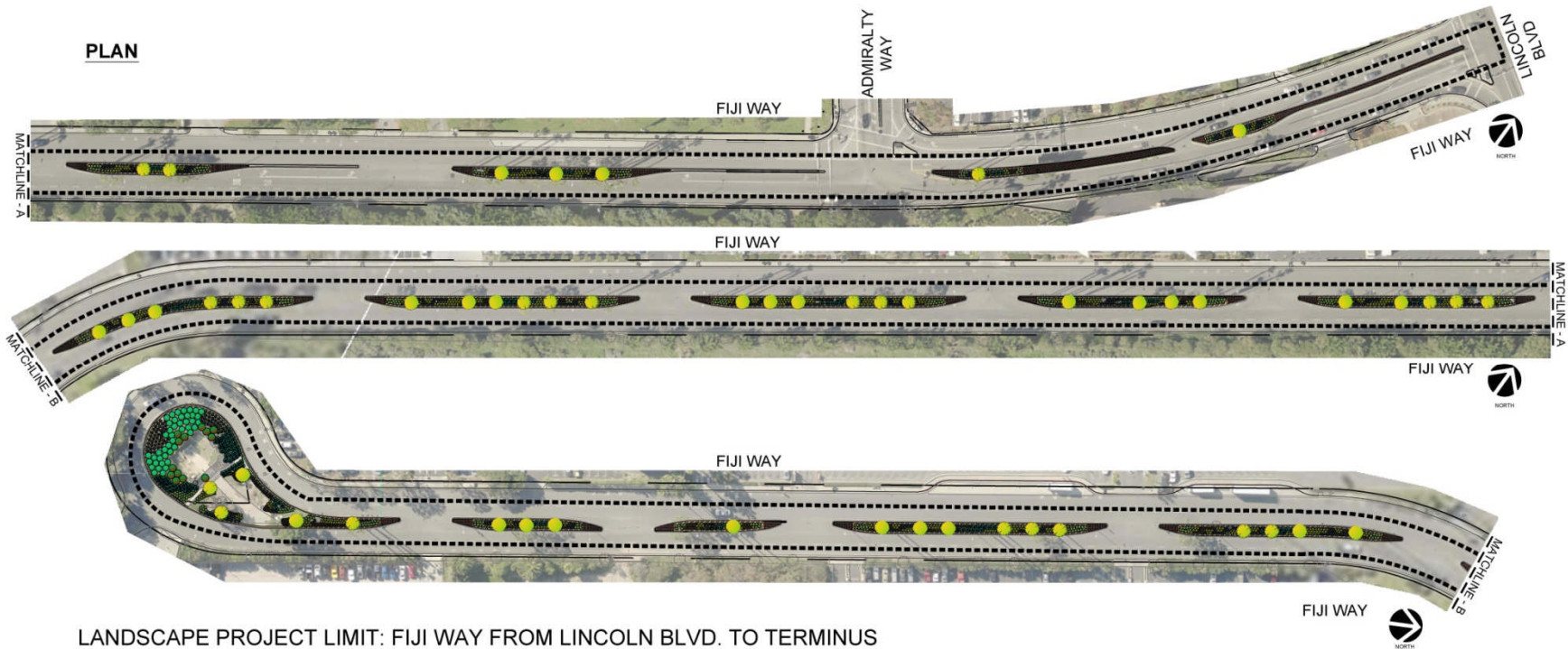

LANDSCAPE PROJECT LIMIT: FIJI WAY FROM LINCOLN BLVD. TO TERMINUS

PROJECT LENGTH: 4,700 FEET

PROJECT SCOPE:

- REMOVAL OF EXISTING VEGETATION IN THE MEDIAN
- CONSTRUCTION OF 18" WIDE MAINTENANCE STRIP USING INTEGRAL COLORED CONCRETE
- CONSTRUCTION OF DECORATIVE PAVING AREAS USING COLORED CONCRETE UNIT PAVERS
- CONSTRUCTION OF AUTOMATIC IRRIGATION SYSTEM
- PLANT STREET TREES, SHRUBS AND GROUNDCOVERS
- PROVIDE ELECTRICAL CONDUITS FOR FUTURE HOLIDAY LIGHTING

FIJI WAY CONCEPT PLAN

MARINA DEL REY



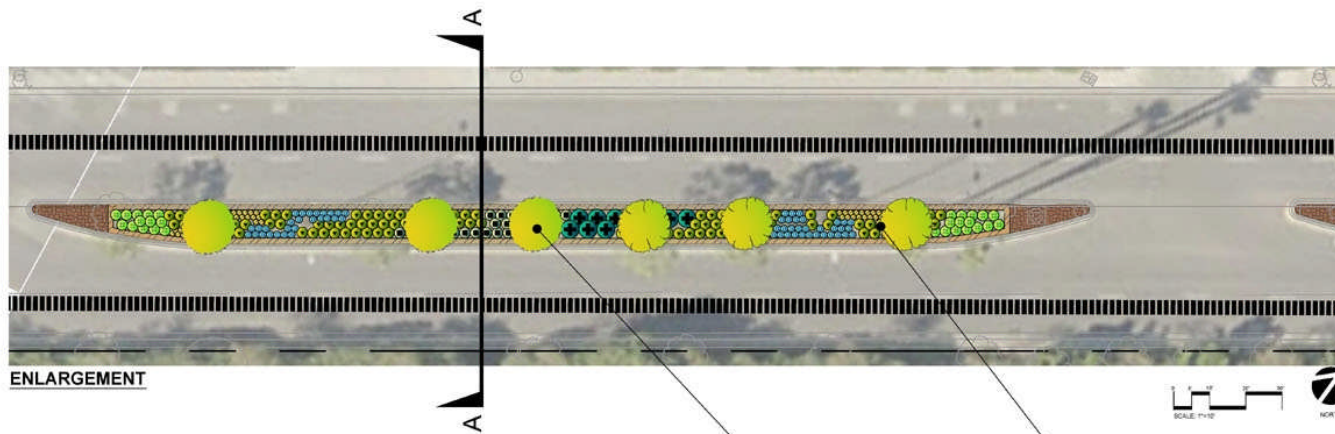

SECTION AA

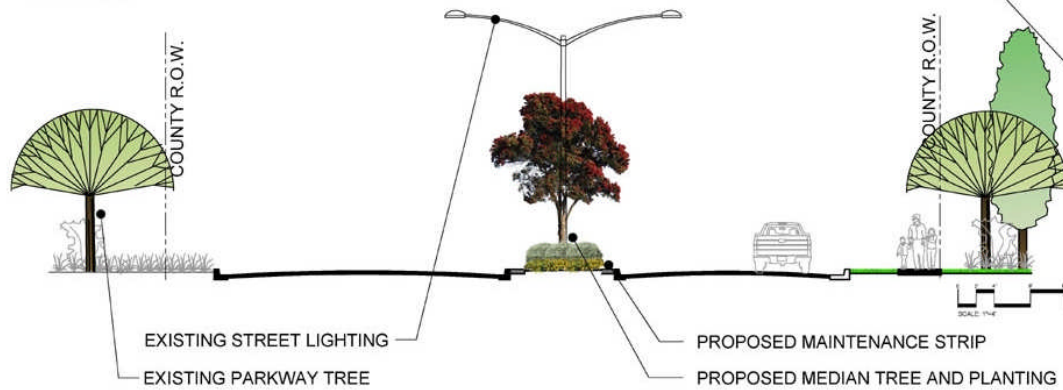

ARBUTUS 'MARINA'
STRAWBERRY TREE



METROSIDEROS EXCELSUS
NEW ZEALAND CHRISTMAS TREE

FIJI WAY MEDIAN TREE PLANTING ENLARGEMENT

MARINA DEL REY

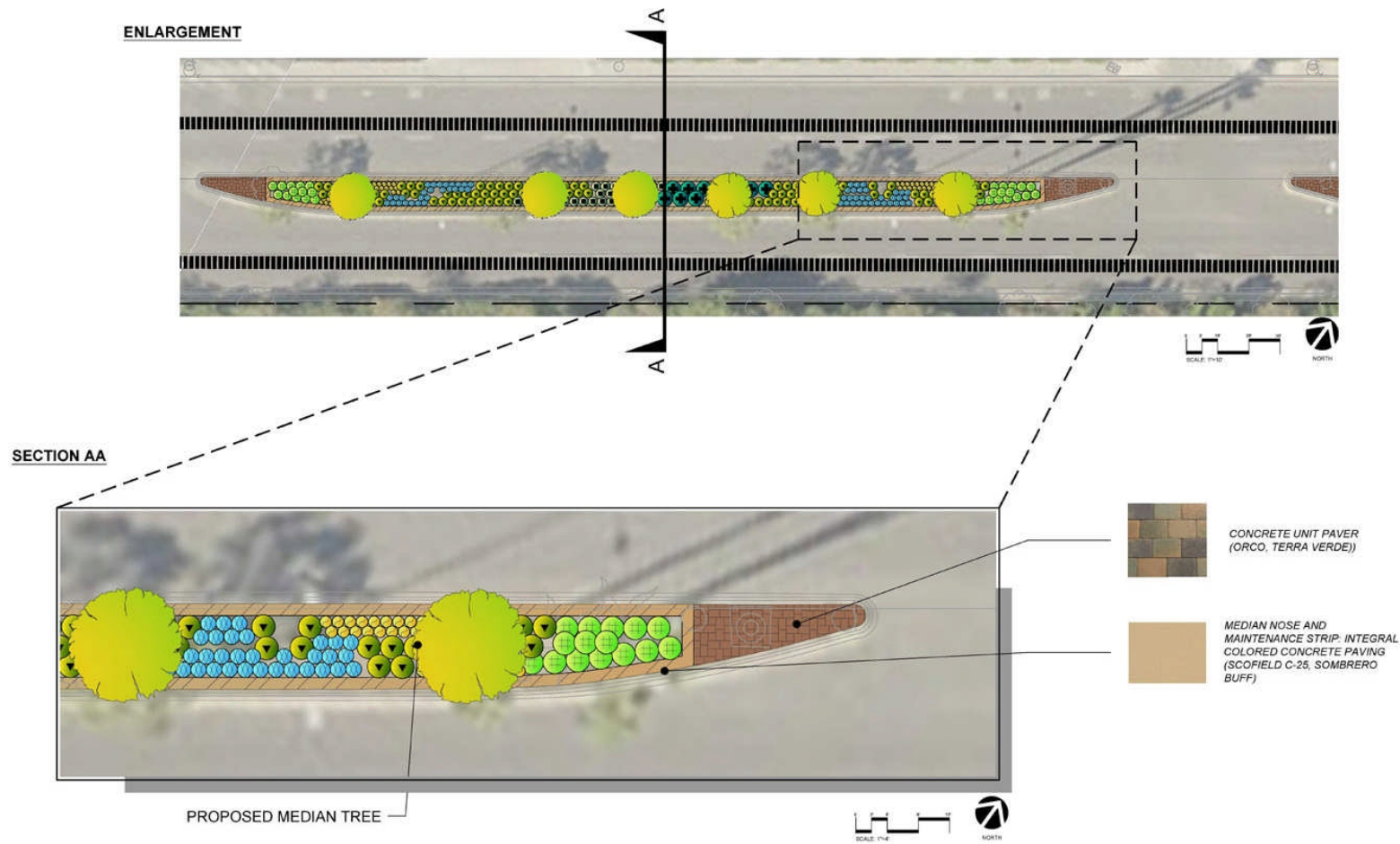

FIJI WAY MEDIAN PAVEMENT ENLARGEMENT

MARINA DEL REY



METROSIDEROS EXCELSUS
NEW ZEALAND CHRISTMAS
TREE



ARBUTUS 'MARINA'
STRAWBERRY TREE



ACHILLEA 'MOONSHINE'
YELLOW YARROW HYBRID



CEANOTHUS GRIS, *HORIZ 'YANKEE POINT'*
CARMEL MOUNTAIN LILAC



LANTANA
DWARF YELLOW TRAILING
LANTANA



PHORMIUM HYBRID 'DUET'



SENECIO MANDRALISCAE
BLUE CHALK STICKS



WESTRINGIA F. 'MORNING LIGHT'
MORNING LIGHT COAST ROSEMARY

| | BOTANICAL NAME | COMMON NAME | SALT TOLERANT | EVERGREEN | DESIGN STANDARD TREE LIST | DROUGHT TOLERANT PLANT LIST | MATURE HEIGHT = 12-20' | MATURE HEIGHT = 30-50' |
|--------------|---------------------------------------|-------------------------------|---------------|-----------|---------------------------|-----------------------------|------------------------|------------------------|
| TREES | <i>METROSIDEROS EXCELSUS</i> | NEW ZEALAND CHRISTMAS TREE | ● | ● | ● | ● | ● | ● |
| | <i>ARBUTUS 'MARINA'</i> | STRAWBERRY TREE | ● | ● | ● | ● | ● | ● |
| SHRUBS | <i>ACHILLEA 'MOONSHINE'</i> | YELLOW YARROW HYBRID | ● | ● | ● | ● | ● | ● |
| | <i>CEANOTHUS G. H. 'YANKEE POINT'</i> | CARMEL MOUNTAIN LILAC | ● | ● | ● | ● | ● | ● |
| | <i>PHORMIUM HYBRID 'DUET'</i> | NCN | ● | ● | ● | ● | ● | ● |
| | <i>WESTRINGIA F. 'MORNING LIGHT'</i> | COAST ROSEMARY | ● | ● | ● | ● | ● | ● |
| GROUND COVER | <i>LANTANA HYBRID 'DWARF YELLOW'</i> | DWARF YELLOW TRAILING LANTANA | ● | ● | ● | ● | ● | ● |
| | <i>SENECIO MANDRALISCAE</i> | BLUE CHALK STICKS | ● | ● | ● | ● | ● | ● |

FIJI WAY MEDIAN TREE/PLANT PALETTE

MARINA DEL REY



VIEW OF FIJI WAY LOOKING NORTH

Via Marina Roadway Improvement Project

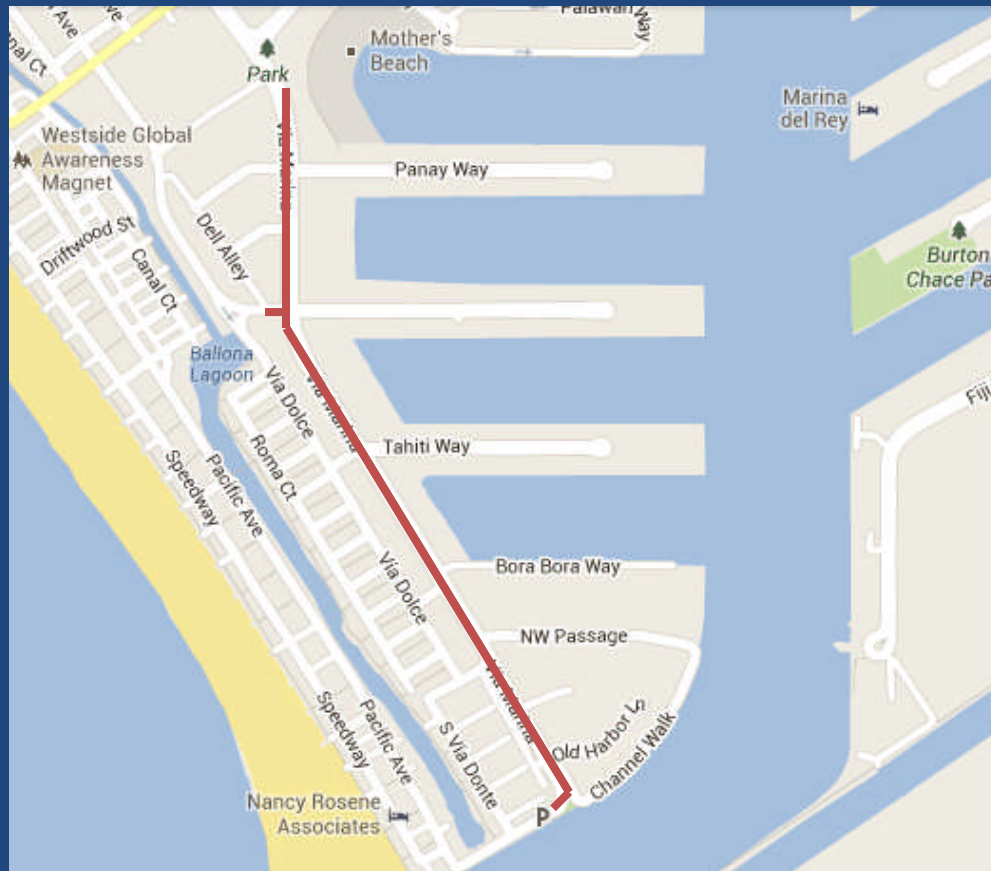

Estimated Construction Start Date: January 2015

Project Improvements

- Median landscaping replacement
- Complete road resurfacing



PROJECT LIMIT: VIA MARINA FROM 465 FT. NORTH OF PANAY WAY TO 1,727 FT. SOUTH OF BORA BORA WAY

PROJECT LENGTH: 5350 FEET

PROJECT SCOPE:

- REMOVAL OF EXISTING VEGETATION IN THE MEDIAN
- CONSTRUCTION OF 18" WIDE MAINTENANCE STRIP USING INTEGRAL COLORED CONCRETE
- CONSTRUCTION OF DECORATIVE PAVING AREAS USING COLORED CONCRETE UNIT PAVERS
- CONSTRUCTION OF AUTOMATIC IRRIGATION SYSTEM
- PLANT STREET TREES, SHRUBS AND GROUNDCOVERS
- PROVIDE ELECTRICAL CONDUITS FOR FUTURE HOLIDAY LIGHTING



VIA MARINA MEDIAN LANDSCAPE CONCEPT PLAN

MARINA DEL REY



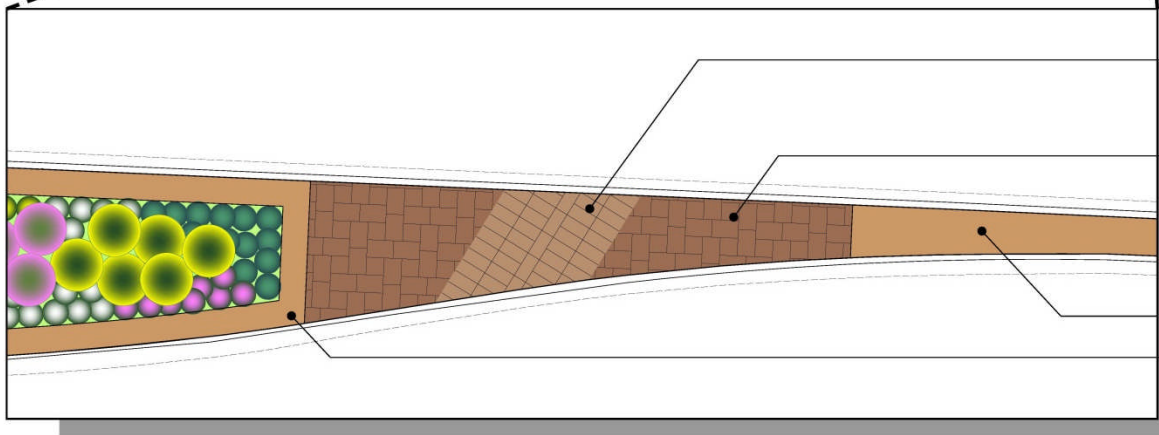
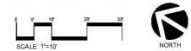
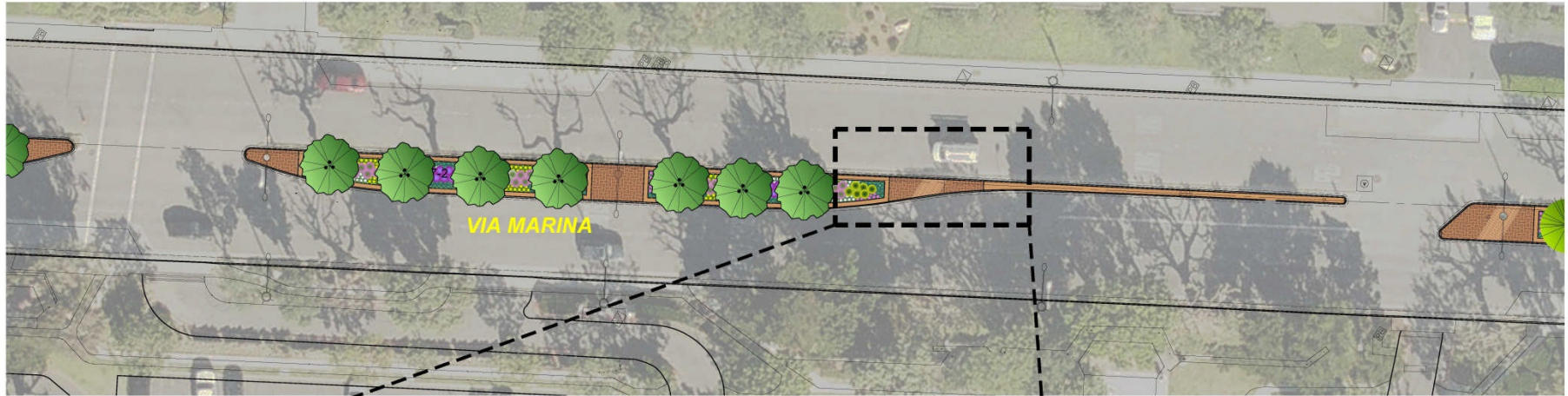

CONCRETE UNIT
PAVER BANDING
(ORCO, SANDSTONE)

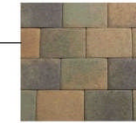

CONCRETE UNIT PAVER
(ORCO, TERRA VERDE))



MEDIAN NOSE AND
MAINTENANCE STRIP:
INTEGRAL COLORED
CONCRETE PAVING
(SCOFIELD C-25,
SOMBRERO BUFF)

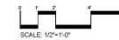

VIA MARINA MEDIAN PAVEMENT ENLARGEMENT

MARINA DEL REY

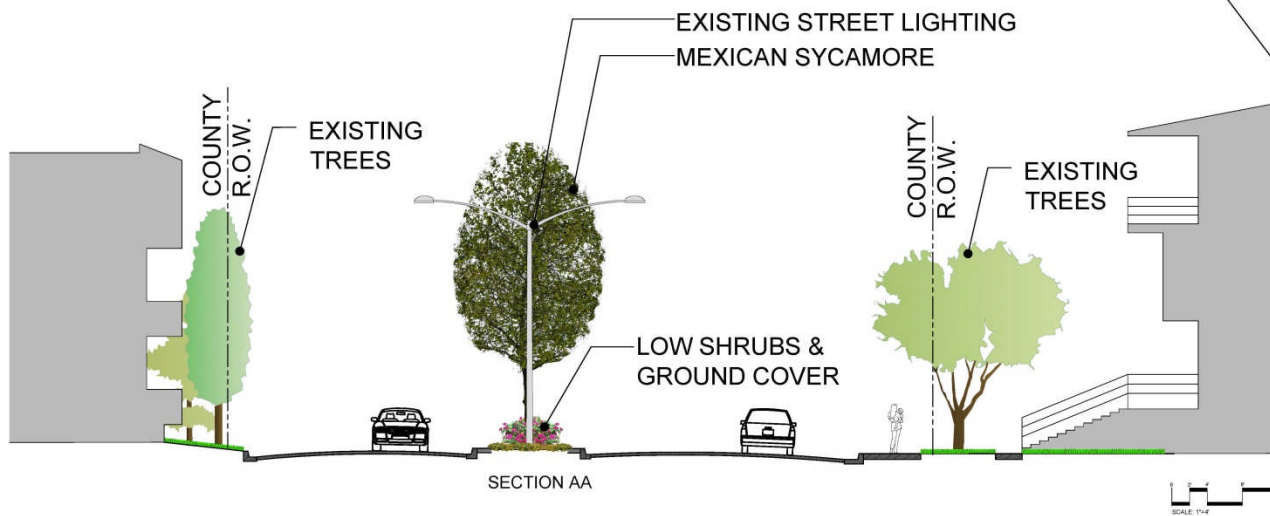
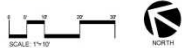
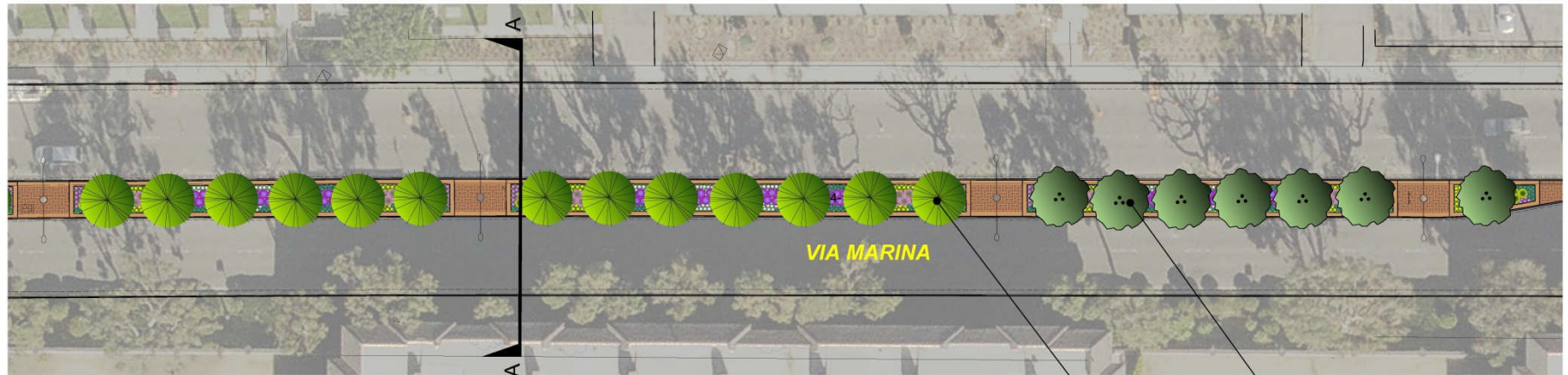

FERN PINE
AFROCARPUS GRACILIOR



MEXICAN SYCAMORE
PLATANUS MEXICANA

VIA MARINA MEDIAN TREE PLANTING ENLARGEMENT

MARINA DEL REY





PLATANUS MEXICANA
MEXICAN SYCAMORE



AFROCARPUS GRACILIOR
FERN PINE



CISTUS X 'BRILLIANCY'
BRILLIANCY ROCK ROSE



ENCELIA CALIFORNIA
CALIFORNIA ENCELIA



WESTRINGIA F. 'MORNING LIGHT'
MORNING LIGHT COAST ROSEMARY



RHAPHIOLEPIS I. 'ENCHANTRESS'
ENCHANTRESS INDIAN HAWTHORNE



CALYLOPHUS HARTWEGII
SUNDROPS



ERIGERON GLAUCUS
BEACH ASTER



MYOPORUM PARVIFOLIUM
PROSTRATE MYOPORUM



STACHYS BYZANTINA
LAMB'S EARS

| | BOTANICAL NAME | COMMON NAME | SALT TOLERANT | EVERGREEN | REGIONAL PLANNING DROUGHT | TOLERANT PLANT LIST | MATURE HEIGHT = 30'-50' | 5 GALLON | 15 GALLON | 24" BOX | 36" BOX |
|--------------|-------------------------------|----------------------|---------------|-----------|---------------------------|---------------------|-------------------------|----------|-----------|---------|---------|
| TREES | AFROCARPUS GRACILIOR | FERN PINE | ● | ● | ● | ● | 100+ | 100+ | 100+ | 100+ | |
| | PLATANUS MEXICANA | MEXICAN SYCAMORE | ● | ● | ● | ● | | | 14 | 100+ | |
| SHRUBS | CISTUS X 'BRILLIANCY' | BRILLIANCY ROCK ROSE | ● | ● | ● | ● | | | | | |
| | ENCELIA CALIFONICA | CALIFORNIA ENCELIA | ● | ● | ● | ● | | | | | |
| | WESTRINGIA F. 'MORNING LIGHT' | COAST ROSEMARY | ● | ● | ● | ● | | | | | |
| | RHAPHIOLEPIS I. 'ENCHANTRESS' | INDIAN HAWTHORNE | ● | ● | ● | ● | | | | | |
| GROUND COVER | CALYLOPHUS HARTWEGII | SUNDROPS | ● | ● | ● | ● | | | | | |
| | ERIGERON GLAUCUS | BEACH ASTER | ● | ● | ● | ● | | | | | |
| | MYOPORUM PARVIFOLIUM | PROSTRATE MYOPORUM | ● | ● | ● | ● | | | | | |
| | STACHYS BYZANTINA | LAMB'S EARS | ● | ● | ● | ● | | | | | |

TREE AVAILABILITY
(AS OF MARCH 2013)

VIA MARINA MEDIAN TREE/PLANT PALETTE

MARINA DEL REY





VIEW OF VIA MARINA SOUTH BOUND

Thank You!

